

NW # 3

1 LOCATION OF WATER WELL: Fraction NE 1/4 NE 1/4 SE 1/4 Section Number 27 Township Number T 11 S Range Number R 16 E  
 County: Shawnee  
 Distance and direction from nearest town or city street address of well if located within city?  
30 feet west of Croco Road 90 feet south of 1/2 Section line

2 WATER WELL OWNER: Kansas Department of Health & Environment  
 RR#, St. Address, Box #: Bldg. 740, Forbes Field Board of Agriculture, Division of Water Resources  
 City, State, ZIP Code: Topeka, Ks, 66620 Application Number: \_\_\_\_\_

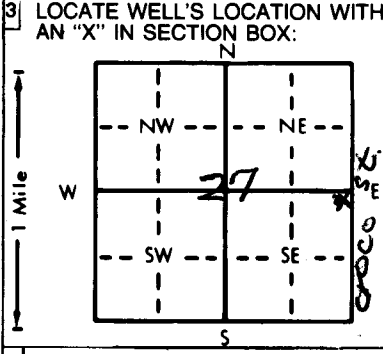

4 DEPTH OF COMPLETED WELL: 62.5 ft. ELEVATION: \_\_\_\_\_  
 Depth(s) Groundwater Encountered: 1. 22.5 ft. 2. \_\_\_\_\_ ft. 3. \_\_\_\_\_ ft.  
 WELL'S STATIC WATER LEVEL: 18.9 ft. below land surface measured on mo/day/yr 8/1/187  
 Pump test data: Well water was \_\_\_\_\_ ft. after \_\_\_\_\_ hours pumping \_\_\_\_\_ gpm  
 Est. Yield \_\_\_\_\_ gpm; Well water was \_\_\_\_\_ ft. after \_\_\_\_\_ hours pumping \_\_\_\_\_ gpm  
 Bore Hole Diameter: 6 in. to 62.5 ft., and \_\_\_\_\_ in. to \_\_\_\_\_ ft.  
 WELL WATER TO BE USED AS: 5 Public water supply 8 Air conditioning 11 Injection well  
 1 Domestic 3 Feedlot 6 Oil field water supply 9 Dewatering 12 Other (Specify below)  
Monitoring well  
 2 Irrigation 4 Industrial 7 Lawn and garden only 10 Observation well  
 Was a chemical/bacteriological sample submitted to Department? Yes \_\_\_\_\_ No \_\_\_\_\_; If yes, mo/day/yr sample was submitted \_\_\_\_\_  
 Water Well Disinfected? Yes \_\_\_\_\_ No Yes

5 TYPE OF BLANK CASING USED: 1 Steel 3 RMP (SR) 5 Wrought iron 8 Concrete tile CASING JOINTS: Glued \_\_\_\_\_ Clamped \_\_\_\_\_  
2 PVC 4 ABS 6 Asbestos-Cement 9 Other (specify below) Welded \_\_\_\_\_  
 7 Fiberglass \_\_\_\_\_ Threaded \_\_\_\_\_  
 Blank casing diameter: 2 in. to \_\_\_\_\_ ft., Dia \_\_\_\_\_ in. to \_\_\_\_\_ ft., Dia \_\_\_\_\_ in. to \_\_\_\_\_ ft.  
 Casing height above land surface: 1.8 in., weight \_\_\_\_\_ lbs./ft. Wall thickness or gauge No. 40  
 TYPE OF SCREEN OR PERFORATION MATERIAL: 7 PVC 10 Asbestos-cement  
 1 Steel 3 Stainless steel 5 Fiberglass 8 RMP (SR) 11 Other (specify) \_\_\_\_\_  
 2 Brass 4 Galvanized steel 6 Concrete tile 9 ABS 12 None used (open hole)  
 SCREEN OR PERFORATION OPENINGS ARE: 5 Gauzed wrapped 8 Saw cut 11 None (open hole)  
 1 Continuous slot 3 Mill slot 6 Wire wrapped 9 Drilled holes  
 2 Louvered shutter 4 Key punched 7 Torch cut 10 Other (specify) \_\_\_\_\_  
 SCREEN-PERFORATED INTERVALS: From 47.5 ft. to 62.5 ft., From \_\_\_\_\_ ft. to \_\_\_\_\_ ft.  
 From \_\_\_\_\_ ft. to \_\_\_\_\_ ft., From \_\_\_\_\_ ft. to \_\_\_\_\_ ft.  
 GRAVEL PACK INTERVALS: From Natural Filter Pack ft. to \_\_\_\_\_ ft., From \_\_\_\_\_ ft. to \_\_\_\_\_ ft.  
 From \_\_\_\_\_ ft. to \_\_\_\_\_ ft., From \_\_\_\_\_ ft. to \_\_\_\_\_ ft.

6 GROUT MATERIAL: 1 Neat cement 2 Cement grout 3 Bentonite 4 Other \_\_\_\_\_  
 Grout Intervals: From 0 ft. to 11 ft., From \_\_\_\_\_ ft. to 11 ft., From 1.3 ft. to \_\_\_\_\_ ft.  
 What is the nearest source of possible contamination:  
1 Septic tank 4 Lateral lines 7 Pit privy 10 Livestock pens 14 Abandoned water well  
 2 Sewer lines 5 Cess pool 8 Sewage lagoon 11 Fuel storage 15 Oil well/Gas well  
 3 Watertight sewer lines 6 Seepage pit 9 Feedyard 12 Fertilizer storage 16 Other (specify below) \_\_\_\_\_  
 13 Insecticide storage \_\_\_\_\_  
 Direction from well? Northeast How many feet? 500

FROM	TO	LITHOLOGIC LOG	FROM	TO	LITHOLOGIC LOG
0	5	Silty clay, dark brown, dry			
5	8	Silty clay, light brown, damp			
8	22	Silty clay, dark brown, moist			
22	40	Sand and sandy silt, saturated			
40	48	Sand, medium grained, saturated			
48	61	Sand, coarse-grained, with gravel			
61	62	gravel and/or limestone float			
62	62	Shale, dark gray, very firm			
		T.D.			

7 CONTRACTOR'S OR LANDOWNER'S CERTIFICATION: This water well was (1) constructed, (2) reconstructed, or (3) plugged under my jurisdiction and was completed on (mo/day/year) 8/1/187 and this record is true to the best of my knowledge and belief. Kansas Water Well Contractor's License No. \_\_\_\_\_ This Water Well Record was completed on (mo/day/yr) 8/1/187 under the business name of \_\_\_\_\_ by (signature) Maura W. Belmont

OFFICE USE ONLY  
T  
R  
EW  
SEC.  
1/4  
1/4  
1/4