

P2-03

WATER WELL PLUGGING RECORD Form WWC-5P KSA 82a-1212 ID NO.

1 LOCATION OF WATER WELL: Fraction 1/4 NW 1/4 NW 1/4 NW 1/4 Section Number 32 Township Number T 11 S Range Number 17 [X] E [ ] W

Street/Rural Address of Well Location; if unknown, distance & direction from nearest town or intersection: If at owner's address, check here [ ] DuPont Tecumseh Site
6000 SE 2nd St., Tecumseh, KS

2 WATER WELL OWNER: E.I.duPont de Nemours Co. RR#, St. Address, Box #: P.O. Box 2915 City, State ZIP Code: Wilmington, DE 19805

Global Positioning Systems (GPS) information: Latitude: 39.05690 (in decimal degrees) Longitude: 95.55283 (in decimal degrees) Elevation: Datum: [X] WGS84, [ ] NAD83, [ ] NAD27 Collection Method: [X] GPS unit (Make/Model: Garmin 60c) [ ] Digital Map/Photo, [ ] Topographic Map, [ ] Land Survey Est. Accuracy: [ ] < 3 m, [X] 3-5 m, [ ] 5-15 m, [ ] > 15 m

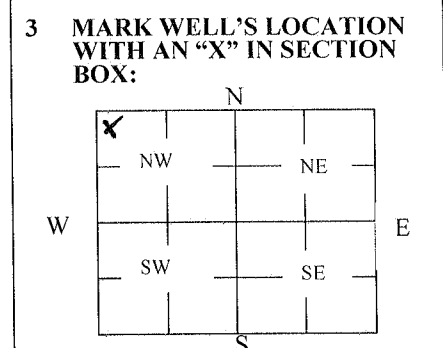

4 DEPTH OF WELL 18.5 ft. WELL'S STATIC WATER LEVEL 14.2 ft. WELL WAS USED AS: [ ] Domestic [ ] Irrigation [ ] Feedlot [ ] Industrial [ ] Public Water Supply [ ] Oil Field Water Supply [ ] Domestic (Lawn & Garden) [ ] Air Conditioning [ ] Dewatering [X] Monitoring [ ] Injection Well [ ] Other Was a chemical/bacteriological sample submitted to Department? Yes [ ] No [X]

5 TYPE OF BLANK CASING USED: [ ] Steel [X] PVC [ ] RMP (SR) [ ] ABS [ ] Wrought Asbestos-Cement [ ] Fiberglass Concrete Tile [ ] Other (Specify below) Blank casing diameter 2 in. Was casing pulled? Yes [ ] No [X] If yes, how much Casing height above or below land surface 30 in.

6 GROUT PLUG MATERIAL: [ ] Neat cement [ ] Cement grout [X] Bentonite [ ] Other Grout Plug Intervals: From 18.5 ft. to 2 ft., From 2 ft. to 0 ft., From 0 ft. to 0 ft. What is the nearest source of possible contamination: [ ] Septic tank [ ] Sewer lines [ ] Watertight sewer lines [ ] Lateral lines [ ] Cess pool [ ] Seepage pit [ ] Pit privy [ ] Sewage lagoon [ ] Feedyard [ ] Livestock pens [ ] Fuel Storage [ ] Fertilizer storage [ ] Insecticide storage [ ] Abandoned water well [ ] Oil well/Gas well [ ] Other (specify below) Direction from well? How many feet?

Table with 6 columns: FROM, TO, PLUGGING MATERIALS, FROM, TO, PLUGGING MATERIALS. Row 1: 18.5, 2, Bentonite Grout, Row 2: 2, 0, Top Soil

7 CONTRACTOR'S OR LANDOWNER'S CERTIFICATION: This water well was plugged under my jurisdiction and was completed on (mo/day/year) 4/16/2013 and this record is true to the best of my knowledge and belief. Kansas Water Well Contractor's License No. 710. This Water Well Record was completed on (mo/day/year) 4/18/2013 under the business name of Below Ground Surface, Inc. by (signature)

INSTRUCTIONS: Use typewriter or ballpoint pen. Please press firmly and print clearly. Please fill in blanks, underline or circle the correct answers. Send top three copies to Kansas Department of Health and Environment, Bureau of Water, Geology Section, 1000 SW Jackson St., Ste. 420, Topeka, Kansas 66612-1367. Telephone: 785/296-5524. Send one to Water Well Owner and retain one for your records. Visit us at http://www.kdheks.gov/waterwell/index.html.

Check one: [ ] White Copy [ ] Blue Copy [ ] Pink Copy