

USE TYPEWRITER OR BALL POINT PEN-PRESS FIRMLY, PRINT CLEARLY.

WATER WELL RECORD
KSA 82a-1201-1215

Kansas Department of Health and Environment-Division of Environment
(Water well Contractors)
Topeka, Kansas 66620

1. Location of well: County **SHAWNEE** Section **SW 1/4 NE 1/4 NE 1/4** Section number **28** Township number **T 11 S R 17 E**

Distance and direction from nearest town or city: **3 MILES E** Owner of well: **C. BRADY**
Street address of well location if in city: **RFD-1 TECUMSEH** City, state, zip code: **T RFD-1 TECUMSEH 66607**

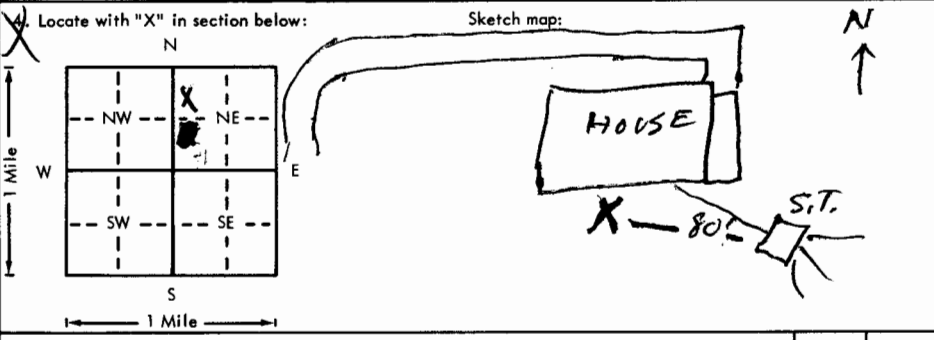

6. Bore hole dia. **8** in. Completion date **9-21-76**
Well depth **44** ft.

7. Cable tool Rotary Driven Dug
 Hollow rod Jetted Bored Reverse rotary

8. Use: Domestic Public supply Industry
 Irrigation Air conditioning Stock
 Lawn Oil field water Other

9. Casing: Material Height: Above or below
Threaded Welded Surface **24** in.
RMP **STI** PVC Weight lbs./ft.
Dia. **5** in. to ft. depth Wall Thickness: inches or
Dia. in. to ft. depth gage No. **200**

5. Type and color of material	From	To
Top soil	0	3
FINE SILT	3	14
SAND	14	22
HARD PAN DARK GRAY	22	26
SILT SAND	26	30
FINE "	30	35
SAND + GRAVEL	35	44
(Use a second sheet if needed)		

10. Screen: Manufacturer's name **SUNFLOWER**

Type **PLAS.** Dia. **5 1/2**
Slot/gauze **24** Length **5'**
Set between **39** ft. and **144** ft.
39 ft. and ft.
Gravel pack? Size range of material **1/4"**

11. Static water level: mo./day/yr.
30 ft. below land surface Date **9-18-76**

12. Pumping level below land surfaces:
30 ft. after **2** hrs. pumping **16** g.p.m.
 ft. after hrs. pumping g.p.m.
Estimated maximum yield **20** g.p.m.

13. Water sample submitted: mo./day/yr.
Yes No Date

14. Well head completion:
 Pitless adapter **12** inches above grade

15. Well grouted?
With: Neat cement Bentonite Concrete
Depth: From **3** ft. to **13** ft.

16. Nearest source of possible contamination:
ft. **18** Direction **E** Type **SEW.**
Well disinfected upon completion? Yes No

17. Pump: Not installed
Manufacturer's name **GOULDS**
Model number **7E4** HP **1/2** Volts **110**
Length of drop pipe **40** ft. capacity **10** g.p.m.
Type:
 Submersible Turbine
 Jet Reciprocating
 Centrifugal Other

18. Elevation: **2600**
Topography:
 Hill
 Slope
 Upland
 Valley

19. Remarks:

20. Water well contractor's certification: **10-1-76**
This well was drilled under my jurisdiction and this report is true to the best of my knowledge and belief.
H. J. Pettit 333
Business name License No.
Address **905 N. Michigan**
Signed **Harold J. Pettit** Date **10-1-76**
Authorized representative

Forward the white, blue and pink copies to the Department of Health and Environment

Form WWC-5

T 11 S R 17 E
Sec 28 NW 1/4 NE 1/4