

WATER WELL RECORD

Form WWC-5

Division of Water Resources App. No.

[Empty box]

Well ID

MW8

[X] Original Record [] Correction [] Change in Well Ust

1 LOCATION OF WATER WELL: County Jefferson Fraction NE 1/4 SW 1/4 SW 1/4 Section Number 23 Township Number T 11 S Range Number R 18 [X] E [] W

2 WELL OWNER: Last Name: Bahnmaier First: Earl Street or Rural Address where well is located (if unknown, distance and direction from nearest town or intersection): If at owner's address, check here: [] SE corner of E Front St & 2nd St., Perry, KS

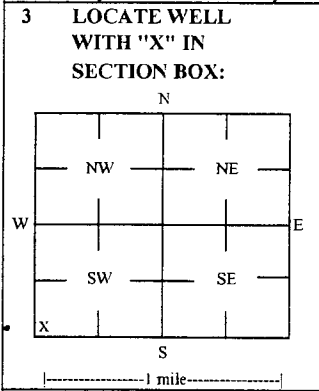

4 DEPTH OF COMPLETED WELL: 30 ft Depth(s) Groundwater Encountered: 1) _____ ft 2) _____ ft 3) _____ ft, or 4) [] Dry Well WELL'S STATIC WATER LEVEL: 22.86 ft. [X] below land surface, measured on (mo-day-yr) 3/26/18

5 Latitude: 39.07398 (decimal degrees) Longitude: 95.39033 (decimal degrees) Horizontal Datum: [] WGS 84 [] NAD 83 [] NAD 27 Source for Latitude/Longitude: [] GPS (unit make/model: _____) (WAAS enabled? [] Yes [] No) [X] Land Survey [] Topographic Map [] Online Mapper

6 Elevation 850.33 ft [] Ground Level [X] TOC Source [X] Land Survey [] GPS [] Topographic Map [] Other _____

7 WELL WATER TO BE USED AS: 1 Domestic: [] Household [] Lawn & Garden [] Livestock 2 [] Irrigation 3 [] Feedlot 4 [] Industrial 5 [] Public Water Supply: well ID 6 [] Dewatering: how many wells? 7 [] Aquifer Recharge: well ID 8 [X] Monitoring: well ID MW8 9 Environmental Remediation: well ID [] Air Sparge [] Soil Vapor Extractor [] Recovery [] Injection 10 [] Oil Field Water Supply: lease _____ 11 Test Hole: well ID [] Cased [] Uncased [] Geotechnical 12 Geothermal: How many bores? a) Closed Loop [] Horizontal [] Vertical b) Open Loop [] Surface Discharge [] Inj. of Water [] Other (specify): _____

Was a chemical/bacteriological sample submitted to KDHE? [] Yes [X] No If yes, date sample was submitted: _____ Water well disinfected? [] Yes [X] No

8 TYPE OF CASING USED: [] Steel [X] PVC [] Other _____ CASING JOINTS: [] Glued [] Clamped [] Welded [X] Threaded Casing diameter 2 in. to 15 ft, Diameter _____ in. to _____ ft, Diameter _____ in. to _____ ft, Casing height above land surface -0.30 in. Weight _____ lbs./ft. Well thickness or gauge No _____ TYPE OF SCREEN OR PERFORATION MATERIAL: [] Steel [] Stainless Steel [] Fiberglass [X] PVC [] Other (Specify) _____ [] Brass [] Galvanized Steel [] Concrete tile [] None used (open hole) SCREEN OR PERFORATION OPENINGS ARE: [] Continuous Slot [X] Mill Slot [] Gauze Wrapped [] Torch Cut [] Drilled Holes [] Other (Specify) _____ [] Louvered Shutter [] Key Punched [] Wire Wrapped [] Saw Cut [] None (Open Hole) SCREEN-PERFORATED INTERVALS: From 15 ft. to 30 ft. From _____ ft. to _____ ft. From _____ ft. to _____ ft. GRAVEL PACK INTERVALS: From 13 ft. to 30 ft. From _____ ft. to _____ ft. From _____ ft. to _____ ft.

9 GROUT MATERIAL: [] Neat cement [] Cement grout [X] Bentonite [X] Other Concrete: 0-1' Grout intervals: From 1 ft. to 13 ft. From _____ ft. to _____ ft. From _____ ft. to _____ ft.

Nearest source of possible contamination: [] Septic Tank [] Lateral Lines [] Pit Privy [] Livestock Pens [] Insecticide Storage [] Sewer Lines [] Cess Pool [] Sewage Lagoon [X] Fuel Storage [] Abandoned Water Well [] Watertight Sewer Lines [] Seepage Pit [] Feedyard [] Fertilizer Storage [] Oil Well / Gas Well [] Other (Specify) _____ Direction from well? S Distance from well? ~310 ft

Table with 6 columns: FROM, TO, LITHOLOGIC LOG, FROM, TO, LITHO. LOG (cont.) or PLUGGING INTERVALS. Rows show lithology from 0 to 30 feet depth.

Notes: KDHE ID: Bahnmaier, Earl: U4-044-10572 Target of monitoring well is shallow groundwater, <20' of grout was installed at the direction of KDHE.

11 CONTRACTOR'S OR LANDOWNER'S CERTIFICATION: This water well was [X] constructed, [] reconstructed, or [] plugged under my jurisdiction and was completed on (mo-day-year) 3/26/18 and this record is true to the best of my knowledge and belief. Kansas Water Well Contractor's License No. 757 This Water Well Record was completed on (mo-day-year) _____ under the business name of Larsen & Associates, Inc. Signature: _____

NOTE: Figures exhibited within this report are only to be used within the context of this report. Placement of property lines, wells, structures, and road is based on the available information from county appraiser maps, surveys, site visits, and/or previous vendor reports and should be considered approximate.

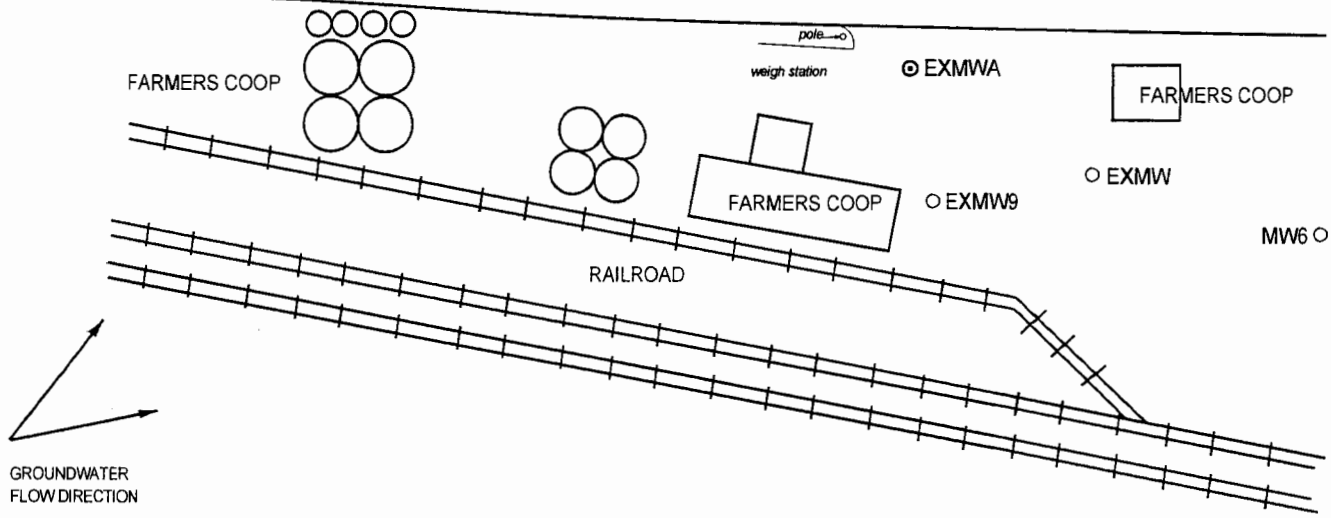
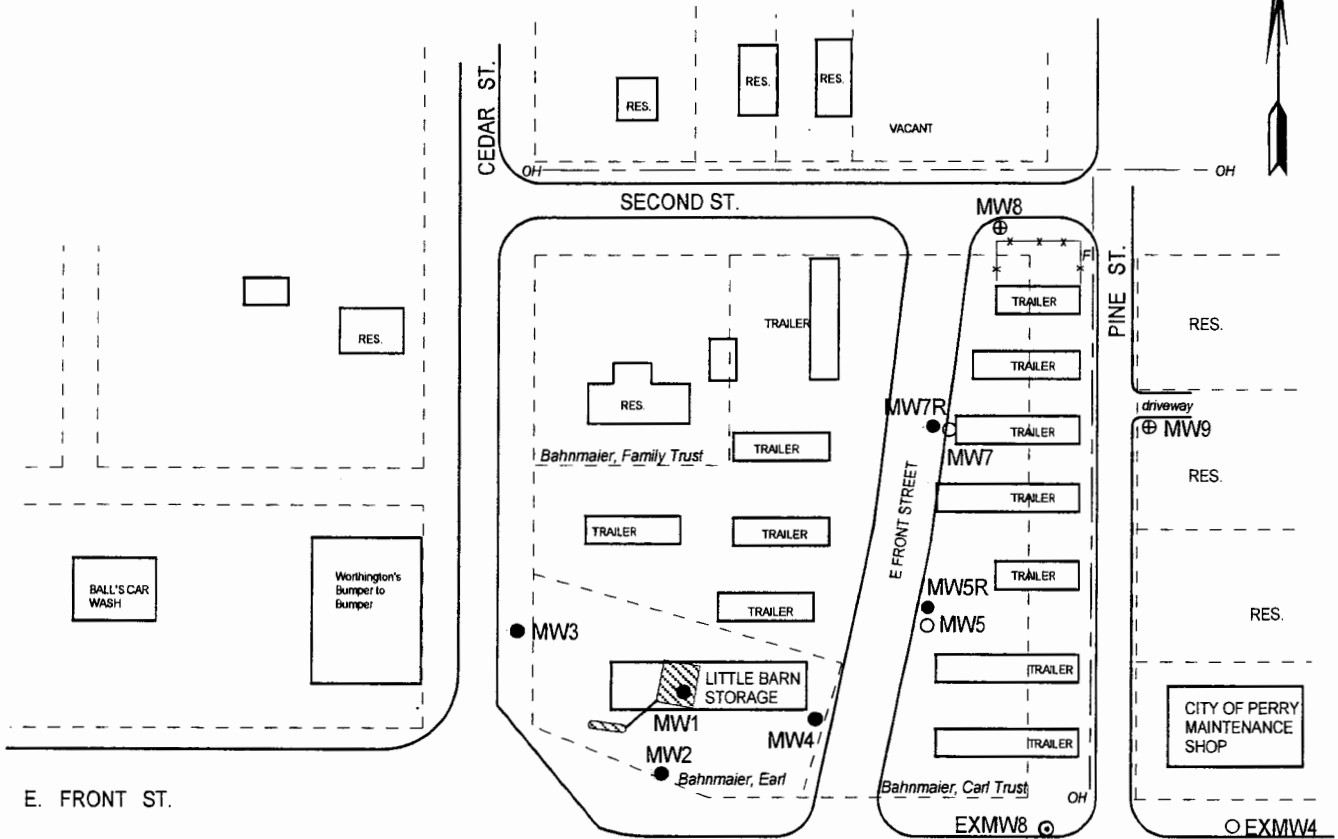

GROUNDWATER FLOW DIRECTION

FIGURE 1 - SITE BASE MAP

LEGEND:

- Approximate Location of Former UST Basin, Product Lines and Pump Island
- Approximate Location of Property Lines
- Monitoring Well
- Existing Monitoring Well
- Plugged Monitoring Well
- Monitoring Well (Installed 3/26/18)



PROJECT:
 Bahmaier, Earl
 Cedar and Front Streets
 Perry, KS
 KDHE ID: U4-044-10572
 Date: 3/26/18

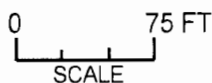

1311 E 25th St., Suite B (785) 841-8707 office
 Lawrence, KS 66046 (785) 865-4282 fax

JEFFERSON

SW SW

23-11-18E

DENNIS L HANDKE

1820 NW 59th Terrace
TOPEKA, KANSAS 66618
785-286-4047 Home
785-217-5864 Cell

Jessica Chapman
Larsen & Associates
1607 SW 41st Street
Lawrence, Kansas, 66609

April 10, 2018

RE: Monitor Well Elevation Survey
Cedar & Front Streets, Perry, Kansas

Proj. 18-00J
Bahnmaier, Earl
U4-044-10572

Bnch Mark: Chisled Sq. on Northwest side of concrete guard post pad at the Southeast corner of building.
Elev: 848.82 North 64.18 West 5086.56 (from SE Cor. Sec. 23-11-18E)

MW-8	rim	850.63	North	358.55	NE1/4,SW1/4,SW1/4,SW1/4
	top pipe	850.33	West	5009.72	Lat= 39.07398 Long = 95.39033
MW-9	rim	850.74	North	238.79	SE1/4,SE1/4,SW1/4,SW1/4
	top pipe	850.46	West	4916.04	Lat= 39.07365 Long = 95.39000

Elevation derived from USGS BM D-375. NAVD 88
Old BM destroyed

Lat & Long derived from Perry 7.5' Quad Map. WGS84

If you have any questions, please feel free to call me. Thank you for the opportunity to be of service to you.

April 10, 2018
Dennis L Handke, RLS
LS 786