

WATER WELL RECORD Form WWC-5

Division of Water Resources App. No.

[ ]

MW13

Original Record Correction Change in Well Use

Well ID

1 LOCATION OF WATER WELL: County: JEFFERSON Fraction NE 1/4 NW 1/4 NW 1/4 NW 1/4 Section Number 26 Township Number T 11 S Range Number R 18 E O W

2 WELL OWNER: Last Name: Business: KDHE Address: 1000 SW JACKSON City: TOPEKA State: KS ZIP: 66612 Street or Rural Address where well is located: FRONT STREET, PERRY KS

3 LOCATE WELL WITH "X" IN SECTION BOX: N W E S 1 mile

4 DEPTH OF COMPLETED WELL: 30 ft. Depth(s) Groundwater Encountered: 1) 15 ft. 2) ... ft. 3) ... ft., or 4) Dry Well WELL'S STATIC WATER LEVEL: ... ft. below land surface, measured on (mo-day-yr) ... ft. above land surface, measured on (mo-day-yr) ... ft. Pump test data: Well water was ... ft. after ... hours pumping ... gpm Well water was ... ft. after ... hours pumping ... gpm Estimated Yield: ... gpm Bore Hole Diameter: 8.5 in. to 30 ft. and ... in. to ... ft.

5 Latitude: 39.07284 (decimal degrees) Longitude: 95.38933 (decimal degrees) Horizontal Datum: WGS 84 NAD 83 NAD 27 Source for Latitude/Longitude: GPS (unit make/model: ... (WAAS enabled? Yes No) Land Survey Topographic Map Online Mapper:

6 Elevation: 848.66 ft. Ground Level TOC Source: Land Survey GPS Topographic Map Other

7 WELL WATER TO BE USED AS: 1. Domestic: Household Lawn & Garden Livestock Feedlot Industrial 2. Irrigation 3. Feedlot 4. Industrial 5. Public Water Supply: well ID ... 6. Dewatering: how many wells? ... 7. Aquifer Recharge: well ID ... 8. Monitoring: well ID ... 9. Environmental Remediation: well ID ... Air Sparge Soil Vapor Extraction Recovery Injection 10. Oil Field Water Supply: lease ... 11. Test Hole: well ID ... Cased Uncased Geotechnical 12. Geothermal: how many bores? ... a) Closed Loop Horizontal Vertical b) Open Loop Surface Discharge Inj. of Water 13. Other (specify): ...

Was a chemical/bacteriological sample submitted to KDHE? Yes No If yes, date sample was submitted: Water well disinfected? Yes No

8 TYPE OF CASING USED: Steel PVC Other CASING JOINTS: Glued Clamped Welded Threaded Casing diameter 2 in. to 30 ft., Diameter in. to ... ft., Diameter in. to ... ft. Casing height above land surface in. Weight lbs./ft. Wall thickness or gauge No. Sch. 40

TYPE OF SCREEN OR PERFORATION MATERIAL: Steel Stainless Steel Fiberglass PVC Other (Specify) Brass Galvanized Steel Concrete tile None used (open hole)

SCREEN OR PERFORATION OPENINGS ARE: Continuous Slot Mill Slot Gauze Wrapped Torch Cut Drilled Holes Other (Specify) Louvered Shutter Key Punched Wire Wrapped Saw Cut None (Open Hole)

SCREEN-PERFORATED INTERVALS: From 15 ft. to 30 ft., From ... ft. to ... ft., From ... ft. to ... ft. GRAVEL PACK INTERVALS: From 13 ft. to 30 ft., From ... ft. to ... ft., From ... ft. to ... ft.

9 GROUT MATERIAL: Neat cement Cement grout Bentonite Other Concrete Surface Completion 0 - 1 Grout Intervals: From 1 ft. to 13 ft., From ... ft. to ... ft., From ... ft. to ... ft.

Nearest source of possible contamination: Septic Tank Lateral Lines Pit Privy Livestock Pens Insecticide Storage Sewer Lines Cess Pool Sewage Lagoon Fuel Storage Abandoned Water Well Watertight Sewer Lines Seepage Pit Feedyard Fertilizer Storage Oil Well/Gas Well Other (Specify) Direction from well? Distance from well? ft.

Table with columns: 10 FROM TO LITHOLOGIC LOG FROM TO LITHO. LOG (cont.) or PLUGGING INTERVALS. Rows: 0 1 Topsoil 1 30 Silty Clay (CL)

11 CONTRACTOR'S OR LANDOWNER'S CERTIFICATION: This water well was constructed, reconstructed, or plugged under my jurisdiction and was completed on (mo-day-year) 1/11/21 and this record is true to the best of my knowledge and belief. Kansas Water Well Contractor's License No. 585 This Water Well Record was completed on (mo-day-year) 2/5/21 under the business name of Associated Environmental, Inc. Signature

23 11 18  
S T R

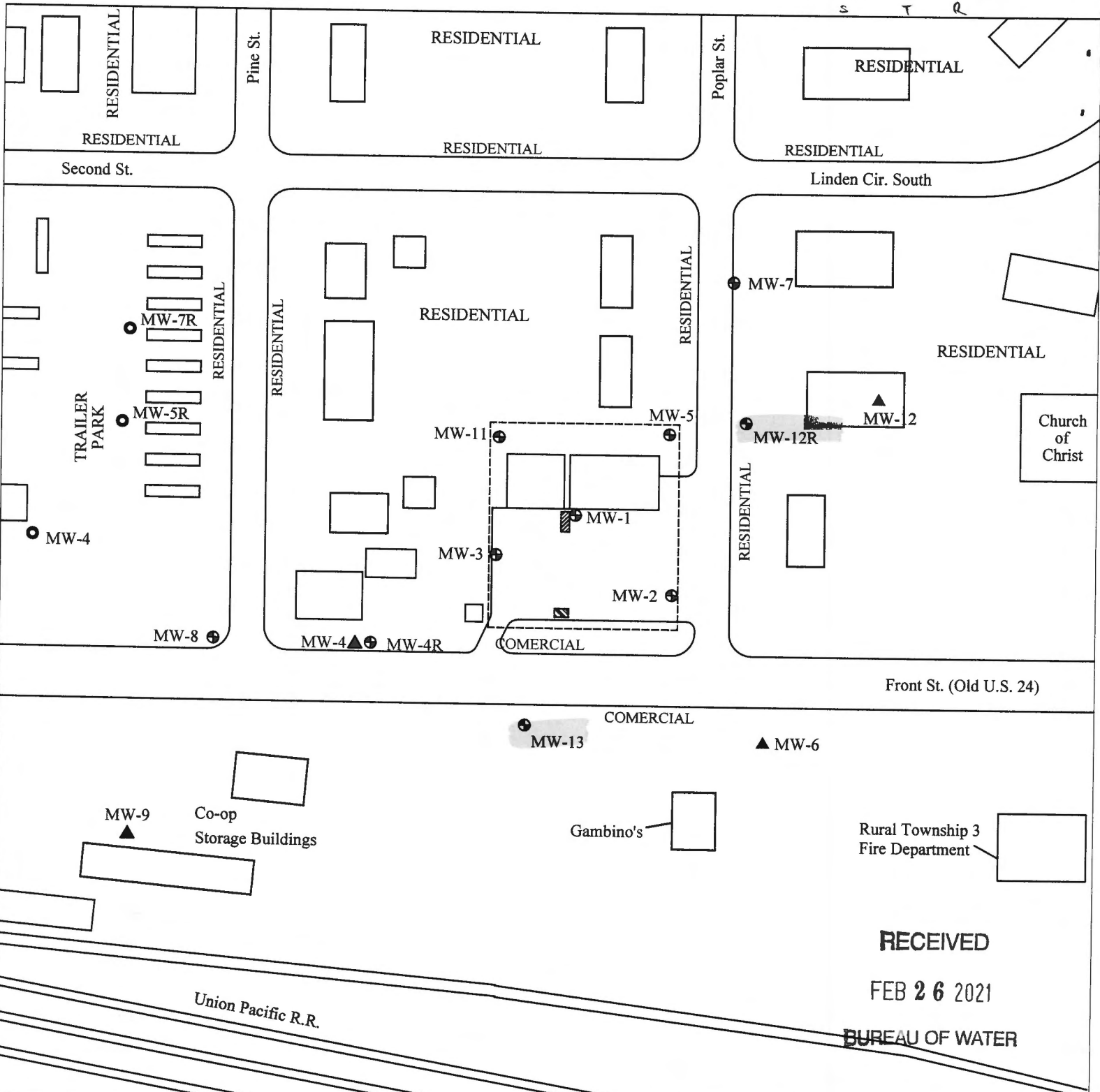

RECEIVED  
FEB 26 2021

BUREAU OF WATER

PROJECT: Perry County Shop  
 ADDRESS: Front Street  
 LOCATION: Perry, KS  
 DRAWN BY: MM DATE: 01/20/95  
 REVISED BY: J. Lang DATE: 1/27/21  
 AEI JOB #: TF157 KDHE JOB #: U4 044 1144

TITLE:  
 ASSOCIATED ENVIRONMENTAL INC.

LEGEND:  
 = Former 500 gallon gasoline UST  
 = Pump house for water  
 = Monitoring Well Locations  
 = Monitoring Well Locations (Bahnmaier, Earl - U4-044-10572)  
 = Plugged/Destroyed Well Locations  
 = Proposed well location  
 --- = Site Property Boundary

SCALE: 1"=100'-0"

NOTES: Date Sampled: 1/11/21  
 The former pump island & product line locations are not known

