

WATER WELL RECORD

Form WWC-5

Division of Water Resources App. No.

Well ID

MW3

Original Record Correction Change in Well Use

1 LOCATION OF WATER WELL: County Wyandotte Fraction SW 1/4 SE 1/4 NE 1/4 SW 1/4 Section Number 26 Township Number T 11 S Range Number R 23 E W

2 WELL OWNER: Last Name: Business: GLJ Enterprises, LLC Address: 1115 South 102 Terrace City: Edwardsville State: KS ZIP: 66111 Street or Rural Address where well is located (if unknown, distance and direction from nearest town or intersection): ~60' W of 10635 Kaw Dr., Edwardsville, KS

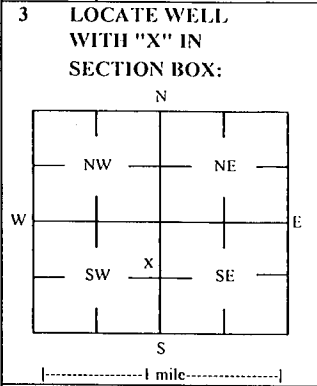

3 LOCATE WELL WITH "X" IN SECTION BOX: 4 DEPTH OF COMPLETED WELL: 48 ft Depth(s) Groundwater Encountered: 1) _____ ft 2) _____ ft 3) _____ ft, or 4) Dry Well WELLS STATIC WATER LEVEL: 40.41 ft. [X] below land surface, measured on (mo-day-yr) 2/27-28/20 [] above land surface, measured on (mo-day-yr) Pump test data: Well water was _____ ft after _____ hours pumping _____ gpm Water well was _____ ft after _____ hours pumping _____ gpm Estimated Yield: _____ gpm Bore Hole Diameter: 7.25 in to _____ ft, and _____ in to _____ ft

5 Latitude: 39.06256 (decimal degrees) Longitude: 94.82710 (decimal degrees) Horizontal Datum [X] WGS 84 [] NAD 83 [] NAD 27 Source for Latitude/Longitude: [] GPS (unit make/model: _____) (WAAS enabled? [] Yes [] No) [X] Land Survey [] Topographic Map [] Online Mapper

6 Elevation: 781.45 ft [] Ground Level [X] TOC Source [X] Land Survey [] GPS [] Topographic Map [] Other

7 WELL WATER TO BE USED AS: 1 Domestic: [] Household [] Lawn & Garden [] Livestock [] Irrigation [] Feedlot [] Industrial 2 Public Water Supply: well ID 3 Dewatering: how many wells? 4 Aquifer Recharge: well ID 5 Monitoring: well ID MW3 6 Environmental Remediation: well ID 7 Air Sparge [] Soil Vapor Extractor [] Recovery [] Injection 8 Oil Field Water Supply: lease 9 Test Hole: well ID [] Cased [] Uncased [] Geotechnical 10 Geothermal: How many bores? a) Closed Loop [] Horizontal [] Vertical b) Open Loop [] Surface Discharge [] Inj. of Water [] Other (specify): _____

Was a chemical/bacteriological sample submitted to KDHE? [] Yes [X] No If yes, date sample was submitted: _____ Water well disinfected? [] Yes [X] No

8 TYPE OF CASING USED: [] Steel [X] PVC [] Other CASING JOINTS: [] Glued [] Clamped [] Welded [X] Threaded Casing diameter 2 in. to 28 ft, Diameter _____ in. to _____ ft, Diameter _____ in. to _____ ft, Casing height above land surface -0.40 in. Weight _____ lbs./ft. Well thickness or gauge No _____ TYPE OF SCREEN OR PERFORATION MATERIAL: [] Steel [] Stainless Steel [] Fiberglass [X] PVC [] Brass [] Galvanized Steel [] Concrete tile [] None used (open hole) [] Other (Specify) _____ SCREEN OR PERFORATION OPENINGS ARE: [] Continuous Slot [X] Mill Slot [] Gauze Wrapped [] Torch Cut [] Drilled Holes [] Other (Specify) [] Louvered Shutter [] Key Punched [] Wire Wrapped [] Saw Cut [] None (Open Hole) SCREEN-PERFORATED INTERVALS: From 28 ft. to 48 ft, From _____ ft. to _____ ft, From _____ ft. to _____ ft, GRAVEL PACK INTERVALS: From 26 ft. to 48 ft, From _____ ft. to _____ ft, From _____ ft. to _____ ft,

9 GROUT MATERIAL: [] Neat cement [] Cement grout [X] Bentonite [X] Other Concrete: 0-0.5' Grout intervals: From 0.5 ft. to 26 ft, From _____ ft. to _____ ft, From _____ ft. to _____ ft,

Nearest source of possible contamination: [] Septic Tank [] Lateral Lines [] Pit Privy [] Livestock Pens [] Insecticide Storage [] Sewer Lines [] Cess Pool [] Sewage Lagoon [X] Fuel Storage [] Abandoned Water Well [] Watertight Sewer Lines [] Seepage Pit [] Feedyard [] Fertilizer Storage [] Oil Well / Gas Well [] Other (Specify) _____

Direction from well? NE Distance from well? ~100 ft

Table with columns: FROM, TO, LITHOLOGIC LOG, FROM, TO, LITHO. LOG (cont.) or PLUGGING INTERVALS. Rows: 0-0.3 Asphalt, 0.3-6 Gravel & fill soil, 6-24 Silty clay, 24-34 Silt, trace clay, 34-48 Coarse sand, 48-50 Limestone cobbles, sand

Notes: KDHE ID: GLJ Enterprises, LLC; U4-105-15164

11 CONTRACTOR'S OR LANDOWNER'S CERTIFICATION: This water well was [X] constructed, [] reconstructed, or [] plugged under my jurisdiction and was completed on (mo-day-year) 2/20/20 and this record is true to the best of my knowledge and belief. Kansas Water Well Contractor's License No 757 This Water Well Record was completed on (mo-day-year) 3/16/20 under the business name of Larsen & Associates, Inc. Signature _____

Mail 1 white copy along with a fee of \$5.00 for each constructed well to: Kansas Department of Health and Environment, Bureau of Water, GWTS Section, 1000 SW Jackson St., Suite 420, Topeka, Kansas 66612-1367. Mail one to Water Well Owner and retain one for your records. Telephone 785-296-5524.

WY Co

26-11-23 E

DENNIS L HANDKE

1820 NW 59th Terrace
TOPEKA, KANSAS 66618
785-286-4047 Home
785-286-1990 Fax

Jess Chapman
Larsen & Associates
1311 E. 25th Street, Suite B
Lawrence, Kansas, 66046

March 13, 2020

RE: Monitor Well Elevation Survey
10635 Kaw Drive, Edwardsville, Kansas

Proj. 20-00N
GLJ Enterprises, LLC
U4-105-15164

Bench Mark: Chisled X on top NW bolt of North leg on concrete sign base at Northeast corner of property.

Elev: 785.94 North 1702.61 West 2867.41 (from SE Cor. Sec. 26-11-23E)

MW-1	rim	784.88	North	1647.89	SW1/4,SE1/4,NE1/4,SW1/4
	top pipe	784.60	West	2979.46	Lat= 39.06266 Long = 94.82666
MW-2	rim	785.11	North	1715.45	NW1/4,SE1/4,NE1/4,SW1/4
	top pipe	784.80	West	2986.95	Lat= 39.06285 Long = 94.82669
MW-3	rim	781.84	North	1610.21	SW1/4,SE1/4,NE1/4,SW1/4
	top pipe	781.45	West	3105.10	Lat= 39.06256 Long = 94.82710
MW-4	rim	783.59	North	1728.81	NW1/4,SE1/4,NE1/4,SW1/4
	top pipe	783.13	West	3056.04	Lat= 39.06288 Long = 94.82693
MW-5	rim	785.35	North	1631.16	SE1/4,SE1/4,NE1/4,SW1/4
	top pipe	785.07	West	2891.77	Lat= 39.06261 Long = 94.82635
MW-6	rim	782.68	North	1565.41	SW1/4,SE1/4,NE1/4,SW1/4
	top pipe	782.16	West	3020.20	Lat= 39.06243 Long = 94.82680
MW-7	rim	784.35	North	1561.22	SE1/4,SE1/4,NE1/4,SW1/4
	top pipe	784.01	West	2916.10	Lat= 39.06242 Long = 94.82644

Lat & Long derived from Edwardsville 7.5' quad map. WGS 84.

Elevation established from Wyandotte County WY 49 NAVD 88.



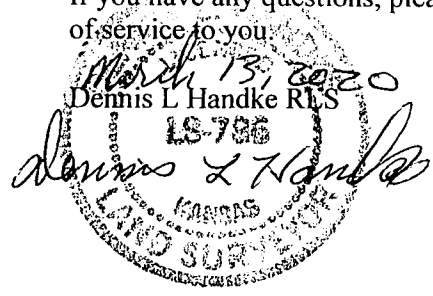

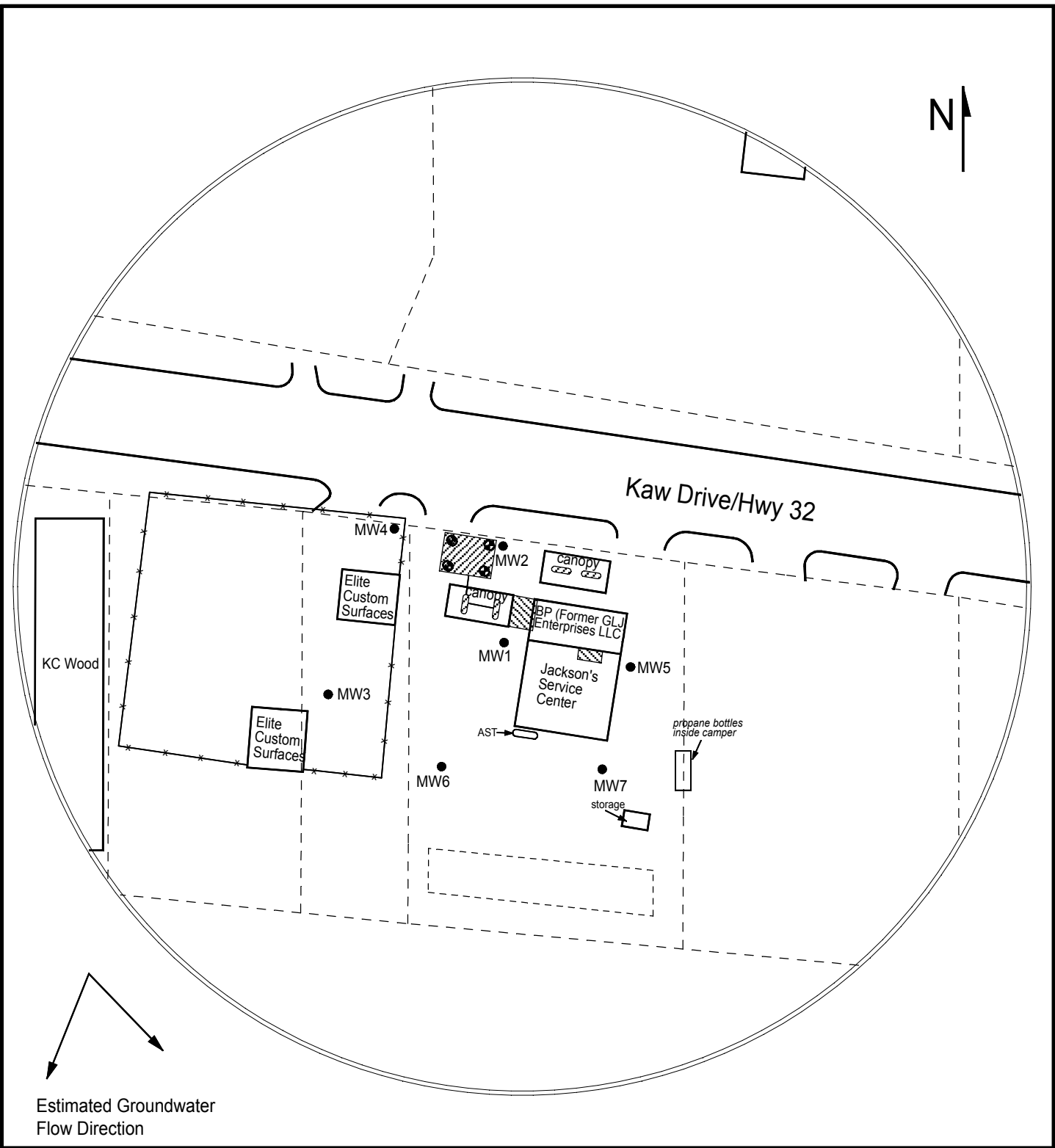
If you have any questions, please feel free to call me. Thank you for the opportunity to be of service to you.





Estimated Groundwater
Flow Direction

LEGEND:

-  Approximate Location of Active UST Basin, Product Lines & Pump Islands
-  Approximate Location of Former UST Basin
-  Approximate Location of Property Line
-  Observation Well
-  Existing Monitoring Well



PROJECT:
 GLJ Enterprises, LLC
 10635 Kaw Drive
 Edwardsville, KS
 KDHE ID: U4-105-15164
 Date: 5/27/20



1311 E 25th St. Suite B 785-841-8707 office
 Lawrence, KS 66046 785-865-4282 fax