

WATER WELL RECORD

Form WWC-5

Division of Water Resources App. No.

Well ID

MW5

Original Record Correction Change in Well Use

1 LOCATION OF WATER WELL: County Wyandotte Fraction SE ¼ SE ¼ NE ¼ SW ¼ Section Number 26 Township Number T 11 S Range Number R 23 E W

2 WELL OWNER: Last Name: First: Street or Rural Address where well is located (if unknown, distance and direction from nearest town or intersection): If at owner's address, check here:
 Business: GLJ Enterprises, LLC Address: 1115 South 102 Terrace 10635 Kaw Dr., Edwardsville, KS
 Address: City Edwardsville State: KS ZIP: 66111

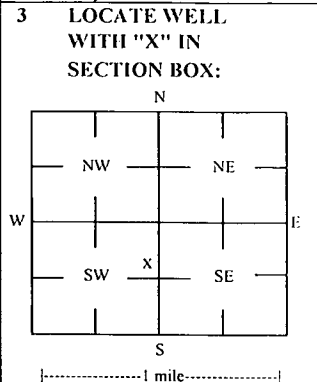

4 DEPTH OF COMPLETED WELL: 54 ft
 Depth(s) Groundwater Encountered: 1) _____ ft
 2) _____ ft 3) _____ ft, or 4) Dry Well
 WELL'S STATIC WATER LEVEL: 43.62 ft.
 below land surface, measured on (mo-day-yr) 2/27-28/20
 above land surface, measured on (mo-day-yr) _____
 Pump test data: Well water was _____ gpm after _____ hours pumping
 Water well was _____ ft after _____ hours pumping _____ gpm
 Estimated Yield: _____ gpm
 Bore Hole Diameter: 7.25 in to _____ ft, and _____ in to _____ ft

5 Latitude: 39.06261 (decimal degrees)
Longitude: 94.82635 (decimal degrees)
 Horizontal Datum: WGS 84 NAD 83 NAD 27
 Source for Latitude/Longitude: GPS (unit make/model: _____) (WAAS enabled? Yes No)
 Land Survey Topographic Map Online Mapper

6 Elevation: 785.07 ft Ground Level TOC
 Source: Land Survey GPS Topographic Map Other _____

7 WELL WATER TO BE USED AS:

1 Domestic: Household Lawn & Garden Livestock Irrigation Feedlot Industrial

2 Public Water Supply: well ID _____
 3 Dewatering: how many wells? _____
 4 Aquifer Recharge: well ID _____
 5 Monitoring: well ID **MW5**
 6 Environmental Remediation: well ID _____
 7 Air Sparge Soil Vapor Extractor Recovery Injection

8 Oil Field Water Supply: lease _____
 9 Test Hole: well ID _____
 10 Cased Uncased Geotechnical
 11 Geothermal: How many bores? _____
 a) Closed Loop Horizontal Vertical
 b) Open Loop Surface Discharge Inj. of Water
 12 Other (specify): _____

Was a chemical/bacteriological sample submitted to KDHE? Yes No If yes, date sample was submitted: _____
 Water well disinfected? Yes No

8 TYPE OF CASING USED: Steel PVC Other _____ CASING JOINTS: Glued Clamped Welded Threaded
 Casing diameter 2 in. to 34 ft, Diameter _____ in. to _____ ft, Diameter _____ in. to _____ ft,
 Casing height above land surface -0.28 in. Weight _____ lbs./ft. Well thickness or gauge No _____

TYPE OF SCREEN OR PERFORATION MATERIAL:
 Steel Stainless Steel Fiberglass PVC Other (Specify) _____
 Brass Galvanized Steel Concrete tile None used (open hole)

SCREEN OR PERFORATION OPENINGS ARE:
 Continuous Slot Mill Slot Gauze Wrapped Torch Cut Drilled Holes Other (Specify) _____
 Louvered Shutter Key Punched Wire Wrapped Saw Cut None (Open Hole)

SCREEN-PERFORATED INTERVALS: From 34 ft. to 54 ft., From _____ ft. to _____ ft., From _____ ft. to _____ ft.,
GRAVEL PACK INTERVALS: From 32 ft. to 54 ft., From _____ ft. to _____ ft., From _____ ft. to _____ ft.,

9 GROUT MATERIAL: Neat cement Cement grout Bentonite Other Concrete: 0-0.5'
 Grout intervals: From 0.5 ft. to 32 ft., From _____ ft. to _____ ft., From _____ ft. to _____ ft.,

Nearest source of possible contamination:
 Septic Tank Lateral Lines Pit Privy Livestock Pens Insecticide Storage
 Sewer Lines Cess Pool Sewage Lagoon Fuel Storage Abandoned Water Well
 Watertight Sewer Lines Seepage Pit Feedyard Fertilizer Storage Oil Well / Gas Well
 Other (Specify) _____

Direction from well? W Distance from well? ~20 ft

10 FROM	TO	LITHOLOGIC LOG	FROM	TO	LITHO. LOG (cont.) or PLUGGING INTERVALS
0	0.3	Asphalt			
0.3	1	Fill, gravel			
1	9	Silty clay			
9	11	Silty clay, high silt, trace clay			
11	35	Very fine silt			
35	40	Fine sand			
40	54	Fine to medium fine gravel			

Notes: KDHE ID: GLJ Enterprises, LLC; U4-105-15164

11 CONTRACTOR'S OR LANDOWNER'S CERTIFICATION: This water well was constructed, reconstructed, or plugged under my jurisdiction and was completed on (mo-day-year) 2/18/20 and this record is true to the best of my knowledge and belief. Kansas Water Well Contractor's License No 757 This Water Well Record was completed on (mo-day-year) 3/16/20 under the business name of Larsen & Associates, Inc. Signature _____

Mail 1 white copy along with a fee of \$5.00 for each constructed well to: Kansas Department of Health and Environment, Bureau of Water, GWWS Section, 1000 SW Jackson St., Suite 420, Topeka, Kansas 66612-1367. Mail one to Water Well Owner and retain one for your records. Telephone 785-296-5524.

WY Co

26-11-23 E

DENNIS L HANDKE

1820 NW 59th Terrace
TOPEKA, KANSAS 66618
785-286-4047 Home
785-286-1990 Fax

Jess Chapman
Larsen & Associates
1311 E. 25th Street, Suite B
Lawrence, Kansas, 66046

March 13, 2020

RE: Monitor Well Elevation Survey
10635 Kaw Drive, Edwardsville, Kansas

Proj. 20-00N
GLJ Enterprises, LLC
U4-105-15164

Bench Mark: Chisled X on top NW bolt of North leg on concrete sign base at Northeast corner of property.

Elev: 785.94 North 1702.61 West 2867.41 (from SE Cor. Sec. 26-11-23E)

MW-1	rim	784.88	North	1647.89	SW1/4,SE1/4,NE1/4,SW1/4
	top pipe	784.60	West	2979.46	Lat= 39.06266 Long = 94.82666
MW-2	rim	785.11	North	1715.45	NW1/4,SE1/4,NE1/4,SW1/4
	top pipe	784.80	West	2986.95	Lat= 39.06285 Long = 94.82669
MW-3	rim	781.84	North	1610.21	SW1/4,SE1/4,NE1/4,SW1/4
	top pipe	781.45	West	3105.10	Lat= 39.06256 Long = 94.82710
MW-4	rim	783.59	North	1728.81	NW1/4,SE1/4,NE1/4,SW1/4
	top pipe	783.13	West	3056.04	Lat= 39.06288 Long = 94.82693
MW-5	rim	785.35	North	1631.16	SE1/4,SE1/4,NE1/4,SW1/4
	top pipe	785.07	West	2891.77	Lat= 39.06261 Long = 94.82635
MW-6	rim	782.68	North	1565.41	SW1/4,SE1/4,NE1/4,SW1/4
	top pipe	782.16	West	3020.20	Lat= 39.06243 Long = 94.82680
MW-7	rim	784.35	North	1561.22	SE1/4,SE1/4,NE1/4,SW1/4
	top pipe	784.01	West	2916.10	Lat= 39.06242 Long = 94.82644

Lat & Long derived from Edwardsville 7.5' quad map. WGS 84.

Elevation established from Wyandotte County WY 49 NAVD 88.



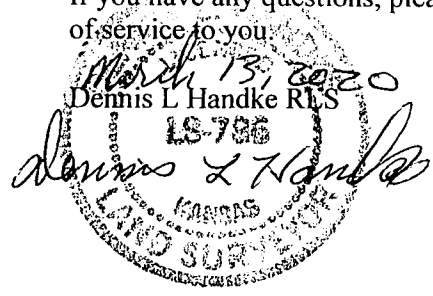

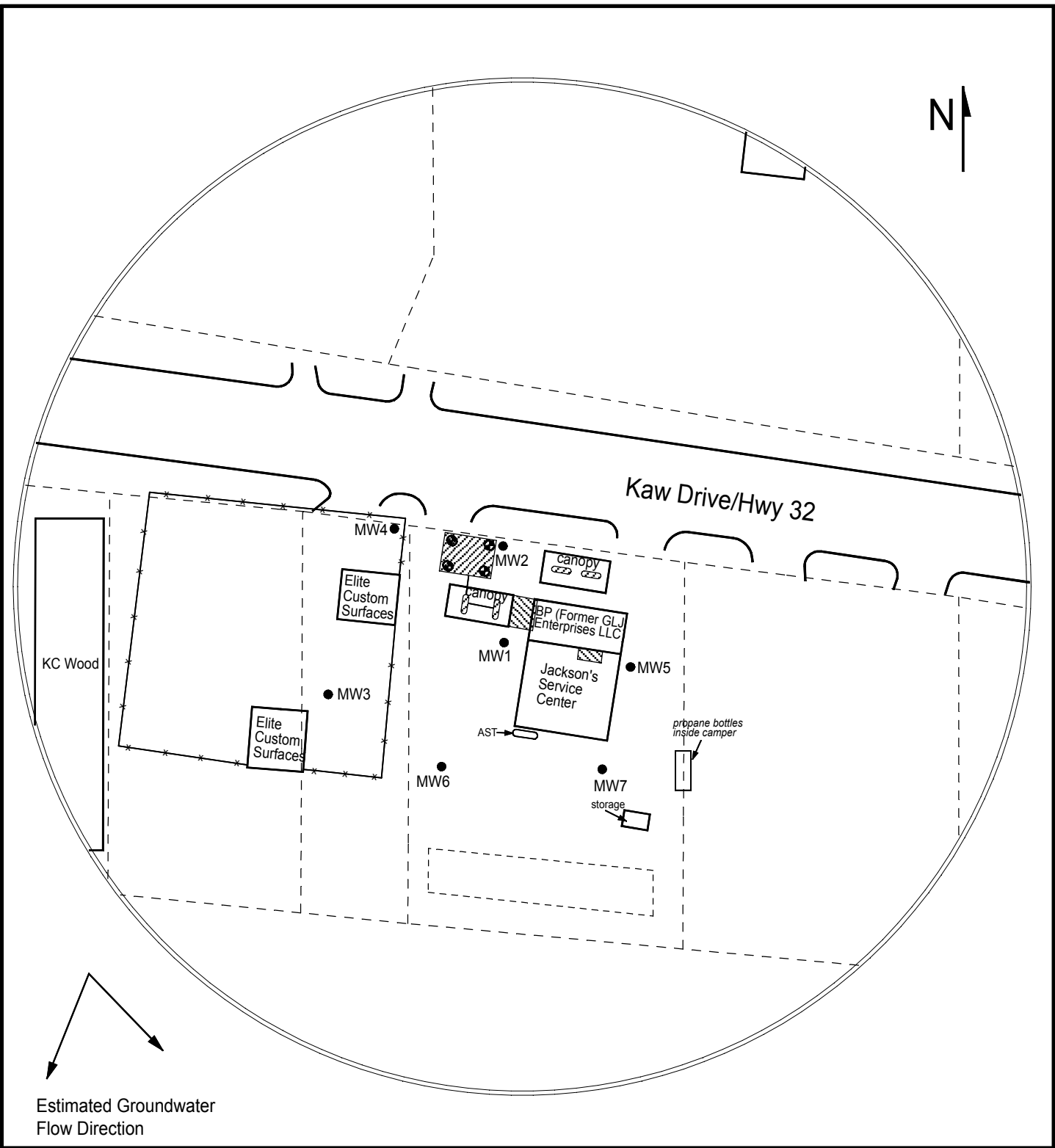
If you have any questions, please feel free to call me. Thank you for the opportunity to be of service to you.





Estimated Groundwater
Flow Direction

LEGEND:

-  Approximate Location of Active UST Basin, Product Lines & Pump Islands
-  Approximate Location of Former UST Basin
-  Approximate Location of Property Line
-  Observation Well
-  Existing Monitoring Well



PROJECT:
 GLJ Enterprises, LLC
 10635 Kaw Drive
 Edwardsville, KS
 KDHE ID: U4-105-15164
 Date: 5/27/20



1311 E 25th St. Suite B 785-841-8707 office
 Lawrence, KS 66046 785-865-4282 fax