

WATER WELL RECORD

Form WWC-5

Division of Water Resources App. No.

Well ID

MW7

Original Record Correction Change in Well Use

1 LOCATION OF WATER WELL: County Wyandotte Fraction SE 1/4 SE 1/4 NE 1/4 SW 1/4 Section Number 26 Township Number T 11 S Range Number R 23 E W

2 WELL OWNER: Last Name: Business: GLJ Enterprises, LLC Address: 1115 South 102 Terrace City: Edwardsville State: KS ZIP: 66111 Street or Rural Address where well is located (if unknown, distance and direction from nearest town or intersection): 10635 Kaw Dr., Edwardsville, KS

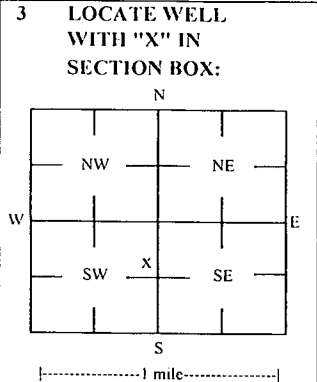

3 LOCATE WELL WITH "X" IN SECTION BOX: 4 DEPTH OF COMPLETED WELL: 53 ft Depth(s) Groundwater Encountered: 1) 53 ft 2) ft 3) ft, or 4) Dry Well WELL'S STATIC WATER LEVEL: 42.63 ft. X below land surface, measured on (mo-day-yr) 2/27-28/20

5 Latitude: 39.06242 (decimal degrees) Longitude: 94.82644 (decimal degrees) Horizontal Datum: X WGS 84 Source for Latitude/Longitude: X Land Survey 6 Elevation: 784.01 ft Ground Level: X TOC Source: X Land Survey

7 WELL WATER TO BE USED AS: 1 Domestic: Household Lawn & Garden Livestock Irrigation Feedlot Industrial 2 Public Water Supply: well ID 3 Dewatering: how many wells? 4 Aquifer Recharge: well ID 5 Monitoring: well ID MW7 6 Environmental Remediation: well ID 7 Air Sparge 8 Soil Vapor Extractor 9 Recovery 10 Injection 10 Oil Field Water Supply: lease 11 Test Hole: well ID 12 Geothermal: How many bores? a) Closed Loop b) Open Loop

Was a chemical/bacteriological sample submitted to KDHE? Yes No Water well disinfected? Yes No If yes, date sample was submitted:

8 TYPE OF CASING USED: Steel PVC Other CASING JOINTS: Glued Clamped Welded Threaded Casing diameter 2 in. to 33 ft. Diameter in. to ft. Casing height above land surface -0.34 in. Weight lbs./ft. Well thickness or gauge No TYPE OF SCREEN OR PERFORATION MATERIAL: Steel Stainless Steel Fiberglass PVC Brass Galvanized Steel Concrete tile None used (open hole) SCREEN OR PERFORATION OPENINGS ARE: Continuous Slot Mill Slot Gauze Wrapped Torch Cut Drilled Holes Louvered Shutter Key Punched Wire Wrapped Saw Cut None (Open Hole) SCREEN-PERFORATED INTERVALS: From 33 ft. to 53 ft. GRAVEL PACK INTERVALS: From 31 ft. to 53 ft.

9 GROUT MATERIAL: Neat cement Cement grout Bentonite Other Concrete: 0-0.5' Grout intervals: From 0.5 ft. to 31 ft. From ft. to ft. From ft. to ft.

Nearest source of possible contamination: Septic Tank Lateral Lines Pit Privy Livestock Pens Insecticide Storage Sewer Lines Cess Pool Sewage Lagoon Fuel Storage Abandoned Water Well Watertight Sewer Lines Seepage Pit Feedyard Fertilizer Storage Oil Well / Gas Well Other (Specify) Direction from well? N Distance from well? ~80 ft

Table with 6 columns: FROM, TO, LITHOLOGIC LOG, FROM, TO, LITHO. LOG (cont.) or PLUGGING INTERVALS. Rows include Asphalt, Fill, gravel, Silty clay, Clayey silt, Limestone cobbles.

Notes: KDHE ID: GLJ Enterprises, LLC; U4-105-15164

11 CONTRACTOR'S OR LANDOWNER'S CERTIFICATION: This water well was constructed, reconstructed, or plugged under my jurisdiction and was completed on (mo-day-year) 2/20/20 and this record is true to the best of my knowledge and belief. Kansas Water Well Contractor's License No 757 This Water Well Record was completed on (mo-day-year) 3/16/20 under the business name of Larsen & Associates, Inc. Signature

WY Co

26-11-23 E

DENNIS L HANDKE

1820 NW 59th Terrace
TOPEKA, KANSAS 66618
785-286-4047 Home
785-286-1990 Fax

Jess Chapman
Larsen & Associates
1311 E. 25th Street, Suite B
Lawrence, Kansas, 66046

March 13, 2020

RE: Monitor Well Elevation Survey
10635 Kaw Drive, Edwardsville, Kansas

Proj. 20-00N
GLJ Enterprises, LLC
U4-105-15164

Bench Mark: Chisled X on top NW bolt of North leg on concrete sign base at Northeast corner of property.

Elev: 785.94 North 1702.61 West 2867.41 (from SE Cor. Sec. 26-11-23E)

MW-1	rim	784.88	North	1647.89	SW1/4,SE1/4,NE1/4,SW1/4
	top pipe	784.60	West	2979.46	Lat= 39.06266 Long = 94.82666
MW-2	rim	785.11	North	1715.45	NW1/4,SE1/4,NE1/4,SW1/4
	top pipe	784.80	West	2986.95	Lat= 39.06285 Long = 94.82669
MW-3	rim	781.84	North	1610.21	SW1/4,SE1/4,NE1/4,SW1/4
	top pipe	781.45	West	3105.10	Lat= 39.06256 Long = 94.82710
MW-4	rim	783.59	North	1728.81	NW1/4,SE1/4,NE1/4,SW1/4
	top pipe	783.13	West	3056.04	Lat= 39.06288 Long = 94.82693
MW-5	rim	785.35	North	1631.16	SE1/4,SE1/4,NE1/4,SW1/4
	top pipe	785.07	West	2891.77	Lat= 39.06261 Long = 94.82635
MW-6	rim	782.68	North	1565.41	SW1/4,SE1/4,NE1/4,SW1/4
	top pipe	782.16	West	3020.20	Lat= 39.06243 Long = 94.82680
MW-7	rim	784.35	North	1561.22	SE1/4,SE1/4,NE1/4,SW1/4
	top pipe	784.01	West	2916.10	Lat= 39.06242 Long = 94.82644

Lat & Long derived from Edwardsville 7.5' quad map. WGS 84.

Elevation established from Wyandotte County WY 49 NAVD 88.



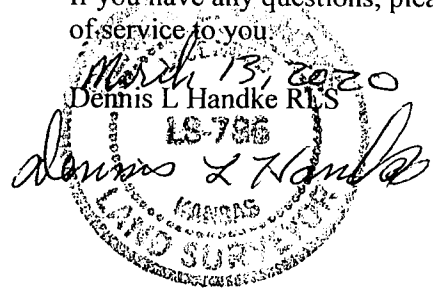

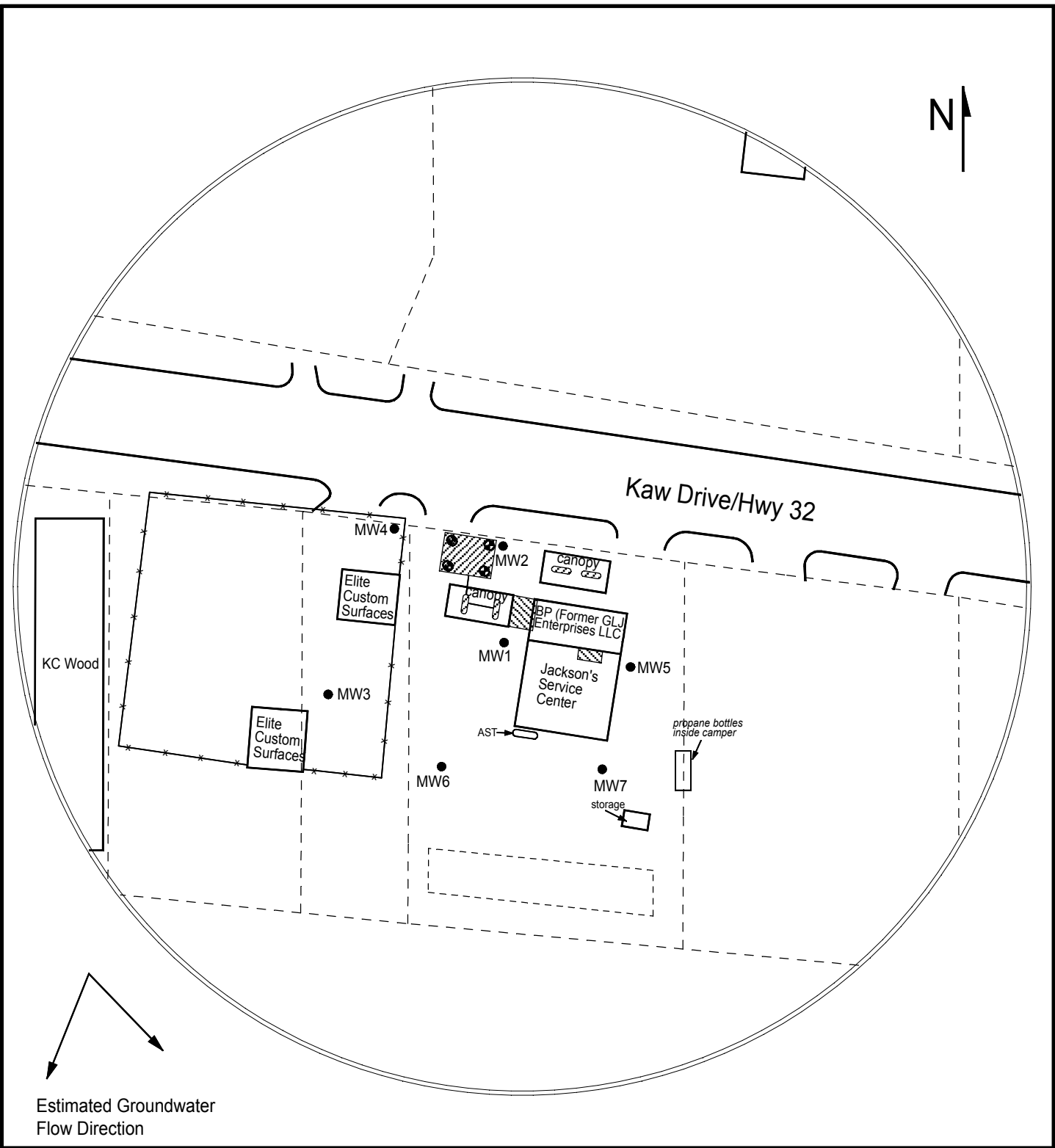
If you have any questions, please feel free to call me. Thank you for the opportunity to be of service to you.





Estimated Groundwater
Flow Direction

LEGEND:

-  Approximate Location of Active UST Basin, Product Lines & Pump Islands
-  Approximate Location of Former UST Basin
-  Approximate Location of Property Line
-  Observation Well
-  Existing Monitoring Well



PROJECT:
 GLJ Enterprises, LLC
 10635 Kaw Drive
 Edwardsville, KS
 KDHE ID: U4-105-15164
 Date: 5/27/20



1311 E 25th St. Suite B 785-841-8707 office
 Lawrence, KS 66046 785-865-4282 fax