

WATER WELL RECORD

Form WWC-5

Division of Water Resources App. No.

Well ID

TMW8

Original Record Correction Change in Well Use

1 LOCATION OF WATER WELL: County Wyandotte Fraction NW 1/4 NW 1/4 NW 1/4 NW 1/4 Section Number 9 Township Number T 11 S Range Number R 23 E W

2 WELL OWNER: Last Name: First: Street or Rural Address where well is located (if unknown, distance and direction from nearest town or intersection): If at owner's address, check here: 1730 Minnesota Ave, Kansas City, KS

3 LOCATE WELL WITH "X" IN SECTION BOX: N NW NE SW SE S

4 DEPTH OF COMPLETED WELL: 20 ft Depth(s) Groundwater Encountered: 1) 2) 3) 4) Dry Well WELL'S STATIC WATER LEVEL: 8.32 ft

5 Latitude: 39.11598 (decimal degrees) Longitude: 94.64925 (decimal degrees) Horizontal Datum: X WGS 84 NAD 83 NAD 27 Source for Latitude/Longitude: GPS (unit make/model): Land Survey Topographic Map Online Mapper

7 WELL WATER TO BE USED AS: 1 Domestic: Household Lawn & Garden Livestock Irrigation Feedlot Industrial 5 Public Water Supply: well ID 6 Dewatering: how many wells? 7 Aquifer Recharge: well ID 8 Monitoring: well ID TMW8 9 Environmental Remediation: well ID Air Sparge Soil Vapor Extractor Recovery Injection 10 Oil Field Water Supply: lease 11 Test Hole: well ID Cased Uncased Geotechnical 12 Geothermal: How many bores? a) Closed Loop Horizontal Vertical b) Open Loop Surface Discharge Inj. of Water Other (specify):

Was a chemical/bacteriological sample submitted to KDHE? Yes No If yes, date sample was submitted: Water well disinfected? Yes No

8 TYPE OF CASING USED: Steel PVC Other CASING JOINTS: Glued Clamped Welded Threaded Casing diameter 2 in. to 8 ft, Diameter in. to ft, Diameter in. to ft, Well thickness or gauge No TYPE OF SCREEN OR PERFORATION MATERIAL: Steel Stainless Steel Fiberglass PVC Other (Specify) SCREEN OR PERFORATION OPENINGS ARE: Continuous Slot Mill Slot Gauze Wrapped Torch Cut Drilled Holes Other (Specify) Louvered Shutter Key Punched Wire Wrapped Saw Cut None (Open Hole) SCREEN-PERFORATED INTERVALS: From 8 ft. to 20 ft, From ft. to ft, From ft. to ft, GRAVEL PACK INTERVALS: From 6 ft. to 20 ft, From ft. to ft, From ft. to ft,

9 GROUT MATERIAL: Neat cement Cement grout Bentonite Other Concrete: 0-1' Grout intervals: From 1 ft. to 6 ft, From ft. to ft, From ft. to ft,

Nearest source of possible contamination: Septic Tank Lateral Lines Pit Privy Livestock Pens Insecticide Storage Sewer Lines Cess Pool Sewage Lagoon Fuel Storage Abandoned Water Well Watertight Sewer Lines Seepage Pit Feedyard Fertilizer Storage Oil Well / Gas Well Other (Specify): Direction from well? E-SE Distance from well? ~50 ft

Table with columns: FROM, TO, LITHOLOGIC LOG, FROM, TO, LITHO. LOG (cont.) or PLUGGING INTERVALS. Rows: 0 to 0.5 Concrete, 0.5 to 1 Gravel fill, 1 to 24.5 Silty clay

Notes: KDHE ID: Taystee Fresh Bread; U4-105-01312 Target of monitoring well is shallow groundwater, <20' of grout was installed at the direction of KDHE.

11 CONTRACTOR'S OR LANDOWNER'S CERTIFICATION: This water well was constructed, reconstructed, or plugged under my jurisdiction and was completed on (mo-day-year) 9/2/20 and this record is true to the best of my knowledge and belief. Kansas Water Well Contractor's License No 757 This Water Well Record was completed on (mo-day-year) 11/4/20 under the business name of Larsen & Associates, Inc. Signature

DENNIS L HANDKE

1820 NW 59th Terrace
TOPEKA, KANSAS 66618
785-286-4047 Home

Jess Chapman
Larsen & Associates
1311 E. 25th Street, Suite B
Lawrence, Kansas, 66046

November 4, 2020

RE: Monitor Well Elevation Survey
1730 Minnesota Ave., Kansas City, Kansas

Proj. 20-00YY
Taystee Fresh Bread
U4-105-01312

Bench Mark: Chisled Square on Northeast corner of concrete signal light base at Southwest corner of property.

Elev: 846.93 North 4867.49 West 5229.25 (from SE Cor. Sec. 9-11-23E)

TMW-1	rim	846.46	North	4974.41	NW1/4,NW1/4,NW1/4,NW1/4
	top pipe	845.99	West	5143.38	Lat= 39.11599 Long = 94.64894
TMW-2	rim	850.37	North	4952.01	NW1/4,NW1/4,NW1/4,NW1/4
	top pipe	850.01	West	5186.34	Lat= 39.11593 Long = 94.64909
TMW-4	rim	846.54	North	4864.66	SW1/4,NW1/4,NW1/4,NW1/4
	top pipe	846.15	West	5189.55	Lat= 39.11569 Long = 94.64910
TMW-5	rim	845.92	North	4748.75	SE1/4,NE1/4,NE1/4,NE1/4 (Sec. 8-11-23E)
	top pipe	845.43	West	5292.05	Lat= 39.11537 Long = 94.64946
TMW-6	rim	839.62	North	5209.95	SE1/4,SW1/4,SW1/4,SW1/4 (Sec. 4-11-23E)
	top pipe	839.16	West	4787.04	Lat= 39.11663 Long = 94.64768
TMW-7	rim	847.58	North	4773.77	SW1/4,NW1/4,NW1/4,NW1/4
	top pipe	847.21	West	5117.14	Lat= 39.11544 Long = 94.64885
TMW-8	rim	853.05	North	4972.08	NW1/4,NW1/4,NW1/4,NW1/4
	top pipe	852.64	West	5231.77	Lat= 39.11598 Long = 94.64925
TMW-10	rim	842.29	North	5141.57	NE1/4,NW1/4,NW1/4,NW1/4
	top pipe	841.65	West	4698.84	Lat= 39.11644 Long = 94.64737

Lat & Long derived from Shawnee 7.5 quad map. WGS84.

Elevation established from USGS BM T 281 NAVD 88

If you have any questions, please feel free to call me. Thank you for the opportunity to be of service to you.

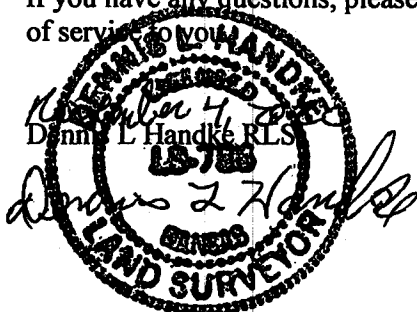

NOTE: Figures exhibited within this report are only to be used within the context of this report. Placement of property lines, wells, structures, and roads is based on the available information from county appraiser maps, surveys, site visits, and/or previous vendor reports and should be considered approximate.

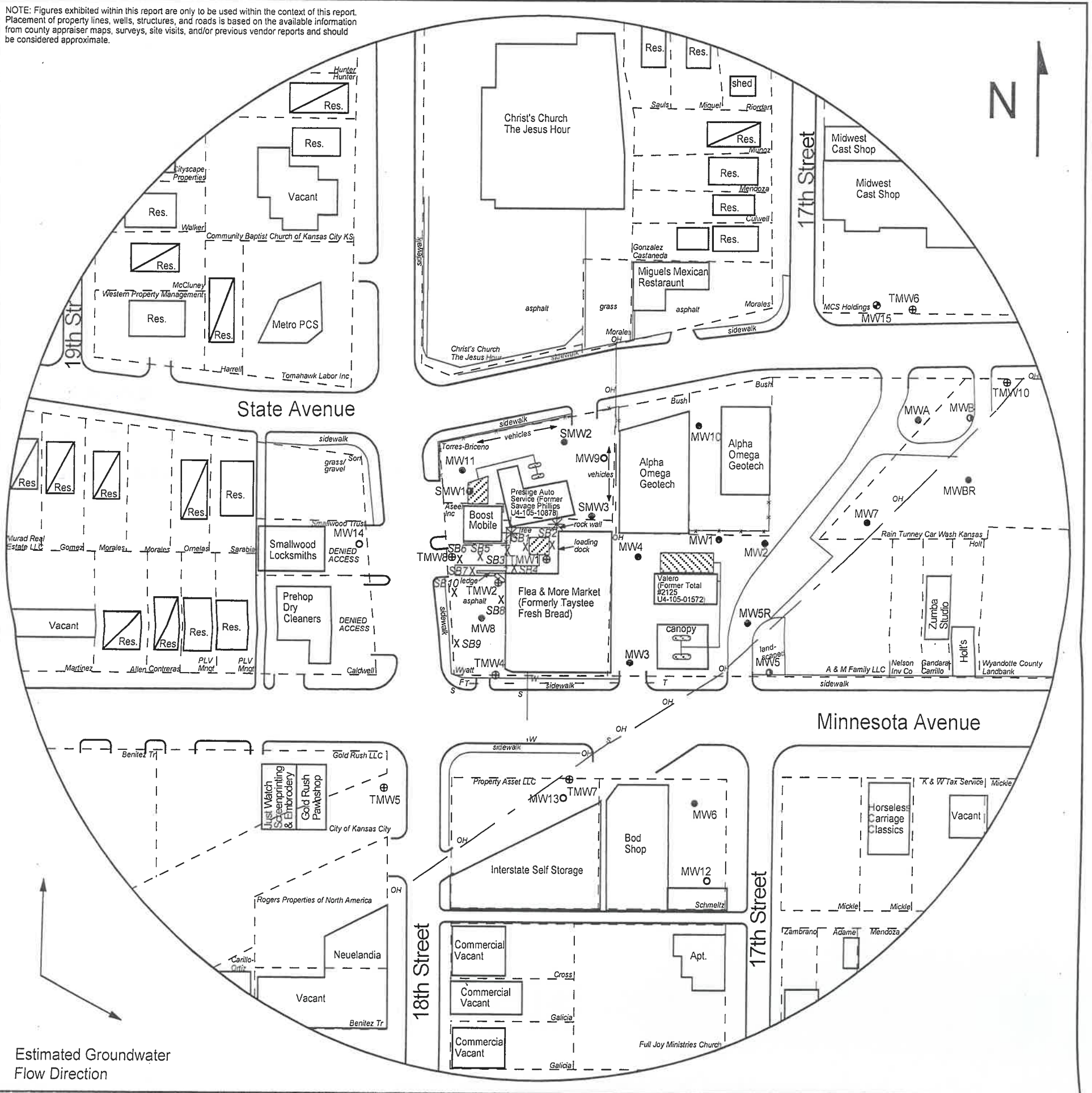

FIGURE 2.2 - 500 FT RADIUS AREA BASE MAP



1311 E 25th St., Suite B
Lawrence, KS 66046

785-841-8707 office
785-865-4282 fax

PROJECT:
 Taystee Fresh Bread
 1730 Minnesota Ave.
 Kansas City, KS
 KDHE ID: U4-105-01312
 Date: 10/13/20

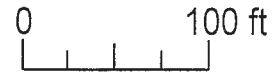

- LEGEND**
- Approximate Location of Former UST Basin, Product Lines & Pump Islands
 - Approximate Location of Active UST Basin, Product Lines & Pump Islands
 - Building with Basement
 - Approximate Location of Property Line
 - Existing Monitoring Well
 - Plugged/Destroyed Well
 - Destroyed Well
 - Abandoned Well
 - Monitoring Well (Installed 8/31/20, 9/1-3/20, 10/13/20)
 - Soil Boring (Drilled 8/31/20, 9/1-2/20)
 - Fire Hydrant
 - Sewer Inlet
 - Overhead Lines (25'-40' high)
 - Telephone Lines (2 - 6 ft bgs)
 - Water Lines (2 - 6 ft bgs)

NOTE: SB1 & SB2 were drilled on 8/31/20.