

WATER WELL PLUGGING RECORD Form WWC-5P

KSA 82a-1212 ID NO.

1 LOCATION OF WATER WELL:
 County: WYANDOTTE Fraction SE 1/4 SE 1/4 SE 1/4 Section Number 11 Township Number 11S Range Number 24 E/W
 Distance and direction from nearest town or city street address of well if located within city? LI-70 & 57th ST.
NEAR 5525 KAW DR., KANSAS CITY, KS 66102

2 WATER WELL OWNER: CONOCO PHILLIPS
 RR#, St. Address, Box #: 1366 PHILLIPS BLDG.
 City, State ZIP Code: BARTLESVILLE, OK 74004
 Global Positioning Systems (decimal degrees, min. of 4 digits)
 Latitude: N 39° 6' 13.05"
 Longitude: W 94° 42' 24.39"
 Elevation: _____
 Datum: _____
 Data Collection Method: _____

3 MARK WELL'S LOCATION WITH AN "X" IN SECTION BOX:

N			
W	NW	NE	E
	SW	SE	
S			

X

4 DEPTH OF WELL 40 ft.
 WELL'S STATIC WATER LEVEL _____ ft.
 WELL WAS USED AS:
 1 Domestic 5 Public Water Supply 9 Dewatering
 2 Irrigation 6 Oil Field Water Supply 10 Monitoring #N-5
 3 Feedlot 7 Domestic (Lawn & Garden) 11 Injection Well
 4 Industrial 8 Air Conditioning 12 Other _____
 Was a chemical/bacteriological sample submitted to Department? Yes _____ No

5 TYPE OF BLANK CASING USED:
 1 Steel 3 RMP (SR) 5 Wrought 7 Fiberglass 9 Other (Specify below)
2 PVC 4 ABS 6 Asbestos-Cement 8 Concrete Tile
 Blank casing diameter 2 in. Was casing pulled? Yes No _____ If yes, how much 3'
 Casing height above or below land surface _____ in.

6 GROUT PLUG MATERIAL: 1 Neat cement 2 Cement grout 3 Bentonite 4 Other _____
 Grout Plug Intervals: From 0 ft. to 40 ft., From _____ ft. to _____ ft., From _____ to _____ ft.
 What is the nearest source of possible contamination:
 1 Septic tank 6 Seepage pit 11 Fuel Storage 16 Other (specify below) FORMER PIPELINE RELEASE
 2 Sewer lines 7 Pit privy 12 Fertilizer storage
 3 Watertight sewer lines 8 Sewage lagoon 13 Insecticide storage
 4 Lateral lines 9 Feedyard 14 Abandoned water well Direction from well? WEST
 5 Cess pool 10 Livestock pens 15 Oil well/Gas well How many feet? ~600'

FROM	TO	PLUGGING MATERIALS	FROM	TO	PLUGGING MATERIALS

7 CONTRACTOR'S OR LANDOWNER'S CERTIFICATION: This water well was plugged under my jurisdiction and was completed on (mo/day/year) 4/22/09 and this record is true to the best of my knowledge and belief. Kansas Water Well Contractor's License No. 788. This Water Well Record was completed on (mo/day/year) 5/19/09 under the business name of ROBERTS ENV. DRILLING, INC. by (signature) Charley W. Roberts

INSTRUCTIONS: Use typewriter or ballpoint pen. Please press firmly and print clearly. Please fill in blanks, underline or circle the correct answers. Send top three copies to Kansas Department of Health and Environment, Bureau of Water, Geology Section, 1000 SW Jackson St., Ste. 420, Topeka, Kansas 66612-1367. Telephone: 785/296-5522. Send one to Water Well Owner and retain one for your records. Visit us at <http://www.kdheks.gov/geo/waterwells>.

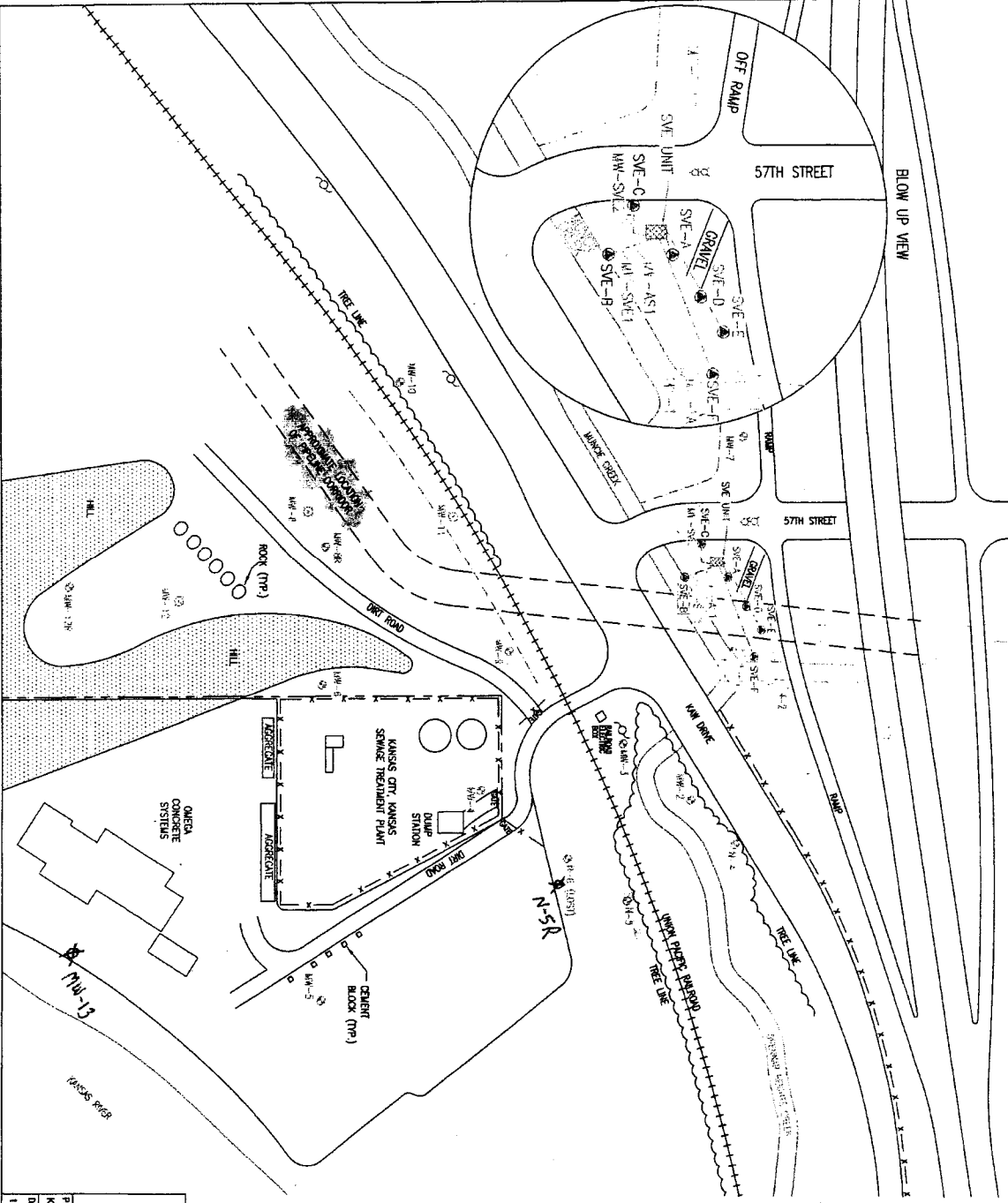

BLOW UP VIEW

LEGEND

- SVE-1 SVE APPROX OPERATIONAL POINT
- APPROXIMATE PRELUDE LOCATION
- 1/2" BOREHOLE PERFORATION
- 6" BOREHOLE PERFORATION
- 4 FT. TRENCH
- RAINWATER FLOW
- LEAK FLOW

ABANDONED WELL
MONITORING WELLS

MWD-14

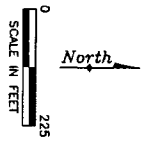

PHILLIPS PIPELINE 1-70 AND 37TH STREET KANSAS CITY, KANSAS			
FIGURE 1 SITE MAP			
PROJECT NO. KS233-5812-0	PREPARED BY DP	ISSUED BY DRE/JH	FILE NAME KS2335805SM
DATE 1/7/08	