

**WATER WELL RECORD Form WWC-5**

Original Record  Correction  Change in Well Use

Division of Water Resources App. No.  

Well ID  

<b>1 LOCATION OF WATER WELL:</b> County: <b>Wyandotte</b>	Fraction SE ¼ NE ¼ SW ¼ ¼	Section Number <b>22</b>	Township Number T <b>11</b> S	Range Number R <b>24</b> <input checked="" type="checkbox"/> E <input type="checkbox"/> W
--	------------------------------	-----------------------------	----------------------------------	--

<b>2 WELL OWNER:</b> Last Name <b>Water District No. 1 of Johnson County</b> Business Address <b>7601 Holliday Drive</b> Address City: <b>Kansas City</b> State: <b>KS</b> ZIP: <b>66106</b>	Street or Rural Address where well is located (if unknown, distance and direction from nearest town or intersection): If at owner's address, check here: <input type="checkbox"/> <b>1.2 miles northeast of intersection of Douglas Ave and South 74th Street</b>
---	--

**3 LOCATE WELL WITH "X" IN SECTION BOX:**

N

NW	NE
SW	SE

S

-----1 mile-----

**4 DEPTH OF COMPLETED WELL:** ..... **55** ..... ft.

Depth(s) Groundwater Encountered: 1) ..... ft.  
2) ..... ft. 3) ..... ft. or 4)  Dry Well

WELL'S STATIC WATER LEVEL: ..... **29.2** ..... ft.  
 below land surface, measured on (mo-day-yr) **9/26/2017**  
 above land surface, measured on (mo-day-yr) .....

Pump test data: Well water was ..... **40** ..... ft.  
after ..... **72** ..... hours pumping **3830** ..... gpm  
Well water was ..... ft.  
after ..... hours pumping ..... gpm

Estimated Yield: **3820** gpm  
Bore Hole Diameter: ..... **234** ..... in. to ..... **55** ..... ft. and  
..... in. to ..... ft.

**5 Latitude:** ..... **39.0776** ..... (decimal degrees)  
**Longitude:** ..... **-94.7349** ..... (decimal degrees)  
Horizontal Datum:  WGS 84  NAD 83  NAD 27  
Source for Latitude/Longitude:  
 GPS (unit make/model: .....)  
(WAAS enabled?  Yes  No)  
 Land Survey  Topographic Map  
 Online Mapper: **Google Earth**

**6 Elevation:** **750** ..... ft.  Ground Level  TOC  
Source:  Land Survey  GPS  Topographic Map  
 Other .....

**7 WELL WATER TO BE USED AS:**

1. Domestic: <input type="checkbox"/> Household <input type="checkbox"/> Lawn & Garden <input type="checkbox"/> Livestock <input type="checkbox"/> Irrigation <input type="checkbox"/> Feedlot <input type="checkbox"/> Industrial	5. <input checked="" type="checkbox"/> Public Water Supply: well ID ..... <b>HCW-1</b> 6. <input type="checkbox"/> Dewatering: how many wells? .....	10. <input type="checkbox"/> Oil Field Water Supply: lease .....
2. <input type="checkbox"/> Livestock 3. <input type="checkbox"/> Irrigation 4. <input type="checkbox"/> Feedlot 5. <input type="checkbox"/> Industrial	7. <input type="checkbox"/> Aquifer Recharge: well ID .....	11. Test Hole: well ID .....
6. <input type="checkbox"/> Household 7. <input type="checkbox"/> Lawn & Garden 8. <input type="checkbox"/> Livestock 9. <input type="checkbox"/> Irrigation 10. <input type="checkbox"/> Feedlot 11. <input type="checkbox"/> Industrial	8. <input type="checkbox"/> Monitoring: well ID .....	12. Geothermal: how many bores? .....
9. Environmental Remediation: well ID .....	13. <input type="checkbox"/> Other (specify): .....	a) Closed Loop <input type="checkbox"/> Horizontal <input type="checkbox"/> Vertical b) Open Loop <input type="checkbox"/> Surface Discharge <input type="checkbox"/> Inj. of Water

Was a chemical/bacteriological sample submitted to KDHE?  Yes  No If yes, date sample was submitted: .....

Water well disinfected?  Yes  No

**8 TYPE OF CASING USED:**  Steel  PVC  Other **Concrete** CASING JOINTS:  Glued  Clamped  Welded  Threaded

Casing diameter ..... **228** ..... in. to ..... **50** ..... ft., Diameter ..... **234** ..... in. to ..... **55** ..... ft., Diameter ..... in. to ..... ft.  
Casing height above land surface ..... **317** ..... in. Weight ..... lbs./ft. Wall thickness or gauge No. **18 inches**.....

**TYPE OF SCREEN OR PERFORATION MATERIAL:**  
 Steel  Stainless Steel  Fiberglass  PVC  Other (Specify) .....

Brass  Galvanized Steel  Concrete tile  None used (open hole)

**SCREEN OR PERFORATION OPENINGS ARE:**  
 Continuous Slot  Mill Slot  Gauze Wrapped  Torch Cut  Drilled Holes  Other (Specify) **940' of 12" laterals**.....  
 Louvered Shutter  Key Punched  Wire Wrapped  Saw Cut  None (Open Hole)

**SCREEN-PERFOR INTERVALS:** From **49** ..... ft. to **49** ..... ft., From ..... ft. to ..... ft., From ..... ft. to ..... ft.  
**GRAVEL PACK INTERVALS:** From ..... ft. to ..... ft., From ..... ft. to ..... ft., From ..... ft. to ..... ft.

**9 GROUT MATERIAL:**  Neat cement  Cement grout  Bentonite  Other .....

Grout Intervals: From ..... **0** ..... ft. to ..... **5** ..... ft., From ..... **5** ..... ft. to ..... **45** ..... ft., From ..... ft. to ..... ft.

**Nearest source of possible contamination:**  
 Septic Tank  Lateral Lines  Pit Privy  Livestock Pens  Insecticide Storage  
 Sewer Lines  Cess Pool  Sewage Lagoon  Fuel Storage  Abandoned Water Well  
 Watertight Sewer Lines  Seepage Pit  Feedyard  Fertilizer Storage  Oil Well/Gas Well  
 Other (Specify) .....

Direction from well? ..... Distance from well? ..... ft.

10 FROM	TO	LITHOLOGIC LOG	FROM	TO	LITHO. LOG (cont.) or PLUGGING INTERVALS
0	17	Dark Brown, clayey silt and fine sand			
17	25	Brown, fine to medium sand			
25	30	Brown, sand and gravel			
30	39	Gray, sand and gravel			
39	41	Tan, fine to coarse sand			
41	48	Gray, sand and gravel			
48	52	Tan, sand and gravel			
52	55	Brown, sand and gravel			

Notes: This is a horizontal collector well, equipped with five 12" diameter laterals totaling 940 feet in length. Screen slot sizes range from 0.060 to .0150 inches.

**11 CONTRACTOR'S OR LANDOWNER'S CERTIFICATION:** This water well was  constructed,  reconstructed, or  plugged under my jurisdiction and was completed on (mo-day-year) **11-2-2017** and this record is true to the best of my knowledge and belief. Kansas Water Well Contractor's License No. **102** This Water Well Record was completed on (mo-day-year) **11-14-2017** under the business name of **Layne Christensen Company** Signature **Robert W. King**

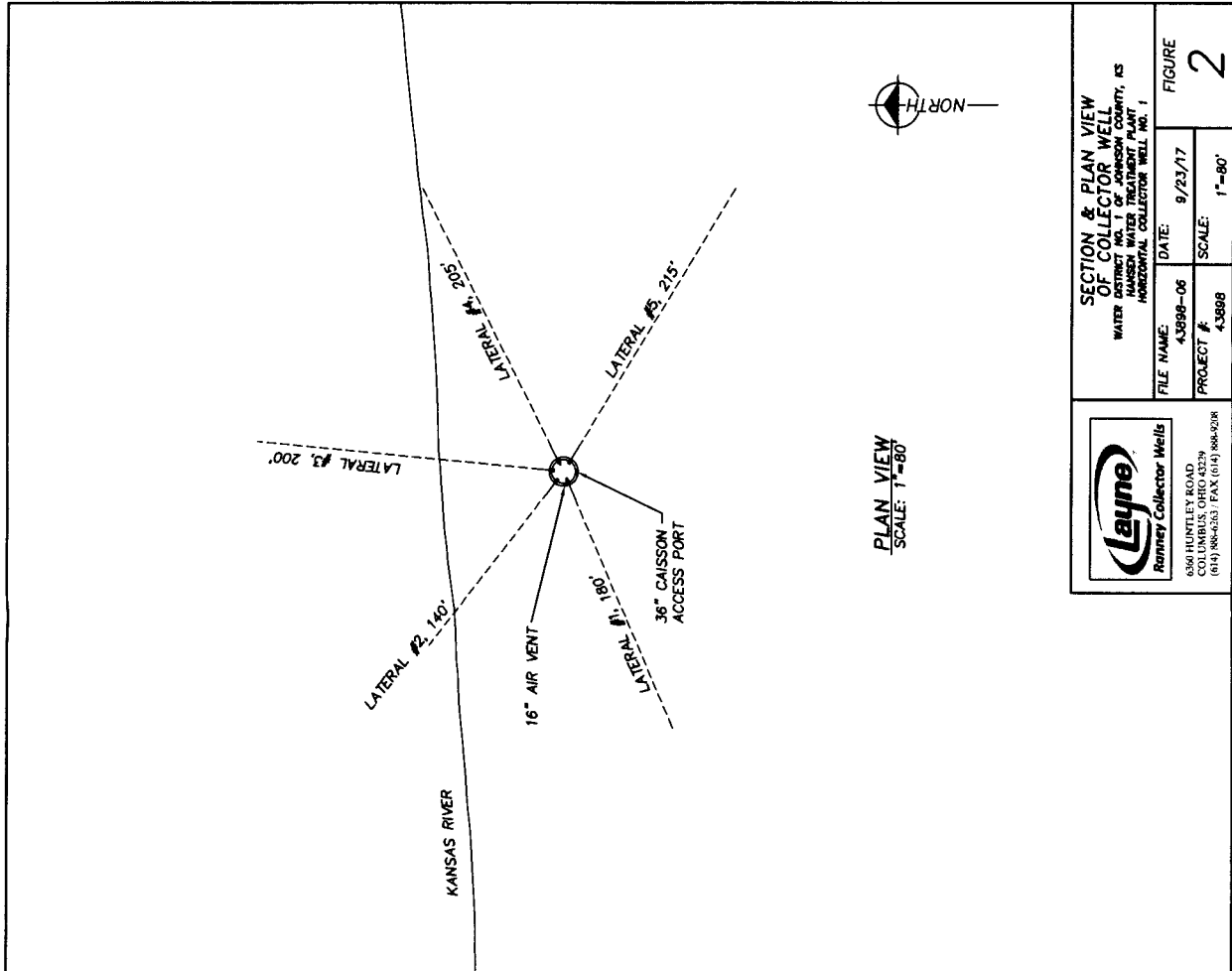

**Layne**  
Rainey Collector Wells  
656 HUNTLEY ROAD  
COLUMBUS, OHIO 43239  
(614) 886-6363 FAX (614) 886-9298

**SECTION & PLAN VIEW OF COLLECTOR WELL**  
WATER DISTRICT NO. 1 OF JOHNSON COUNTY, KS  
MADISON WATERSHED DISTRICT PART 1  
MADISON WATERSHED COLLECTOR WELL, PH. 1

FILE NAME:	43898-06	DATE:	9/23/17	FIGURE	2
PROJECT #:	43898	SCALE:	1"=80'		

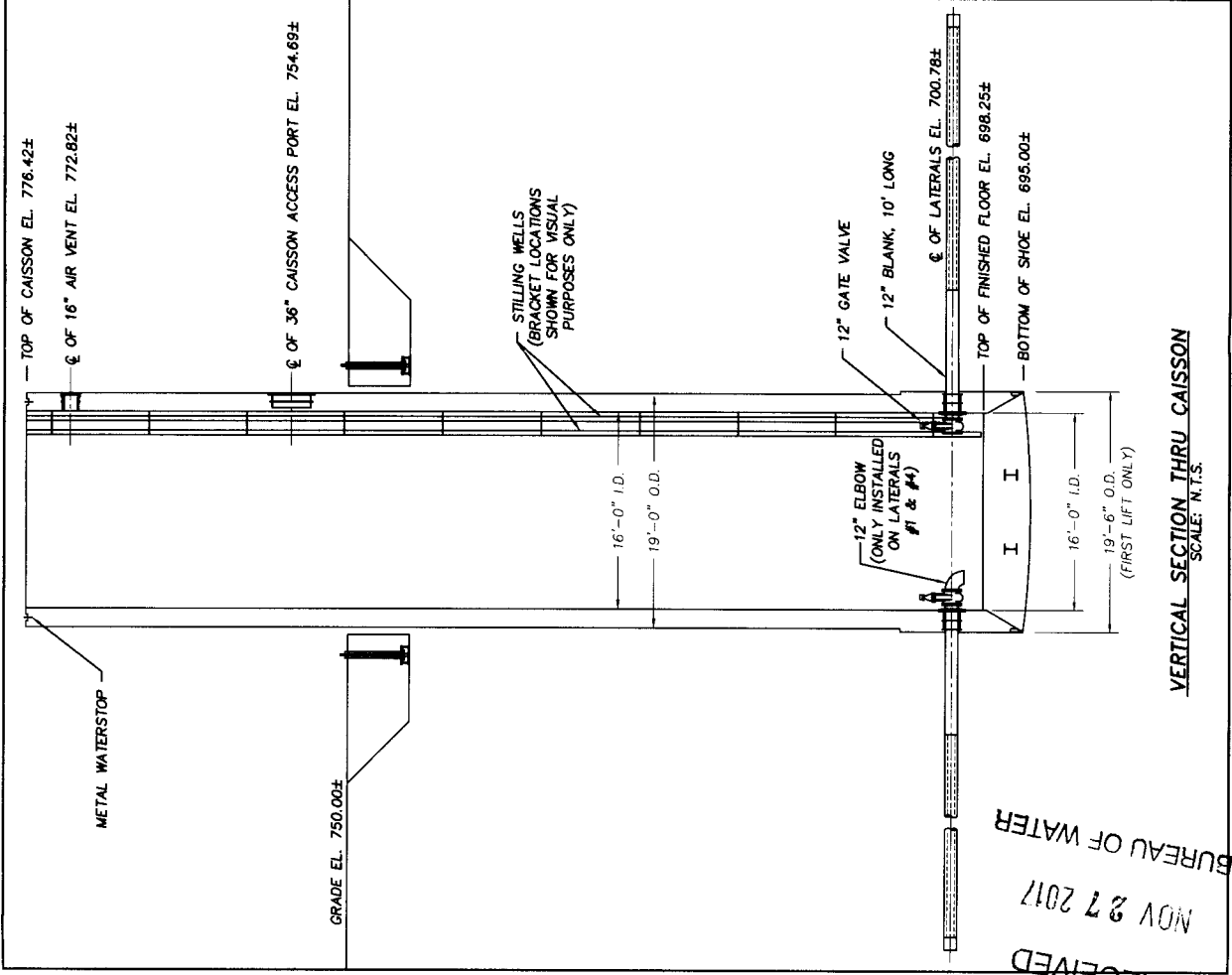

RECEIVED  
NOV 27 2017  
BUREAU OF WATER