

WATER WELL RECORD

Form WWC-5

Division of Water Resources App. No. _____

Well ID

MW12

Original Record Correction Change in Well Ust

1 **LOCATION OF WATER WELL:** County Wyandotte Fraction NW ¼ NE ¼ NW ¼ SW ¼ Section Number 27 Township Number T 11 S Range Number R 24 E W

2 **WELL OWNER:** Last Name: First: Street or Rural Address where well is located (if unknown, distance and direction from nearest town or intersection): If at owner's address, check here:
 Business: Americold Logistics, LLC
 Address: 10 Glenlake Pkwy.
 Address: Ste. 600 South Tower
 City Atlanta State: GA ZIP: 30328
 7000 Holliday Drive, Kansas City, KS

3 **LOCATE WELL WITH "X" IN SECTION BOX:**

N

NW	NE
X	
SW	SE

S

1 mile

4 **DEPTH OF COMPLETED WELL:** 28.00 ft
 Depth(s) Groundwater Encountered: 1) _____ ft
 2) _____ ft 3) _____ ft, or 4) Dry Well
 WELL'S STATIC WATER LEVEL: 25.10 ft.
 below land surface, measured on (mo-day-yr) 9/20/18
 above land surface, measured on (mo-day-yr) _____
 Pump test data: Well water was _____ ft
 after _____ hours pumping _____ gpm
 Water well was _____ ft
 after _____ hours pumping _____ gpm
 Estimated Yield: _____ gpm
 Bore Hole Diameter: 7.25 in to _____ ft, and
 _____ in to _____ ft

5 **Latitude:** 39.06520 (decimal degrees)
Longitude: 94.73888 (decimal degrees)
 Horizontal Datum: WGS 84 NAD 83 NAD 27
 Source for Latitude/Longitude:
 GPS (unit make/model: _____)
 (WAAS enabled? Yes No)
 Land Survey Topographic Map
 Online Mapper

6 **Elevation:** 771.64 ft Ground Level TOC
 Source: Land Survey GPS Topographic Map
 Other _____

7 **WELL WATER TO BE USED AS:**

1 Domestic: Household Lawn & Garden Livestock Irrigation Feedlot Industrial

2 Public Water Supply: well ID _____
 3 Dewatering: how many wells? _____
 4 Aquifer Recharge: well ID _____
 5 Monitoring: well ID **MW12**
 6 Environmental Remediation: well ID _____
 7 Air Sparge Soil Vapor Extractor
 8 Recovery Injection

9 Oil Field Water Supply: lease _____
 10 Test Hole: well ID _____
 Cased Uncased Geotechnical
 11 Geothermal: How many bores?
 a) Closed Loop Horizontal Vertical
 b) Open Loop Surface Discharge Inj. of Water
 Other (specify): _____

Was a chemical/bacteriological sample submitted to KDHE? Yes No If yes, date sample was submitted: _____
 Water well disinfected? Yes No

8 **TYPE OF CASING USED:** Steel PVC Other _____ CASING JOINTS: Glued Clamped Welded Threaded
 Casing diameter 2 in. to 13 ft, Diameter _____ in. to _____ ft, Diameter _____ in. to _____ ft,
 Casing height above land surface -0.48 in. Weight _____ lbs./ft. Well thickness or gauge No _____
TYPE OF SCREEN OR PERFORATION MATERIAL:
 Steel Stainless Steel Fiberglass PVC Other (Specify) _____
 Brass Galvanized Steel Concrete tile None used (open hole)
SCREEN OR PERFORATION OPENINGS ARE:
 Continuous Slot Mill Slot Gauze Wrapped Torch Cut Drilled Holes Other (Specify) _____
 Louvered Shutter Key Punched Wire Wrapped Saw Cut None (Open Hole)
SCREEN-PERFORATED INTERVALS: From 13 ft. to 28 ft, From _____ ft. to _____ ft, From _____ ft. to _____ ft,
GRAVEL PACK INTERVALS: From 11 ft. to 28 ft, From _____ ft. to _____ ft, From _____ ft. to _____ ft,

9 **GROUT MATERIAL:** Neat cement Cement grout Bentonite Other Concrete: 0-0.7'
 Grout intervals: From 0.7 ft. to 11 ft, From _____ ft. to _____ ft, From _____ ft. to _____ ft,

Nearest source of possible contamination:
 Septic Tank Lateral Lines Pit Privy Livestock Pens Insecticide Storage
 Sewer Lines Cess Pool Sewage Lagoon Fuel Storage Abandoned Water Well
 Watertight Sewer Lines Seepage Pit Feedyard Fertilizer Storage Oil Well / Gas Well
 Other (Specify) _____
 Direction from well? S Distance from well? ~155 ft

10 FROM	TO	LITHOLOGIC LOG	FROM	TO	LITHO. LOG (cont.) or PLUGGING INTERVALS
0	5	Silty clay mixed with limestone rubble and gravel			
5	7	Silty clay			
7	9.25	Rubble fill, limestone concrete blocks, some shale			
9.25	9.5	Cobbles, limestone			
9.5	16	Very fine silt			
16	16.75	Limestone cobbles			
16.75	28	Siltstone, occasional limestone fingers			

Notes: KDHE ID: Inland Quarries; A4-105-40484
 Target of monitoring well is shallow groundwater, <20' of grout was installed at the direction of KDHE.

11 **CONTRACTOR'S OR LANDOWNER'S CERTIFICATION:** This water well was constructed, reconstructed, or plugged under my jurisdiction and was completed on (mo-day-year) 8/21/18 and this record is true to the best of my knowledge and belief. Kansas Water Well Contractor's License No 757 This Water Well Record was completed on (mo-day-year) 10/8/18 under the business name of Larsen & Associates, Inc. Signature _____

Wyan doffe
 SW NE NW SW
 NW NE NW SW

NOTE: Figures exhibited within this report are only to be used within the context of this report. Placement of property lines, wells, structures, and roads is based on the available information from county appraiser maps, surveys, site visits, and/or previous vendor reports and should be considered approximate.

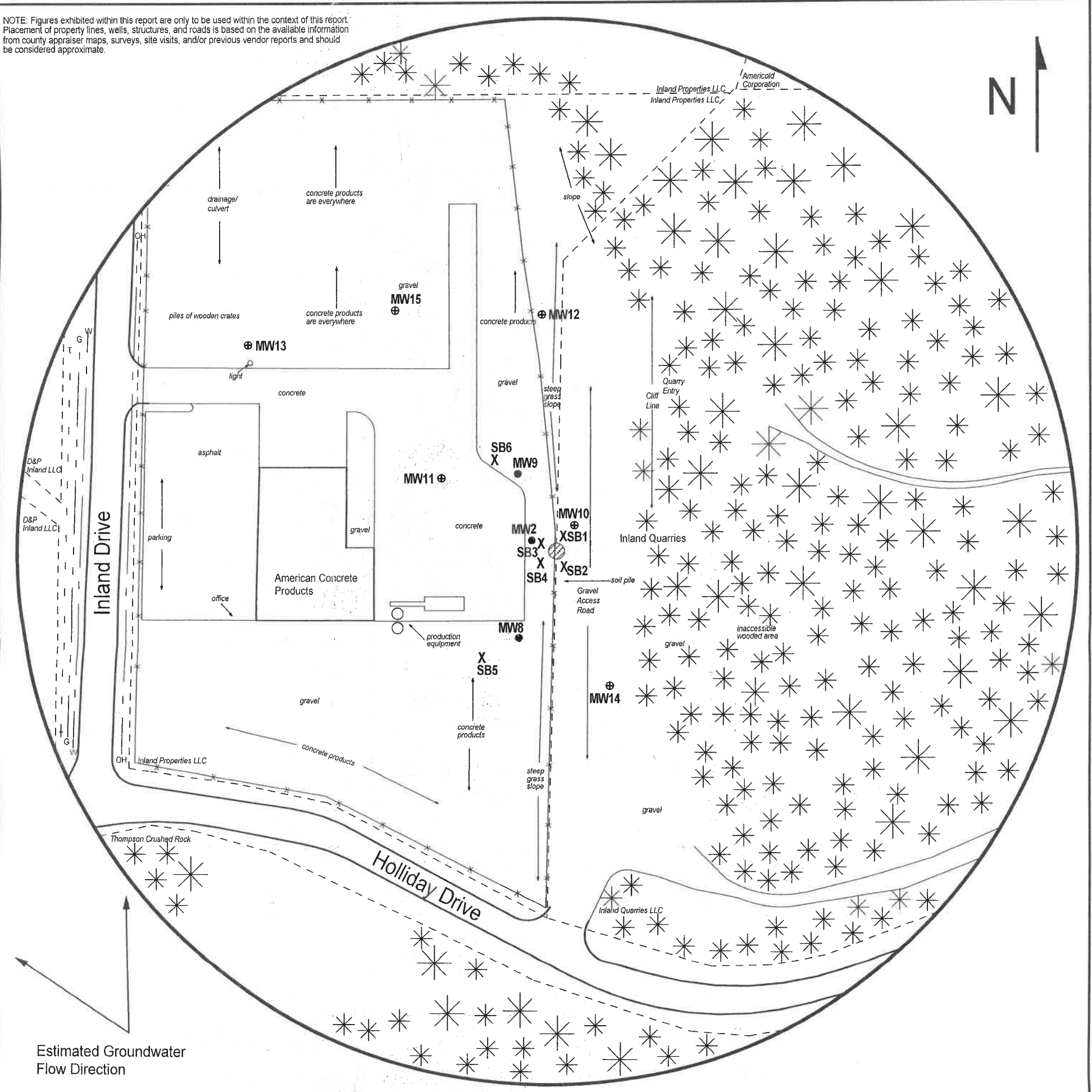

FIGURE 2.2 - 500 FT RADIUS AREA BASE MAP

LEGEND:

- Approximate Location of Former AST
- Approximate Location of Former AST
- Existing Monitoring Well
- Monitoring Well (Installed 8/20-21/18)
- Soil Boring (Drilled 8/21-22/18)
- Gas Lines (2 - 6 ft BGS)
- Overhead Lines (25-40 ft high)
- Telephone Lines (2 - 6 ft BGS)
- Water Lines (2 - 6 ft BGS)

larsen
 & ASSOCIATES, INC.

1311 E 25th St., Suite B
 Lawrence, KS 66046

(785) 841-8707 office
 (785) 865-4282 fax

PROJECT:
 Inland Quarries
 7000 Holliday Drive
 Kansas City, KS
 KDHE ID: A4-105-40484
 Date: 9/20/18

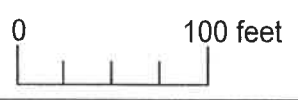

NOTE: SB5 & SB6 were drilled to collect hydrologic samples.
 NOTE: Utility depths, heights and locations are approximate.

27-11-24

DENNIS L HANDKE

1820 NW 59th Terrace
TOPEKA, KANSAS 66618
785-286-4047 Home
785-286-1990 Fax

Jessica Chapman
Larsen & Associates
1311 E. 25th Street, Suite B
Lawrence, Kansas, 66046

September 17, 2018

RE: Monitor Well Elevation Survey
7000 Holiday Drive, Kansas City, Kansas

Proj. 18-00BB
Inland Quarries
A4-105-40484

Bench Mark #2: Chisled Sq. on SW Corner of storm sewer basin NE of the building. Concrete plant

Elev: 768.63 North 2316 West 4314 (from SE Cor. Sec. 27-11-24E)

MW-10	rim	773.47	North	2199	SW1/4,NE1/4,NW1/4,SW1/4
	top pipe	773.09	West	4222	Lat= 39.06466 Long = 94.73877
MW-11	rim	770.13	North	2241	SW1/4,NE1/4,NW1/4,SW1/4
	top pipe	769.82	West	4338	Lat= 39.06478 Long = 94.73917
MW-12	rim	772.12	North	2394	NW1/4,NE1/4,NW1/4,SW1/4
	top pipe	771.64	West	4256	Lat= 39.06520 Long = 94.73888
MW-13	rim	768.07	North	2366	NW1/4,NE1/4,NW1/4,SW1/4
	top pipe	767.66	West	4532	Lat= 39.06512 Long = 94.73986
MW-14	rim	773.97	North	2044	NW1/4,NE1/4,NW1/4,SW1/4
	top pipe	773.48	West	4194	Lat= 39.06424 Long = 94.73867
MW-15	rim	769.16	North	2394	SW1/4,NE1/4,NW1/4,SW1/4
	top pipe	768.86	West	4389	Lat= 39.06520 Long = 94.73935

Lat & Long derived existing Shawnee 7.5' quad map. WGS 84.

Elevation established from existing project

If you have any questions, please feel free to call me. Thank you for the opportunity to be of service to you.

Dennis L Handke RLS
September 17, 2018
Dennis L Handke
KANSAS
LAND SURVEYOR

RECEIVED

DEC 04 2018

BUREAU OF WATER

RECEIVED

DEC 04 2018

BUREAU OF WATER