

WATER WELL RECORD

Form WWC-5

Division of Water Resources App. No.

Well ID MW10

Original Record Correction Change in Well Ust

1 LOCATION OF WATER WELL: County Wyandotte Fraction SW 1/4 NE 1/4 NW 1/4 SW 1/4 Section Number 27 Township Number T 11 S Range Number R 24 E

2 WELL OWNER: Last Name: First: Street or Rural Address where well is located (if unknown, distance and direction from nearest town or intersection): 7000 Holliday Drive, Kansas City, KS

3 LOCATE WELL WITH "X" IN SECTION BOX: [Diagram showing a 3x3 grid with 'X' in the center square]

4 DEPTH OF COMPLETED WELL: 12.5 ft Depth(s) Groundwater Encountered: 1) 12.5 ft 2) ft 3) ft or 4) Dry Well WELL'S STATIC WATER LEVEL: 8.68 ft

5 Latitude: 39.06466 (decimal degrees) Longitude: 94.73877 (decimal degrees) Horizontal Datum: X WGS 84 Source for Latitude/Longitude: X Land Survey

7 WELL WATER TO BE USED AS: 1 Domestic: 5 Public Water Supply: well ID 10 Oil Field Water Supply: lease 11 Test Hole: well ID 12 Geothermal: How many bores?

Was a chemical/bacteriological sample submitted to KDHE? Yes No If yes, date sample was submitted: Water well disinfected? Yes No

8 TYPE OF CASING USED: Steel PVC Other CASING JOINTS: Glued Clamped Welded Threaded Casing diameter 2 in. to 5 ft. Diameter in. to ft. Diameter in. to ft.

9 GROUT MATERIAL: Neat cement Cement grout Bentonite Other Concrete: 0-0.7 Grout intervals: From 0.7 ft. to 3 ft. From ft. to ft. From ft. to ft.

10 FROM TO LITHOLOGIC LOG FROM TO LITHO. LOG (cont.) or PLUGGING INTERVALS

11 CONTRACTOR'S OR LANDOWNER'S CERTIFICATION: This water well was constructed, reconstructed, or plugged under my jurisdiction and was completed on (mo-day-year) 8/21/18 and this record is true to the best of my knowledge and belief.

-Wyan doffe
 SW NE NW SW
 NW NE NW SW

NOTE: Figures exhibited within this report are only to be used within the context of this report. Placement of property lines, wells, structures, and roads is based on the available information from county appraiser maps, surveys, site visits, and/or previous vendor reports and should be considered approximate.

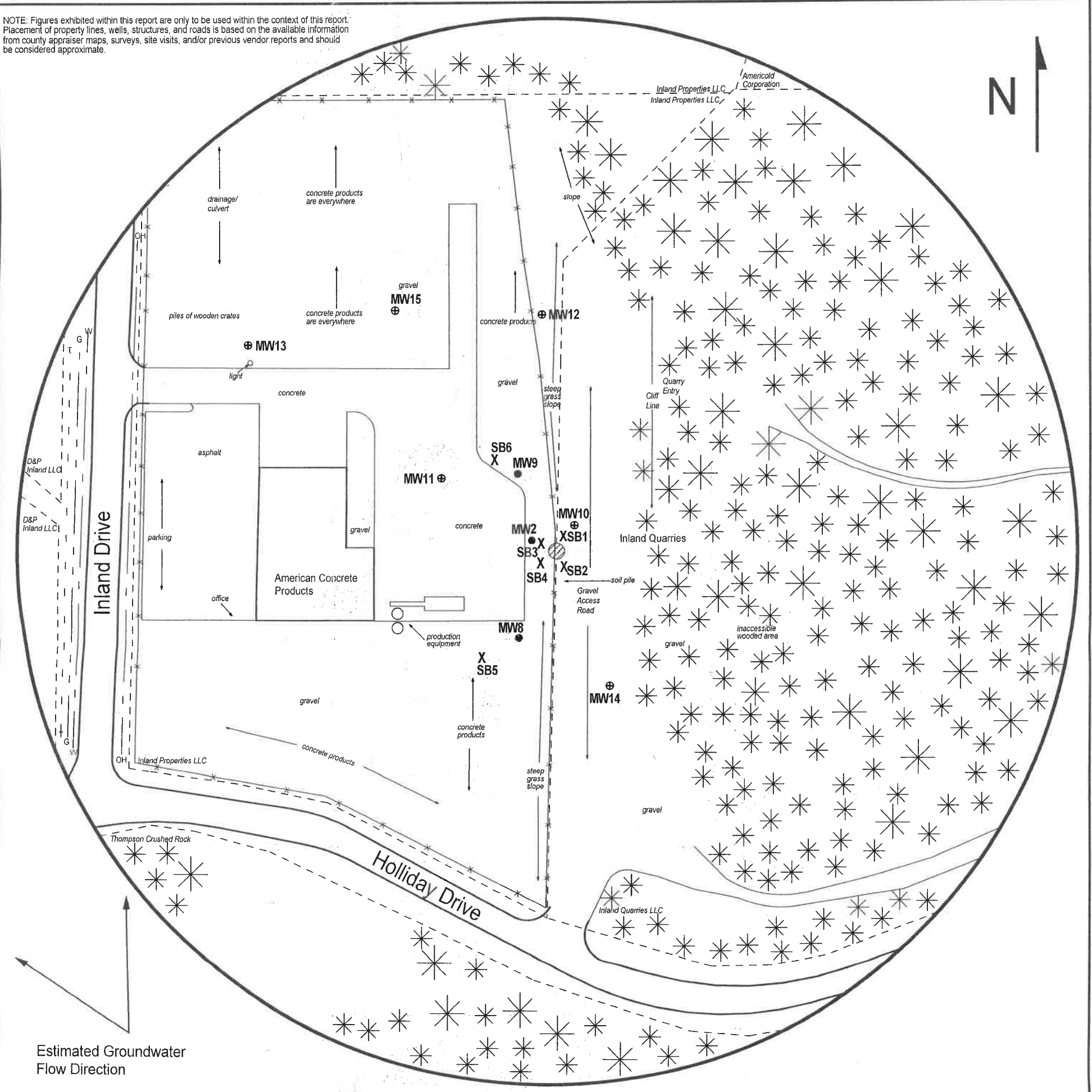

FIGURE 2.2 - 500 FT RADIUS AREA BASE MAP

LEGEND:

- Approximate Location of Former AST
- Approximate Location of Former AST
- Existing Monitoring Well
- Monitoring Well (Installed 8/20-21/18)
- Soil Boring (Drilled 8/21-22/18)
- Gas Lines (2 - 6 ft BGS)
- Overhead Lines (25-40 ft high)
- Telephone Lines (2 - 6 ft BGS)
- Water Lines (2 - 6 ft BGS)

larsen
 & ASSOCIATES, INC.

1311 E 25th St., Suite B
 Lawrence, KS 66046

(785) 841-8707 office
 (785) 865-4282 fax

PROJECT:
 Inland Quarries
 7000 Holliday Drive
 Kansas City, KS
 KDHE ID: A4-105-40484
 Date: 9/20/18



NOTE: SB5 & SB6 were drilled to collect hydrologic samples.
 NOTE: Utility depths, heights and locations are approximate.

27-11-24

DENNIS L HANDKE

1820 NW 59th Terrace
TOPEKA, KANSAS 66618
785-286-4047 Home
785-286-1990 Fax

Jessica Chapman
Larsen & Associates
1311 E. 25th Street, Suite B
Lawrence, Kansas, 66046

September 17, 2018

RE: Monitor Well Elevation Survey
7000 Holiday Drive, Kansas City, Kansas

Proj. 18-00BB
Inland Quarries
A4-105-40484

Bench Mark #2: Chisled Sq. on SW Corner of storm sewer basin NE of the building. Concrete plant

Elev: 768.63 North 2316 West 4314 (from SE Cor. Sec. 27-11-24E)

MW-10	rim	773.47	North	2199	SW1/4,NE1/4,NW1/4,SW1/4
	top pipe	773.09	West	4222	Lat= 39.06466 Long = 94.73877
MW-11	rim	770.13	North	2241	SW1/4,NE1/4,NW1/4,SW1/4
	top pipe	769.82	West	4338	Lat= 39.06478 Long = 94.73917
MW-12	rim	772.12	North	2394	NW1/4,NE1/4,NW1/4,SW1/4
	top pipe	771.64	West	4256	Lat= 39.06520 Long = 94.73888
MW-13	rim	768.07	North	2366	NW1/4,NE1/4,NW1/4,SW1/4
	top pipe	767.66	West	4532	Lat= 39.06512 Long = 94.73986
MW-14	rim	773.97	North	2044	NW1/4,NE1/4,NW1/4,SW1/4
	top pipe	773.48	West	4194	Lat= 39.06424 Long = 94.73867
MW-15	rim	769.16	North	2394	SW1/4,NE1/4,NW1/4,SW1/4
	top pipe	768.86	West	4389	Lat= 39.06520 Long = 94.73935

Lat & Long derived existing Shawnee 7.5' quad map. WGS 84.

Elevation established from existing project

If you have any questions, please feel free to call me. Thank you for the opportunity to be of service to you.

Dennis L Handke RLS
September 17, 2018
Dennis L Handke
KANSAS
LAND SURVEYOR

RECEIVED

DEC 04 2018

BUREAU OF WATER

RECEIVED

DEC 04 2018

BUREAU OF WATER