

WATER WELL PLUGGING RECORD Form WWC-5P

KSA 82a-1212

ID NO.

VMP-155

1 LOCATION OF WATER WELL: Fraction NW 1/4 SE 1/4 NW 1/4 Section Number 13 Township Number T 11 S Range Number 24 E W
 County: Wyandotte

Street/Rural Address of Well Location; if unknown, distance & direction from nearest town or intersection: If at owner's address, check here 5200 Speaker Road Kansas City, KS

Global Positioning Systems (GPS) information:
 Latitude: 39.098541 (in decimal degrees)
 Longitude: -94.698634 (in decimal degrees)
 Elevation: _____
 Horizontal Datum: WGS84, NAD83, NAD27
 Collection Method: _____

2 WATER WELL OWNER: TH Agriculture & Nutrition LLC
 RR#, St. Address, Box #: 15313 W 95th St
 City, State ZIP Code: Lenexa, KS 66219

GPS unit (Make/Model: Garmin etrek)
 Digital Map/Photo, Topographic Map, Land Survey
 Est. Accuracy: < 3 m, 3-5 m, 5-15 m, > 15 m

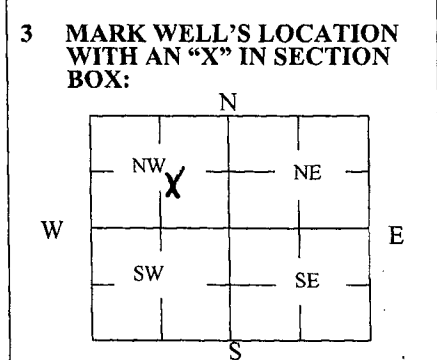

4 DEPTH OF WELL 18 ft.
 WELL'S STATIC WATER LEVEL _____ ft.
 WELL WAS USED AS:
 Domestic Public Water Supply Dewatering
 Irrigation Oil Field Water Supply Monitoring
 Feedlot Domestic (Lawn & Garden) Injection Well
 Industrial Air Conditioning Other SVE Well

Was a chemical/bacteriological sample submitted to Department? Yes No

5 TYPE OF BLANK CASING USED:

Steel RMP (SR) Wrought Fiberglass Other (Specify below) _____
 PVC ABS Asbestos-Cement Concrete Tile

Blank casing diameter 1 in. Was casing pulled? Yes No If yes, how much _____
 Casing height above or below land surface -6 in.

6 GROUT PLUG MATERIAL: Neat cement Cement grout Bentonite Other Top Soil

Grout Plug Intervals: From 0 ft. to 1 ft., From 1 ft. to 18 ft., From — ft. to — ft.

What is the nearest source of possible contamination:
 Septic tank Seepage pit Fuel storage Other (specify below) _____
 Sewer lines Pit privy Fertilizer storage unknown _____
 Watertight sewer lines Sewage lagoon Insecticide storage _____
 Lateral lines Feedyard Abandoned water well Direction from well? _____
 Cess pool Livestock pens Oil well/Gas well How many feet? _____

FROM	TO	PLUGGING MATERIALS	FROM	TO	PLUGGING MATERIALS
0	1	Top Soil			
1	18	Bentonite grout			

7 CONTRACTOR'S OR LANDOWNER'S CERTIFICATION: This water well was plugged under my jurisdiction and was completed on (mo/day/year) 3/23/2020 and this record is true to the best of my knowledge and belief. Kansas Water Well Contractor's License No. 710. This Water Well Record was completed on (mo/day/year) 4/10/2020 under the business name of Below Ground Surface, Inc. by (signature) Ray K. [Signature]

Send one white copy to Kansas Department of Health & Environment, Geology Section, 1000 SW Jackson Street, Ste. 420, Topeka, KS 66612-1367. Send one copy to WATER WELL OWNER and retain one for your records.
 Visit us at <http://www.kdheks.gov/waterwell/index.html> Telephone 785-296-5524.

Wyandtic

NW SECTION

13-T11-R4E

DWG. DATE: 5-13-09

FILE NAME: FIGURE_1.DWG

COMPILED BY: RENEE ALINGES

PROJECT MANAGER: KATHY KISSOK

DRAWN BY: CHAD NIMMO

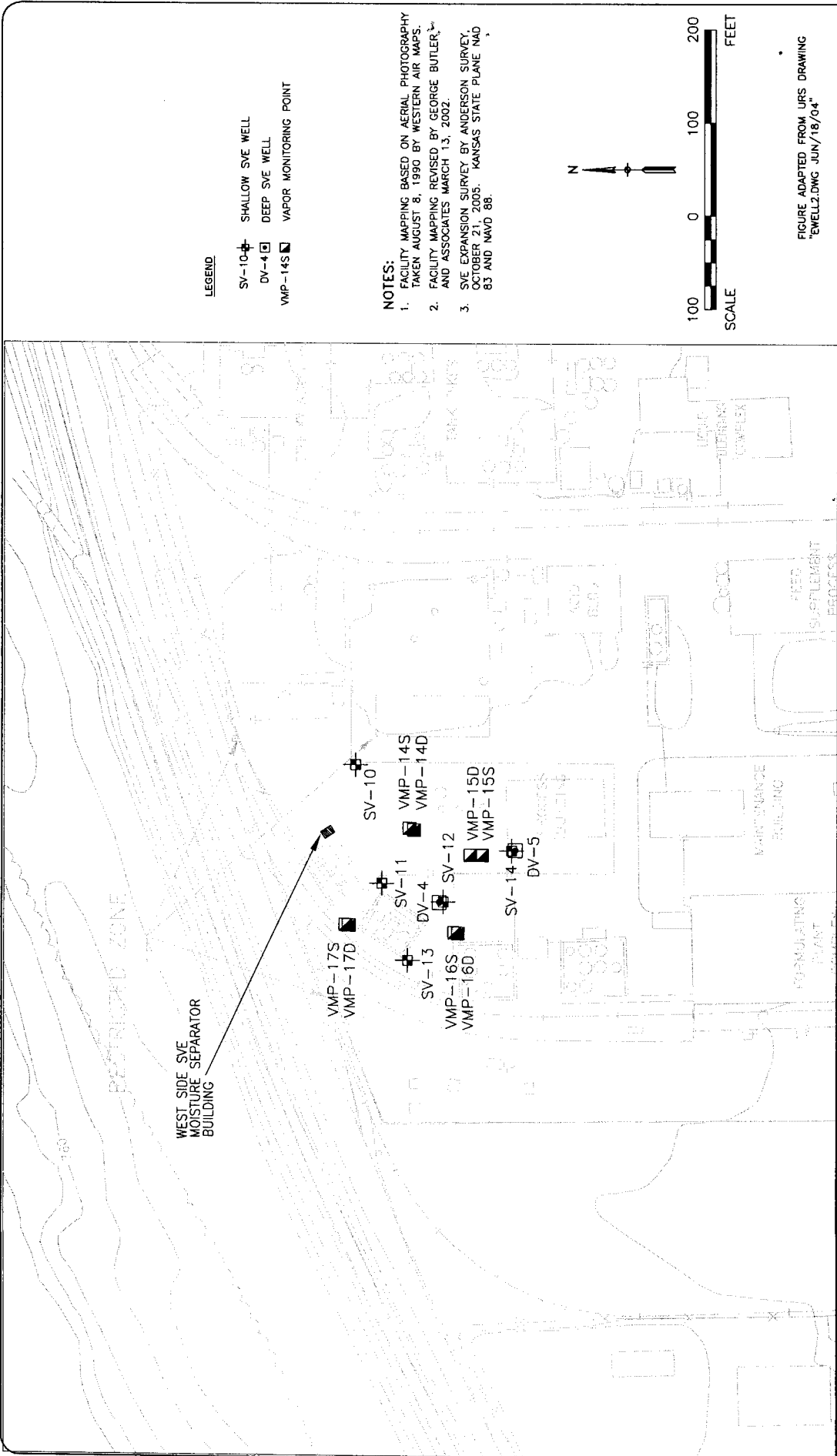

LEGEND

- SV-10 SHALLOW SVE WELL
- DV-4 DEEP SVE WELL
- VMP-14S VAPOR MONITORING POINT

NOTES:

1. FACILITY MAPPING BASED ON AERIAL PHOTOGRAPHY TAKEN AUGUST 8, 1990 BY WESTERN AIR MAPS. FACILITY MAPPING REVISED BY GEORGE BUTLER AND ASSOCIATES MARCH 13, 2002.
2. SVE EXPANSION SURVEY BY ANDERSON SURVEY, OCTOBER 21, 2005. KANSAS STATE PLANE NAD 83 AND NAVD 88.

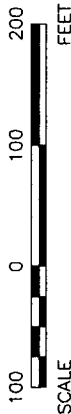
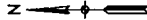

FIGURE ADAPTED FROM IJRS DRAWING "EWELL.DWG JUN/18/04"



WEST TANK DIKE SOIL VAPOR EXTRACTION SYSTEM WELL LOCATIONS

HARCROS CHEMICALS INC.
5000 SPEAR ROAD
KANSAS CITY, MISSOURI

PROJECT NUMBER

KC001458.0001

FIGURE NUMBER

4