

WATER WELL PLUGGING RECORD Form WWC-5P

KSA 82a-1212

ID NO.

VMP-15D

1 LOCATION OF WATER WELL: County: Wyandotte	Fraction NW ¼ SE ¼ NW ¼ ¼	Section Number 13	Township Number T 11 S	Range Number 24 <input checked="" type="checkbox"/> E <input type="checkbox"/> W
---	------------------------------	----------------------	---------------------------	---

Street/Rural Address of Well Location; if unknown, distance & direction from nearest town or intersection: If at owner's address, check here <input type="checkbox"/> 5200 Speaker Road Kansas City, KS	Global Positioning Systems (GPS) information: Latitude: <u>39.098541</u> (in decimal degrees) Longitude: <u>-94.698634</u> (in decimal degrees) Elevation: _____ Horizontal Datum: <input checked="" type="checkbox"/> WGS84, <input type="checkbox"/> NAD83, <input type="checkbox"/> NAD27 Collection Method: _____
---	---

2 WATER WELL OWNER: TH Agriculture & Nutrition LLC RR#, St. Address, Box #: 15313 W 95th St City, State ZIP Code: Lenexa, KS 66219	<input checked="" type="checkbox"/> GPS unit (Make/Model: <u>Garmin etrek</u>) <input type="checkbox"/> Digital Map/Photo, <input type="checkbox"/> Topographic Map, <input type="checkbox"/> Land Survey Est. Accuracy: <input type="checkbox"/> < 3 m, <input checked="" type="checkbox"/> 3-5 m, <input type="checkbox"/> 5-15 m, <input type="checkbox"/> > 15 m
---	---

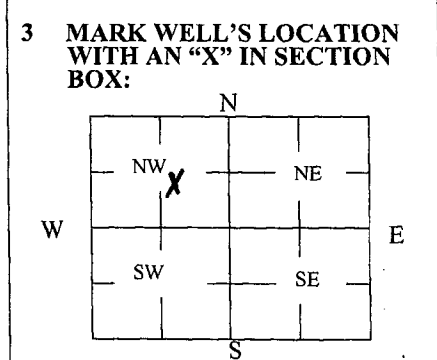

4 DEPTH OF WELL 33 ft.

WELL'S STATIC WATER LEVEL _____ ft.

WELL WAS USED AS:

<input type="checkbox"/> Domestic	<input type="checkbox"/> Public Water Supply	<input type="checkbox"/> Dewatering
<input type="checkbox"/> Irrigation	<input type="checkbox"/> Oil Field Water Supply	<input type="checkbox"/> Monitoring
<input type="checkbox"/> Feedlot	<input type="checkbox"/> Domestic (Lawn & Garden)	<input type="checkbox"/> Injection Well
<input type="checkbox"/> Industrial	<input type="checkbox"/> Air Conditioning	<input checked="" type="checkbox"/> Other <u>SVE Well</u>

Was a chemical/bacteriological sample submitted to Department? Yes No

5 TYPE OF BLANK CASING USED:

<input type="checkbox"/> Steel	<input type="checkbox"/> RMP (SR)	<input type="checkbox"/> Wrought	<input type="checkbox"/> Fiberglass	<input type="checkbox"/> Other (Specify below) _____
<input checked="" type="checkbox"/> PVC	<input type="checkbox"/> ABS	<input type="checkbox"/> Asbestos-Cement	<input type="checkbox"/> Concrete Tile	

Blank casing diameter 1 in. Was casing pulled? Yes No If yes, how much _____

Casing height above or below land surface -6 in.

6 GROUT PLUG MATERIAL: Neat cement Cement grout Bentonite Other Top Soil

Grout Plug Intervals: From 0 ft. to 1 ft., From 1 ft. to 33 ft., From _____ ft. to _____ ft.

What is the nearest source of possible contamination:

<input type="checkbox"/> Septic tank	<input type="checkbox"/> Seepage pit	<input type="checkbox"/> Fuel storage	<input type="checkbox"/> Other (specify below) _____
<input type="checkbox"/> Sewer lines	<input type="checkbox"/> Pit privy	<input type="checkbox"/> Fertilizer storage	<input type="checkbox"/> unknown
<input type="checkbox"/> Watertight sewer lines	<input type="checkbox"/> Sewage lagoon	<input type="checkbox"/> Insecticide storage	
<input type="checkbox"/> Lateral lines	<input type="checkbox"/> Feedyard	<input type="checkbox"/> Abandoned water well	Direction from well? _____
<input type="checkbox"/> Cess pool	<input type="checkbox"/> Livestock pens	<input type="checkbox"/> Oil well/Gas well	How many feet? _____

FROM	TO	PLUGGING MATERIALS	FROM	TO	PLUGGING MATERIALS
0	1	Top Soil			
1	33	Bentonite grout			

7 CONTRACTOR'S OR LANDOWNER'S CERTIFICATION: This water well was plugged under my jurisdiction and was completed on (mo/day/year) 3/23/2020 and this record is true to the best of my knowledge and belief. Kansas Water Well Contractor's License No. 710. This Water Well Record was completed on (mo/day/year) 4/10/2020 under the business name of Below Ground Surface, Inc. by (signature) Ray K. He...

Send one white copy to Kansas Department of Health & Environment, Geology Section, 1000 SW Jackson Street, Ste. 420, Topeka, KS 66612-1367. Send one copy to WATER WELL OWNER and retain one for your records.
 Visit us at <http://www.kdheks.gov/waterwell/index.html> Telephone 785-296-5524.

Wyandtic

NW SECTION

13-T11-R4E

DWG. DATE: 5-13-09

FILE NAME: FIGURE_1.DWG

COMPILED BY: RENEE ALINGES

PROJECT MANAGER: KATHY KISSOK

DRAWN BY: CHAD NIMMO

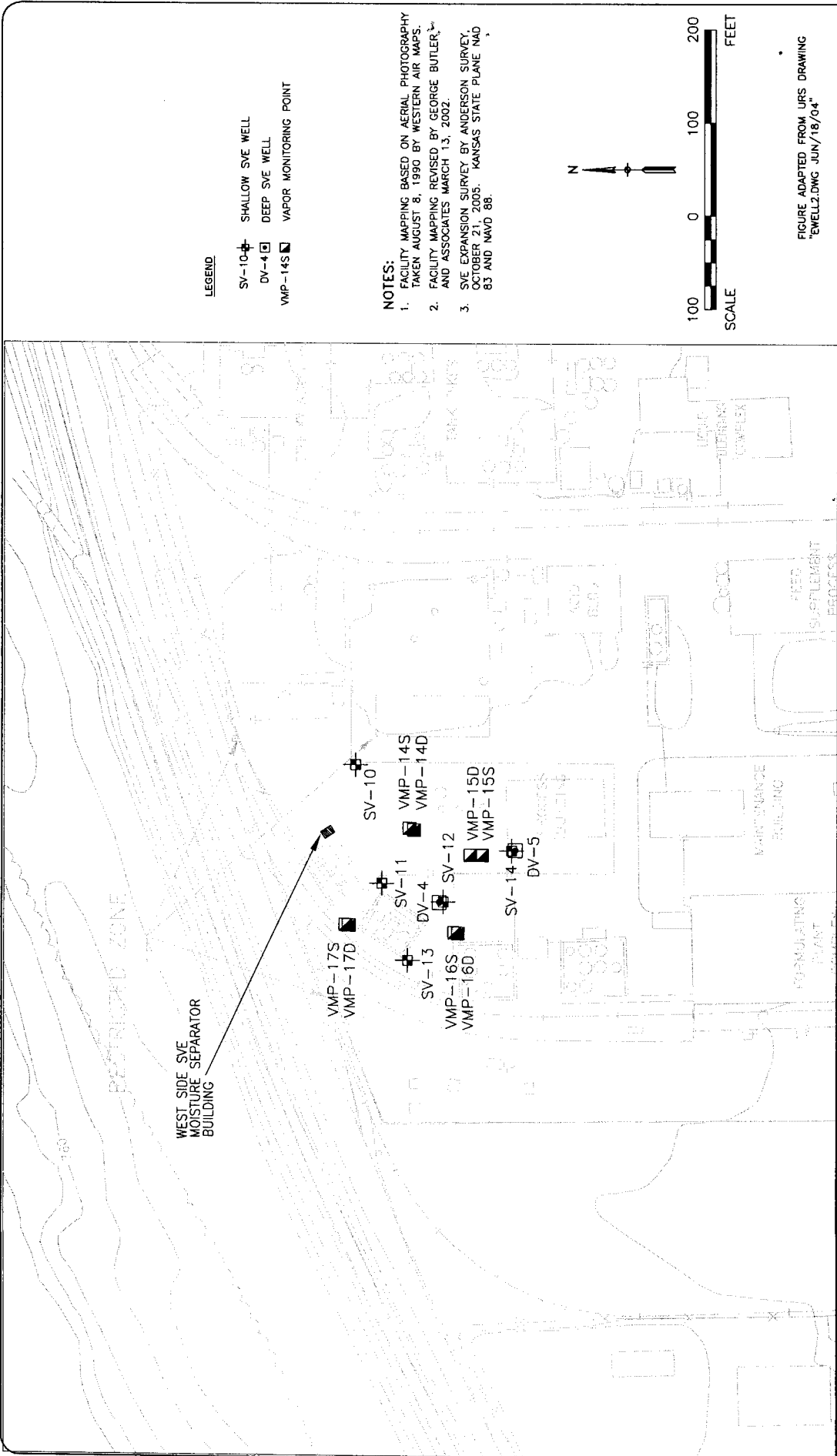

LEGEND

- SV-10 SHALLOW SVE WELL
- DV-4 DEEP SVE WELL
- VMP-14S VAPOR MONITORING POINT

NOTES:

1. FACILITY MAPPING BASED ON AERIAL PHOTOGRAPHY TAKEN AUGUST 8, 1990 BY WESTERN AIR MAPS. FACILITY MAPPING REVISED BY GEORGE BUTLER AND ASSOCIATES MARCH 13, 2002.
2. SVE EXPANSION SURVEY BY ANDERSON SURVEY, OCTOBER 21, 2005. KANSAS STATE PLANE NAD 83 AND NAVD 88.

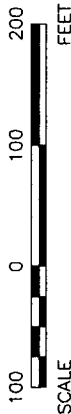
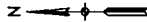

FIGURE ADAPTED FROM IJRS DRAWING "EWELL.DWG JUN/18/04"



WEST TANK DIKE SOIL VAPOR EXTRACTION SYSTEM WELL LOCATIONS

HARCROS CHEMICALS INC.
5000 SPEAR ROAD
KANSAS CITY, MISSOURI

PROJECT NUMBER

KC001458.0001

FIGURE NUMBER

4