

WATER WELL RECORD

Form WWC-5

Division of Water Resources App. No.

Well ID

MW10

Original Record Correction Change in Well Use

1 LOCATION OF WATER WELL: County Wyandotte Fraction NE 1/4 NW 1/4 NE 1/4 NW 1/4 Section Number 8 Township Number T 11 S Range Number R 24 E W

2 WELL OWNER: Last Name: Business: KDHE Address: 1000 SW Jackson City Topeka State: KS ZIP: 66612 Street or Rural Address where well is located (if unknown, distance and direction from nearest town or intersection): -280' W of 8245 State Ave., Kansas City, KS

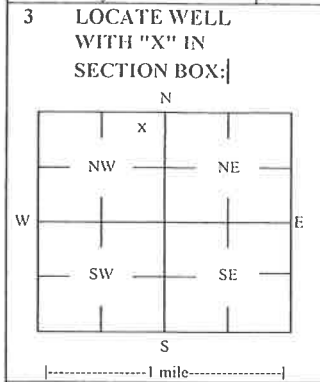

3 LOCATE WELL WITH 'X' IN SECTION BOX: 4 DEPTH OF COMPLETED WELL: 13 ft Depth(s) Groundwater Encountered: 1) 13 ft 2) ft 3) ft, or 4) Dry Well WELL'S STATIC WATER LEVEL: 8.89 ft. X below land surface, measured on (mo-day-yr) 8/10/2021

5 Latitude: 39.11591 (decimal degrees) Longitude: 94.77259 (decimal degrees) Horizontal Datum: X WGS 84 NAD 83 NAD 27 Source for Latitude/Longitude: GPS (unit make/model): Land Survey X Topographic Map Online Mapper 6 Elevation 937.52 ft Ground Level X TOC Source X Land Survey GPS Topographic Map Other

7 WELL WATER TO BE USED AS: 1 Domestic: Household Lawn & Garden Livestock Irrigation Feedlot Industrial 2 Public Water Supply: well ID 3 Dewatering: how many wells? 4 Aquifer Recharge: well ID 5 Monitoring: well ID MW10 6 Environmental Remediation: well ID Air Sparge Soil Vapor Extractor Recovery Injection 7 Oil Field Water Supply: lease 8 Test Hole: well ID Cased Uncased Geotechnical 9 Geothermal: How many bores? a) Closed Loop Horizontal Vertical b) Open Loop Surface Discharge Inj. of Water Other (specify):

Was a chemical/bacteriological sample submitted to KDHE? Yes No X No If yes, date sample was submitted: Water well disinfected? Yes No X No

8 TYPE OF CASING USED: Steel PVC X Other CASING JOINTS: Glued Clamped Welded X Threaded Casing diameter 2 in. to 3 ft, Diameter in. to ft, Diameter in. to ft, Casing height above land surface -0.29 in. Weight lbs./ft. Well thickness or gauge No TYPE OF SCREEN OR PERFORATION MATERIAL: Steel Stainless Steel Fiberglass PVC X Other (Specify) Brass Galvanized Steel Concrete tile None used (open hole) SCREEN OR PERFORATION OPENINGS ARE: Continuous Slot X Mill Slot Gauze Wrapped Torch Cut Drilled Holes Other (Specify) Louvered Shutter Key Punched Wire Wrapped Saw Cut None (Open Hole) SCREEN-PERFORATED INTERVALS: From 3 ft. to 13 ft, From ft. to ft, From ft. to ft, From ft. to ft, GRAVEL PACK INTERVALS: From 2 ft. to 13 ft, From ft. to ft, From ft. to ft, From ft. to ft,

9 GROUT MATERIAL: Neat cement Cement grout Bentonite X Other Concrete: 0-0.5' Grout intervals: From 0.5 ft. to 2 ft, From ft. to ft, From ft. to ft,

Nearest source of possible contamination: Septic Tank Lateral Lines Pit Privy Livestock Pens Insecticide Storage Sewer Lines Cess Pool Sewage Lagoon X Fuel Storage Abandoned Water Well Watertight Sewer Lines Seepage Pit Feedyard Fertilizer Storage Oil Well / Gas Well Other (Specify): Direction from well? E Distance from well? ~335 ft

Table with columns: FROM, TO, LITHOLOGIC LOG, FROM, TO, LITHO. LOG (cont.) or PLUGGING INTERVALS. Rows: 0-1 Grass/topsoil, 1-10 Silty clay, 10-12 Clay, 12-13 Weathered limestone

Notes: KDHE ID: Saco Petroleum; U4-105-10699 Target of monitoring well is shallow groundwater, <20' of grout was installed at the direction of KDHE.

11 CONTRACTOR'S OR LANDOWNER'S CERTIFICATION: This water well was X constructed, reconstructed, or plugged under my jurisdiction and was completed on (mo-day-year) 8/5/21 and this record is true to the best of my knowledge and belief. Kansas Water Well Contractor's License No 757 This Water Well Record was completed on (mo-day-year) 8/30/21 under the business name of Larsen & Associates, Inc. Signature

NOTE: Figures exhibited within this report are only to be used within the context of this report. Placement of property lines, wells, structures, and roads is based on the available information from county appraiser maps, surveys, site visits, and/or previous vendor reports and should be considered approximate.

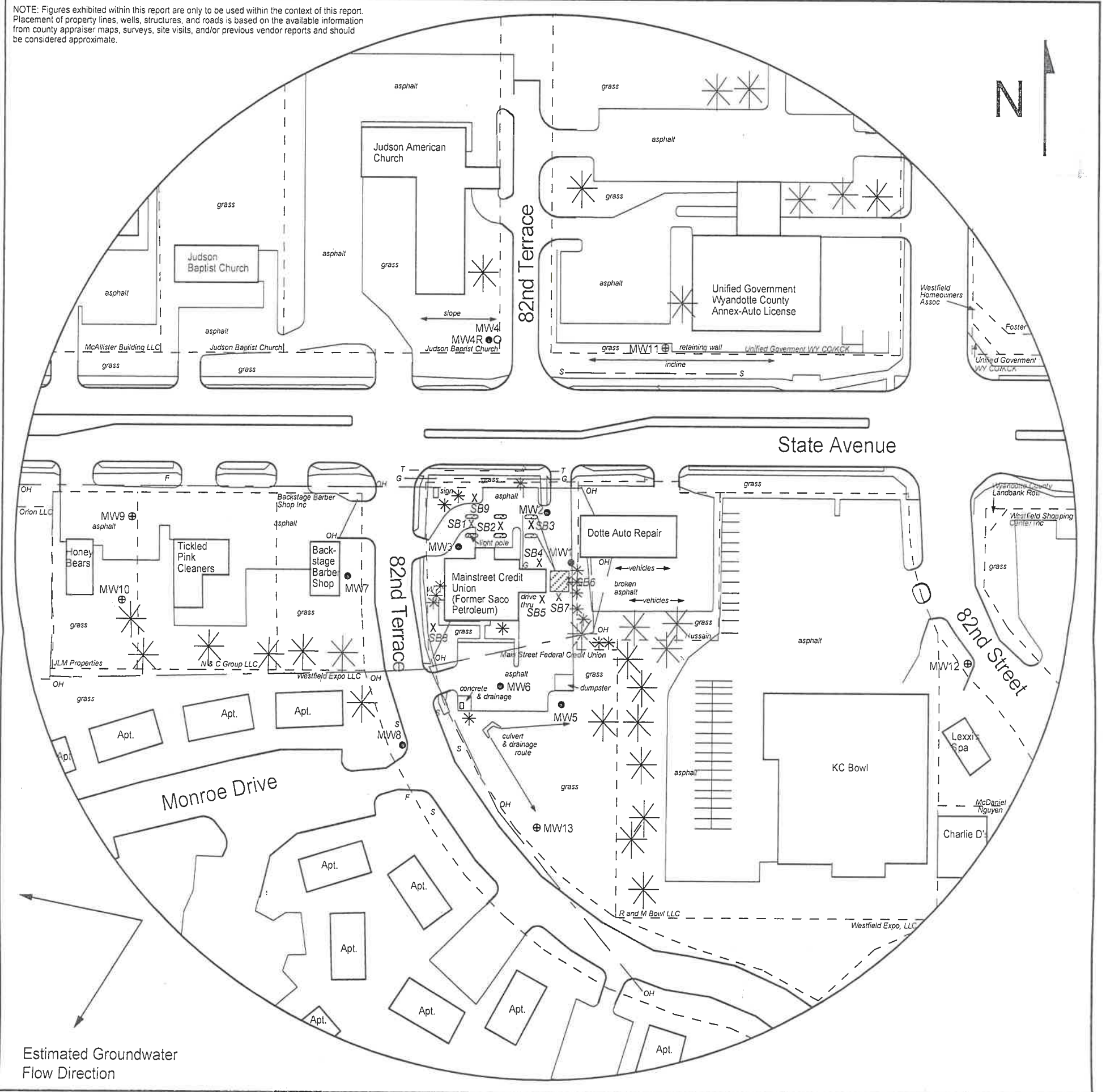

FIGURE 2.2 - 500 FT RADIUS AREA BASE MAP

LEGEND

- Approximate Location of Former UST Basin, Product Lines & Pump Islands
- Building with Basement
- Approximate Location of Property Line
- Existing Monitoring Well
- Monitoring Well (Installed 8/4-5/21)
- Soil Boring SB1 - SB9 (Drilled 11/12-14/19)
- Fire Hydrant
- Gas Lines (1.5 - 3 ft bgs)
- Overhead Lines (25'-40' high)
- Sewer Lines (2 - 6 ft bgs)
- Telephone Lines (2 - 6 ft bgs)
- Water Lines (2 - 6 ft bgs)

NOTE: Utility depths, heights and locations are approximate.



PROJECT:
 Saco Petroleum
 8245 State Ave.
 Kansas City, KS
 KDHE ID: U4-105-10699
 Date: 8/10/21



1311 E 25th St., Suite B 785-841-8707 office
 Lawrence, KS 66046 785-865-4282 fax

RECEIVED
 OCT 12 2021
 BUREAU OF WATER

DENNIS L HANDKE

1820 NW 59th Terrace
TOPEKA, KANSAS 66618
785-286-4047 Home

Jess Chapman
Larsen & Assoc.
1311 E. 25th St., Suite B
Lawrence, Kansas 66046

August 24, 2021
Revised September 1, 2021

RE: Monitor Well Elevation Survey
8245 State Ave, Kansas City, Kansas

Proj. 21-00Y
Saco Petroleum
KDHE ID U4-105-10699

Bench Mark: Square cut on North center of concrete storm sewer inlet near the North center of property on South curb of State Ave.

Elev.:		North	West	(from SE Cor. Sec. 8-11-24E)
MW-9	rim	938.14	North 5189.19	NE1/4,NW1/4,NE1/4,NW1/4
	top pipe	937.83	West 3420.24	Lat = 39.11611 Long = 94.77258
MW-10	rim	937.81	North 5116.47	NE1/4,NW1/4,NE1/4,NW1/4
	top pipe	937.52	West 3422.33	Lat = 39.11591 Long = 94.77259
MW-11	rim	958.62	North 5352.94	SE1/4,SE1/4,SE1/4,SW1/4 (Sec. 5-11-24E)
	top pipe	958.39	West 2910.71	Lat = 39.11656 Long = 94.77079
MW-12	rim	959.93	North 5052.40	NW1/4,NW1/4,NW1/4,NE1/4
	top pipe	959.66	West 2610.47	Lat = 39.11574 Long = 94.76973
MW-13	rim	941.59	North 4895.87	SW1/4,NE1/4,NE1/4,NW1/4
	top pipe	941.32	West 3034.97	Lat = 39.11531 Long = 94.77122

Lat & Long derived from Edwardsville 7.5' quad map. WGS84.

Elevation derived from existing project, NAVD 29.

If you have any questions, please feel free to call me. Thank you for the opportunity to be of service to you.

