

WATER WELL RECORD

Form WWC-5

Division of Water Resources App. No.

Well ID

MW15

Original Record Correction Change in Well Use

1 LOCATION OF WATER WELL: County Wyandotte Fraction SW 1/4 SE 1/4 SE 1/4 SW 1/4 Section Number 5 Township Number T 11 S Range Number R 24 E W

2 WELL OWNER: Last Name: Business: KDHE Address: 1000 SW Jackson City Topeka State: KS ZIP: 66612 Street or Rural Address where well is located (if unknown, distance and direction from nearest town or intersection): 8261 State Ave., Kansas City, KS

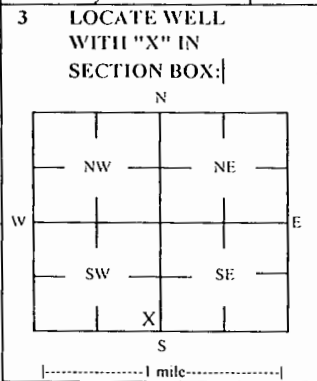

3 LOCATE WELL WITH "X" IN SECTION BOX: 4 DEPTH OF COMPLETED WELL: 21 ft Depth(s) Groundwater Encountered: 1) 21 ft 2) 3) 4) Dry Well WELL'S STATIC WATER LEVEL: 13.05 ft

5 Latitude: 39.11660 (decimal degrees) Longitude: 94.77210 (decimal degrees) Horizontal Datum: X WGS 84 NAD 83 NAD 27 Source for Latitude/Longitude: GPS (unit make/model): Land Survey Topographic Map Online Mapper

7 WELL WATER TO BE USED AS: 1 Domestic: Household Lawn & Garden Livestock Irrigation Feedlot Industrial 2 Public Water Supply: well ID 3 Dewatering: how many wells? 4 Aquifer Recharge: well ID 5 Monitoring: well ID MW15 6 Environmental Remediation: well ID 7 Air Sparge 8 Soil Vapor Extractor 9 Recovery 10 Injection 10 Oil Field Water Supply: lease 11 Test Hole: well ID 12 Geothermal: How many bores? a) Closed Loop Horizontal Vertical b) Open Loop Surface Discharge Inj. of Water Other (specify):

Was a chemical/bacteriological sample submitted to KDHE? Yes No If yes, date sample was submitted: Water well disinfected? Yes No

8 TYPE OF CASING USED: Steel PVC Other CASING JOINTS: Glued Clamped Welded Threaded Casing diameter 2 in. to 11 ft, Diameter in. to ft, Diameter in. to ft, Casing height above land surface -0.39 in. Weight lbs./ft. Well thickness or gauge No TYPE OF SCREEN OR PERFORATION MATERIAL: Steel Stainless Steel Fiberglass PVC Brass Galvanized Steel Concrete tile None used (open hole) SCREEN OR PERFORATION OPENINGS ARE: Continuous Slot Mill Slot Gauze Wrapped Torch Cut Drilled Holes Other (Specify) Louvered Shutter Key Punched Wire Wrapped Saw Cut None (Open Hole) SCREEN-PERFORATED INTERVALS: From 11 ft. to 21 ft, From ft. to ft, From ft. to ft, GRAVEL PACK INTERVALS: From 9 ft. to 21 ft, From ft. to ft, From ft. to ft,

9 GROUT MATERIAL: Neat cement Cement grout Bentonite Other Concrete: 0-0.5' Grout intervals: From 0.5 ft. to 9 ft, From ft. to ft, From ft. to ft, Nearest source of possible contamination: Septic Tank Lateral Lines Pit Privy Livestock Pens Insecticide Storage Sewer Lines Cess Pool Sewage Lagoon Fuel Storage Abandoned Water Well Watertight Sewer Lines Seepage Pit Feedyard Fertilizer Storage Oil Well / Gas Well Other (Specify): Direction from well? SE Distance from well? -250 ft

Table with columns: FROM, TO, LITHOLOGIC LOG, FROM, TO, LITHO. LOG (cont.) or PLUGGING INTERVALS. Rows: 0-1 Topsoil, 1-14 Clay, 14-21 Clay/sand

Notes: KDHE ID: Saco Petroleum; U4-105-10699

11 CONTRACTOR'S OR LANDOWNER'S CERTIFICATION: This water well was constructed, reconstructed, or plugged under my jurisdiction and was completed on (mo-day-year) 2/4/22 and this record is true to the best of my knowledge and belief. Kansas Water Well Contractors License No 757 This Water Well Record was completed on (mo-day-year) 4/11/22 under the business name of Larsen & Associates, Inc. Signature

Mail 1 white copy along with a fee of \$5.00 for each constructed well to: Kansas Department of Health and Environment, Bureau of Water, 1000 SW Jackson St., Suite 420, Topeka, Kansas 66612-1367. Mail one to Water Well Owner and retain one for your records. Telephone 785-296-5524.

Wyandotte

8-11-24E

DENNIS L HANDKE

1820 NW 59th Terrace
TOPEKA, KANSAS 66618
785-286-4047 Home

Jess Chapman
Larsen & Assoc.
1311 E. 25th St., Suite B
Lawrence, Kansas 66046

February 23, 2022

RE: Monitor Well Elevation Survey
8245 State Ave, Kansas City, Kansas

Proj. 22-00G
Saco Petroleum
KDHE ID U4-105-10699

Bench Mark: Square cut on North center of concrete storm sewer inlet near the North center of property on South curb of State Ave.

Elev.: 947.98 North 5242.27 West 3060.81 (from SE Cor. Sec. 8-11-24E)

MW-14 rim 940.18 North 5084.27 NW1/4,NE1/4,NE1/4,NW1/4
 top pipe 939.94 West 3276.01 Lat = 39.11582 Long = 94.77208

MW-15 rim 944.40 North 5368.96 SW1/4,SE1/4,SE1/4,SW1/4 (Sec. 5-11-24E)
 top pipe 944.01 West 3282.50 Lat = 39.11660 Long = 94.77210

Lat & Long derived from Edwardsville 7.5' quad map. WGS84.

Elevation derived from existing project, NAVD 29.

If you have any questions, please feel free to call me. Thank you for the opportunity to be of service to you.

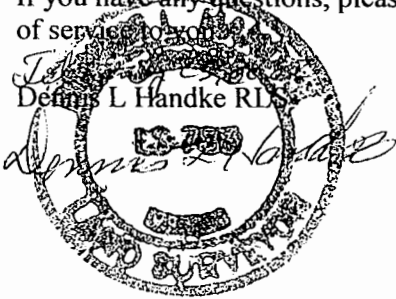

RECEIVED
APR 26 2022
BUREAU OF WATER

Wyandotte

NOTE: Figures exhibited within this report are only to be used within the context of this report. Placement of property lines, wells, structures, and roads is based on the available information from county appraiser maps, surveys, site visits, and/or previous vendor reports and should be considered approximate.

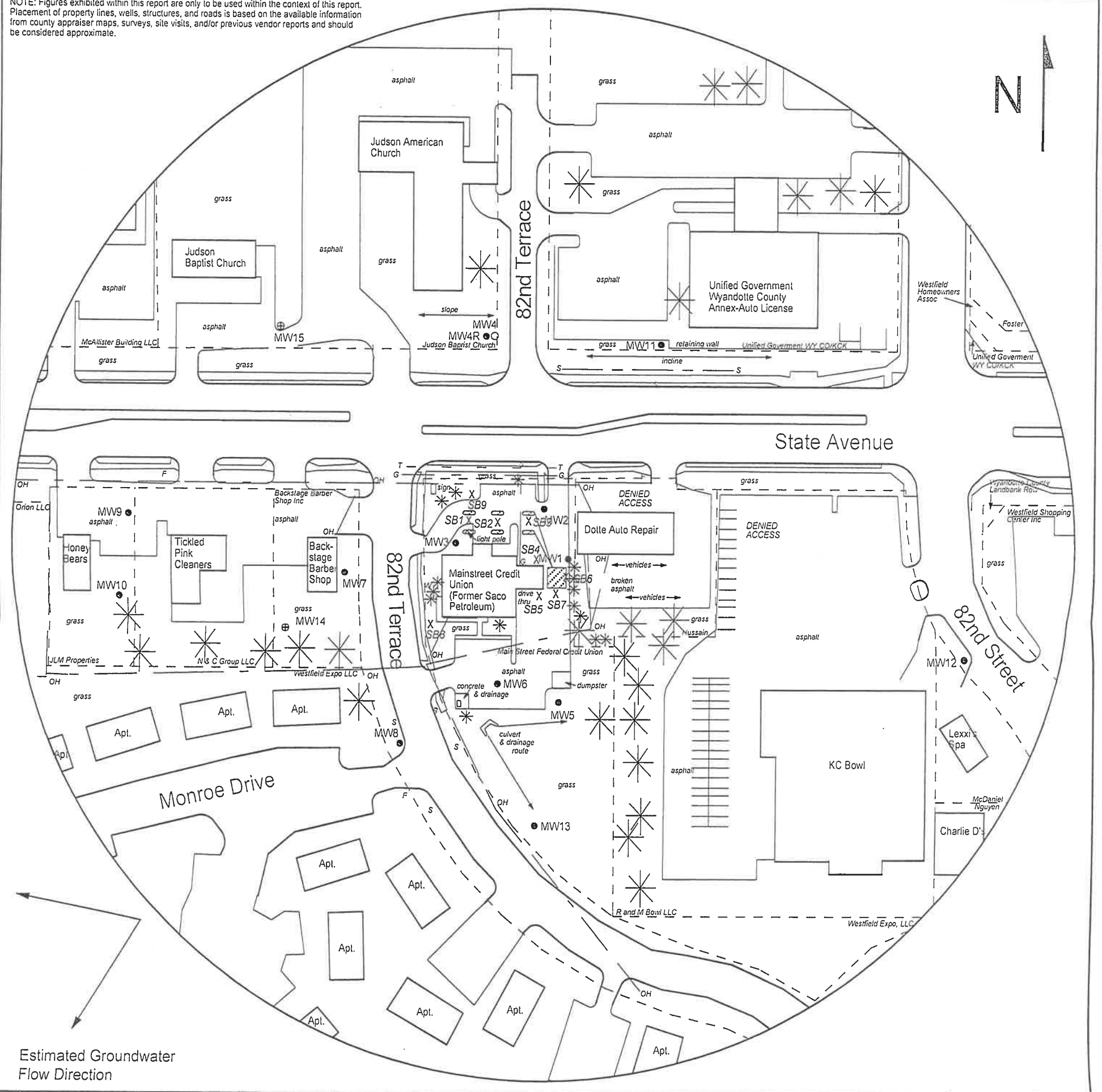

FIGURE 2.2 - 500 FT RADIUS AREA BASE MAP

LEGEND

- Approximate Location of Former UST Basin, Product Lines & Pump Islands
 - Building with Basement
 - Approximate Location of Property Line
 - Existing Monitoring Well
 - Plugged Well
 - New Monitoring Well (Installed 2/4/22)
 - Soil Boring SB1 - SB9 (Drilled 11/12-14/19)
 - Fire Hydrant
 - Gas Lines (1.5 - 3 ft bgs)
 - Overhead Lines (25'-40' high)
 - Sewer Lines (2 - 6 ft bgs)
 - Telephone Lines (2 - 6 ft bgs)
 - Water Lines (2 - 6 ft bgs)
- NOTE: Utility depths, heights and locations are approximate.

PROJECT:
 Saco Petroleum
 8245 State Ave.
 Kansas City, KS
 KDHE ID: U4-105-10699
 Date: 3/16/22



1311 E 25th St., Suite B 785-841-8707 office
 Lawrence, KS 66046 785-865-4282 fax

RECEIVED
 APR 26 2022
 BUREAU OF WATER

8-11-2016