

WATER WELL RECORD

Form WWC-5

Division of Water Resources App. No.

Well ID

MW2

Original Record Correction Change in Well Ust

1 LOCATION OF WATER WELL: County Wyandotte Fraction NW 1/4 NE 1/4 NW 1/4 NE 1/4 Section Number 8 Township Number T 11 S Range Number R 24 E

2 WELL OWNER: Last Name: Business: KDHE Address: 1000 SW Jackson St City Topeka State: KS ZIP: 66612 Street or Rural Address where well is located (if unknown, distance and direction from nearest town or intersection): If at owner's address, check here: -270' NW of N 80th Terr & Minnesota Ave., Kansas City, KS 66112

3 LOCATE WELL WITH "X" IN SECTION BOX: N NW NE SW SE S

4 DEPTH OF COMPLETED WELL: 34.5 ft Depth(s) Groundwater Encountered: 1) 2) 3) 4) Dry Well WELL'S STATIC WATER LEVEL: 28.3 ft below land surface, measured on (mo-day-yr) 1/27/2022

5 Latitude: 39.11571 (decimal degrees) Longitude: 94.76704 (decimal degrees) Horizontal Datum: WGS 84 NAD 83 NAD 27 Source for Latitude/Longitude: GPS (unit make/model) (WAAS enabled? Yes No) Land Survey Topographic Map Online Mapper

6 Elevation 953.06 ft Ground Level TOC Source: Land Survey GPS Topographic Map Other

7 WELL WATER TO BE USED AS: 1 Domestic: Household Lawn & Garden Livestock Irrigation Feedlot Industrial 2 Public Water Supply: well ID 3 Dewatering: how many wells? 4 Aquifer Recharge: well ID 5 Monitoring: well ID MW2 6 Environmental Remediation: well ID 7 Air Sparge 8 Soil Vapor Extractor 9 Recovery 10 Injection 10 Oil Field Water Supply: lease 11 Test Hole: well ID Cased Uncased Geotechnical 12 Geothermal: How many bores? a) Closed Loop Horizontal Vertical b) Open Loop Surface Discharge Inj. of Water Other (specify):

Was a chemical/bacteriological sample submitted to KDHE? Yes No If yes, date sample was submitted: Water well disinfected? Yes No

8 TYPE OF CASING USED: Steel PVC Other CASING JOINTS: Glued Clamped Welded Threaded Casing diameter 2 in. to 24.5 ft, Diameter in. to ft, Diameter in. to ft, Casing height above land surface -0.45 in. Weight lbs./ft. Well thickness or gauge No TYPE OF SCREEN OR PERFORATION MATERIAL: Steel Stainless Steel Fiberglass PVC Other (Specify) Brass Galvanized Steel Concrete tile None used (open hole) SCREEN OR PERFORATION OPENINGS ARE: Continuous Slot Mill Slot Gauze Wrapped Torch Cut Drilled Holes Other (Specify) Louvered Shutter Key Punched Wire Wrapped Saw Cut None (Open Hole) SCREEN-PERFORATED INTERVALS: From 24.5 ft. to 34.5 ft, From ft. to ft, From ft. to ft, GRAVEL PACK INTERVALS: From 22 ft. to 34.5 ft, From ft. to ft, From ft. to ft,

9 GROUT MATERIAL: Neat cement Cement grout Bentonite Other Concrete: 0-0.7' Grout intervals: From 0.7 ft. to 22 ft, From ft. to ft, From ft. to ft,

Nearest source of possible contamination: Septic Tank Lateral Lines Pit Privy Livestock Pens Insecticide Storage Sewer Lines Cess Pool Sewage Lagoon Fuel Storage Abandoned Water Well Watertight Sewer Lines Seepage Pit Feedyard Fertilizer Storage Oil Well / Gas Well Other (Specify) Dry cleaning Direction from well? SW Distance from well? ~95 ft

Table with 6 columns: FROM, TO, LITHOLOGIC LOG, FROM, TO, LITHO. LOG (cont.) or PLUGGING INTERVALS. Rows include Asphalt, Gravel, Clayey silt, Silty clay, Glacial till (clayey silt w/ silty sand & coarse gravel lenses), Limestone.

Notes: KDHE ID: Norge Village / Excel Cleaners C4-105-73681/73680 Target of monitoring well is shallow groundwater, <20' of grout was installed at the direction of KDHE.

11 CONTRACTOR'S OR LANDOWNER'S CERTIFICATION: This water well was constructed, reconstructed, or plugged under my jurisdiction and was completed on (mo-day-year) 12/14/22 and this record is true to the best of my knowledge and belief. Kansas Water Well Contractor's License No 757 This Water Well Record was completed on (mo-day-year) 2/15/22 under the business name of Larsen & Associates, Inc. Signature

Wyandotte

8-11-24E

# DENNIS L HANDKE

1820 NW 59th Terrace  
TOPEKA, KANSAS 66618  
785-286-4047 Home

Jess Chapman  
Larsen & Assoc.  
1311 E. 25<sup>th</sup> St., Suite B  
Lawrence, Kansas 66046

January 27, 2022

RE: Monitor Well Elevation Survey  
8129 State Ave, Kansas City, Kansas

Proj. 22-00D  
North Village Cleaners  
KDHE ID U4-105-73681

Bench Mark: Chisled X on top SW bolt on concrete parking lot light base #3.

Elev.: 967.83      North 5157.15      West 2137.54      (from SE Cor. Sec. 8-11-24E)

MW-1	rim	965.21	North	5172.27	NW1/4,NW1/4,NW1/4,NE1/4
	top pipe	964.59	West	2312.03	Lat = 39.11607    Long = 94.76867
MW-2	rim	953.51	North	4987.06	NW1/4,NE1/4,NW1/4,NE1/4
	top pipe	953.06	West	1775.92	Lat = 39.11571    Long = 94.76704
MW-3	rim	966.09	North	4881.73	SW1/4,NW1/4,NW1/4,NE1/4
	top pipe	965.63	West	2360.75	Lat = 39.11656    Long = 94.76579
MW-4	rim	966.67	North	4878.30	SW1/4,NE1/4,NW1/4,NE1/4
	top pipe	966.31	West	1865.24	Lat = 39.11527    Long = 94.76884
MW-5	rim	960.45	North	4828.02	SE1/4,NW1/4,NW1/4,NE1/4
	top pipe	960.01	West	2576.13	Lat = 39.11512    Long = 94.76960
MW-6	rim	958.11	North	4722.05	SW1/4,NW1/4,NW1/4,NE1/4
	top pipe	957.74	West	2483.26	Lat = 39.11483    Long = 94.76927
MW-7	rim	963.31	North	4798.02	SE1/4,NE1/4,NW1/4,NE1/4
	top pipe	962.96	West	1608.02	Lat = 39.11504    Long = 94.76619
MW-8	rim	946.27	North	4944.67	SE1/4,NE1/4,NW1/4,NE1/4
	top pipe	946.03	West	1417.53	Lat = 39.11545    Long = 94.76552

Lat & Long derived from Edwardsville 7.5' quad map. WGS84.

Elevation derived from Kansas City Public Works, NAVD 88.

If you have any questions, please feel free to call me. Thank you for the opportunity to be

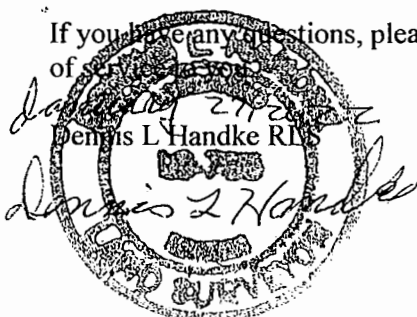

RECEIVED  
MAY 25 2022  
BUREAU OF WATER

NOTE: Figures exhibited within this report are only to be used within the context of this report. Placement of property lines, wells, structures, and roads is based on the available information from county appraiser maps, surveys, site visits, and/or previous vendor reports and should be considered approximate.

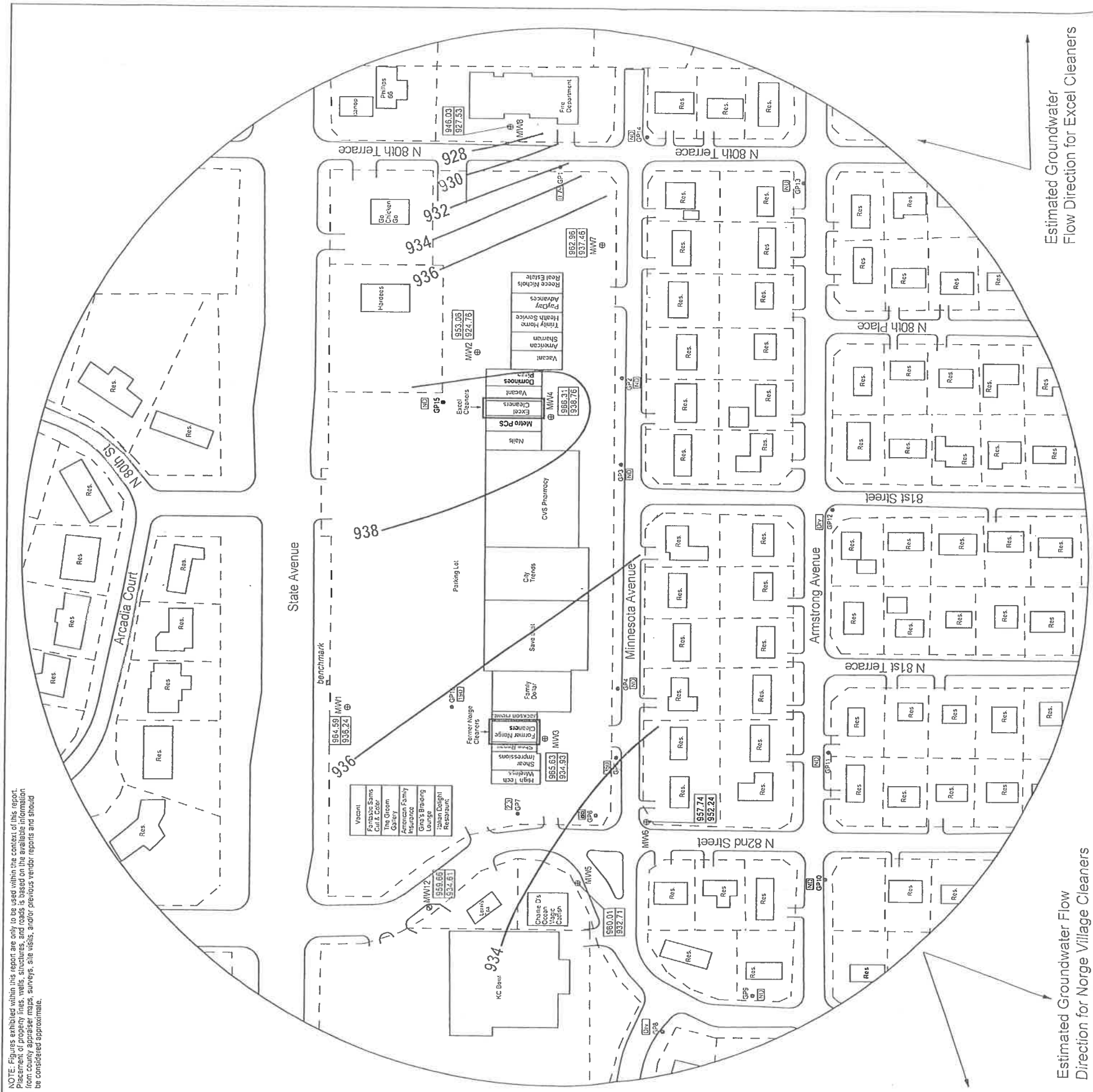

FIGURE 3 - GROUNDWATER FLOW MAP

LEGEND

- Approximate Location of Former UST Basin, Product Lines & Pump Islands
- Approximate Location of Property Line



1311 E 25th St., Suite B  
Lawrence, KS 66046

785-841-8707 office  
785-865-4282 fax

PROJECT:

Norge Village Cleaners  
8129 State Avenue  
Kansas City, KS  
KDHE ID: C4-105-73681  
Date: 1/27/22



Norge Village Cleaners  
8129 State Avenue  
Kansas City, KS  
KDHE ID: C4-105-73681  
Date: 1/27/22

- Monitoring Well nearby site Saco Petroleum (U4-105-10699)
- Monitoring Well (Installed 12/13-14/21, 12/16-17/21, 12/20/21)
- Casing Elevation (AMSL) 1307.80
- Groundwater Elevation (AMSL) 1290.97
- Equipotential Line (AMSL) 1291

NOTE: MW2 & MW5 is anomalous; therefore the data was not used to determine groundwater flow.

RECEIVED

MAY 25 2022

BUREAU OF WATER

8-11-24 E