

WATER WELL RECORD

Form WWC-5

Division of Water Resources App. No.

Well ID

MW8

Original Record [] Correction [X] Change in Well Use []

1 LOCATION OF WATER WELL: County Wyandotte, Fraction SE 1/4 NE 1/4 NW 1/4 NE 1/4, Section Number 8, Township Number T 11 S, Range Number R 24 E. 2 WELL OWNER: Last Name: Business: KDHE, Address: 1000 SW Jackson St, City: Topeka, State: KS, ZIP: 66612. Street or Rural Address where well is located (if unknown, distance and direction from nearest town or intersection): 1011 N 80th Terr., Kansas City, KS 66112. 3 LOCATE WELL WITH "X" IN SECTION BOX: [Diagram showing section box with 'X' in NE quadrant]. 4 DEPTH OF COMPLETED WELL: 21 ft. Depth(s) Groundwater Encountered: 1) _____ ft. 2) _____ ft. 3) _____ ft. or 4) [] Dry Well. WELL'S STATIC WATER LEVEL: 18.5 ft. [X] below land surface, measured on (mo-day-yr) 1/27/2022. [] above land surface, measured on (mo-day-yr) _____. Pump test data: Well water was _____ ft after _____ hours pumping _____ gpm. Water well was _____ ft after _____ hours pumping _____ gpm. Estimated Yield: _____ gpm. Bore Hole Diameter: 8.25 in to _____ ft, and _____ in to _____ ft. 5 Latitude: 39.11545 (decimal degrees), Longitude: 94.76552 (decimal degrees), Horizontal Datum [X] WGS 84 [] NAD 83 [] NAD 27. Source for Latitude/Longitude: [] GPS (unit make/model: _____) (WAAS enabled? [] Yes [] No) [X] Land Survey [] Topographic Map [] Online Mapper. 6 Elevation 946.03 ft [] Ground Level [X] TOC. Source [X] Land Survey [] GPS [] Topographic Map [] Other _____.

7 WELL WATER TO BE USED AS: 1 Domestic: [] Household [] Lawn & Garden [] Livestock [] Irrigation [] Feedlot [] Industrial. 2 Public Water Supply: well ID []. 3 Dewatering: how many wells? []. 4 Aquifer Recharge: well ID []. 5 Monitoring: well ID MW8 [X]. 6 Environmental Remediation: well ID []. 7 Air Sparge [], Soil Vapor Extractor [], Recovery [], Injection []. 8 Oil Field Water Supply: lease []. 9 Test Hole: well ID []. 10 Cased [], Uncased [], Geotechnical []. 11 Geothermal: How many bores? []. 12 a) Closed Loop [], Horizontal [], Vertical []. b) Open Loop [], Surface Discharge [], Inj. of Water []. Other (specify): _____.

Was a chemical/bacteriological sample submitted to KDHE? [] Yes [X] No. If yes, date sample was submitted: _____. Water well disinfected? [] Yes [X] No.

8 TYPE OF CASING USED: [] Steel [X] PVC [] Other _____. CASING JOINTS: [] Glued [] Clamped [] Welded [X] Threaded. Casing diameter 2 in. to 11 ft, Diameter _____ in. to _____ ft, Diameter _____ in. to _____ ft. Casing height above land surface -0.24 in. Weight _____ lbs./ft. Well thickness or gauge No _____. TYPE OF SCREEN OR PERFORATION MATERIAL: [] Steel [] Stainless Steel [] Fiberglass [X] PVC [] Other (Specify) _____. [] Brass [] Galvanized Steel [] Concrete tile [] None used (open hole). SCREEN OR PERFORATION OPENINGS ARE: [] Continuous Slot [X] Mill Slot [] Gauze Wrapped [] Torch Cut [] Drilled Holes [] Other (Specify) _____. [] Louvered Shutter [] Key Punched [] Wire Wrapped [] Saw Cut [] None (Open Hole). SCREEN-PERFORATED INTERVALS: From 11 ft. to 21 ft, From _____ ft. to _____ ft, From _____ ft. to _____ ft. GRAVEL PACK INTERVALS: From 9 ft. to 21 ft, From _____ ft. to _____ ft, From _____ ft. to _____ ft.

9 GROUT MATERIAL: [] Neat cement [] Cement grout [X] Bentonite [X] Other Concrete: 0-0.5'. Grout intervals: From 0.5 ft. to 9 ft, From _____ ft. to _____ ft, From _____ ft. to _____ ft.

Nearest source of possible contamination: [] Septic Tank [] Lateral Lines [] Pit Privy [] Livestock Pens [] Insecticide Storage [] Sewer Lines [] Cess Pool [] Sewage Lagoon [] Fuel Storage [] Abandoned Water Well [] Watertight Sewer Lines [] Seepage Pit [] Feedyard [] Fertilizer Storage [] Oil Well / Gas Well [X] Other (Specify) Dry cleaning. Direction from well? W Distance from well? ~400 ft.

Table with 6 columns: FROM, TO, LITHOLOGIC LOG, FROM, TO, LITHO. LOG (cont.) or PLUGGING INTERVALS. Row 1: 0, 1, Topsoil, , , . Row 2: 1, 18, Clay, , , . Row 3: 18, 21, Shale, , , .

Notes: KDHE ID: Norge Village / Excel Cleaners C4-105-73681/73680. Target of monitoring well is shallow groundwater. <20' of grout was installed at the direction of KDHE.

11 CONTRACTOR'S OR LANDOWNER'S CERTIFICATION: This water well was [X] constructed, [] reconstructed, or [] plugged under my jurisdiction and was completed on (mo-day-year) 1/13/22 and this record is true to the best of my knowledge and belief. Kansas Water Well Contractor's License No 757. This Water Well Record was completed on (mo-day-year) 2/15/22 under the business name of Larsen & Associates, Inc. Signature _____

Wyandotte

8-11-24E

DENNIS L HANDKE

1820 NW 59th Terrace
TOPEKA, KANSAS 66618
785-286-4047 Home

Jess Chapman
Larsen & Assoc.
1311 E. 25th St., Suite B
Lawrence, Kansas 66046

January 27, 2022

RE: Monitor Well Elevation Survey
8129 State Ave, Kansas City, Kansas

Proj. 22-00D
North Village Cleaners
KDHE ID U4-105-73681

Bench Mark: Chisled X on top SW bolt on concrete parking lot light base #3.

Elev.: 967.83 North 5157.15 West 2137.54 (from SE Cor. Sec. 8-11-24E)

MW-1	rim	965.21	North	5172.27	NW1/4,NW1/4,NW1/4,NE1/4
	top pipe	964.59	West	2312.03	Lat = 39.11607 Long = 94.76867
MW-2	rim	953.51	North	4987.06	NW1/4,NE1/4,NW1/4,NE1/4
	top pipe	953.06	West	1775.92	Lat = 39.11571 Long = 94.76704
MW-3	rim	966.09	North	4881.73	SW1/4,NW1/4,NW1/4,NE1/4
	top pipe	965.63	West	2360.75	Lat = 39.11656 Long = 94.76579
MW-4	rim	966.67	North	4878.30	SW1/4,NE1/4,NW1/4,NE1/4
	top pipe	966.31	West	1865.24	Lat = 39.11527 Long = 94.76884
MW-5	rim	960.45	North	4828.02	SE1/4,NW1/4,NW1/4,NE1/4
	top pipe	960.01	West	2576.13	Lat = 39.11512 Long = 94.76960
MW-6	rim	958.11	North	4722.05	SW1/4,NW1/4,NW1/4,NE1/4
	top pipe	957.74	West	2483.26	Lat = 39.11483 Long = 94.76927
MW-7	rim	963.31	North	4798.02	SE1/4,NE1/4,NW1/4,NE1/4
	top pipe	962.96	West	1608.02	Lat = 39.11504 Long = 94.76619
MW-8	rim	946.27	North	4944.67	SE1/4,NE1/4,NW1/4,NE1/4
	top pipe	946.03	West	1417.53	Lat = 39.11545 Long = 94.76552

Lat & Long derived from Edwardsville 7.5' quad map. WGS84.

Elevation derived from Kansas City Public Works, NAVD 88.

If you have any questions, please feel free to call me. Thank you for the opportunity to be

RECEIVED

MAY 25 2022

BUREAU OF WATER

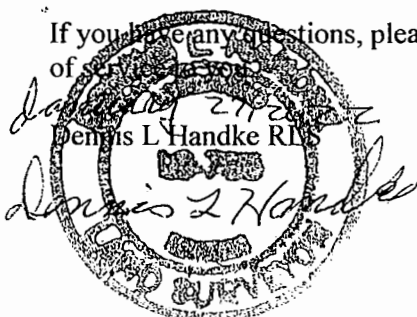

NOTE: Figures exhibited within this report are only to be used within the context of this report. Placement of property lines, wells, structures, and roads is based on the available information from county appraiser maps, surveys, site visits, and/or previous vendor reports and should be considered approximate.

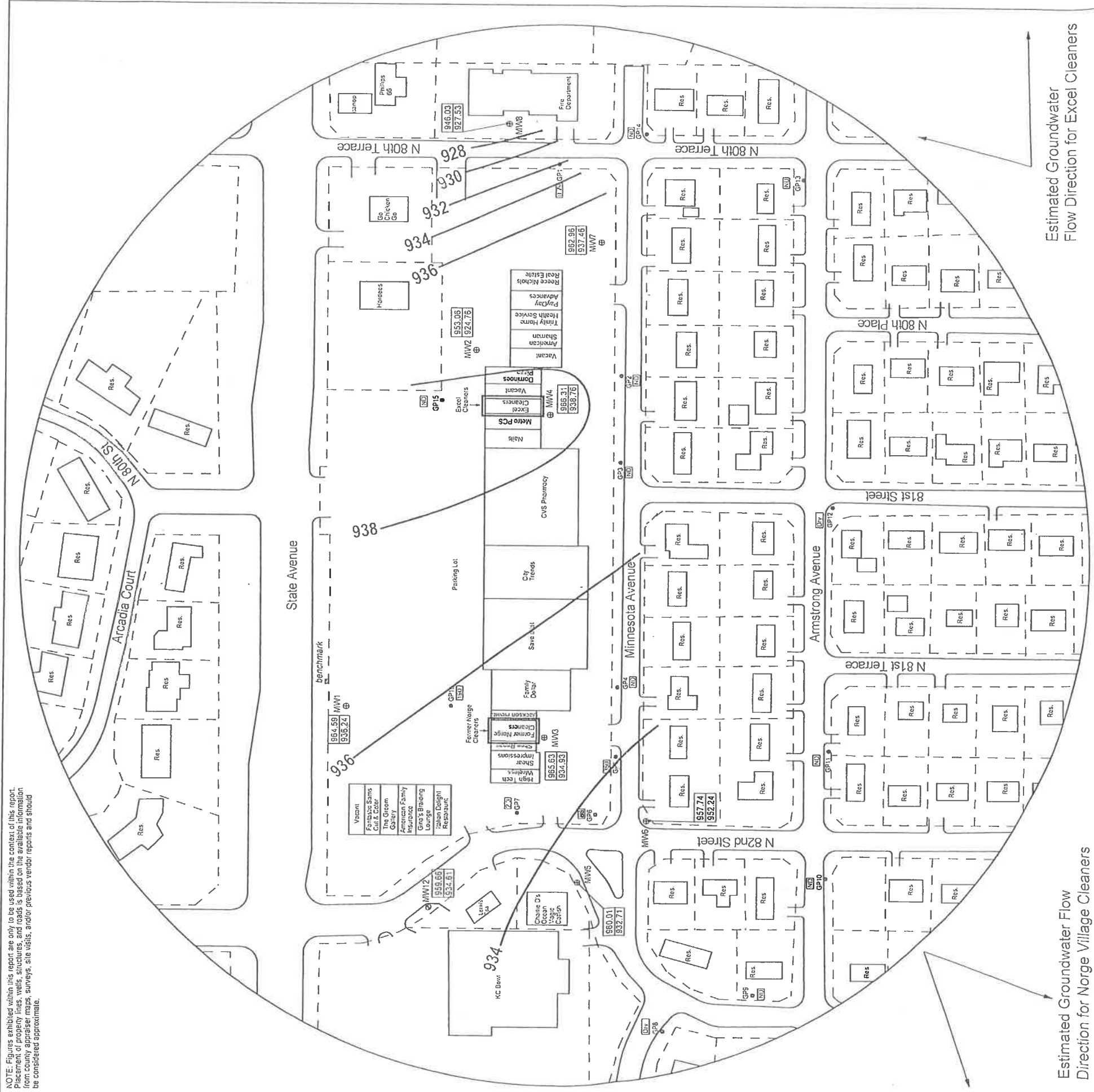

Estimated Groundwater Flow Direction for Norge Village Cleaners

Estimated Groundwater Flow Direction for Excel Cleaners

FIGURE 3 - GROUNDWATER FLOW MAP

LEGEND

- Approximate Location of Former UST Basin, Product Lines & Pump Islands
- Approximate Location of Property Line
- Monitoring Well nearby site Saco Petroleum (U4-105-10699)
- Monitoring Well (Installed 12/13-14/21, 12/16-17/21, 12/20/21)
- Casing Elevation (AMSL) 1307.80
- Groundwater Elevation (AMSL) 1290.97
- Equipotential Line (AMSL) 1291

NOTE: MW2 & MW5 is anomalous; therefore the data was not used to determine groundwater flow.

PROJECT:

Norge Village Cleaners
 8129 State Avenue
 Kansas City, KS
 KDHE ID: C4-105-73681
 Date: 1/27/22

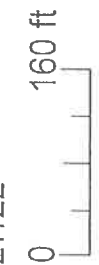

1311 E 25th St., Suite B
 Lawrence, KS 66046
 785-841-8707 office
 785-865-4282 fax

RECEIVED

MAY 25 2022

BUREAU OF WATER

8-11-24E