

CORRECTION(S) TO WATER WELL RECORD (WWC-5)

(to rectify lacking or incorrect information)

County: Wyandotte

Location listed as:

Section-Township-Range: 2-115-25E

Fraction ($\frac{1}{4}$ $\frac{1}{4}$ $\frac{1}{4}$): NW NE NW

Location changed to:

2-115-25E

W2 E2 NE NW

Other changes: Initial statements: _____

Changed to: _____

Comments: _____

verification method: Map of well locations from owner, and
North Kansas City 1:24,000 topo. map.

initials: DRL date: 9/15/2005

submitted by: Kansas Geological Survey, Data Resources Library, 1930 Constant Ave., Lawrence, KS 66047-3726
to: Kansas Dept of Health & Environment, Bureau of Water, 1000 SW Jackson, Suite 420, Topeka, KS 66612-1367.

INSTRUCTIONS: Use typewriter or ball point pen. PLEASE PRESS FIRMLY and PRINT clearly. Please fill in blanks, underline or circle the correct answers. Send top three copies to Kansas Department of Health and Environment, Bureau of Water, Geology Section, 1000 SW Jackson St., Suite 420, Topeka, Kansas 66612-1367. Telephone 785-296-5522. Send one to WATER WELL OWNER and retain one for your records. Fee of \$5.00 for each constructed well.



PROJECT NUMBER 321564.SI.01	BORING NUMBER MW-304S
SHEET 1 OF 1	
SOIL BORING LOG	

PROJECT : Conoco Phillips - Supplemental SI	NORTHING: 306913.69 EASTING: 2275236.78
Elevation: 749.62 ft b.t.o.c.	DRILLING CONTRACTOR : Max's Enterprises Inc.
DRILLING METHOD AND EQUIPMENT USED : CME 750 ATV, HSA	LOGGER : C. Morris
WATER LEVELS : 26' bgs	START : 11/04/04 1015 END : 11/04/04 1045

DEPTH BELOW SURFACE (FT)	INTERVAL (FT)	RECOVERY (FT)	#/TYPE	STANDARD PENETRATION TEST RESULTS	SOIL DESCRIPTION	COMMENTS
				6"-6"-6" (N)	SOIL NAME, USCS GROUP SYMBOL, COLOR, MOISTURE CONTENT, RELATIVE DENSITY, OR CONSISTENCY, SOIL STRUCTURE, MINERALOGY.	DEPTH OF CASING, DRILLING RATE, DRILLING FLUID LOSS, TESTS, AND INSTRUMENTATION.
						Notes
	No Soil Sampling				0.0': Silty sand (SM), tan, moist, loose, fine stained 1.0': Silty sand (SM), stained brown to black, gravel/asphalt present 5.0': Poorly graded sand with gravel (SP), reddish brown, moist, loose, strong odor (HC/creosote like) 7.0': Layered gray to black staining and sheen oily/product appearance 8.0': Poorly graded sand (SP), gray to black, moist, strong odor, product/oily sheen 9.0': Silty clay (CL) with some fine sand, gray to black, moist, soft, plastic, strong odor, sheen/oily 11.0': Sandy silt with some gravel (ML), dark olive gray, moist, plastic, soft, sheen but oil does not squeeze out 15.0': Increasing fine sands 17.0': Sandy silt (ML), gray to black, wet, soft, strong highly plastic, strong odor, sheen/oily appearance 18.5': Silty sand (SM), gray to black, wet, soft, highly plastic, strong odor, sheen/oily appearance 22.0': Poorly graded sand (SP), medium gray, moist, poorly sorted, strong odor 26.0': Encounter water 28.0': Poorly graded sand (SP), grading to light medium gray with some black staining, moist to wet, fine to medium, strong odor 32.0': Sand grading fine to coarse 35.0': End of boring	

R25E

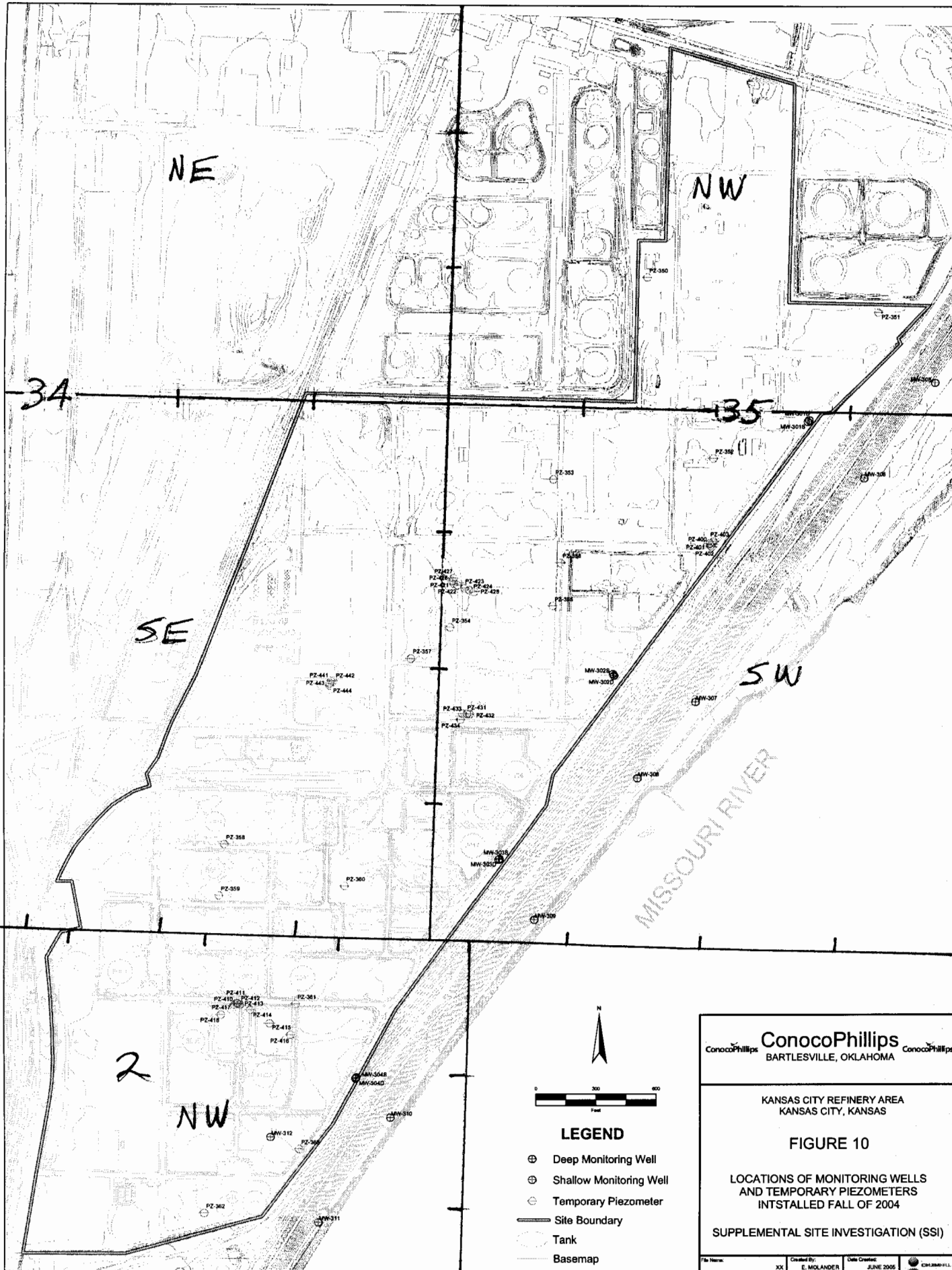

ConocoPhillips
BARTLESVILLE, OKLAHOMA

KANSAS CITY REFINERY AREA
KANSAS CITY, KANSAS

FIGURE 10

LOCATIONS OF MONITORING WELLS
AND TEMPORARY PIEZOMETERS
INSTALLED FALL OF 2004

SUPPLEMENTAL SITE INVESTIGATION (SSI)

File Name:	Created By:	Date Created:	
XX	E. MOLANDER	JUNE 2005	