

WATER WELL PLUGGING RECORD Form WWC-5P

KSA 82a-1212

ID NO.

22-19

1 LOCATION OF WATER WELL: County: <u>Wyandotte</u>	Fraction <u>SE 1/4 SW 1/4 NE 1/4 NE 1/4</u>	Section Number <u>19</u>	Township Number <u>T 11 S</u>	Range Number <u>25</u> <input checked="" type="checkbox"/> E <input type="checkbox"/> W
---	--	-----------------------------	----------------------------------	--

Street/Rural Address of Well Location; if unknown, distance & direction from nearest town or intersection: If at owner's address, check here ☐ Fairbanks Morse
3601 Fairbanks Ave., Kansas City, KS

Global Positioning Systems (GPS) information:
Latitude: 39° 05.0662 (in decimal degrees)
Longitude: 94° 40.2223 (in decimal degrees)
Elevation: _____
Datum: ☐ WGS84, ☐ NAD83, ☐ NAD27
Collection Method: _____

2 WATER WELL OWNER: SPX Corporation-FuPC
RR#, St. Address, Box #: 13320 Ballantyne Corp. Pl.
City, State ZIP Code: Charlotte, NC 28277

☐ GPS unit (Make/Model): _____
☒ Digital Map/Photo, ☐ Topographic Map, ☐ Land Survey
Est. Accuracy: ☐ < 3 m, ☒ 3-5 m, ☐ 5-15 m, ☐ > 15 m

3 MARK WELL'S LOCATION WITH AN "X" IN SECTION BOX:

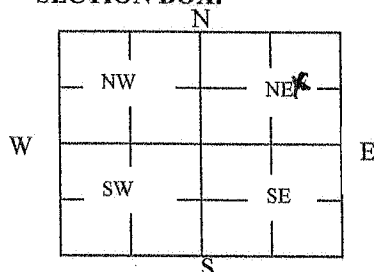

4 DEPTH OF WELL 40.68 ft.

WELL'S STATIC WATER LEVE 38.47 ft

WELL WAS USED AS:

☐ Domestic
☐ Irrigation
☐ Feedlot
☐ Industrial

☐ Public Water Supply
☐ Oil Field Water Supply
☐ Domestic (Lawn & Garden)
☐ Air Conditioning

☐ Dewatering
☒ Monitoring
☐ Injection Well
☐ Other _____

Was a chemical/bacteriological sample submitted to Department? Yes ☐ No ☐

5 TYPE OF BLANK CASING USED:

☐ Steel ☐ RMP (SR) ☐ Wrought ☐ Fiberglass ☐ Other (Specify below)
☒ PVC ☐ ABS ☐ Asbestos-Cement ☐ Concrete Tile

Blank casing diameter 2 in. Was casing pulled? Yes ☒ No ☐ If yes, how much 4.5'
Casing height above or below land surface 15.48 in.

6 GROUT PLUG MATERIAL: ☐ Neat cement ☐ Cement grout ☒ Bentonite ☐ Other _____

Grout Plug Intervals: From 40.68 ft. to 3 ft., From _____ ft. to _____ ft., From _____ to _____ ft.

What is the nearest source of possible contamination:

☐ Septic tank
☐ Sewer lines
☐ Watertight sewer lines
☐ Lateral lines
☐ Cess pool

☐ Seepage pit
☐ Pit privy
☐ Sewage lagoon
☐ Feedyard
☐ Livestock pens

☐ Fuel Storage
☐ Fertilizer storage
☐ Insecticide storage
☐ Abandoned water well
☐ Oil well/Gas well

☐ Other (specify below) _____

Direction from well? _____
How many feet? _____

FROM	TO	PLUGGING MATERIALS	FROM	TO	PLUGGING MATERIALS
<u>40.68</u>	<u>3</u>	<u>CLWP Bentonite</u>			
<u>3</u>	<u>0</u>	<u>Soil</u>			

7 CONTRACTOR'S OR LANDOWNER'S CERTIFICATION: This water well was plugged under my jurisdiction and was completed on (mo/day/year) 1/15/14 and this record is true to the best of my knowledge and belief. Kansas Water Well Contractor's License No. _____ This Water Well Record was completed on (mo/day/year) 1/15/14 under the business name of Knightly Environmental Inc. by (signature) [Signature]

INSTRUCTIONS: Use typewriter or ballpoint pen. Please press firmly and print clearly. Please fill in blanks, underline or circle the correct answers. Send top three copies to Kansas Department of Health and Environment, Bureau of Water, Geology Section, 1000 SW Jackson St., Ste. 420, Topeka, Kansas 66612-1367. Telephone: 785/296-5524. Send one to Water Well Owner and retain one for your records. Visit us at <http://www.kdheks.gov/waterwell/index.html>.

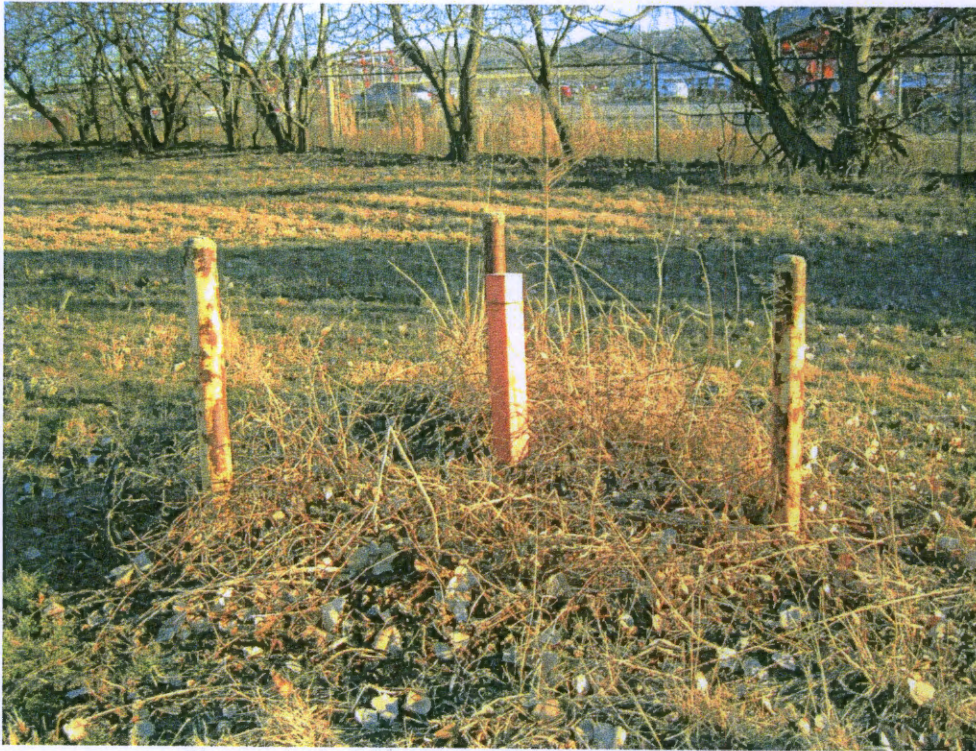

Photograph 21 – MW-19 before plugging. J. Knightly, 1/14/14.

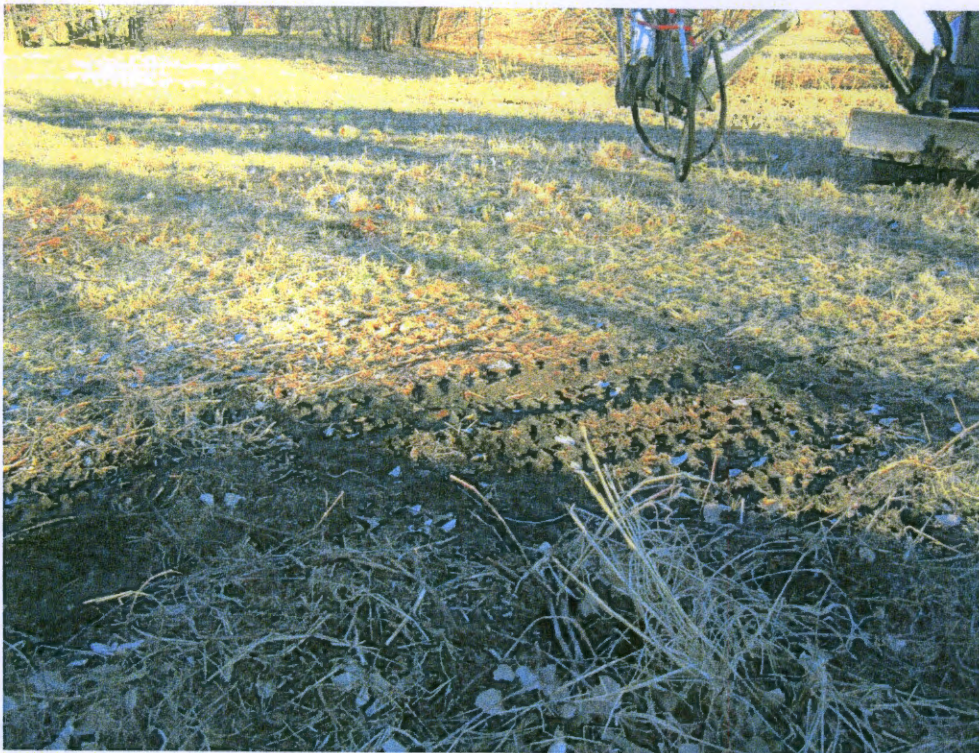

Photograph 22 – MW-19 post plugging. J. Knightly, 1/17/14.