

WATER WELL RECORD

Form WWC-5

Division of Water Resources App. No.

Well ID

MW10

Original Record Correction Change in Well Use

1 LOCATION OF WATER WELL: County Wyandotte Fraction SE 1/4 NW 1/4 SW 1/4 Section Number 3 Township Number T 11 S Range Number R 25 E W

2 WELL OWNER: Last Name Kiayani First: A. Street or Rural Address where well is located (if unknown, distance and direction from nearest town or intersection): If at owner's address, check here: ~210' N of 748 Washington Blvd., Kansas City, KS

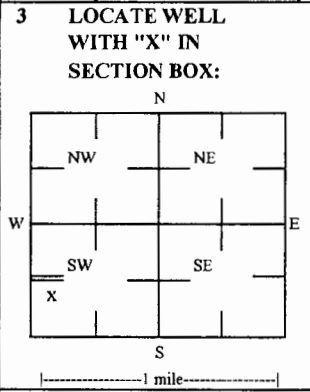

3 LOCATE WELL WITH 'X' IN SECTION BOX: 4 DEPTH OF COMPLETED WELL: 25 ft Depth(s) Groundwater Encountered: 1) ft 2) ft 3) ft, or 4) Dry Well WELL'S STATIC WATER LEVEL: 15.39 ft

5 Latitude: 39.11962 (decimal degrees) Longitude: 94.62903 (decimal degrees) Horizontal Datum: WGS 84 X NAD 83 NAD 27 Source for Latitude/Longitude: X Land Survey Topographic Map Online Mapper

6 Elevation 830.51 ft Ground Level X TOC Source X Land Survey GPS Topographic Map Other

7 WELL WATER TO BE USED AS: 1 Domestic: Household Lawn & Garden Livestock Irrigation Feedlot Industrial 2 Public Water Supply: well ID 3 Dewatering: how many wells? 4 Aquifer Recharge: well ID 5 Monitoring: well ID MW10 6 Environmental Remediation: well ID Air Sparge Soil Vapor Extraction Recovery Injection 7 Oil Field Water Supply: lease 8 Test Hole: well ID Cased Uncased Geotechnical 9 Geothermal: How many bores? a) Closed Loop Horizontal Vertical b) Open Loop Surface Discharge Inj. of Water Other (specify):

Was a chemical/bacteriological sample submitted to KDHE? Yes No X If yes, date sample was submitted:

8 TYPE OF CASING USED: Steel PVC Other CASING JOINTS: Glued Clamped Welded X Threaded Casting diameter 2 in. to 10 ft, Diameter in. to ft, Diameter in. to ft, Casing height above land surface -0.34 in. Weight lbs./ft. Wall thickness or gauge No TYPE OF SCREEN OR PERFORATION MATERIAL: Steel Stainless Steel Fiberglass PVC Other (Specify) SCREEN OR PERFORATION OPENINGS ARE: Continuous Slot X Mill Slot Gauze Wrapped Torch Cut Drilled Holes Other (Specify) Louvered Shutter Key Punched Wire Wrapped Saw Cut None (Open Hole) SCREEN-PERFORATED INTERVALS: From 10 ft. to 25 ft. From ft. to ft. From ft. to ft. GRAVEL PACK INTERVALS: From 8 ft. to 25 ft. From ft. to ft. From ft. to ft.

9 GROUT MATERIAL: Neat cement Cement grout X Bentonite X Other Concrete: 0-1' Grout intervals: From 1 ft. to 8 ft. From ft. to ft. From ft. to ft.

Nearest source of possible contamination: Septic Tank Lateral Lines Pit Privy Livestock Pens Insecticide Storage Sewer Lines Cess Pool Sewage Lagoon X Fuel Storage Abandoned Water Well Watertight Sewer Lines Seepage Pit Feedyard Fertilizer Storage Oil Well / Gas Well Other (Specify)

Direction from well? S-SW Distance from well? ~210 ft

Table with columns: 10 FROM, TO, LITHOLOGIC LOG, FROM, TO, LITHO. LOG (cont.) or PLUGGING INTERVALS. Row 1: 0, 18, Topsoil: silty clay. Row 2: 18, 25, Glacial till, some silt, sand, gravel.

Notes: KDHE ID: Snappy C-Store; U4-105-14678 Target of monitoring well is shallow groundwater, <20' of grout was installed at the direction of KDHE.



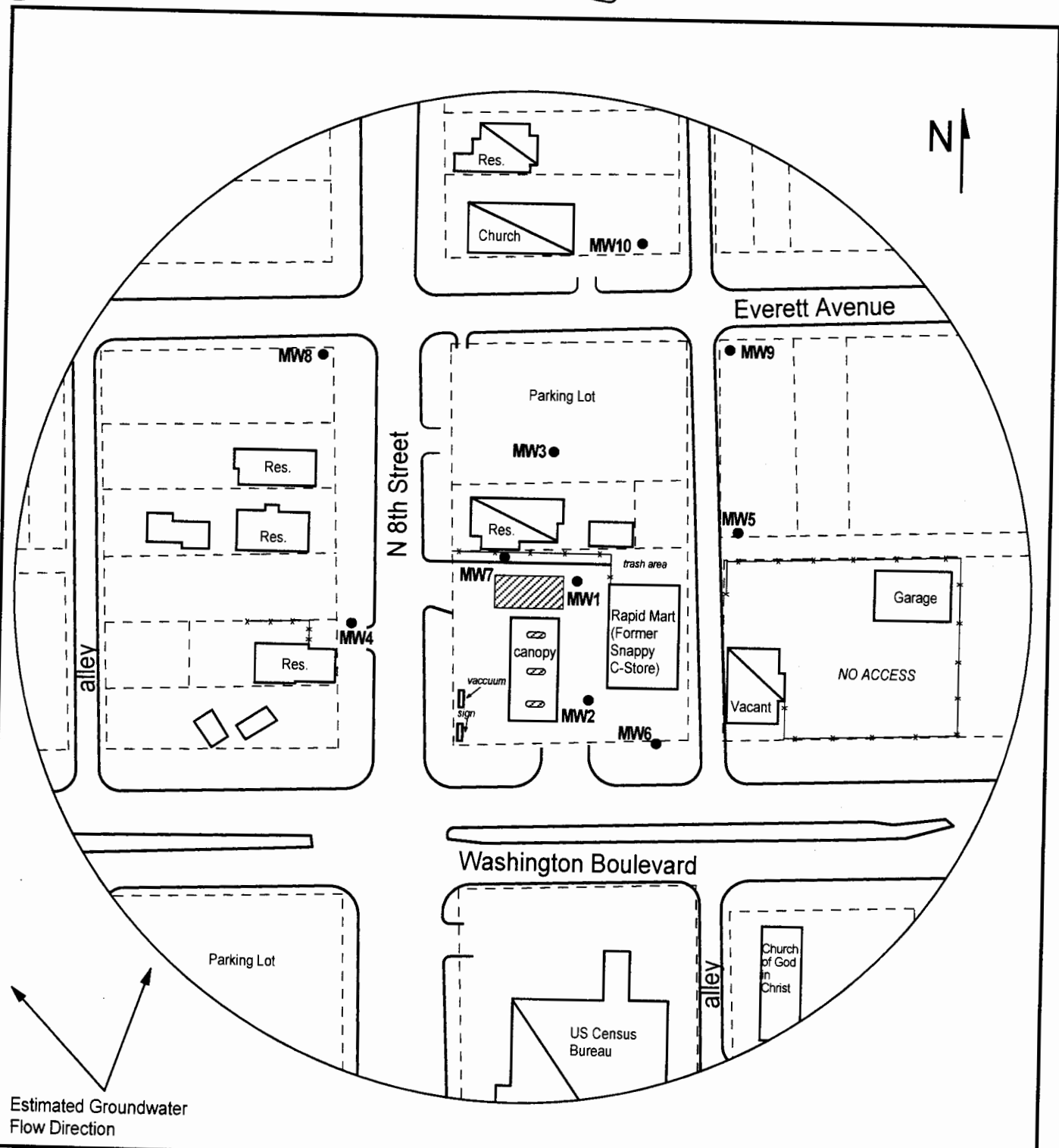

11 CONTRACTOR'S OR LANDOWNER'S CERTIFICATION: This water well was X constructed, reconstructed, or plugged under my jurisdiction and was completed on (mo-day-year) 8/1/2017 and this record is true to the best of my knowledge and belief. Kansas Water Well Contractor's License No 757 This Water Well Record was completed on (mo-day-year) 9/7/2017 under th business name of Larsen & Associates Signature

Mail 1 white copy along with a fee of \$5.00 for each constructed well to: Kansas Department of Health and Environment, Bureau of Water/GWPS Section, 1000 SW Jackson St., Suite 420, Topeka, Kansas 66612-1367. Mail one to Water Well Owner and retain one for



Estimated Groundwater Flow Direction

LEGEND:

-  Approximate Location of Active UST Basin and Pump Islands
-  Building with Basement
-  Approximate Location of Property Line
-  Existing Monitoring Well

PROJECT:

Snappy C-Store
 748 Washington Blvd
 Kansas City, KS
 KDHE ID: U4-105-14678/14990
 Date: 4/24/18



1311 E 25th St., Suite B (785) 841-8707 office
 Lawrence, KS 66046 (785) 865-4282 fax

NOTE: Location of active product line is unknown.

Wyandotte

3-11-25E

DENNIS L. HANDKE

1820 NW 59th Terrace
TOPEKA, KANSAS 66618
785-286-4047 Home
785-286-1990 Fax

Jessica Chapman
Larsen & Associates
1311 E. 25th Street, Suite B
Lawrence, Kansas, 66046

September 1, 2017

RE: Monitor Well Elevation Survey
748 Washington Blvd., Kansas City, Kansas

Proj. 17-00Z
Snappy C-Store
KDHE ID U4-105-14678

Bench Mark: Square cut on SW corner of concrete sidewalk at SW Corner of building.
Elev: 852.71 North 815 West 4832 (from SE Cor. Sec.3-11-25E)

MW-8	rim	842.17	North	1051	SW1/4,NW1/4,SW1/4,SW1/4
	top pipe	841.85	West	5020	Lat= 39.11944 Long = 94.62977
MW-9	rim	828.53	North	1049	SE1/4,NW1/4,SW1/4,SW1/4
	top pipe	828.08	West	4752	Lat= 39.11943 Long = 94.62883
MW-10	rim	830.85	North	1116	SE1/4,NW1/4,SW1/4,SW1/4
	top pipe	830.51	West	4810	Lat= 39.11962 Long = 94.62903

Elevation derived from existing project. NAVD 88

Lat & Long derived from Shawnee 7.5 Quad Map WSG84

If you have any questions, please feel free to call me. Thank you for the opportunity to be of service to you.

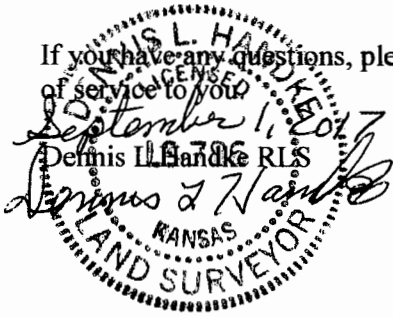

RECEIVED

MAY 25 2018

BUREAU OF WATER