

WATER WELL RECORD Form WWC-5

Original Record Correction Change in Well Use

Division of Water Resources App. No.

Well ID

MW 17

1 LOCATION OF WATER WELL: County: Wyandotte Fraction 1/4 SW 1/4 SE 1/4 SW 1/4 Section Number 5 Township Number T 11 S Range Number R 25 E W

2 WELL OWNER: Last Name: First: Street or Rural Address where well is located (if unknown, distance and direction from nearest town or intersection): If at owner's address, check here: Business: BP Products North America Address: 28100 Torch Parkway City: Warrenville State: IL ZIP: 60555 2859 State Avenue Kansas City, KS 66102

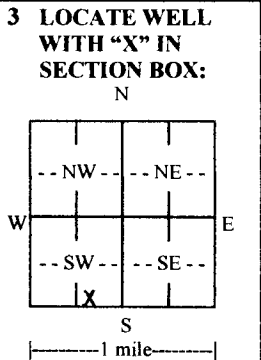

3 LOCATE WELL WITH 'X' IN SECTION BOX: 4 DEPTH OF COMPLETED WELL: 30 ft. Depth(s) Groundwater Encountered: 1) 18 ft. 2) ... 3) ... 4) Dry Well WELL'S STATIC WATER LEVEL: below land surface, measured on (mo-day-yr) above land surface, measured on (mo-day-yr) Pump test data: Well water was N/A ft. after N/A hours pumping N/A gpm Well water was N/A ft. after N/A hours pumping N/A gpm Estimated Yield: N/A gpm Bore Hole Diameter: 8.25 in. to 30 ft. and N/A in. to N/A ft.

5 Latitude: 39.11726 (decimal degrees) Longitude: -94.66141 (decimal degrees) Horizontal Datum: WGS 84 NAD 83 NAD 27 Source for Latitude/Longitude: GPS (unit make/model): WAAS enabled? Yes No Land Survey Topographic Map Online Mapper:

6 Elevation: ft. Ground Level TOC Source: Land Survey GPS Topographic Map Other

7 WELL WATER TO BE USED AS: 1. Domestic: Household Lawn & Garden Livestock Irrigation Feedlot Industrial 2. Public Water Supply: well ID Dewatering: how many wells? Aquifer Recharge: well ID Monitoring: well ID MW-17 Environmental Remediation: well ID Air Sparge Soil Vapor Extraction Recovery Injection 10. Oil Field Water Supply: lease 11. Test Hole: well ID Cased Uncased Geotechnical 12. Geothermal: how many bores? a) Closed Loop Horizontal Vertical b) Open Loop Surface Discharge Inj. of Water 13. Other (specify):

Was a chemical/bacteriological sample submitted to KDHE? Yes No If yes, date sample was submitted: Water well disinfected? Yes No

8 TYPE OF CASING USED: Steel PVC Other CASING JOINTS: Glued Clamped Welded Threaded Casing diameter 2 in. to 15 ft., Diameter N/A in. to N/A ft., Diameter N/A in. to N/A ft. Casing height above land surface 0 in. Weight lbs./ft. Wall thickness or gauge No. Sch. 40

TYPE OF SCREEN OR PERFORATION MATERIAL: Steel Stainless Steel Fiberglass PVC Brass Galvanized Steel Concrete tile None used (open hole) Other (Specify)

SCREEN OR PERFORATION OPENINGS ARE: Continuous Slot Mill Slot Gauze Wrapped Torch Cut Drilled Holes Other (Specify) Louvered Shutter Key Punched Wire Wrapped Saw Cut None (Open Hole)

SCREEN-PERFORATED INTERVALS: From 15 ft. to 30 ft., From N/A ft. to N/A ft., From N/A ft. to N/A ft. GRAVEL PACK INTERVALS: From 13 ft. to 30 ft., From N/A ft. to N/A ft., From N/A ft. to N/A ft.

9 GROUT MATERIAL: Neat cement Cement grout Bentonite Other Concrete 0 to 1 feet Grout Intervals: From 1 ft. to 13 ft., From N/A ft. to N/A ft., From N/A ft. to N/A ft.

Nearest source of possible contamination: Septic Tank Lateral Lines Pit Privy Livestock Pens Insecticide Storage Sewer Lines Cess Pool Sewage Lagoon Fuel Storage Abandoned Water Well Watertight Sewer Lines Seepage Pit Feedyard Fertilizer Storage Oil Well/Gas Well Other (Specify) Direction from well? South Distance from well? 225 ft.

Table with columns: 10 FROM, TO, LITHOLOGIC LOG, FROM, TO, LITHO. LOG (cont.) or PLUGGING INTERVALS. Row 1: 0, 30, CL: med. stiff, moist, brown, silty CLAY, Notes:

11 CONTRACTOR'S OR LANDOWNER'S CERTIFICATION: This water well was constructed, reconstructed, or plugged under my jurisdiction and was completed on (mo-day-year) 9-12-2018 and this record is true to the best of my knowledge and belief. Kansas Water Well Contractor's License No. 759 This Water Well Record was completed on (mo-day-year) 10-21-2018 under the business name of RAZEK Environmental, LLC Signature

Mail 1 white copy along with a fee of \$5.00 for each constructed well to: Kansas Department of Health and Environment, Bureau of Water, GWTS Section, 1000 SW Jackson St., Suite 420, Topeka, Kansas 66612-1367. Mail one to Water Well Owner and retain one for your records. Telephone 785-296-5524. Visit us at http://www.kdheks.gov/waterwell/index.html KSA 82a-1212 Revised 7/10/2015

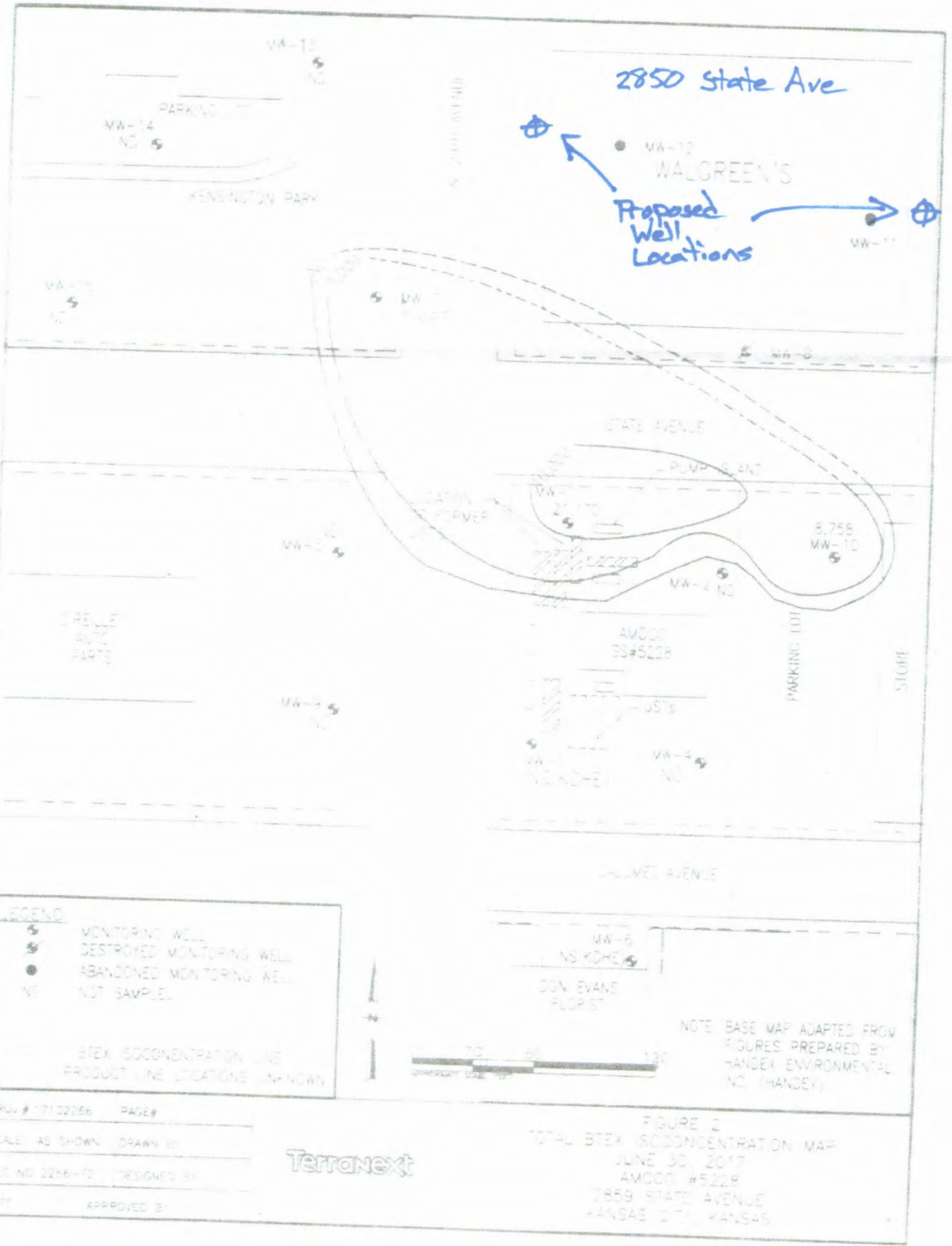

LEGEND

- ● MONITORING WELL
- / DESTROYED MONITORING WELL
- ⊗ ABANDONED MONITORING WELL
- NS NOT SAMPLED

--- BTEX ISOCENTRATION LINE
 --- PRODUCT LINE LOCATIONS (UNKNOWN)

PROJ # 17102256 PAGE #
 SCALE AS SHOWN DRAWN BY
 FILE NO 2256-02 DESIGNED BY
 DATE APPROVED BY

Terranext

FIGURE 2
 TOTAL BTEX ISOCENTRATION MAP
 JUNE 30, 2017
 AMCCO #5228
 2859 STATE AVENUE
 KANSAS CITY, KANSAS