

**1 LOCATION OF WATER WELL:** Fraction SE 1/4 NE 1/4 NE 1/4 NE 1/4 Section Number 19 Township Number T 11 S Range Number 25  E  W  
 County: Wyandotte

Street/Rural Address of Well Location; if unknown, distance & direction from nearest town or intersection: If at owner's address, check here  3601 Fairbanks Ave. Kansas City, KS 66106

**Global Positioning Systems (GPS) information:**  
 Latitude: 39.085566 (in decimal degrees)  
 Longitude: -94.67188 (in decimal degrees)  
 Elevation: 751.60  
 Horizontal Datum:  WGS84,  NAD83,  NAD27  
 Collection Method:

**2 WATER WELL OWNER:** SPX Corp - FMPC  
 RR#, St. Address, Box #: 13515 Ballantyne Corp Place  
 City, State ZIP Code: Charlotte NC 28277

GPS unit (Make/Model: Garmin etrek)  
 Digital Map/Photo,  Topographic Map,  Land Survey  
 Est. Accuracy:  < 3 m,  3-5 m,  5-15 m,  > 15 m

**3 MARK WELL'S LOCATION WITH AN "X" IN SECTION BOX:**

**4 DEPTH OF WELL** 39.5 ft.  
 WELL'S STATIC WATER LEVEL 30.5 ft.  
 WELL WAS USED AS:

Domestic Irrigation  Public Water Supply  Dewatering  
 Feedlot  Oil Field Water Supply  Monitoring  
 Industrial  Domestic (Lawn & Garden)  Injection Well  
 Air Conditioning  Other \_\_\_\_\_

Was a chemical/bacteriological sample submitted to Department? Yes  No

**5 TYPE OF BLANK CASING USED:**

Steel  RMP (SR)  Wrought  Fiberglass  Other (Specify below)  
 PVC  ABS  Asbestos-Cement  Concrete Tile

Blank casing diameter 2 in. Was casing pulled? Yes  No  If yes, how much five feet  
 Casing height above or below land surface -6 in.

**6 GROUT PLUG MATERIAL:**  Neat cement  Cement grout  Bentonite  Other Concrete/Top Soil

Grout Plug Intervals: From 0 ft. to 1 ft., From 1 ft. to 3 ft., From 3 ft. to 39.5 ft.

What is the nearest source of possible contamination:

Septic tank  Seepage pit  Fuel storage  Other (specify below) \_\_\_\_\_  
 Sewer lines  Pit privy  Fertilizer storage  unknown  
 Watertight sewer lines  Sewage lagoon  Insecticide storage  
 Lateral lines  Feedyard  Abandoned water well Direction from well? unknown  
 Cess pool  Livestock pens  Oil well/Gas well How many feet? unknown

FROM	TO	PLUGGING MATERIALS	FROM	TO	PLUGGING MATERIALS
0	1	Concrete			
1	3	Top soil			
3	<u>39.5</u>	Bentonite			

**7 CONTRACTOR'S OR LANDOWNER'S CERTIFICATION:** This water well was plugged under my jurisdiction and was completed on (mo/day/year) 12/5/2018 and this record is true to the best of my knowledge and belief. Kansas Water Well Contractor's License No. 710. This Water Well Record was completed on (mo/day/year) 12/7/2018 under the business name of Below Ground Surface, Inc. by (signature) Craig R. Hair

Send one white copy to Kansas Department of Health & Environment, Geology Section, 1000 SW Jackson Street, Ste. 420, Topeka, KS 66612-1367. Send one copy to WATER WELL OWNER and retain one for your records.  
 Visit us at <http://www.kdheks.gov/waterwell/index.html> Telephone 785-296-5524.

wyandotte

SE NENE NE

19-11S-25E

DEC 17 2018

BUREAU OF WATER

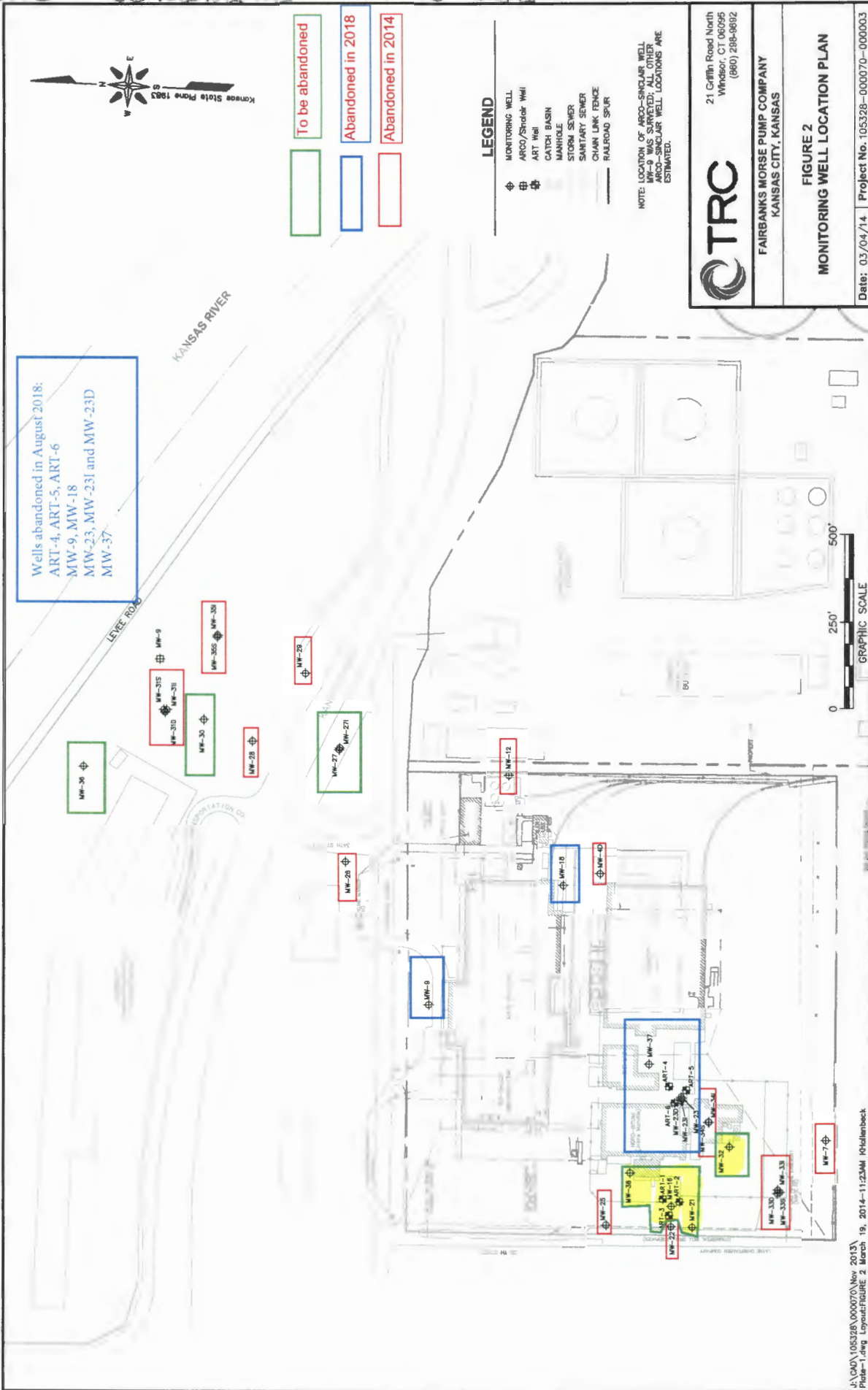

**CTRC**  
 21 Griffin Road North  
 Windsor, CT 06095  
 (860) 298-9892

**FAIRBANKS MORSE PUMP COMPANY**  
 KANSAS CITY, KANSAS

**FIGURE 2**  
**MONITORING WELL LOCATION PLAN**

Date: 03/04/14 Project No. 105328-000070-000003

J:\CAD\105328\000070\New 2013\Profile-1.dwg Layout:FIGURE 2 March 19, 2014-11:23AM KHallenbeck