

WATER WELL RECORD

Form WWC-5

Division of Water Resources App. No.

Well ID

MW5

Original Record Correction Change in Well Use

1 LOCATION OF WATER WELL: County Wyandotte Fraction SE 1/4 NE 1/4 SE 1/4 SW 1/4 Section Number 18 Township Number T 11 S Range Number R 25 E W
2 WELL OWNER: Last Name: Business: QuikTrip Corporation Address: 4705 S 129th E. Ave. Address: 4202 Kansas Ave., Kansas City, KS
3 LOCATE WELL WITH "X" IN SECTION BOX: [Diagram showing section box with 'X' in SW quadrant]
4 DEPTH OF COMPLETED WELL: 45 ft
5 Latitude: 39.09000 Longitude: 94.67754

7 WELL WATER TO BE USED AS: 1 Domestic: 2 Irrigation 3 Feedlot 4 Industrial 5 Public Water Supply: well ID 6 Dewatering: how many wells? 7 Aquifer Recharge: well ID 8 Monitoring: well ID MW5 9 Environmental Remediation: well ID 10 Oil Field Water Supply: lease 11 Test Hole: well ID 12 Geothermal: How many bores?

Was a chemical/bacteriological sample submitted to KDHE? Yes No Water well disinfected? Yes No

8 TYPE OF CASING USED: Steel PVC Other CASING JOINTS: Glued Clamped Welded Threaded Casing diameter 2 in. to 25 ft. Diameter in. to ft. Casing height above land surface -0.27 in. Weight lbs./ft. Well thickness or gauge No TYPE OF SCREEN OR PERFORATION MATERIAL: Steel Stainless Steel Fiberglass PVC Other SCREEN OR PERFORATION OPENINGS ARE: Continuous Slot Mill Slot Gauze Wrapped Torch Cut Drilled Holes Louvered Shutter Key Punched Wire Wrapped Saw Cut None (Open Hole) SCREEN-PERFORATED INTERVALS: From 25 ft. to 45 ft. GRAVEL PACK INTERVALS: From 23 ft. to 45 ft.

9 GROUT MATERIAL: Neat cement Cement grout Bentonite Other Concrete: 0-0.7' Grout intervals: From 0.7 ft. to 23 ft. From ft. to ft. From ft. to ft.

Nearest source of possible contamination: Septic Tank Lateral Lines Pit Privy Livestock Pens Insecticide Storage Sewer Lines Cess Pool Sewage Lagoon Fuel Storage Abandoned Water Well Watertight Sewer Lines Sepage Pit Feedyard Fertilizer Storage Oil Well / Gas Well Other (Specify) Direction from well? SW Distance from well? ~80 ft

Table with columns: FROM, TO, LITHOLOGIC LOG, FROM, TO, LITHO. LOG (cont.) or PLUGGING INTERVALS. Rows include: 0-0.7 Topsoil, mostly silty clay; 0.7-1 Gravel fill w/ silty clay; 1-6 Clayey silt; 6-26 Silty and very fine sand; 26-31 Medium sand; 31-35 Very coarse sand and small gravel; 35-45 Coarse sand. Notes: KDHE ID: Former Quiktrip #231; U4-105-14927

11 CONTRACTOR'S OR LANDOWNER'S CERTIFICATION: This water well was constructed, reconstructed or plugged under my jurisdiction and was completed on (mo-day-year) 6/28/19 and this record is true to the best of my knowledge and belief. Kansas Water Well Contractor's License No 757 This Water Well Record was completed on (mo-day-year) 7/29/19 under the business name of Larsen & Associates, Inc. Signature

DENNIS L HANDKE

1820 NW 59th Terrace
TOPEKA, KANSAS 66618
785-286-4047 Home
785-286-1990 Fax

Jess Chapman
Larsen & Associates
1311 E. 25th Street, Suite B
Lawrence, Kansas 66046

July 18, 2019

RE: Monitor Well Elevation Survey
4202 Kansas Ave., Kansas City, Kansas

Proj. 19-00X
Former Quik Trip #231
KDHE ID: ~~U4-105-14927~~

U4-105-14927

Bench Mark: Chisled Sq. on NE corner of concrete QT sign base near the SE Corner of property.

Elev: 762.09 North 726.46 West 2736.63 (from SE Cor. Sec. 18-11-25E)

MW-1	rim	763.55	North	715.57	SE1/4,NE1/4,SE1/4,SW1/4
	top pipe	763.26	West	2882.13	Lat = 39.08981 Long = 94.67800
MW-2	rim	762.64	North	925.69	SE1/4,NE1/4,SE1/4,SW1/4
	top pipe	762.24	West	2813.01	Lat = 39.09039 Long = 94.67776
MW-3	rim	761.18	North	719.45	SW1/4,NE1/4,SE1/4,SW1/4
	top pipe	760.26	West	3154.10	Lat = 39.08982 Long = 94.67896
MW-4	rim	763.89	North	986.57	SW1/4,NE1/4,SE1/4,SW1/4
	top pipe	763.59	West	2980.44	Lat = 39.09036 Long = 94.67836
MW-5	rim	761.78	North	783.48	SE1/4,NE1/4,SE1/4,SW1/4
	top pipe	761.51	West	2750.13	Lat = 39.09000 Long = 94.67754
MW-6	rim	761.00	North	1016.86	NE1/4,NE1/4,SE1/4,SW1/4
	top pipe	760.66	West	2724.29	Lat = 39.09064 Long = 94.67745

Elevation derived from KDOT BM 304-B project K-4890-01 NAVD88.

Lat & Long derived from Shawnee 7.5 Quad Map WGS84.

If you have any questions, please feel free to call me. Thank you for the opportunity to be of service to you.

July 18, 2019
Dennis L Handke RS

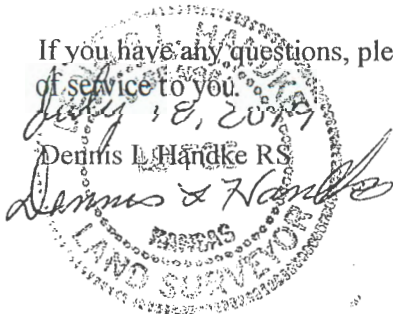

NOTE: Figures exhibited within this report are only to be used within the context of this report. Placement of property lines, wells, structures, and roads is based on the available information from county appraiser maps, surveys, site visits, and/or previous vendor reports and should be considered approximate.

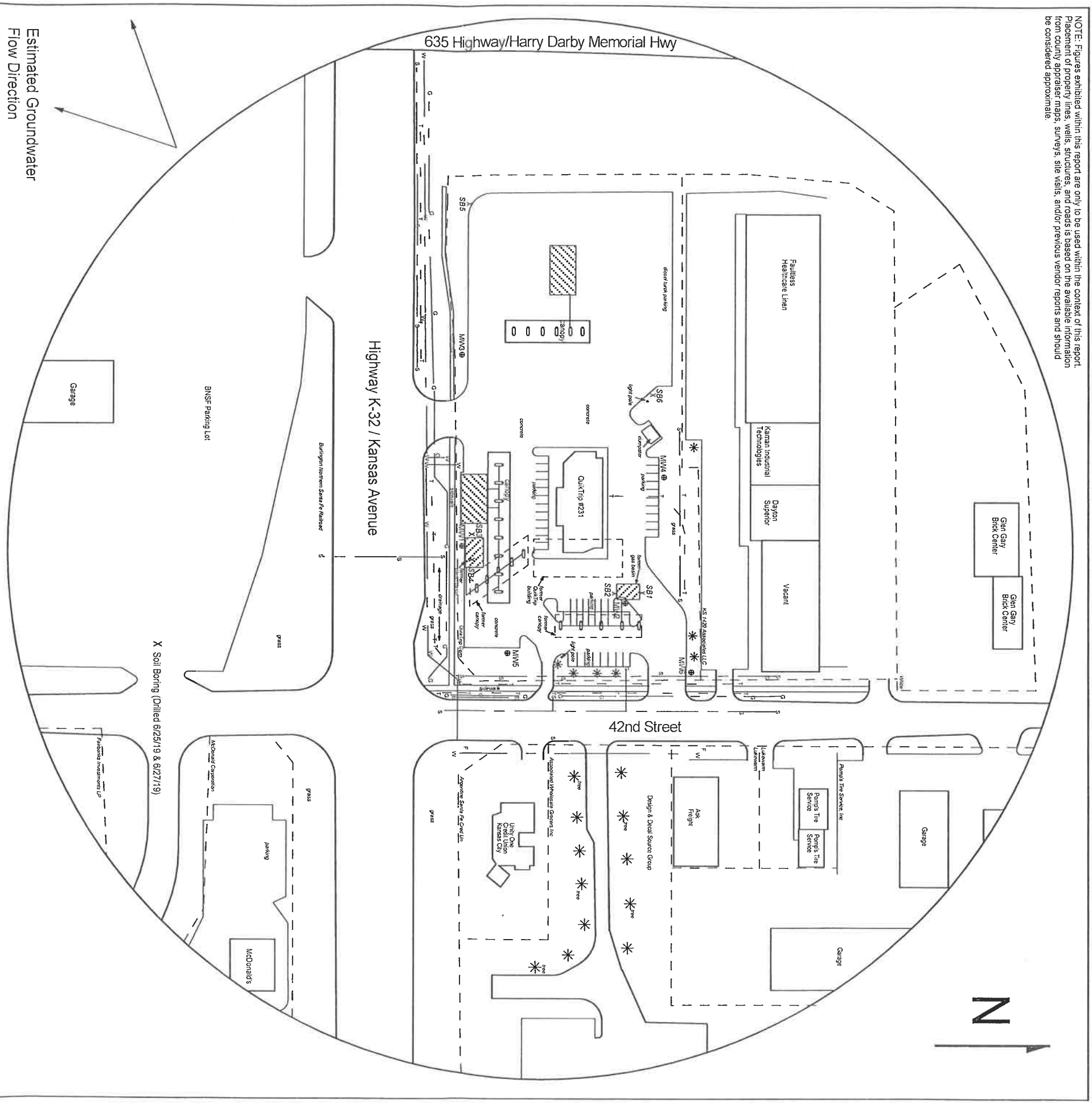

Estimated Groundwater
Flow Direction













FIGURE 2.2 - 700 FT RADIUS AREA BASE MAP

larsen
 & ASSOCIATES, INC.

1311 E 25th St., Suite B 785-841-8707 office
 Lawrence, KS 66046 785-865-4282 fax

PROJECT:
 Former QuikTrip #231
 4202 Kansas Avenue
 Kansas City, KS
 KDHEID: U4-105-14927
 Date: 7/3/19

LEGEND

-  Approximate Location of Active UST Basin,
-  Product Lines & Pump Islands
-  Approximate Location of Former UST Basin, Product Lines & Pump Islands
-  Approximate Location of Property Line
-  Monitoring Well
(Installed 6/25, 27, 28/19 & 7/2/19)
-  Soil Boring (Drilled 6/25/19 & 6/27/19)
-  Fire Hydrant
-  Electric Lines (1.5 - 3 ft bgs)
-  Gas Lines (1.5 - 3 ft bgs)
-  Overhead Lines (25'-40' high)
-  Sewer Lines (2 - 6 ft bgs)
-  Telephone Lines (2 - 6 ft bgs)
-  Water Lines (2 - 6 ft bgs)

NOTE: Utility depths, heights and locations are approximate.
 NOTE: SB5 & SB6 were drilled to collect hydrologic samples.

