

WATER WELL RECORD Form WWC-5

Division of Water Resources App. No.

Well ID MW-18

Original Record Correction Change in Well Use

1 LOCATION OF WATER WELL: County: Wyandotte Fraction 1/4 NW 1/4 SE 1/4 SE 1/4 Section Number 15 Township Number T 11 S Range Number R 25 E W

2 WELL OWNER: Last Name: Business: BP Products North America Address: 201 Helios Way, 6th Floor City: Houston State: TX ZIP: 77079 Street or Rural Address where well is located: 47-51 Kansas Ave.; Kansas City, KS

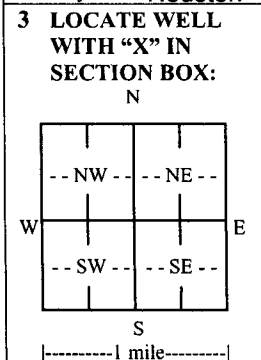

3 LOCATE WELL WITH 'X' IN SECTION BOX: N W E S 4 DEPTH OF COMPLETED WELL: 25 ft. Depth(s) Groundwater Encountered: 1) ... ft. 2) ... ft. 3) ... ft., or 4) Dry Well

5 Latitude: 39.087583 (decimal degrees) Longitude: -94.616027 (decimal degrees) Horizontal Datum: WGS 84 NAD 83 NAD 27 Source for Latitude/Longitude: GPS (unit make/model: Garmin etrek) (WAAS enabled? Yes No) Land Survey Topographic Map Online Mapper

6 Elevation: ... ft. Ground Level TOC Source: Land Survey GPS Topographic Map Other

7 WELL WATER TO BE USED AS: 1. Domestic: Household Lawn & Garden Livestock Irrigation Feedlot Industrial 5. Public Water Supply: well ID 6. Dewatering: how many wells? 7. Aquifer Recharge: well ID 8. Monitoring: well ID MW-18 9. Environmental Remediation: well ID Air Sparge Soil Vapor Extraction Recovery Injection 10. Oil Field Water Supply: lease 11. Test Hole: well ID Cased Uncased Geotechnical 12. Geothermal: how many bores? a) Closed Loop Horizontal Vertical b) Open Loop Surface Discharge Inj. of Water 13. Other (specify):

Was a chemical/bacteriological sample submitted to KDHE? Yes No If yes, date sample was submitted: Water well disinfected? Yes No

8 TYPE OF CASING USED: Steel PVC Other CASING JOINTS: Glued Clamped Welded Threaded Casing diameter 2 in. to 10 ft., Diameter in. to ft., Diameter in. to ft. Casing height above land surface 6 in. Weight lbs./ft. Wall thickness or gauge No. sch 40 TYPE OF SCREEN OR PERFORATION MATERIAL: Steel Stainless Steel Fiberglass PVC Other (Specify) SCREEN OR PERFORATION OPENINGS ARE: Continuous Slot Mill Slot Gauze Wrapped Torch Cut Drilled Holes Other (Specify) Louvered Shutter Key Punched Wire Wrapped Saw Cut None (Open Hole) SCREEN-PERFORATED INTERVALS: From 10 ft. to 25 ft., From ft. to ft., From ft. to ft. GRAVEL PACK INTERVALS: From 8 ft. to 25 ft., From ft. to ft., From ft. to ft.

9 GROUT MATERIAL: Neat cement Cement grout Bentonite Other Grout Intervals: From 2 ft. to 8 ft., From ft. to ft., From ft. to ft. Nearest source of possible contamination: Septic Tank Lateral Lines Pit Privy Livestock Pens Insecticide Storage Sewer Lines Cess Pool Sewage Lagoon Fuel Storage Abandoned Water Well Watertight Sewer Lines Seepage Pit Feedyard Fertilizer Storage Oil Well/Gas Well Other (Specify) unknown Direction from well? unknown Distance from well? unknown ft.

Table with 6 columns: 10 FROM, TO, LITHOLOGIC LOG, FROM, TO, LITHO. LOG (cont.) or PLUGGING INTERVALS. Rows: 0 to 0.5 Concrete, 0.5 to 18 Brown silty clay, 18 to 25 Gray sand - fine to coarse. Includes a Notes section.

11 CONTRACTOR'S OR LANDOWNER'S CERTIFICATION: This water well was constructed, reconstructed, or plugged under my jurisdiction and was completed on (mo-day-year) 10/23/2019 and this record is true to the best of my knowledge and belief. Kansas Water Well Contractor's License No. 710 This Water Well Record was completed on (mo-day-year) 11/5/2019 under the business name of Below Ground Surface, Inc. Signature: Clay R. Hew

Mail 1 white copy along with a fee of \$5.00 for each constructed well to: Kansas Department of Health and Environment, Bureau of Water, GWTS Section, 1000 SW Jackson St., Suite 420, Topeka, Kansas 66612-1367. Mail one to Water Well Owner and retain one for your records. Telephone 785-296-5524. Visit us at http://www.kdheks.gov/waterwell/index.html KSA 82a-1212 Revised 7/10/2015

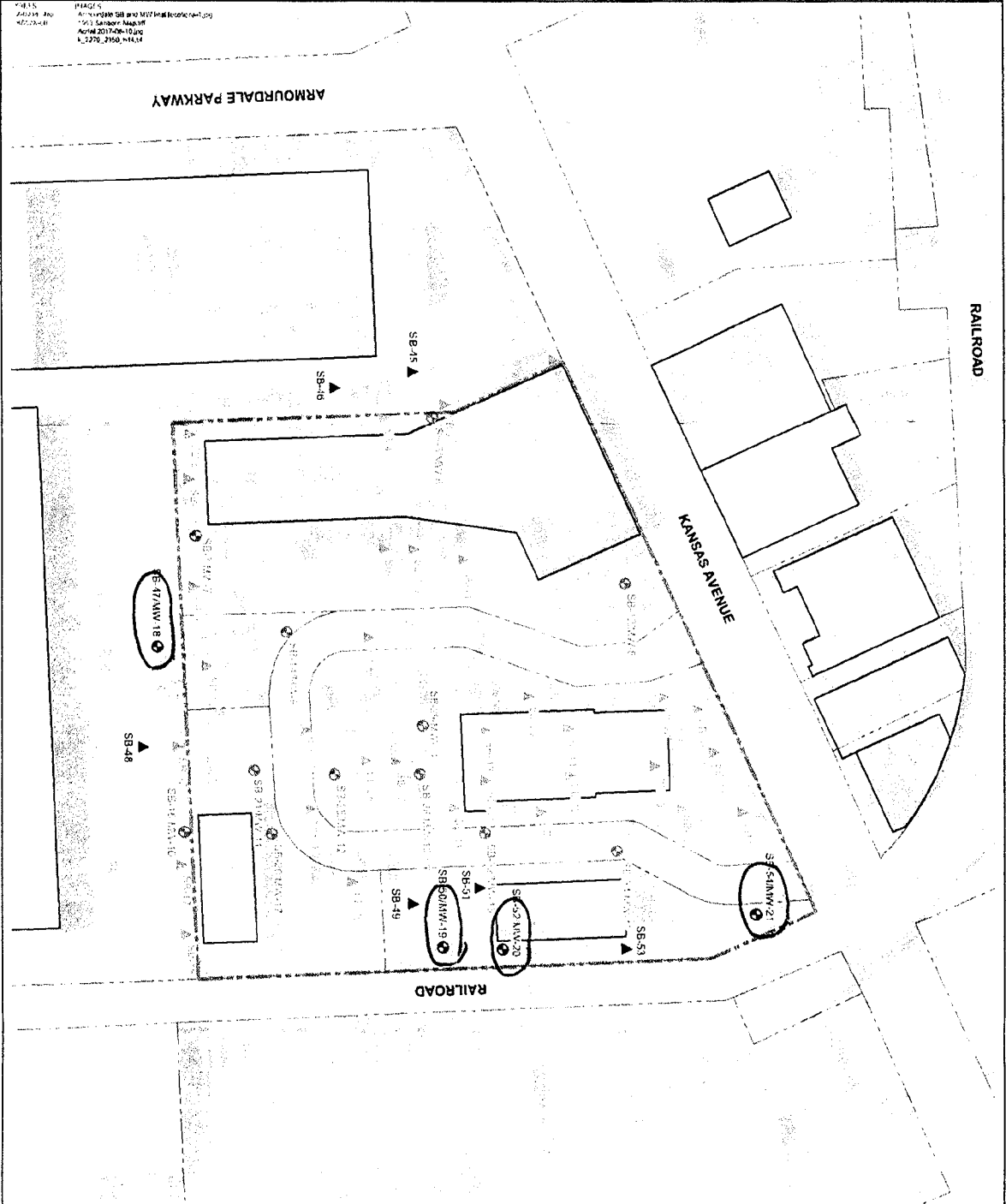

LEGEND:

- PROJECT BOUNDARY
- CROSS SECTION LINE
- EXISTING BUILDING
- PARCEL MAP BOUNDARY
- MONITORING WELL
- SOIL BORING
- PROPOSED SOIL BORING
- PROPOSED MONITORING WELL

NOTE:
 ALL LOCATIONS ARE APPROXIMATE

2. BASE MAP REFERENCES

- 2.1. PARCEL MAP INFORMATION PROVIDED BY UNIFIED GOVERNMENT WEB MAPPING APPLICATION.
- 2.2. BENCHMARKED AERIAL PHOTOGRAPHY PROVIDED BY ENRICH EXPLORER (UES), KANSAS AERIAL PHOTOGRAPHY CONTRACTOR BY UES CONSULTING SERVICES, INC., DATED JANUARY 13, 2014.
- 2.3. SOIL BORING DATA OBTAINED FROM SOIL BORINGS AT 43 KANSAS AVE. FROM "SITE SAMPLING PLAN" BY UES CONSULTING SERVICES, INC., DATED JUNE 10, 2016.

GRAPHIC SCALE

0 100' 200'

SITE MAP WITH PROPOSED SAMPLE POINTS

ARCADIS

1