

WATER WELL RECORD Form WWC-5

Division of Water Resources App. No.

Well ID MW-19

Original Record Correction Change in Well Use

1 LOCATION OF WATER WELL: County: Wyandotte	Fraction ¼ NW ¼ SE ¼ SE ¼	Section Number 15	Township Number T 11 S	Range Number R 25 <input checked="" type="checkbox"/> E <input type="checkbox"/> W
---	------------------------------	----------------------	---------------------------	---

2 WELL OWNER: Last Name: BP Products North America Business: BP Products North America Address: 201 Helios Way, 6th Floor Address: City: Houston State: TX ZIP: 77079	Street or Rural Address where well is located (if unknown, distance and direction from nearest town or intersection): If at owner's address, check here: <input type="checkbox"/> 47-51 Kansas Ave.; Kansas City, KS
--	--

3 LOCATE WELL WITH "X" IN SECTION BOX: N W E S -----1 mile-----	4 DEPTH OF COMPLETED WELL: 40 ft. Depth(s) Groundwater Encountered: 1) ft. 2) ft. 3) ft., or 4) <input type="checkbox"/> Dry Well WELL'S STATIC WATER LEVEL: ft. <input type="checkbox"/> below land surface, measured on (mo-day-yr) <input type="checkbox"/> above land surface, measured on (mo-day-yr) Pump test data: Well water was ft. after hours pumping gpm Well water was ft. after hours pumping gpm Estimated Yield: gpm Bore Hole Diameter: 8.5 in. to 40 ft. and in. to ft.	5 Latitude: 39.088527 (decimal degrees) Longitude: -94.615194 (decimal degrees) Horizontal Datum: <input checked="" type="checkbox"/> WGS 84 <input type="checkbox"/> NAD 83 <input type="checkbox"/> NAD 27 Source for Latitude/Longitude: <input checked="" type="checkbox"/> GPS (unit make/model: Garmin etrek) (WAAS enabled? <input checked="" type="checkbox"/> Yes <input type="checkbox"/> No) <input type="checkbox"/> Land Survey <input type="checkbox"/> Topographic Map <input type="checkbox"/> Online Mapper:
		6 Elevation: ft. <input type="checkbox"/> Ground Level <input type="checkbox"/> TOC Source: <input type="checkbox"/> Land Survey <input checked="" type="checkbox"/> GPS <input type="checkbox"/> Topographic Map <input type="checkbox"/> Other

7 WELL WATER TO BE USED AS:

1. Domestic: <input type="checkbox"/> Household <input type="checkbox"/> Lawn & Garden <input type="checkbox"/> Livestock	5. <input type="checkbox"/> Public Water Supply: well ID	10. <input type="checkbox"/> Oil Field Water Supply: lease
2. <input type="checkbox"/> Irrigation	6. <input type="checkbox"/> Dewatering: how many wells?	11. Test Hole: well ID
3. <input type="checkbox"/> Feedlot	7. <input type="checkbox"/> Aquifer Recharge: well ID	<input type="checkbox"/> Cased <input type="checkbox"/> Uncased <input type="checkbox"/> Geotechnical
4. <input type="checkbox"/> Industrial	8. <input checked="" type="checkbox"/> Monitoring: well ID MW-19	12. Geothermal: how many bores?
	9. Environmental Remediation: well ID	a) Closed Loop <input type="checkbox"/> Horizontal <input type="checkbox"/> Vertical
	<input type="checkbox"/> Air Sparge <input type="checkbox"/> Soil Vapor Extraction	b) Open Loop <input type="checkbox"/> Surface Discharge <input type="checkbox"/> Inj. of Water
	<input type="checkbox"/> Recovery <input type="checkbox"/> Injection	13. <input type="checkbox"/> Other (specify):

Was a chemical/bacteriological sample submitted to KDHE? Yes No If yes, date sample was submitted:

Water well disinfected? Yes No

8 TYPE OF CASING USED: Steel PVC Other **CASING JOINTS:** Glued Clamped Welded Threaded

Casing diameter 2 in. to 25 ft., Diameter in. to ft., Diameter in. to ft.

Casing height above land surface 30 in. Weight lbs./ft. Wall thickness or gauge No. **Sch 40**

TYPE OF SCREEN OR PERFORATION MATERIAL:
 Steel Stainless Steel Fiberglass PVC Other (Specify)

Brass Galvanized Steel Concrete tile None used (open hole)

SCREEN OR PERFORATION OPENINGS ARE:
 Continuous Slot Mill Slot Gauze Wrapped Torch Cut Drilled Holes Other (Specify)

Louvered Shutter Key Punched Wire Wrapped Saw Cut None (Open Hole)

SCREEN-PERFORATED INTERVALS: From **25** ft. to **40** ft., From ft. to ft., From ft. to ft.

GRAVEL PACK INTERVALS: From **23** ft. to **40** ft., From ft. to ft., From ft. to ft.

9 GROUT MATERIAL: Neat cement Cement grout Bentonite Other

Grout Intervals: From **2** ft. to **23** ft., From ft. to ft., From ft. to ft.

Nearest source of possible contamination:
 Septic Tank Lateral Lines Pit Privy Livestock Pens Insecticide Storage
 Sewer Lines Cess Pool Sewage Lagoon Fuel Storage Abandoned Water Well
 Watertight Sewer Lines Seepage Pit Feedyard Fertilizer Storage Oil Well/Gas Well
 Other (Specify)

Direction from well? Distance from well? ft.

10 FROM	TO	LITHOLOGIC LOG	FROM	TO	LITHO. LOG (cont.) or PLUGGING INTERVALS
	0	Gravel			
0	5	Fill Material; bricks			
5	18	Brown silty clay			
18	40	Sand - coarse to fine			

11 CONTRACTOR'S OR LANDOWNER'S CERTIFICATION: This water well was constructed, reconstructed, or plugged under my jurisdiction and was completed on (mo-day-year) **10/23/2019** and this record is true to the best of my knowledge and belief. Kansas Water Well Contractor's License No. **710** This Water Well Record was completed on (mo-day-year) **11/5/2019** under the business name of **Below Ground Surface, Inc.** Signature: *Craig R. Hew*

Mail 1 white copy along with a fee of \$5.00 for each constructed well to: Kansas Department of Health & Environment, Bureau of Water, GWTS Section, 1000 SW Jackson St., Suite 420, Topeka, Kansas 66612-1367. Mail one to Water Well Owner and retain one for your records. Telephone 785-296-5524.

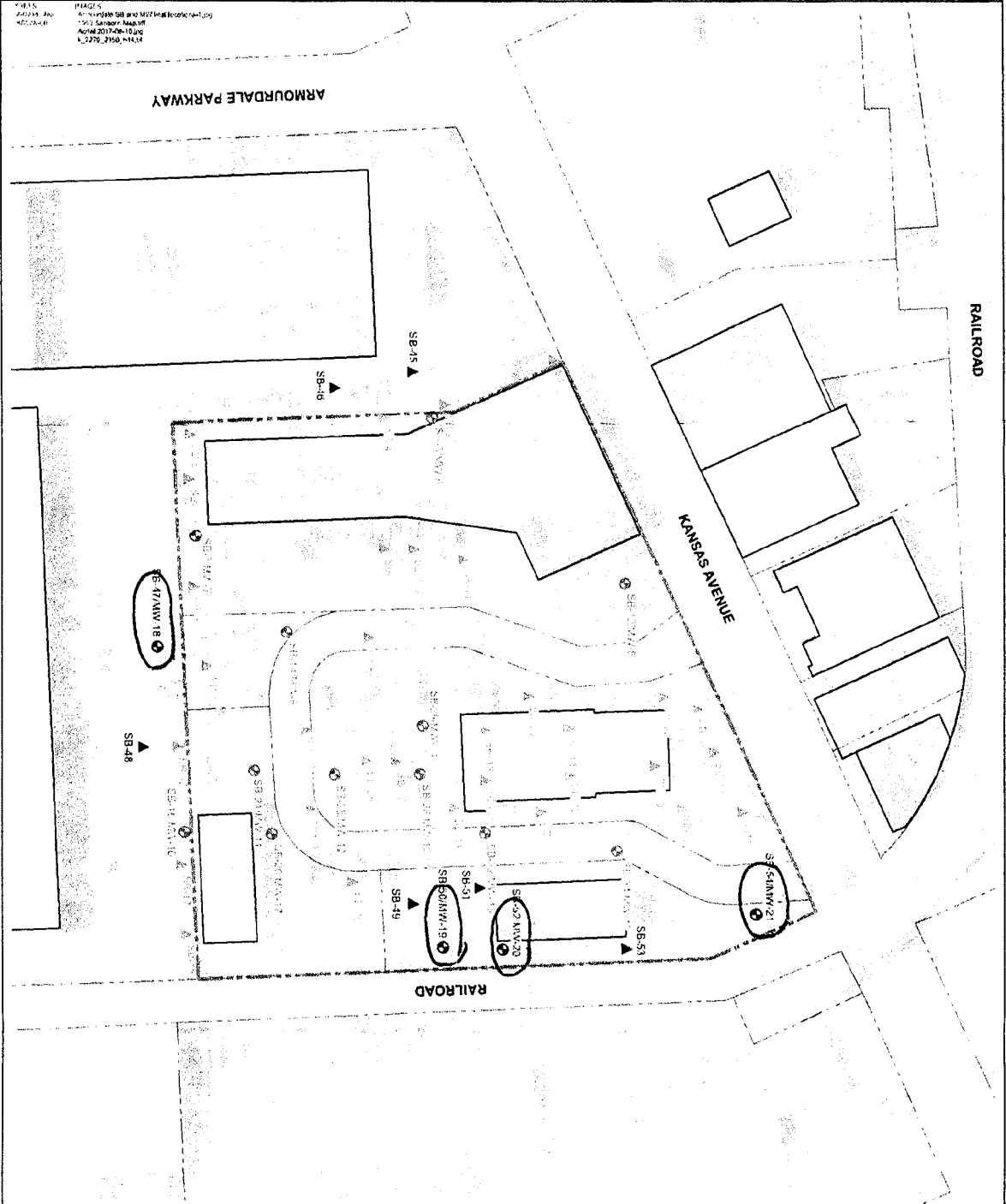

LEGEND:

- PROJECT BOUNDARY
- CROSS SECTION LINE
- EXISTING BUILDING
- PARCEL MAP BOUNDARY
- MONITORING WELL
- SOIL BORING
- PROPOSED SOIL BORING
- PROPOSED MONITORING WELL

NOTE:

1. ALL LOCATIONS ARE APPROXIMATE

2. BASE MAP REFERENCES

2.1. PARCEL MAP INFORMATION PROVIDED BY UNFIELD GOVERNMENT WEB MAPPING APPLICATION.

2.2. BENCHMARKED AERIAL PHOTOGRAPHY PROVIDED BY UNFIELD AERIAL PHOTOGRAPHY.

2.3. MONITORING WELL DATA PROVIDED BY UNFIELD SERVICES, INC. DATED JANUARY 13, 2014.

2.4. SOIL BORINGS AT 43 KANSAS AVE. FROM "SITE SAMPLING PLAN" BY UFS CONSULTING SERVICES, INC. DATED JUNE 10, 2016.

GRAPHIC SCALE: 0 100' 200'

BP AMOCO CORPORATION
 FORMER S. STANDARD OIL COMPANY 11528 S. KANSAS AVE.
 KANSAS CITY, KANSAS

SITE MAP WITH PROPOSED SAMPLE POINTS

ARCADIS

1