

WATER WELL RECORD

Form WWC-5

Division of Water Resources App. No.

[Empty box]

Well ID

MW3R

[X] Original Record [ ] Correction [ ] Change in Well Use

1 LOCATION OF WATER WELL: County Wyandotte Fraction SW 1/4 SW 1/4 SE 1/4 SE 1/4 Section Number 16 Township Number T 11 S Range Number R 25 [X] E [ ] W

2- WELL OWNER: Last Name: Business: Praxair Distribution Inc. Address: 217 Loren Address: City Washington State: IL ZIP: 61571 Street or Rural Address where well is located (if unknown, distance and direction from nearest town or intersection): If at owner's address, check here: [ ] ~70' SE of the SE corner of McAlpine Ave & S 10th St., Kansas City KS

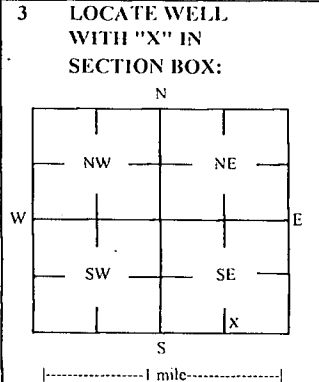

4 DEPTH OF COMPLETED WELL: 33.5 ft Depth(s) Groundwater Encountered: 1) \_\_\_\_\_ ft 2) \_\_\_\_\_ ft 3) \_\_\_\_\_ ft, or 4) [ ] Dry Well WELL'S STATIC WATER LEVEL: 23.38 ft [X] below land surface, measured on (mo-day-yr) 3/17/20 [ ] above land surface, measured on (mo-day-yr) Pump test data: Well water was \_\_\_\_\_ ft after \_\_\_\_\_ hours pumping \_\_\_\_\_ gpm Water well was \_\_\_\_\_ ft after \_\_\_\_\_ hours pumping \_\_\_\_\_ gpm Estimated Yield: \_\_\_\_\_ gpm Bore Hole Diameter: 7.25 in to \_\_\_\_\_ ft, and \_\_\_\_\_ in to \_\_\_\_\_ ft

5 Latitude: 39.08905 (decimal degrees) Longitude: 94.63503 (decimal degrees) Horizontal Datum [X] WGS 84 [ ] NAD 83 [ ] NAD 27 Source for Latitude/Longitude: [ ] GPS (unit make/model: \_\_\_\_\_) (WAAS enabled? [ ] Yes [ ] No) [X] Land Survey [ ] Topographic Map [ ] Online Mapper 6 Elevation 754.46 ft [ ] Ground Level [X] TOC Source [X] Land Survey [ ] GPS [ ] Topographic Map [ ] Other \_\_\_\_\_

7 WELL WATER TO BE USED AS: 1 Domestic: [ ] Household [ ] Lawn & Garden [ ] Livestock 2 [ ] Irrigation 3 [ ] Feedlot 4 [ ] Industrial 5 [ ] Public Water Supply: well ID 6 [ ] Dewatering: how many wells? 7 [ ] Aquifer Recharge: well ID 8 [X] Monitoring: well ID MW3R 9 Environmental Remediation: well ID [ ] Air Sparge [ ] Soil Vapor Extractor [ ] Recovery [ ] Injection 10 [ ] Oil Field Water Supply: lease 11 Test Hole: well ID [ ] Cased [ ] Uncased [ ] Geotechnical 12 Geothermal: How many bores? a) Closed Loop [ ] Horizontal [ ] Vertical b) Open Loop [ ] Surface Discharge [ ] Inj. of Water [ ] Other (specify): \_\_\_\_\_

Was a chemical/bacteriological sample submitted to KDHE? [ ] Yes [X] No If yes, date sample was submitted: \_\_\_\_\_ Water well disinfected? [ ] Yes [X] No

8 TYPE OF CASING USED: [ ] Steel [X] PVC [ ] Other \_\_\_\_\_ CASING JOINTS: [ ] Glued [ ] Clamped [ ] Welded [X] Threaded Casing diameter 2 in. to 18.5 ft, Diameter \_\_\_\_\_ in. to \_\_\_\_\_ ft, Diameter \_\_\_\_\_ in. to \_\_\_\_\_ ft, Casing height above land surface -0.34 in. Weight \_\_\_\_\_ lbs./ft. Well thickness or gauge No \_\_\_\_\_ TYPE OF SCREEN OR PERFORATION MATERIAL: [ ] Steel [ ] Stainless Steel [ ] Fiberglass [X] PVC [ ] Other (Specify) \_\_\_\_\_ [ ] Brass [ ] Galvanized Steel [ ] Concrete tile [ ] None used (open hole) SCREEN OR PERFORATION OPENINGS ARE: [ ] Continuous Slot [X] Mill Slot [ ] Gauze Wrapped [ ] Torch Cut [ ] Drilled Holes [ ] Other (Specify) \_\_\_\_\_ [ ] Louvered Shutter [ ] Key Punched [ ] Wire Wrapped [ ] Saw Cut [ ] Nonc (Open Hole) SCREEN-PERFORATED INTERVALS: From 18.5 ft. to 33.5 ft, From \_\_\_\_\_ ft. to \_\_\_\_\_ ft, From \_\_\_\_\_ ft. to \_\_\_\_\_ ft, GRAVEL PACK INTERVALS: From 16.5 ft. to 33.5 ft, From \_\_\_\_\_ ft. to \_\_\_\_\_ ft, From \_\_\_\_\_ ft. to \_\_\_\_\_ ft,

9 GROUT MATERIAL: [ ] Neat cement [ ] Cement grout [X] Bentonite [X] Other Concrete: 0-0.5' Grout intervals: From 0.5 ft. to 16.5 ft, From \_\_\_\_\_ ft. to \_\_\_\_\_ ft, From \_\_\_\_\_ ft. to \_\_\_\_\_ ft,

Nearest source of possible contamination: [ ] Septic Tank [ ] Lateral Lines [ ] Pit Privy [ ] Livestock Pens [ ] Insecticide Storage [ ] Sewer Lines [ ] Cess Pool [ ] Sewage Lagoon [X] Fuel Storage [ ] Abandoned Water Well [ ] Watertight Sewer Lines [ ] Seepage Pit [ ] Feedyard [ ] Fertilizer Storage [ ] Oil Well / Gas Well [ ] Other (Specify) \_\_\_\_\_ Direction from well? SE Distance from well? ~70 ft

10 FROM TO LITHOLOGIC LOG FROM TO LITHO. LOG (cont.) or PLUGGING INTERVALS

|      |      |                          |  |  |  |
|------|------|--------------------------|--|--|--|
| 0    | 0.5  | Grass/Topsoil            |  |  |  |
| 0.5  | 1.5  | Silty clay w/ gravel     |  |  |  |
| 1.5  | 3.5  | Silty clay w/ rubble     |  |  |  |
| 3.5  | 6    | Clayey silt              |  |  |  |
| 6    | 23.5 | Very fine silt           |  |  |  |
| 23.5 | 28   | Fine to medium fine sand |  |  |  |
| 28   | 33.5 | Coarse sand              |  |  |  |

Notes: KDHE ID: Oxygen Service Company; U4-105-01127 Target of monitoring well is shallow groundwater, <20' of grout was installed at the direction of KDHE.

11 CONTRACTOR'S OR LANDOWNER'S CERTIFICATION: This water well was [X] constructed, [ ] reconstructed, or [ ] plugged under my jurisdiction and was completed on (mo-day-year) 3/16-17/20 and this record is true to the best of my knowledge and belief. Kansas Water Well Contractor's License No 757 This Water Well Record was completed on (mo-day-year) 5/12/20 under the business name of Larsen & Associates, Inc. Signature \_\_\_\_\_

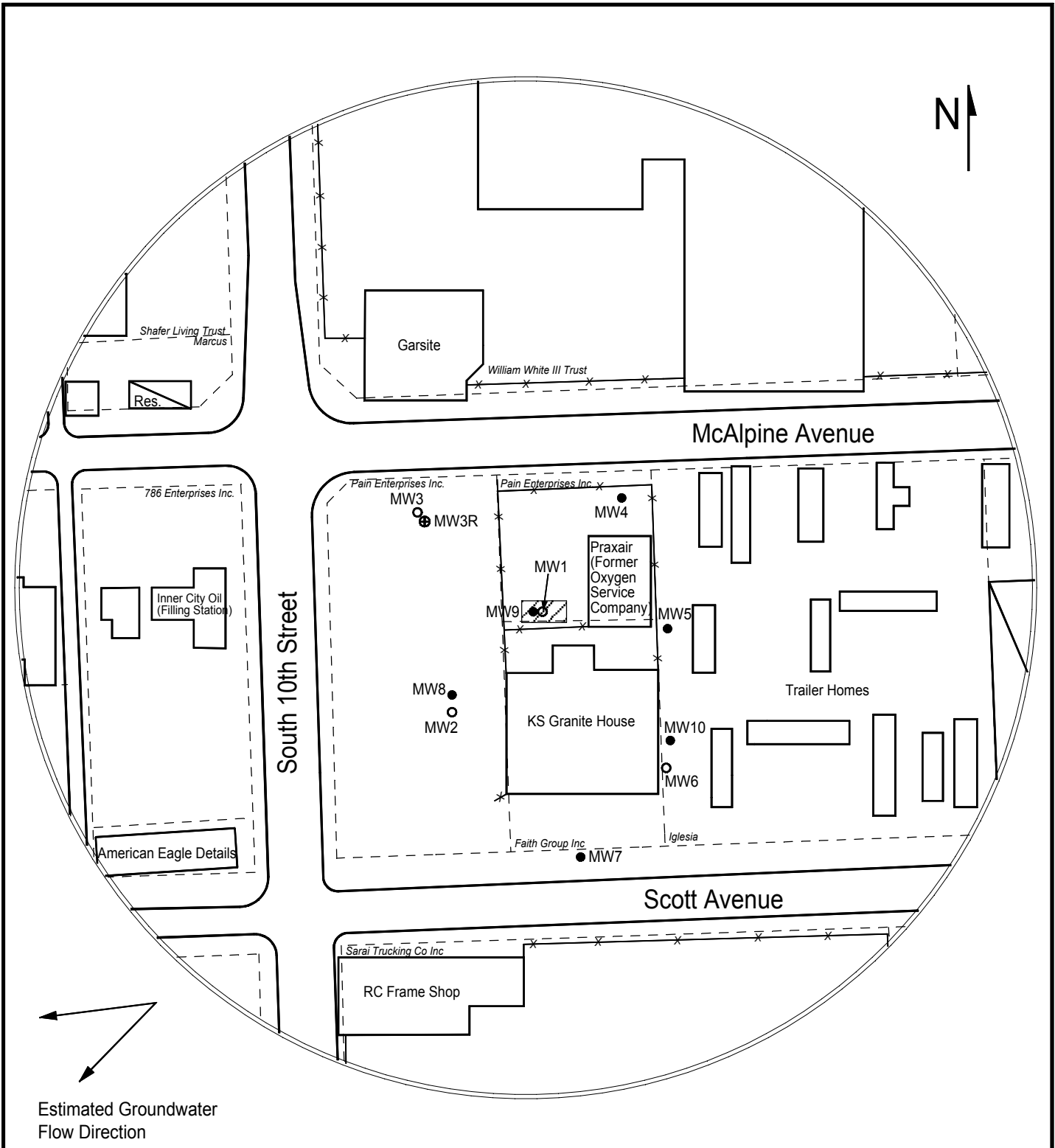

**larsen**  
& ASSOCIATES, INC.

1311 E 25th St. Suite B  
Lawrence, KS 66046

785-841-8707 office  
785-865-4282 fax

**PROJECT:**  
 Oxygen Service Company  
 970 Scott  
 Kansas City, KS  
 KDHE ID: U4-105-01127  
 Date: 4/27/20

0 100 ft

**LEGEND:**

- Approximate Location of Former UST Basin
- Approximate Location of Property Line
- Building with Basement
- Existing Monitoring Well
- Plugged Monitoring Well
- Monitoring Well (Installed 3/16-17/20)

Wyandotte

SW SW SE SE

16-11-25E

**DENNIS L HANDKE**

1820 NW 59th Terrace  
TOPEKA, KANSAS 66618  
785-286-4047 Home

Jess Chapman  
Larsen & Associates  
1311 E. 25<sup>th</sup> Street, Suite B  
Lawrence, Kansas, 66046

May 2, 2020

RE: Monitor Well Elevation Survey  
970 Scott, Kansas City, Kansas

Proj. 20-00U  
Oxygen Service Company  
U4-105-01127

Bench Mark: Chisled Square on NW corner of storm inlet West of alley, South side of Alpine Street.  
Elev: 753.16      North 484.81      West 1104.77      (from SE Cor. Sec. 16-11-25E)

|           |        |       |         |                               |
|-----------|--------|-------|---------|-------------------------------|
| MW-3R rim | 754.80 | North | 449.02  | SW1/4,SW1/4,SE1/4,SE1/4       |
| top pipe  | 754.46 | West  | 1229.45 | Lat= 39.08905 Long = 94.63503 |

Lat & Long derived from Shawnee 7.5 quad map. WGS84.

Elevation established from existing project. NAVD 88

If you have any questions, please feel free to call me. Thank you for the opportunity to be of service to you.

Dennis L Handke, RLS

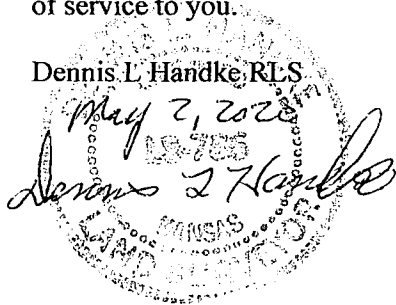

RECEIVED  
MAY 27 2020  
BUREAU OF WATER