

WATER WELL RECORD

Form WWC-5

Original Record  Correction  Change in Well Use

Division of Water Resources App. No.

Well ID **TMW10**

1 LOCATION OF WATER WELL: County Wyandotte Fraction NE 1/4 NW 1/4 NW 1/4 NW 1/4 Section Number 9 Township Number T 11 S Range Number R 23  E  W

2 WELL OWNER: Last Name: First: Street or Rural Address where well is located (if unknown, distance and direction from nearest town or intersection): If at owner's address, check here:  Business: Kansas Department of Health & Environment (Taystee Fresh Bread) Address: 1000 SW Jackson City Topeka State: KS ZIP: 66612 1549 State Ave, Kansas City, KS

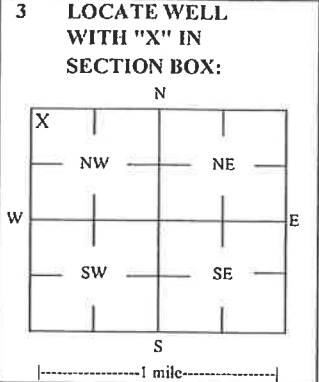

4 DEPTH OF COMPLETED WELL: 15 ft Depth(s) Groundwater Encountered: 1) \_\_\_\_\_ ft 2) \_\_\_\_\_ ft 3) \_\_\_\_\_ ft, or 4)  Dry Well WELL'S STATIC WATER LEVEL: 7.09 ft.  below land surface, measured on (mo-day-yr) 10/13/20  above land surface, measured on (mo-day-yr) \_\_\_\_\_ Pump test data: Well water was \_\_\_\_\_ ft after \_\_\_\_\_ hours pumping \_\_\_\_\_ gpm Water well was \_\_\_\_\_ ft after \_\_\_\_\_ hours pumping \_\_\_\_\_ gpm Estimated Yield: \_\_\_\_\_ gpm Bore Hole Diameter: 7.25 in to \_\_\_\_\_ ft, and \_\_\_\_\_ in to \_\_\_\_\_ ft

5 Latitude: 39.11644 (decimal degrees) Longitude: 94.64737 (decimal degrees) Horizontal Datum  WGS 84  NAD 83  NAD 27 Source for Latitude/Longitude:  GPS (unit make/model: \_\_\_\_\_) (WAAS enabled?  Yes  No)  Land Survey  Topographic Map  Online Mapper 6 Elevation 841.65 ft  Ground Level  TOC Source  Land Survey  GPS  Topographic Map  Other

7 WELL WATER TO BE USED AS: 1 Domestic:  Household  Lawn & Garden  Livestock 2  Irrigation 3  Feedlot 4  Industrial 5  Public Water Supply: well ID \_\_\_\_\_ 6  Dewatering: how many wells? \_\_\_\_\_ 7  Aquifer Recharge: well ID \_\_\_\_\_ 8  Monitoring: well ID TMW10 9 Environmental Remediation: well ID \_\_\_\_\_  Air Sparge  Soil Vapor Extractor  Recovery  Injection 10  Oil Field Water Supply: lease \_\_\_\_\_ 11 Test Hole: well ID \_\_\_\_\_  Cased  Uncased  Geotechnical 12 Geothermal: How many bores? \_\_\_\_\_ a) Closed Loop  Horizontal  Vertical b) Open Loop  Surface Discharge  Inj. of Water  Other (specify): \_\_\_\_\_

Was a chemical/bacteriological sample submitted to KDHE?  Yes  No If yes, date sample was submitted: \_\_\_\_\_ Water well disinfected?  Yes  No

8 TYPE OF CASING USED:  Steel  PVC  Other \_\_\_\_\_ CASING JOINTS:  Glued  Clamped  Welded  Threaded Casing diameter 2 in. to 5 ft, Diameter \_\_\_\_\_ in. to \_\_\_\_\_ ft, Diameter \_\_\_\_\_ in. to \_\_\_\_\_ ft, Casing height above land surface -0.64 in. Weight \_\_\_\_\_ lbs./ft. Well thickness or gauge No \_\_\_\_\_ TYPE OF SCREEN OR PERFORATION MATERIAL:  Steel  Stainless Steel  Fiberglass  PVC  Other (Specify) \_\_\_\_\_  Brass  Galvanized Steel  Concrete tile  None used (open hole) SCREEN OR PERFORATION OPENINGS ARE:  Continuous Slot  Mill Slot  Gauze Wrapped  Torch Cut  Drilled Holes  Other (Specify) \_\_\_\_\_  Louvered Shutter  Key Punched  Wire Wrapped  Saw Cut  None (Open Hole) SCREEN-PERFORATED INTERVALS: From 5 ft. to 15 ft, From \_\_\_\_\_ ft. to \_\_\_\_\_ ft, From \_\_\_\_\_ ft. to \_\_\_\_\_ ft, GRAVEL PACK INTERVALS: From 3 ft. to 15 ft, From \_\_\_\_\_ ft. to \_\_\_\_\_ ft, From \_\_\_\_\_ ft. to \_\_\_\_\_ ft,

9 GROUT MATERIAL:  Neat cement  Cement grout  Bentonite  Other Concrete: 0-1' Grout intervals: From 1 ft. to 3 ft, From \_\_\_\_\_ ft. to \_\_\_\_\_ ft, From \_\_\_\_\_ ft. to \_\_\_\_\_ ft,

Nearest source of possible contamination:  Septic Tank  Lateral Lines  Pit Privy  Livestock Pens  Insecticide Storage  Sewer Lines  Cess Pool  Sewage Lagoon  Fuel Storage  Abandoned Water Well  Watertight Sewer Lines  Seepage Pit  Feedyard  Fertilizer Storage  Oil Well / Gas Well  Other (Specify) \_\_\_\_\_ Direction from well? SW Distance from well? ~315 ft

10 FROM TO LITHOLOGIC LOG FROM TO LITHO. LOG (cont.) or PLUGGING INTERVALS

0	0.5	Topsoil/sandy/silty/clay with gravel, rubble mix			
0.5	15	Silty clay			

Notes: KDHE ID: Taystee Fresh Bread; U4-105-01312 Target of monitoring well is shallow groundwater, <20' of grout was installed at the direction of KDHE.

11 CONTRACTOR'S OR LANDOWNER'S CERTIFICATION: This water well was  constructed,  reconstructed, or  plugged under my jurisdiction and was completed on (mo-day-year) 9/3/20 and this record is true to the best of my knowledge and belief. Kansas Water Well Contractor's License No 757 This Water Well Record was completed on (mo-day-year) 11/4/20 under the business name of Larsen & Associates, Inc. Signature \_\_\_\_\_

# DENNIS L HANDKE

1820 NW 59th Terrace  
TOPEKA, KANSAS 66618  
785-286-4047 Home

Jess Chapman  
Larsen & Associates  
1311 E. 25<sup>th</sup> Street, Suite B  
Lawrence, Kansas, 66046

November 4, 2020

RE: Monitor Well Elevation Survey  
1730 Minnesota Ave., Kansas City, Kansas

Proj. 20-00YY  
Taystee Fresh Bread  
U4-105-01312

Bench Mark: Chisled Square on Northeast corner of concrete signal light base at Southwest corner of property.

Elev: 846.93	North 4867.49	West 5229.25	(from SE Cor. Sec. 9-11-23E)	
TMW-1 rim	846.46	North	4974.41	NW1/4,NW1/4,NW1/4,NW1/4
top pipe	845.99	West	5143.38	Lat= 39.11599 Long = 94.64894
TMW-2 rim	850.37	North	4952.01	NW1/4,NW1/4,NW1/4,NW1/4
top pipe	850.01	West	5186.34	Lat= 39.11593 Long = 94.64909
TMW-4 rim	846.54	North	4864.66	SW1/4,NW1/4,NW1/4,NW1/4
top pipe	846.15	West	5189.55	Lat= 39.11569 Long = 94.64910
TMW-5 rim	845.92	North	4748.75	SE1/4,NE1/4,NE1/4,NE1/4 (Sec. 8-11-23E)
top pipe	845.43	West	5292.05	Lat= 39.11537 Long = 94.64946
TMW-6 rim	839.62	North	5209.95	SE1/4,SW1/4,SW1/4,SW1/4 (Sec. 4-11-23E)
top pipe	839.16	West	4787.04	Lat= 39.11663 Long = 94.64768
TMW-7 rim	847.58	North	4773.77	SW1/4,NW1/4,NW1/4,NW1/4
top pipe	847.21	West	5117.14	Lat= 39.11544 Long = 94.64885
TMW-8 rim	853.05	North	4972.08	NW1/4,NW1/4,NW1/4,NW1/4
top pipe	852.64	West	5231.77	Lat= 39.11598 Long = 94.64925
TMW-10 rim	842.29	North	5141.57	NE1/4,NW1/4,NW1/4,NW1/4
top pipe	841.65	West	4698.84	Lat= 39.11644 Long = 94.64737

Lat & Long derived from Shawnee 7.5 quad map. WGS84.

Elevation established from USGS BM T 281 NAVD 88

If you have any questions, please feel free to call me. Thank you for the opportunity to be of service to you.

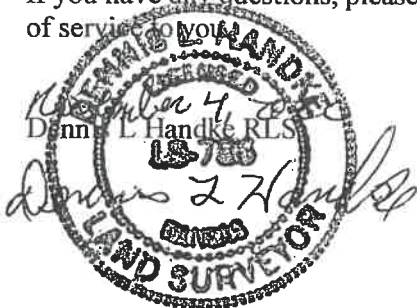

Wyandotte

4-11-23E  
8-11-23E  
9-11-23E

NOTE: Figures exhibited within this report are only to be used within the context of this report. Placement of property lines, wells, structures, and roads is based on the available information from county appraiser maps, surveys, site visits, and/or previous vendor reports and should be considered approximate.

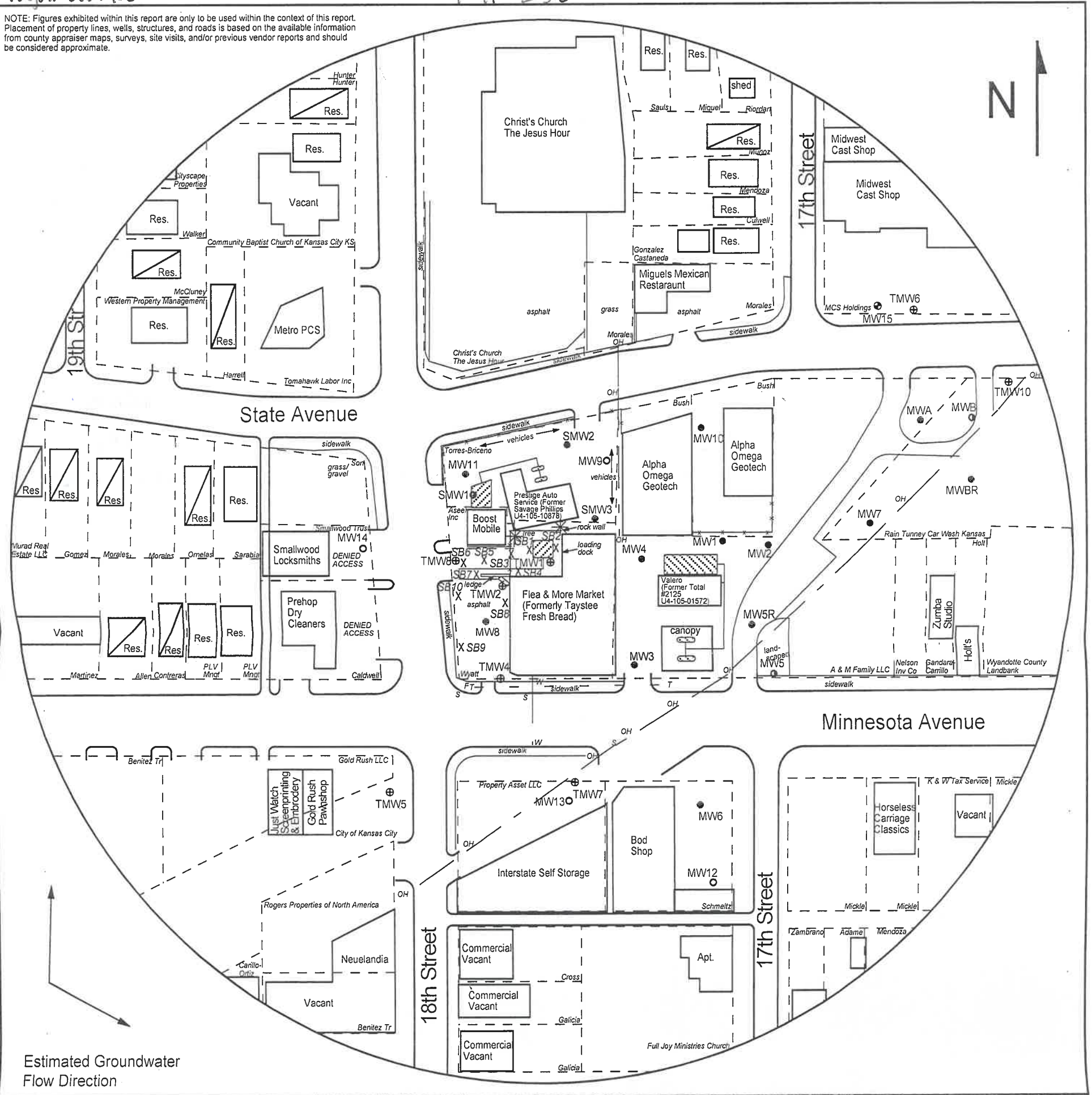

Estimated Groundwater Flow Direction

FIGURE 2.2 - 500 FT RADIUS AREA BASE MAP

**larsen**  
& ASSOCIATES, INC.

1311 E 25th St., Suite B Lawrence, KS 66046  
785-841-8707 office  
785-865-4282 fax

**PROJECT:**  
Taystee Fresh Bread  
1730 Minnesota Ave.  
Kansas City, KS  
KDHE ID: U4-105-01312  
Date: 10/13/20



**LEGEND**

- Approximate Location of Former UST Basin, Product Lines & Pump Islands
- Approximate Location of Active UST Basin, Product Lines & Pump Islands
- Building with Basement
- Approximate Location of Property Line
- Existing Monitoring Well
- Plugged/Destroyed Well
- Destroyed Well
- Abandoned Well
- Monitoring Well (Installed 8/31/20, 9/1-3/20, 10/13/20)
- Soil Boring (Drilled 8/31/20, 9/1-2/20)
- Fire Hydrant
- Sewer Inlet
- Overhead Lines (25'-40' high)
- Telephone Lines (2 - 6 ft bgs)
- Water Lines (2 - 6 ft bgs)

NOTE: SB1 & SB2 were installed locations are approximate.