

WATER WELL PLUGGING RECORD

Form WWC-5P

KSA 82a-1212

ID NO.

MW24

<b>1 LOCATION OF WATER WELL:</b> County: Wyandotte	Fraction SW¼ SW¼ SW¼ SW¼	Section Number 35	Township Number T 11 S	Range Number 25 <input checked="" type="checkbox"/> E <input type="checkbox"/> W
---	-----------------------------	----------------------	---------------------------	---

Street/Rural Address of Well Location; if unknown, distance & direction from nearest town or intersection: If at owner's address, check here   
 4601 N. Rainbow Blvd., Kansas City KS

**Global Positioning Systems (GPS) information:**  
 Latitude: N 39.04440° (in decimal degrees)  
 Longitude: W 94.61153° (in decimal degrees)  
 Elevation: NA  
 Horizontal Datum  WGS84,  NAD83,  NAVD27  
 Collection Method:

**2 WATER WELL OWNER:** KDHE  
 RR#, St. Address, Box #: 1000 SW Jackson Blvd  
 City, State ZIP Code: Topeka, KS 66612

GPS unit (Make/model): \_\_\_\_\_  
 Digital Map/Photo,  Topographic Map  Land Survey  
 Est. Accuracy:  <3 m,  3-5 m,  5-15 m,  >15 m

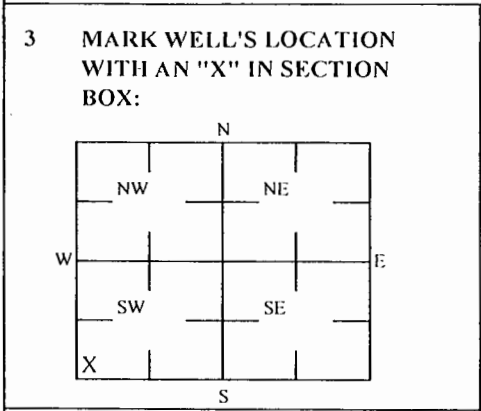

**4 DEPTH OF WELL** 28.93 ft. MW24  
 WELL'S STATIC WATER LEVEL \_\_\_\_\_ ft  
 WELL WAS USED AS:  
 Domestic  Public Water Supply  Dewatering  
 Irrigation  Oil Field Water Supply  Monitoring  
 Feedlot  Domestic (Lawn & Garden)  Injection Well  
 Industrial  Air Conditioning  Other \_\_\_\_\_  
 Was a chemical/bacteriological sample submitted to Department? Yes  No

**5 TYPE OF BLANK CASING USED:**  
 Steel  RMP (SR)  Wrought  Fiberglass  Other (Specific below)  
 PVC  ABS  Asbestos-Cement  Concrete Tile  
 Blank casing diameter 2 in. Was casing pulled? Yes  No  If yes, how much 2.54 ft  
 Casing height above or below land surface NA in.

**6 GROUT PLUG MATERIAL:**  Neat cement  Cement grout  Bentonite  Other Asphalt: 0-0.5'; Soil: 0.5-3'  
 Grout Plug Intervals: From 3 ft to 28.93 ft, From \_\_\_\_\_ ft to \_\_\_\_\_ ft, From \_\_\_\_\_ ft to \_\_\_\_\_ ft.  
 What is the nearest source of possible contamination:  
 Septic tank  Seepage pit  Fuel storage  Other (specify below) \_\_\_\_\_  
 Sewer lines  Pit privy  Fertilizer storage \_\_\_\_\_  
 Watertight sewer lines  Sewage lagoon  Insecticide storage \_\_\_\_\_  
 Lateral lines  Feed yard  Abandoned water well \_\_\_\_\_  
 Cess pool  Livestock pens  Oil well/Gas well \_\_\_\_\_  
 Direction from well? \_\_\_\_\_  
 How many feet? \_\_\_\_\_

FROM	TO	PLUGGING MATERIALS	FROM	TO	PLUGGING MATERIALS
0	0.5	Asphalt			
0.5	3	Soil			
3	28.93	Bentonite			

KDHE ID: Former Amoco; U4-105-14658

**7 CONTRACTOR'S OR LANDOWNER'S CERTIFICATION:** This water well was plugged under my jurisdiction and was completed on (mo/day/year) 5/12/22 and this record is true to the best of my knowledge and belief. Kansas Water Contractor's License No. 757. This Water Well Record was completed on (mo/day/year) 5/17/22 under the business name of Larsen & Associates, Inc. By (signature) \_\_\_\_\_

Send one white copy to Kansas Department of Health & Environment, Geology Section, 1000 SW Jackson Street, Ste. 420, Topeka, KS 66612-1367. Send one copy to WATER WELL OWNER and retain one for your records  
 Visit us at <http://www.kdheks.gov/waterwell/index.html> Telephone 785-296-5524.

NOTE: Figures exhibited within this report are only to be used within the context of this report. Placement of property lines, wells, structures, and roads is based on the available information from county appraiser maps, surveys, site visits, and/or previous vendor reports and should be considered approximate.

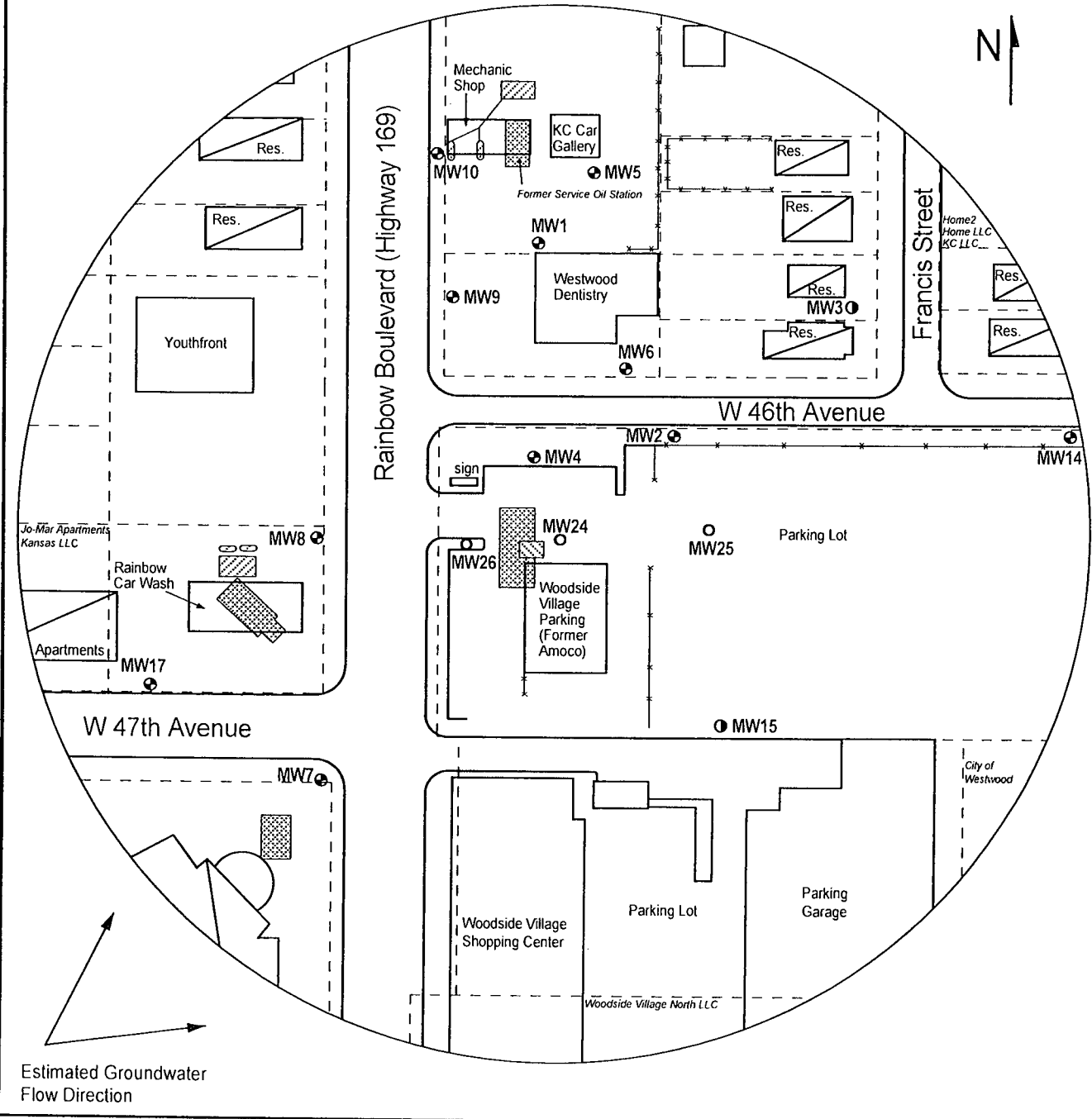

FIGURE 1 - 350 FT RADIUS AREA BASE MAP



1311 E 25th St., Suite B (785) 841-8707 office  
Lawrence, KS 66046 (785) 865-4282 fax

**PROJECT:**

Former Amoco  
4601 N. Rainbow Blvd.  
Kansas City, KS  
KDHE ID: U4-105-14658  
Date: May 12 & 14, 2022



**LEGEND:**

- Approximate Location of Former UST Basins, Pump Islands, & Product Lines
- Approximate Location of Suspected Former UST Basin
- Former Filling Stations from Sanborn Map (1963)
- Building with Basement
- Approximate Location of Property Line
- Plugged Monitoring Well (Former Amoco U4-105-14658)
- Monitoring Well (Service Oil U4-105-10370)
- Destroyed Well

NOTE: Location of off-site former product lines is unknown.