

WATER WELL RECORD

Form WWC-5

Division of Water Resources App. No.

Well ID

MW19

Original Record Correction Change in Well Ust

1 LOCATION OF WATER WELL: County Wyandotte Fraction SE 1/4 NW 1/4 SE 1/4 SW 1/4 Section Number 20 Township Number T 11 S Range Number R 25 E W

2 WELL OWNER: Last Name: Business: KDHE Address: 1000 SW Jackson City Topeka State: KS ZIP: 66612 Street or Rural Address where well is located (if unknown, distance and direction from nearest town or intersection): ~180' E of 2900 Strong Ave., Kansas City, KS

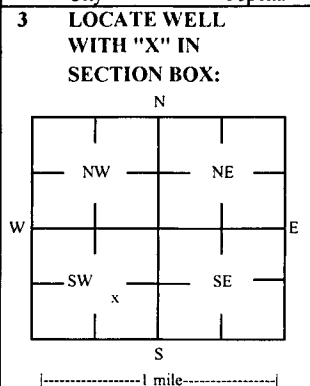

3 LOCATE WELL WITH 'X' IN SECTION BOX: 4 DEPTH OF COMPLETED WELL: 35 ft Depth(s) Groundwater Encountered: 1) 35 ft 2) 27.64 ft 3) Dry Well 4) Dry Well WELL'S STATIC WATER LEVEL: 27.64 ft

5 Latitude: 39.07528 (decimal degrees) Longitude: 94.66197 (decimal degrees) Horizontal Datum: X WGS 84 NAD 83 NAD 27 Source for Latitude/Longitude: GPS (unit make/model): (WAAS enabled? Yes No) X Land Survey Topographic Map Online Mapper

7 WELL WATER TO BE USED AS: 1 Domestic: Household Lawn & Garden Livestock Irrigation Feedlot Industrial 2 Public Water Supply: well ID Dewatering: how many wells? Aquifer Recharge: well ID Monitoring: well ID MW19 Environmental Remediation: well ID Air Sparge Soil Vapor Extractor Recovery Injection 3 Oil Field Water Supply: lease 4 Test Hole: well ID Cased Uncased Geotechnical 5 Geothermal: How many bores? a) Closed Loop Horizontal Vertical b) Open Loop Surface Discharge Inj. of Water Other (specify):

Was a chemical/bacteriological sample submitted to KDHE? Yes No Water well disinfected? Yes No If yes, date sample was submitted:

8 TYPE OF CASING USED: Steel PVC Other CASING JOINTS: Glued Clamped Welded Threaded Casing diameter 2 in. to 20 ft, Diameter in. to ft, Diameter in. to ft, Casing height above land surface -0.49 in. Weight lbs./ft. Well thickness or gauge No TYPE OF SCREEN OR PERFORATION MATERIAL: Steel Stainless Steel Fiberglass PVC Other (Specify) Brass Galvanized Steel Concrete tile None used (open hole) SCREEN OR PERFORATION OPENINGS ARE: Continuous Slot Mill Slot Gauze Wrapped Torch Cut Drilled Holes Other (Specify) Louvered Shutter Key Punched Wire Wrapped Saw Cut None (Open Hole) SCREEN-PERFORATED INTERVALS: From 20 ft. to 35 ft, From ft. to ft, From ft. to ft, GRAVEL PACK INTERVALS: From 18 ft. to 35 ft, From ft. to ft, From ft. to ft,

9 GROUT MATERIAL: Neat cement Cement grout Bentonite Other Concrete: 0-0.5' Grout intervals: From 0.5 ft. to 18 ft, From ft. to ft, From ft. to ft,

Nearest source of possible contamination: Septic Tank Lateral Lines Pit Privy Livestock Pens Insecticide Storage Sewer Lines Cess Pool Sewage Lagoon Fuel Storage Abandoned Water Well Watertight Sewer Lines Seepage Pit Feedyard Fertilizer Storage Oil Well / Gas Well Other (Specify)

Direction from well? W Distance from well? ~195 ft

Table with columns: FROM, TO, LITHOLOGIC LOG, FROM, TO, LITHO. LOG (cont.) or PLUGGING INTERVALS. Rows: 0-1 Topsoil, clay; 1-6 Clay with rock fill; 6-15 Clay; 15-22 Silty clay; 22-35 Sand

Notes: KDHE ID: Kerr-McGee, Argentine: U4-105-11672 Target of monitoring well is shallow groundwater, <20' of grout was installed at the direction of KDHE.

11 CONTRACTOR'S OR LANDOWNER'S CERTIFICATION: This water well was constructed, reconstructed, or plugged under my jurisdiction and was completed on (mo-day-year) 2/16/22 and this record is true to the best of my knowledge and belief. Kansas Water Well Contractor's License No. 757 This Water Well Record was completed on (mo-day-year) 7/12/22 under the business name of Larsen & Associates, Inc. Signature

vogyan adunk

20-11-25E

# DENNIS L HANDKE

1820 NW 59th Terrace  
TOPEKA, KANSAS 66618  
785-286-4047 Home

Jess Chapman  
Larsen & Assoc.  
1311 E. 25<sup>th</sup> St., Suite B  
Topeka, Kansas 66046

April 15, 2022

RE: Monitor Well Elevation Survey  
2900 Strong Ave., Kansas City, Kansas

Proj. 22-00W  
Kerr-McGee, Argentine  
KDHE ID U4-105-11672

Bench Mark: Chisled square on NE corner of concrete storm inlet near SE corner of property.  
Elev.: 745.75      North 704.86      West 3820.19      (from SE Cor. Sec. 20-11-25E)

MW-18	rim	755.27	North	644.16	NE1/4,SW1/4,SE1/4,SW1/4
	top pipe	754.97	West	3603.28	Lat = 39.07503    Long = 94.66190
MW-19	rim	754.93	North	734.75	SE1/4,NW1/4,SE1/4,SW1/4
	top pipe	754.44	West	3624.28	Lat = 39.07528    Long = 94.66197

Lat & Long derived from Shawnee 7.5' quad map. WGS84.

Elevation derived from existing project. NAVD 88.

If you have any questions, please feel free to call me. Thank you for the opportunity to be

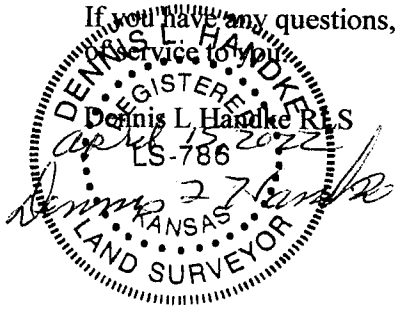

NOTE: Figures exhibited within this report are only to be used within the context of this report. Placement of property lines, wells, structures, and roads is based on the available information from county appraiser maps, surveys, site visits, and/or previous vendor reports and should be considered approximate.

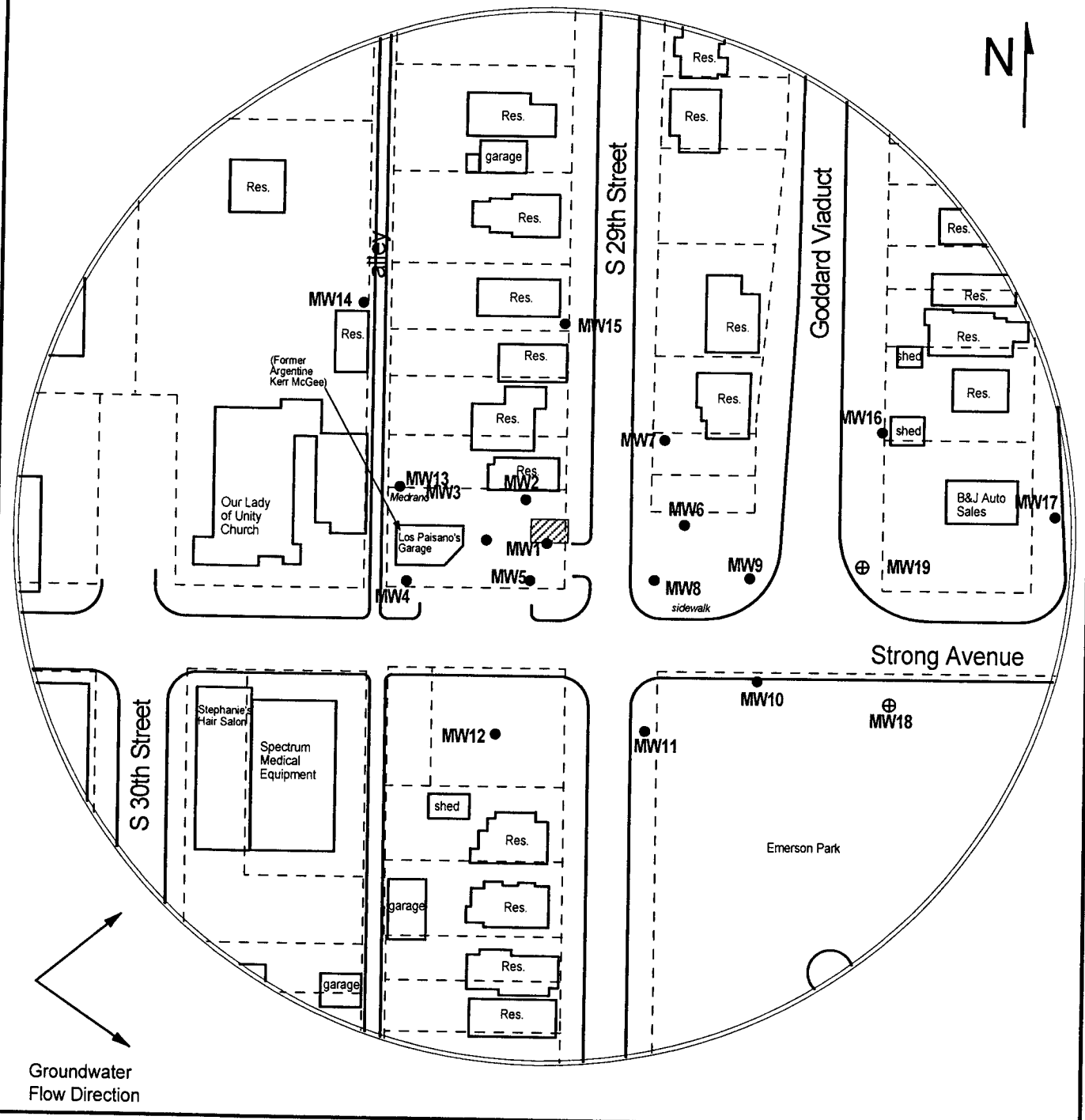

FIGURE 1 - SITE BASE MAP



**PROJECT:**  
 Kerr-McGee, Argentine  
 2900 Strong Avenue  
 Kansas City, KS  
 KDHE ID: U4-105-11672  
 Date: 2/16/22



**LEGEND:**

- Approximate Location of Former UST Basin
- Approximate Location of Property Line
- Monitoring Well
- New Monitoring Well (Installed 2/16/22)

1311 E 25th St., Suite B (785) 841-8707 office  
 Lawrence, KS 66046 (785) 865-4282 fax

NOTE: Approximate location of former pump island and product line is unknown.