

1 LOCATION OF WATER WELL: County: COFFEY Fraction: Gov. Lot 7 $\frac{1}{4}$ SE $\frac{1}{4}$ NW $\frac{1}{4}$ Section Number: Special Section 3 Township Number: T 11 S Range Number: R 5 E
 Distance and direction from nearest town or city street address of well if located within city? Grant Ave. in Junction City in City Limits

2 WATER WELL OWNER: P.D.F. Inc. Walter Robinson
 RR#, St. Address, Box #: 900 S. Washington Board of Agriculture, Division of Water Resources
 City, State, ZIP Code: Junction City, Kansas 66441 Application Number:

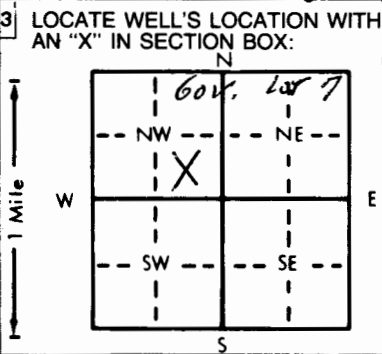

4 DEPTH OF COMPLETED WELL: 28 ft. ELEVATION:
 Depth(s) Groundwater Encountered: 1. 20 ft. 2. ft. 3. ft.
 WELL'S STATIC WATER LEVEL: 20 ft. below land surface measured on mo/day/yr
 Pump test data: Well water was ft. after hours pumping gpm
 Est. Yield: 40 gpm: Well water was ft. after hours pumping gpm
 Bore Hole Diameter: 10 in. to 80' in. to in. to ft.
 WELL WATER TO BE USED AS:
 1 Domestic 3 Feedlot 6 Oil field water supply 9 Dewatering 12 Other (Specify below)
 2 Irrigation 4 Industrial 7 Lawn and garden only 10 Monitoring well
 Was a chemical/bacteriological sample submitted to Department? Yes No; If yes, mo/day/yr sample was submitted
 Water Well Disinfected? Yes No

5 TYPE OF BLANK CASING USED:
 1 Steel 3 RMP (SR) 5 Wrought iron 8 Concrete tile CASING JOINTS: Glued Clamped
2 PVC 4 ABS 6 Asbestos-Cement 9 Other (specify below) Welded
 7 Fiberglass Threaded
 Blank casing diameter: 5 in. to 20 ft. Dia. in. to ft. Dia. in. to ft.
 Casing height above land surface: 2' in. weight 5.4 lbs./ft. Wall thickness or gauge No.
 TYPE OF SCREEN OR PERFORATION MATERIAL:
 1 Steel 3 Stainless steel 5 Fiberglass 7 PVC 10 Asbestos-cement
 2 Brass 4 Galvanized steel 6 Concrete tile 8 RMP (SR) 11 Other (specify)
 12 None used (open hole)
 SCREEN OR PERFORATION OPENINGS ARE:
 1 Continuous slot 3 Mill slot 16/1000' 5 Gauzed wrapped 8 Saw cut 11 None (open hole)
 2 Louvered shutter 4 Key punched 6 Wire wrapped 9 Drilled holes
 7 Torch cut 10 Other (specify)
 SCREEN-PERFORATED INTERVALS: From 20 ft. to 38 ft. From ft. to ft.
 From ft. to ft. From ft. to ft.
 GRAVEL PACK INTERVALS: From 20 ft. to 38 ft. From ft. to ft.
 From ft. to ft. From ft. to ft.

6 GROUT MATERIAL: 1 Neat cement 2 Cement grout 3 Bentonite 4 Other
 Grout Intervals: From 0 ft. to 20 ft. From ft. to ENVIRONMENTAL ft. From ft. to ft.
 What is the nearest source of possible contamination: None Close
 1 Septic tank 4 Lateral lines 7 Pit privy 10 Livestock pens 14 Abandoned water well
 2 Sewer lines 5 Cess pool 8 Sewage lagoon 11 Fuel storage 15 Oil well/Gas well
 3 Watertight sewer lines 6 Seepage pit 9 Feedyard 12 Fertilizer storage 16 Other (specify below)
 13 Insecticide storage
 Direction from well? How many feet?

FROM	TO	LITHOLOGIC LOG	FROM	TO	PLUGGING INTERVALS
0	12	Sandy Clay			
12	23	Sandy Clay & Fine Sand			
23	32	Fine Sand			
32	38	Coarse Sand			

7 CONTRACTOR'S OR LANDOWNER'S CERTIFICATION: This water well was (1) constructed, (2) reconstructed, or (3) plugged under my jurisdiction and was completed on (mo/day/year) 10/12/88 and this record is true to the best of my knowledge and belief. Kansas Water Well Contractor's License No. 451 This Water Well Record was completed on (mo/day/yr) 10/12/88 under the business name of Haldeman Well Drilling by (signature) Craig H.

INSTRUCTIONS: Use typewriter or ball point pen. PLEASE PRESS FIRMLY and PRINT clearly. Please fill in blanks, underline or circle the correct answers. Send top three copies to Kansas Department of Health and Environment, Bureau of Water Protection, Topeka, Kansas 66620-7320. Telephone: 913-296-5514. Send one to WATER WELL OWNER and retain one for your records.