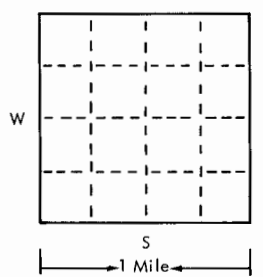

USE TYPEWRITER OR BALL POINT PEN-PRESS FIRMLY, PRINT CLEARLY.

T R EW sec 1/4 1/4 1/4 No.

WATER WELL RECORD  
KSA 82a-1201-1215

Kansas State Dept. Of Health  
(Water Well Contractors)  
Forbes-Bldg. 740  
Topeka, Kansas 66620

1 Location of well:	County <b>Geary</b>	Township name	Fraction <b>NW4</b>	Section number <b>35</b>	Town number <b>T11S</b>	Range number <b>R5E</b>
Distance and direction from nearest town or city: Street address of well location if in city:			3 Owner of well: Address: <b>City of Junction City Junction City, Kansas City Well No. 12</b>			
Locate with "X" in section below: N  S 1 Mile		Sketch map: <b>(Attached)</b>		4 Well depth: <b>59.20</b> ft. Date of completion <b>6/21/75</b> Well diameter <b>42</b> in.		
2 Type and color of material		From		To		5 <input type="checkbox"/> Cable tool <input type="checkbox"/> Rotary <input type="checkbox"/> Driven <input type="checkbox"/> Dug <input type="checkbox"/> Hollow rod <input type="checkbox"/> Jetted <input type="checkbox"/> Bored <input checked="" type="checkbox"/> Reverse rotary
						6 Use: <input type="checkbox"/> Domestic <input checked="" type="checkbox"/> Public supply <input type="checkbox"/> Industry <input type="checkbox"/> Irrigation <input type="checkbox"/> Air conditioning <input type="checkbox"/> Commercial <input type="checkbox"/> Test well <input type="checkbox"/>
Top soil		0		2		7 Casing: Material <b>Stl</b> Height: above/below Threaded <input type="checkbox"/> Welded <input checked="" type="checkbox"/> Surface <b>148</b> in. Diam. <b>16</b> in. to <b>39</b> ft. depth Weight <b>82</b> lbs./ft. <b>16</b> in. to <b>39</b> ft. depth Drive shoe? <input type="checkbox"/> Yes <input checked="" type="checkbox"/> No
Sandy silt		2		10		8 Screen: Manufacturer <b>Layne</b> Type <b>St. Stl</b> Dia. <b>16"</b> Slot/gauze <b>.105"</b> Length <b>20'</b> Set between <b>39</b> ft. and <b>59</b> ft. Fittings: Gravel pack <input checked="" type="checkbox"/> Yes <input type="checkbox"/> No Size range of material <b>1/8"</b>
Med. to coarse sand and gravel		10		34		9 Static water level: <b>15</b> ft. below land surface Date <b>6-19-75</b>
Med. to coarse sand & gravel with limestone rock		34		57		10 Pumping level below land surfaces: <b>21.6</b> ft. after <b>1</b> hrs. pumping <b>900</b> g.p.m. <b>21.75</b> ft. after <b>6</b> hrs. pumping <b>900</b> g.p.m. Estimated maximum yield <b>2000</b> g.p.m.
Shale		57		58		11 Water sample submitted: <input checked="" type="checkbox"/> Yes <input type="checkbox"/> No Date <b>6-20-75</b>
						12 Well head completion: <input type="checkbox"/> Pitless adapter <input checked="" type="checkbox"/> Inches above grade <b>12'4"</b>
						13 Well grouted? <input checked="" type="checkbox"/> Yes <input type="checkbox"/> No <input checked="" type="checkbox"/> Neat cement <input type="checkbox"/> Bentonite <input type="checkbox"/> Depth: From <b>0</b> ft. to <b>20</b> ft.
						14 Nearest source of possible contamination: ft <b>150</b> Direction <b>S</b> Type <b>sewer</b> Well disinfected upon completion? <input checked="" type="checkbox"/> Yes <input type="checkbox"/> No
						15 Pump: <input type="checkbox"/> Not installed Manufacturer's name <b>LAYNE</b> Model number <b>12BK</b> HP <b>75</b> Volts <b>440</b> Length of drop pipe <b>50</b> ft. capacity <b>900</b> g.p.m. Type: <input type="checkbox"/> Submersible <input checked="" type="checkbox"/> Turbine <input type="checkbox"/> Jet <input type="checkbox"/> Reciprocating <input type="checkbox"/> Centrifugal <input type="checkbox"/> Other
16 Remarks: elevation <b>1067.8</b>						17 Water well contractor's certification: This well was drilled under my jurisdiction and this report is true to the best of my knowledge and belief. <b>Layne Western Co.</b> <b>102</b> Business name License No. Address <b>Wichita, Kansas</b> Signed <b>[Signature]</b> Date <b>6/23/75</b>

Forward the white, blue and pink copies to the Kansas State Dept. Of Health.

Form WWC-5

FORT RILEY MILITARY RESERVATION

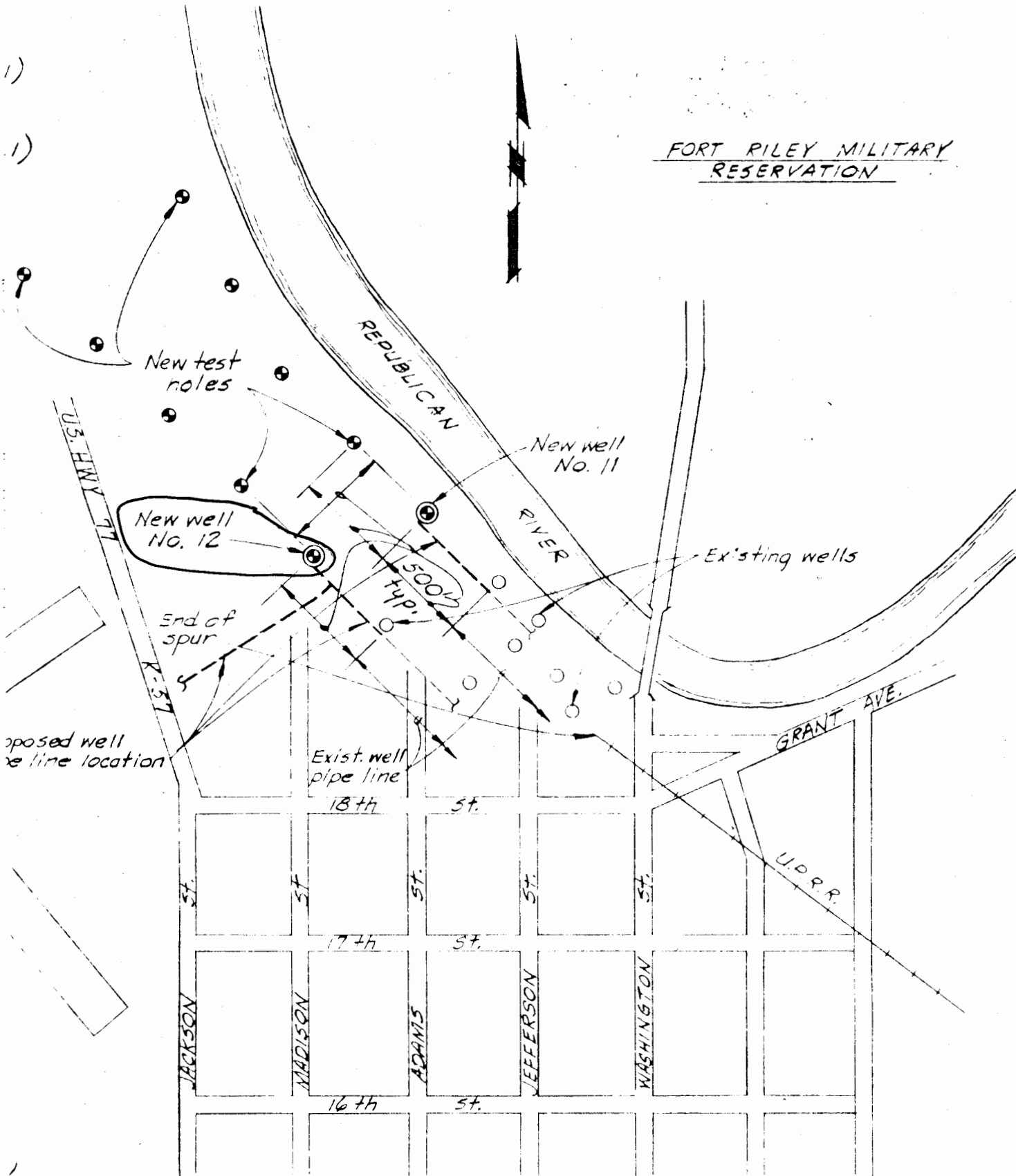

City of Junction City, Ka.