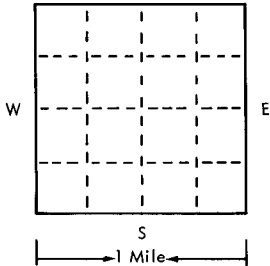

USE TYPEWRITER OR BALL POINT PEN-PRESS FIRMLY, PRINT CLEARLY.

WATER WELL RECORD
KSA 82a-1201-1215

T R EW sec 1/4 1/4 1/4 No.

Kansas State Dept. Of Health
(Water Well Contractors)
Forbes-Bldg. 740
Topeka, Kansas 66620

1 Location of well:	County Geary	Township name	Fraction NW4	Section number 35	Town number T11S	Range number R5E
Distance and direction from nearest town or city: Street address of well location if in city:				3 Owner of well: Address: City of Junction City Junction City, Kansas Well No. 13 (TH3-75)		
Locate with "X" in section below: N  W S 1 Mile		Sketch map: Attached		4 Well depth: 60 ft. Date of completion 7/9/75 Well diameter 42 in.		
2 Type and color of material				5 <input type="checkbox"/> Cable tool <input type="checkbox"/> Rotary <input type="checkbox"/> Driven <input type="checkbox"/> Dug <input type="checkbox"/> Hollow rod <input type="checkbox"/> Jetted <input type="checkbox"/> Bored <input checked="" type="checkbox"/> Reverse rotary		
				6 Use: <input type="checkbox"/> Domestic <input checked="" type="checkbox"/> Public supply <input type="checkbox"/> Industry <input type="checkbox"/> Irrigation <input type="checkbox"/> Air conditioning <input type="checkbox"/> Commercial <input type="checkbox"/> Test well <input type="checkbox"/>		
Type and color of material				7 Casing: Material Stl Height: above/below Threaded <input type="checkbox"/> Welded <input type="checkbox"/> Surface 12 Ft Diam. Weight 82 lbs./ft. 16 in. to 40 ft. depth Drive shoe? <input type="checkbox"/> Yes <input checked="" type="checkbox"/> No 36 in. to 20 ft. depth		
				8 Screen: Manufacturer LAYNE Type Stn. Stl. Dia. 16" Slot/gauze .105" Length 20' Set between 40 ft. and 60 ft. Fittings: 1/8 to 3/8" Gravel pack <input checked="" type="checkbox"/> Yes <input type="checkbox"/> No Size range of material		
Type and color of material				9 Static water level: 14 ft. below land surface Date 7-9-75		
				10 Pumping level below land surfaces: 23 ft. after 1 hrs. pumping 900 g.p.m. 24 ft. after 6 hrs. pumping 900 g.p.m. Estimated maximum yield 1500 g.p.m.		
Type and color of material				11 Water sample submitted: <input checked="" type="checkbox"/> Yes <input type="checkbox"/> No Date 7-9-75		
				12 Well head completion: <input type="checkbox"/> Pitless adapter <input checked="" type="checkbox"/> leaker above grade 12'		
Type and color of material				13 Well grouted? <input checked="" type="checkbox"/> Yes <input type="checkbox"/> No <input checked="" type="checkbox"/> Neat cement <input type="checkbox"/> Bentonite <input type="checkbox"/> Depth: From 2 ft. to 20 ft.		
				14 Nearest source of possible contamination: ft. 1000 Direction S. Sewer Well disinfected upon completion? <input checked="" type="checkbox"/> Yes <input type="checkbox"/> No		
Type and color of material				15 Pump: <input type="checkbox"/> Not installed Manufacturer's name LAYNE Model number 12RK HP 30 Volt 440 Length of drop pipe 50 ft. capacity 900 g.m.p. Type: <input type="checkbox"/> Submersible <input checked="" type="checkbox"/> Turbine <input type="checkbox"/> Jet <input type="checkbox"/> Reciprocating <input type="checkbox"/> Centrifugal <input type="checkbox"/> Other		
				16 Remarks: elevation 1069.0		
16 Remarks: elevation 1069.0 Topography: <input type="checkbox"/> Hill <input type="checkbox"/> Slope <input type="checkbox"/> Upland <input checked="" type="checkbox"/> Valley				17 Water well contractor's certification: This well was drilled under my jurisdiction and this report is true to the best of my knowledge and belief. Layne Western Co., Inc. 102 Business name License No. Address Wichita, Kansas Signed [Signature] Date 7/10/75 Authorized representative P.E.		

Forward the white, blue and pink copies to the Kansas State Dept. Of Health.

Form WWC-5

FORT RILEY MILITARY RESERVATION

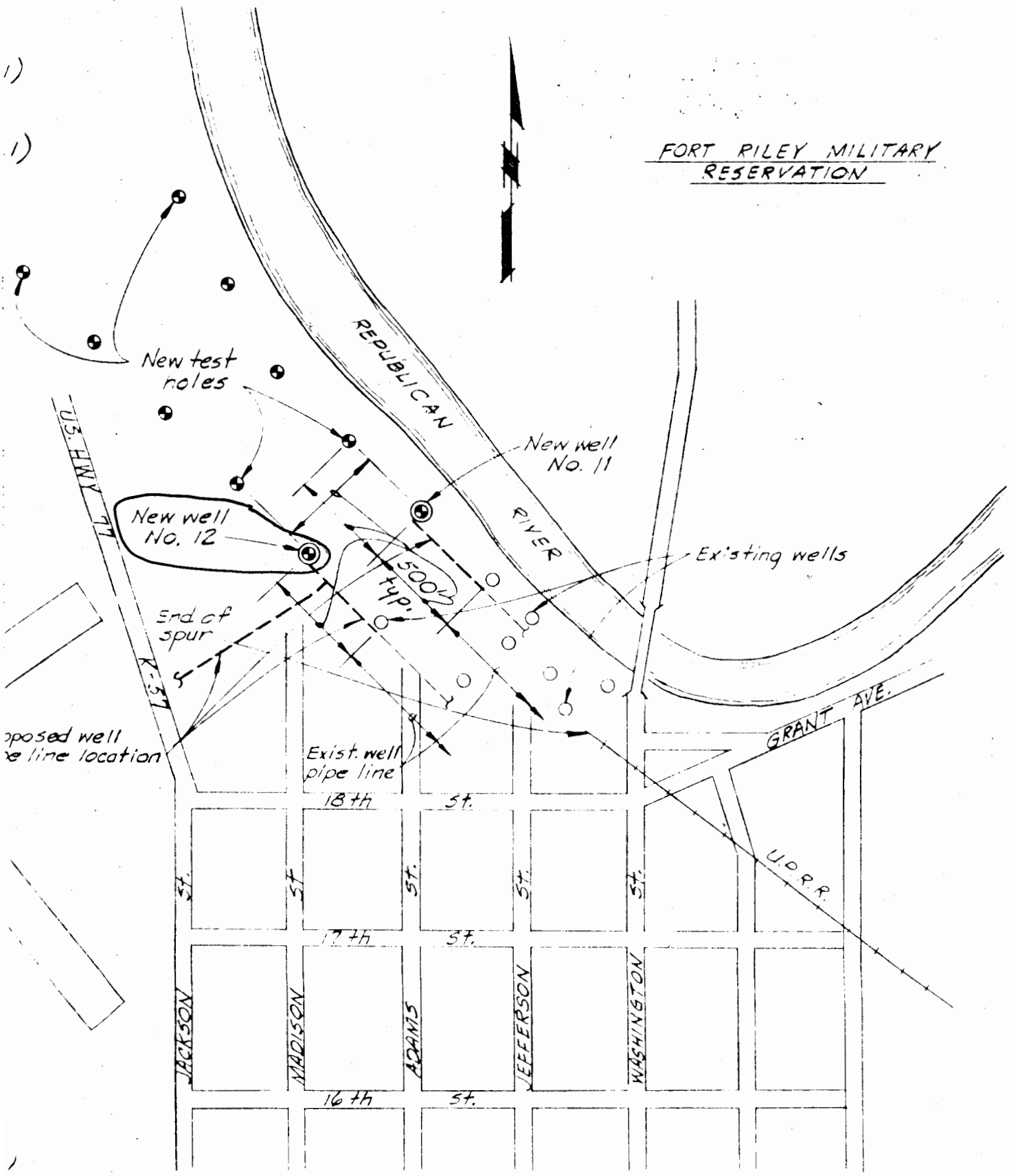

City of Junction City, Ka.