

CORRECTION(S) TO WATER WELL RECORD (WWC-5)
(to rectify lacking or incorrect information)

County: Geary

Location listed as:

Location changed to:

Section-Township-Range: None Given

30-11S-6E

Fraction ($\frac{1}{4}$ $\frac{1}{4}$ $\frac{1}{4}$): _____

SE SW SE NW

Other changes: Initial statements: Riley County

Changed to: Geary County

Comments: Section, township, and range determined by projecting normal Kansas survey system over Fort Riley.

verification method: Latitude & longitude, KGS "LED" conversion tool, and Junction City 1:24,000 topo. map.

initials: DRK date: 7/26/2010

submitted by: Kansas Geological Survey, Data Resources Library, 1930 Constant Ave., Lawrence, KS 66047-3726
to: Kansas Dept of Health & Environment, Bureau of Water, 1000 SW Jackson, Suite 420, Topeka, KS 66612-1367.

WATER WELL PLUGGING RECORD Form WWC-5P KSA 82a-1212 ID NO.

| | | | | |
|--|---|----------------|------------------------|---|
| 1 LOCATION OF WATER WELL: County: <u>Riley</u> | Fraction Not Gridded 1/4 1/4 1/4 1/4 | Section Number | Township Number T S | Range Number <input type="checkbox"/> E <input type="checkbox"/> W |
|--|---|----------------|------------------------|---|

| | |
|---|---|
| Street/Rural Address of Well Location; if unknown, distance & direction from nearest town or intersection: If at owner's address, check here <input type="checkbox"/> See attached map (at Well No. 10 site) | Global Positioning Systems (GPS) information: Latitude: <u>39.066285</u> (in decimal degrees) Longitude: <u>-96.80747</u> (in decimal degrees) Elevation: <u>unknown</u> Datum: <input type="checkbox"/> WGS84, <input checked="" type="checkbox"/> NAD83, <input type="checkbox"/> NAD27 Collection Method: <input checked="" type="checkbox"/> GPS unit (Make/Model: <u>WAAS</u>) <input type="checkbox"/> Digital Map/Photo, <input type="checkbox"/> Topographic Map, <input type="checkbox"/> Land Survey Est. Accuracy: <input type="checkbox"/> < 3 m, <input checked="" type="checkbox"/> 3-5 m, <input type="checkbox"/> 5-15 m, <input type="checkbox"/> > 15 m |
|---|---|

| | | | | | | | | | | | | |
|--|---|--|--|--------|--------|--|--|--------|--------|--|--|---|
| 2 WATER WELL OWNER: U.S. Army Corps of Engineers Federal Building RR#, St. Address, Box #: <u>601 East 12th Street</u> City, State ZIP Code: <u>Kansas City, MO 64106-2896</u> | 3 MARK WELL'S LOCATION WITH AN "X" IN SECTION BOX: <div style="text-align: center;"> N <table border="1" style="margin: auto; border-collapse: collapse;"> <tr><td style="width: 20px; height: 20px;"></td><td style="width: 20px; height: 20px;"></td></tr> <tr><td style="text-align: center;">--NW--</td><td style="text-align: center;">--NE--</td></tr> <tr><td style="width: 20px; height: 20px;"></td><td style="width: 20px; height: 20px;"></td></tr> <tr><td style="text-align: center;">--SW--</td><td style="text-align: center;">--SE--</td></tr> <tr><td style="width: 20px; height: 20px;"></td><td style="width: 20px; height: 20px;"></td></tr> </table> W E S </div> | | | --NW-- | --NE-- | | | --SW-- | --SE-- | | | 4 DEPTH OF WELL <u>70</u> ft. WELL'S STATIC WATER LEVEL <u>23</u> ft. WELL WAS USED AS: <input type="checkbox"/> Domestic <input type="checkbox"/> Public Water Supply <input type="checkbox"/> Dewatering <input type="checkbox"/> Irrigation <input type="checkbox"/> Oil Field Water Supply <input type="checkbox"/> Monitoring <input type="checkbox"/> Feedlot <input type="checkbox"/> Domestic (Lawn & Garden) <input type="checkbox"/> Injection Well <input type="checkbox"/> Industrial <input type="checkbox"/> Air Conditioning <input checked="" type="checkbox"/> Other <u>Test Well</u> Was a chemical/bacteriological sample submitted to Department? Yes <input type="checkbox"/> No <input checked="" type="checkbox"/> |
| | | | | | | | | | | | | |
| --NW-- | --NE-- | | | | | | | | | | | |
| | | | | | | | | | | | | |
| --SW-- | --SE-- | | | | | | | | | | | |
| | | | | | | | | | | | | |

5 TYPE OF BLANK CASING USED:

| | | | | |
|---|-----------------------------------|--|--|--|
| <input type="checkbox"/> Steel | <input type="checkbox"/> RMP (SR) | <input type="checkbox"/> Wrought | <input type="checkbox"/> Fiberglass | <input type="checkbox"/> Other (Specify below) _____ |
| <input checked="" type="checkbox"/> PVC | <input type="checkbox"/> ABS | <input type="checkbox"/> Asbestos-Cement | <input type="checkbox"/> Concrete Tile | |

Blank casing diameter 5 in. Was casing pulled? Yes No If yes, how much _____
 Casing height above or below land surface. 48 in.

6 GROUT PLUG MATERIAL: Neat cement Cement grout Bentonite Other _____

Grout Plug Intervals: From 70 ft. to 4 ft., From _____ ft. to _____ ft., From _____ to _____ ft.

What is the nearest source of possible contamination:
 Septic tank Seepage pit Fuel Storage Other (specify below) New well
 Sewer lines Pit privy Fertilizer storage
 Watertight sewer lines Sewage lagoon Insecticide storage
 Lateral lines Feedyard Abandoned water well Direction from well? West
 Cess pool Livestock pens Oil well/Gas well How many feet? 20

| FROM | TO | PLUGGING MATERIALS | FROM | TO | PLUGGING MATERIALS |
|------|----|--------------------|------|----|--------------------|
| 70 | 4 | Bentonite Chips | | | |
| 4 | 0 | Compacted Soil | | | |
| | | | | | |
| | | | | | |
| | | | | | |
| | | | | | |

7 CONTRACTOR'S OR LANDOWNER'S CERTIFICATION: This water well was plugged under my jurisdiction and was completed on (mo/day/year) 6/24/10 and this record is true to the best of my knowledge and belief. Kansas Water Well Contractor's License No. 185. This Water Well Record was completed on (mo/day/year) 7/6/10 under the business name of Clarke Well & Equipment, Inc. by (signature)

INSTRUCTIONS: Use typewriter or ballpoint pen. Please press firmly and print clearly. Please fill in blanks, underline or circle the correct answers. Send top three copies to Kansas Department of Health and Environment, Bureau of Water, Geology Section, 1000 SW Jackson St., Ste. 420, Topeka, Kansas 66612-1367. Telephone: 785/296-5524. Send one to Water Well Owner and retain one for your records. Visit us at <http://www.kdheks.gov/waterwell/index.html>.

Check one: White Copy Blue Copy Pink Copy

JOB #10075
MCKINZIE / FORT RILEY
WELL #10

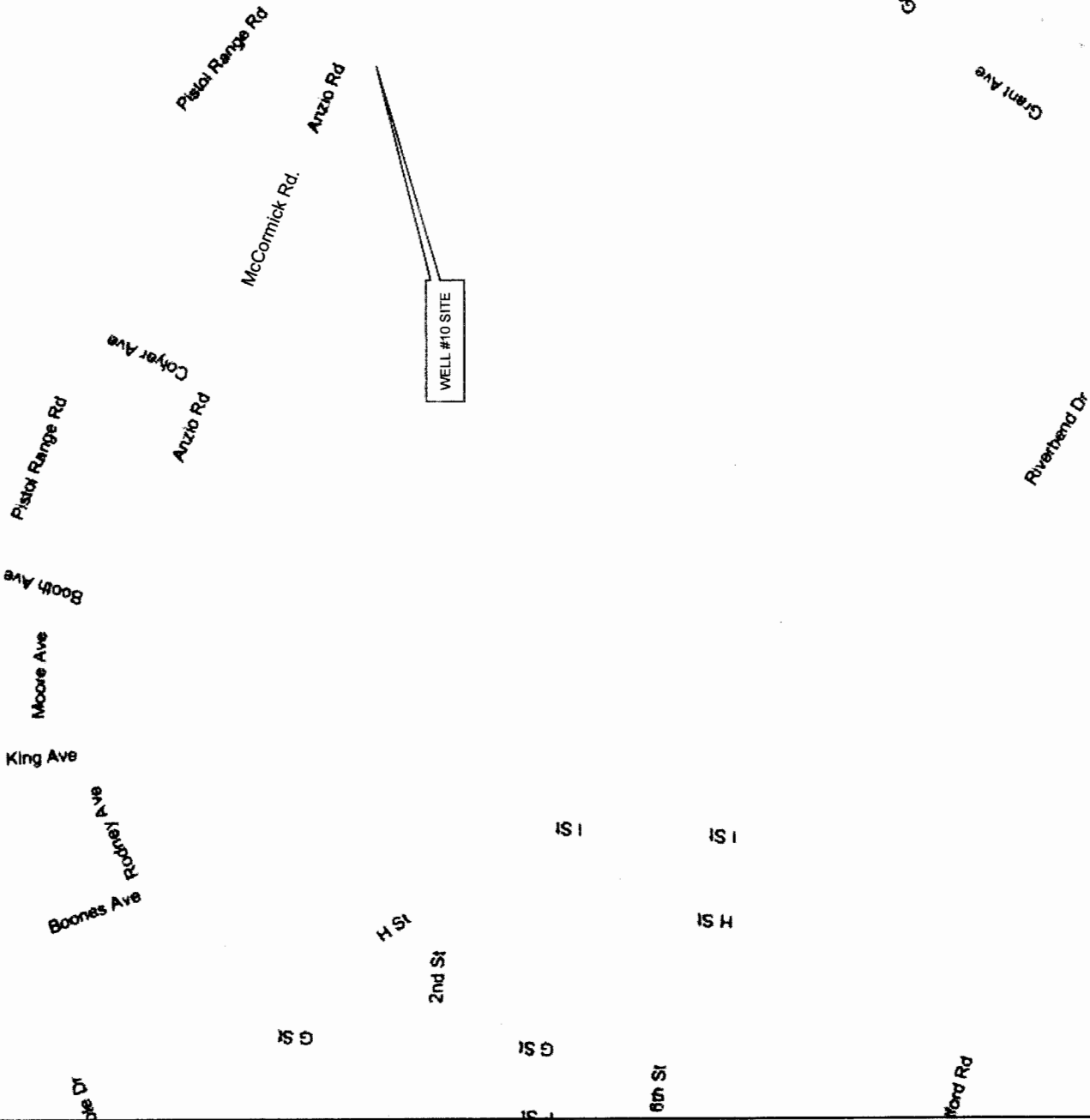

N
1 inch = 1,000 feet