

1 LOCATION OF WATER WELL: County: **GEARY** Fraction: **SW 1/4 NE 1/4** Section Number: **31** Township Number: **T 11 S** Range Number: **R 6** **(EW)**

Distance and direction from nearest town or city street address of well if located within city?
Former BLDG 1245 FORT RILEY - CAMP FUNSTON, KS. BLDG 1245 PZ-3

2 WATER WELL OWNER: **US ARMY CORPS OF ENGINEERS**
 RR#, St. Address, Box #: **601 EAST 12TH ST**
 City, State, ZIP Code: **KANSAS CITY MISSOURI 64106**
 Board of Agriculture, Division of Water Resources
 Application Number:

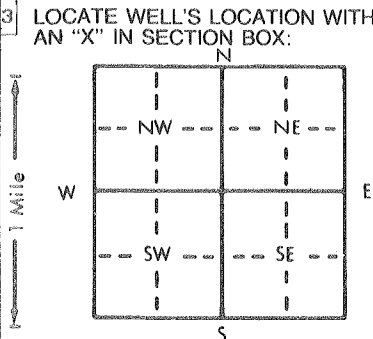

4 DEPTH OF COMPLETED WELL: **20** ft. ELEVATION: **1070.93**
 Depth(s) Groundwater Encountered: 1. **13.81** ft. 2. ft. 3. ft.
 WELL'S STATIC WATER LEVEL: **12** ft. below land surface measured on mo/day/yr **2-27-95**
 Pump test data: Well water was ft. after hours pumping gpm
 Est. Yield gpm: Well water was ft. after hours pumping gpm
 Bore Hole Diameter: **1** in. to **20** ft., and in. to ft.
 WELL WATER TO BE USED AS:
 5 Public water supply 8 Air conditioning 11 Injection well
 1 Domestic 3 Feedlot 6 Oil field water supply 9 Dewatering
 2 Irrigation 4 Industrial 7 Lawn and garden only 10 Monitoring well **PIEZOMETER**
 Was a chemical/bacteriological sample submitted to Department? Yes No **X**; If yes, mo/day/yr sample was submitted
 Water Well Disinfected? Yes No **X**

5 TYPE OF BLANK CASING USED:
 1 Steel 3 RMP (SR) 5 Wrought iron 8 Concrete tile CASING JOINTS: Glued Clamped
 2 PVC 4 ABS 6 Asbestos-Cement 9 Other (specify below) Welded
 7 Fiberglass Threaded
 Blank casing diameter: **1** in. to **17** ft., Dia in. to ft., Dia in. to ft.
 Casing height above land surface: **FLUSA** maintained weight lbs./ft. Wall thickness or gauge No.
 TYPE OF SCREEN OR PERFORATION MATERIAL:
 1 Steel 3 Stainless steel 5 Fiberglass 8 RMP (SR) 10 Asbestos-cement
 2 Brass 4 Galvanized steel 6 Concrete tile 9 ABS 11 Other (specify)
 12 None used (open hole)
 SCREEN OR PERFORATION OPENINGS ARE:
 1 Continuous slot 3 Mill slot **.010** 5 Gauzed wrapped 8 Saw cut 11 None (open hole)
 2 Louvered shutter 4 Key punched 6 Wire wrapped 9 Drilled holes
 7 Torch cut 10 Other (specify)
 SCREEN-PERFORATED INTERVALS: From **20** ft. to **17** ft., From ft. to ft.
 GRAVEL PACK INTERVALS: From **20** ft. to ft., From ft. to ft.

6 GROUT MATERIAL: 1 Neat cement 2 Cement grout 3 Bentonite 4 Other
 Grout Intervals: From ft. to ft., From ft. to ft., From ft. to ft.
 What is the nearest source of possible contamination:
 1 Septic tank 4 Lateral lines 7 Pit privy 10 Livestock pens 14 Abandoned water well
 2 Sewer lines 5 Cess pool 8 Sewage lagoon 11 Fuel storage 15 Oil well/Gas well
 3 Watertight sewer lines 6 Seepage pit 9 Feedyard 12 Fertilizer storage 16 Other (specify below)
 Direction from well? **USF. SITE FORMER**
 How many feet?

FROM	TO	LITHOLOGIC LOG	FROM	TO	PLUGGING INTERVALS
3	20	DIRECT PUSA WITHOUT SOIL CORING			
		LOCATION SEE ATTACHED DWG			

7 CONTRACTOR'S OR LANDOWNER'S CERTIFICATION: This water well was **(1)** constructed, (2) reconstructed, or (3) plugged under my jurisdiction and was completed on (mo/day/year) **2-26-95** and this record is true to the best of my knowledge and belief. Kansas Water Well Contractor's License No. **606** This Water Well Record was completed on (mo/day/yr) **4-19-98** under the business name of **PSA ENVIRONMENTAL (ESCC)** by (signature) **[Signature]**

INSTRUCTIONS: Use typewriter or ball point pen. PLEASE PRESS FIRMLY and PRINT clearly. Please fill in blanks, underline or circle the correct answers. Send top three copies to Kansas Department of Health and Environment, Bureau of Water, Topeka, Kansas 66620-0001. Telephone: 913-296-5545. Send one to WATER WELL OWNER and retain one for your records.

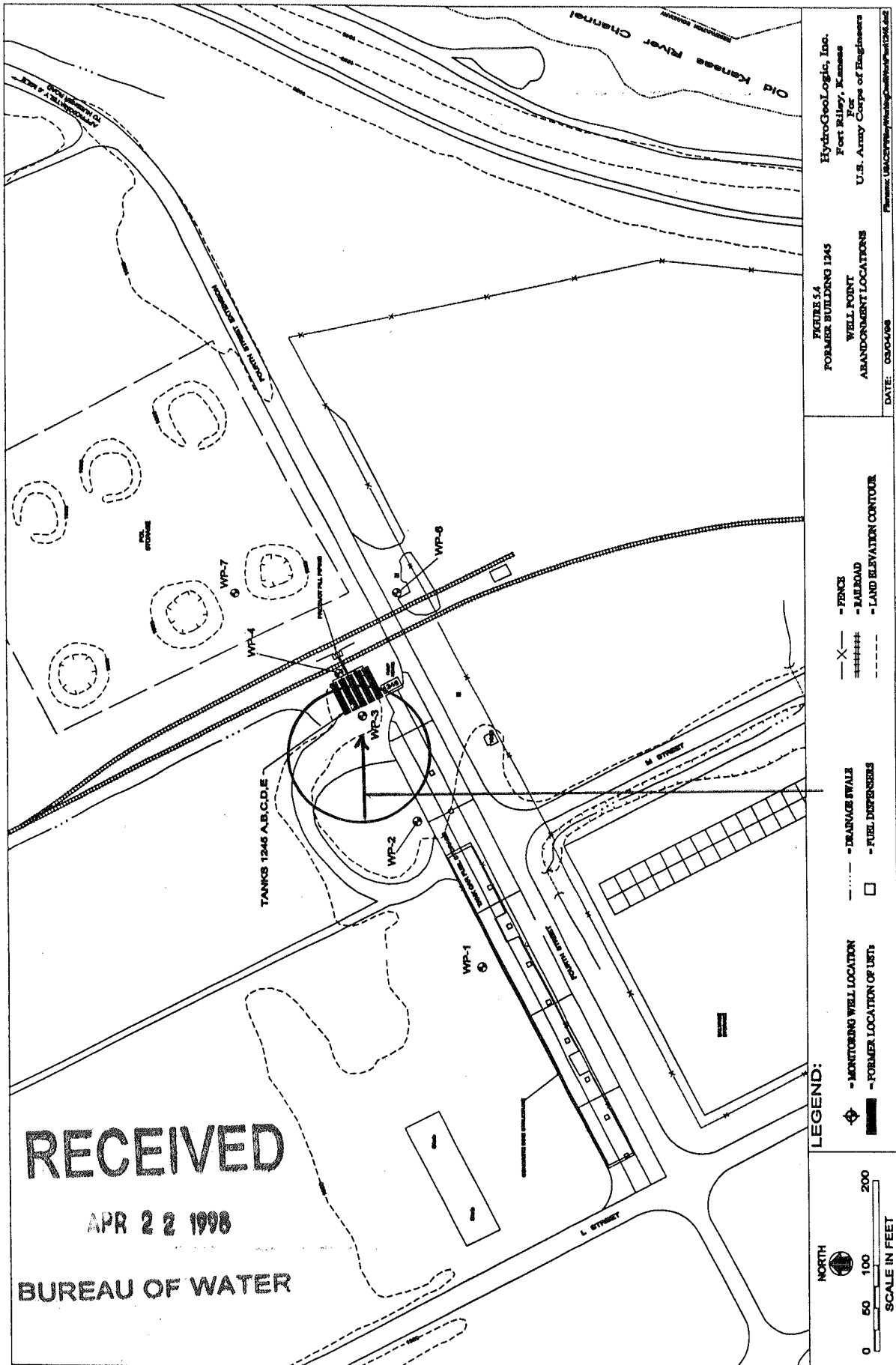

PIEZOMETER #3
FOR MER BLDG # 1245