

1	LOCATION OF WATER WELL:	Fraction	Section Number	Township Number	Range Number
County:	GEMMY	SW 1/4 NE 1/4 1/4	31	11 S	6 E

Distance and direction from nearest town or city street address of well if located within city?
 FT. RILEY, KS, CAMP FLEUSTON FORMER BLDG 1044 WP-6

2 WATER WELL OWNER: US ARMY CORPS OF ENGINEERS
 601 E 12TH ST
 RR#, St. Address, Box #: KC, MO 64106
 City, State, ZIP Code : Board of Agriculture, Division of Water Resources
 Application Number:

3 MARK WELL'S LOCATION WITH AN "X" IN SECTION BOX:

N			
W	PLS SEE DWG ATTACHED	E	
S			

4 DEPTH OF WELL... 23.10ft.
 WELL'S STATIC WATER LEVEL... 22.8ft.
 WELL WAS USED AS:
 1 Domestic 5 Public Water Supply 9 Dewatering
 2 Irrigation 6 Oil Field Water Supply 10 Monitoring Well
 3 Feedlot 7 Lawn and Garden Only 11 Injection Well
 4 Industrial 8 Air Conditioning 12 Other.....
 PIEZOMETER
 Was a chemical/bacteriological sample submitted to Department? Yes.....No. X.
 If yes, mo/day/yr sample was submitted.....
 Water Well Disinfected: Yes..... No. X...

5 TYPE OF BLANK CASING USED:
 1 Steel 3 RMP (SR) 5 Wrought 7 Fiberglass 9 Other (specify below)
 2 PVC 4 ABS 6 Asbestos-Cement 8 Concrete Tile
 Blank casing diameter... 1in. Was casing pulled? Yes. X. No..... If yes, how much... 5'
 Casing height above or below land surface... FLUSA. MTD.in.

6 GROUT PLUG MATERIAL: 1 Neat cement 2 Cement grout 3 Bentonite 4 Other.....
 Grout Plug Intervals: From... 23.10ft. to... 3ft., From.....ft. toft., From..... toft.
 What is the nearest source of possible contamination:
 1 Septic tank 6 Seepage pit 11 Fuel storage 16 Other (specify below)
 2 Sewer lines 7 Pit privy 12 Fertilizer storage FORMER UST.....
 3 Watertight sewer lines 8 Sewage lagoon 13 Insecticide storage SITE
 4 Lateral lines 9 Feedyard 14 Abandoned water well
 5 Cess Pool 10 Livestock pens 15 Oil well/Gas well
 Direction from well? How many feet?

FROM	TO	PLUGGING MATERIALS
23.10	3'	BENTONITE SAND
3'	0	CLAY THE NATIVE SOIL

Geoprobe Grout Plug
 in TRENCH LINE USED

7 CONTRACTOR'S OR LANDOWNER'S CERTIFICATION: This water well was plugged under my jurisdiction and was completed on (mo/day/year) 4-11-98 and this record is true to the best of my knowledge and belief. Kansas Water Well Contractor's License No. G.D.G. This Water Well Record was completed on (mo/day/year) 4-15-98 under the business name of ESSE d.b.a. PSD ENV.
 by (signature) [Signature]

INSTRUCTIONS: Use typewriter or ball point pen. Please press firmly and print clearly. Please fill in blanks, underline or circle the correct answers. Send top three copies to Kansas Department of Health and Environment, Bureau of Water, Topeka, Kansas 66620-0001. Telephone: 913/296-3565. Send one to Water Well Owner and retain one for your records.

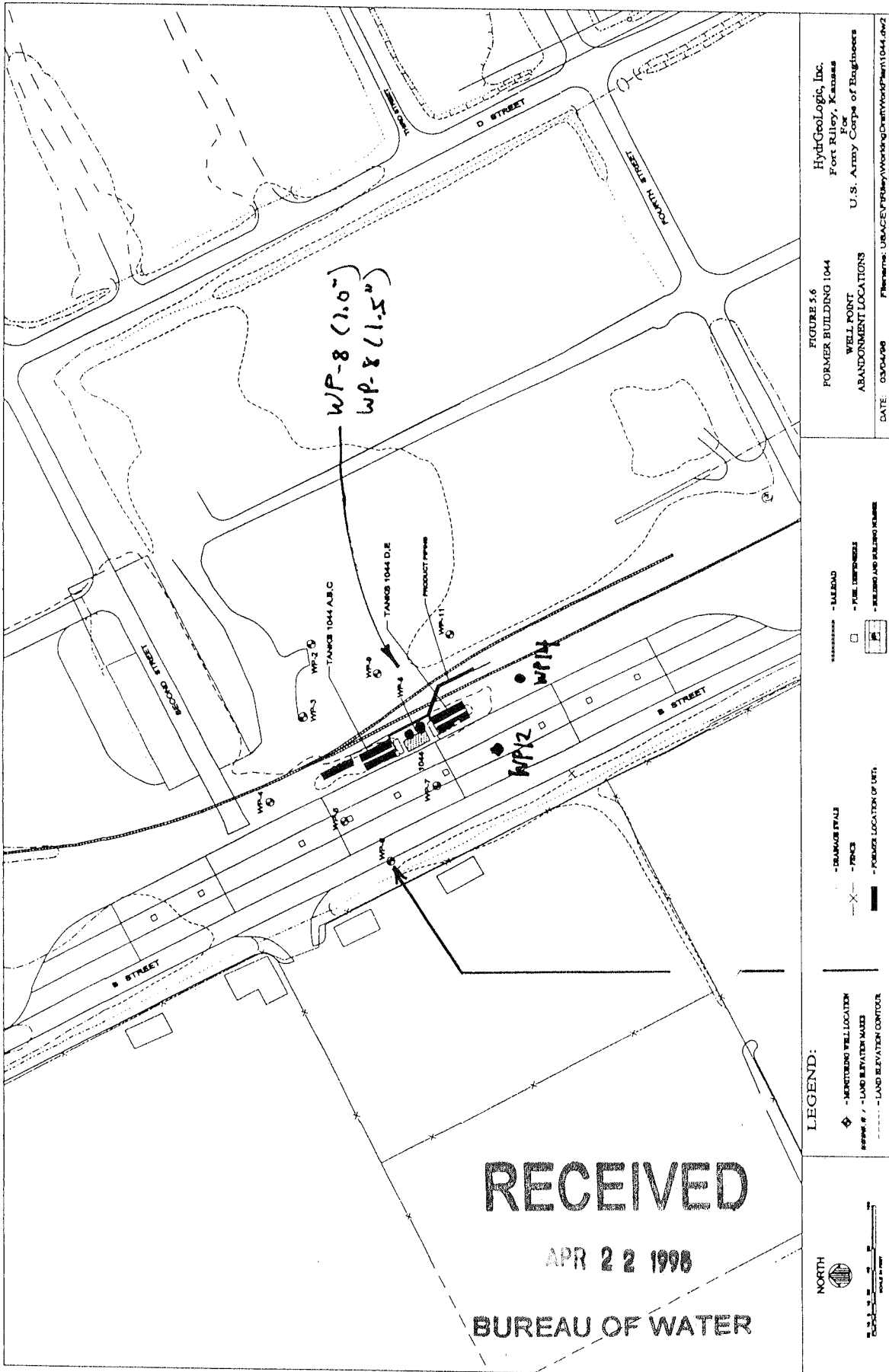

PIEZOMETER WP G
FORMER BLDG 1044