

WATER WELL RECORD Form WWC-5 KSA 82a-1212

1 LOCATION OF WATER WELL: Fraction SW 1/4 NW 1/4 Section Number 31 Township Number T 11 S Range Number R 6 E/W
 County: GOFF
 Distance and direction from nearest town or city street address of well if located within city?
FORT RILEY KS, CAMP FUNDED FORMER BLDG 1637 WP-3

2 WATER WELL OWNER: US ARMY CORPS OF ENGINEERS
 RR#, St. Address, Box #: 601 - E 12TH ST
 City, State, ZIP Code: KC, MO, 64106
 Board of Agriculture, Division of Water Resources
 Application Number:

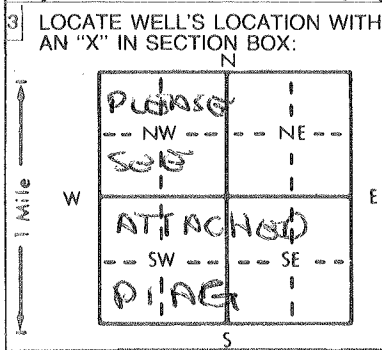

4 DEPTH OF COMPLETED WELL: 24.3 ft. ELEVATION: 1075.27
 Depth(s) Groundwater Encountered 123.8 ft. 2. ft. 3. ft.
 WELL'S STATIC WATER LEVEL 22.0 ft. below land surface measured on mo/day/yr 3-2-98
 Pump test data: Well water was ft. after hours pumping gpm
 Est. Yield gpm: Well water was ft. after hours pumping gpm
 Bore Hole Diameter: in. to ft., and in. to ft.
 WELL WATER TO BE USED AS: 5 Public water supply 8 Air conditioning 11 Injection well
 1 Domestic 3 Feedlot 6 Oil field water supply 9 Dewatering 12 Other (Specify below)
 2 Irrigation 4 Industrial 7 Lawn and garden only 10 Monitoring well PIEZOMETER
 Was a chemical/bacteriological sample submitted to Department? Yes No X If yes, mo/day/yr sample was sub-
 mitted Water Well Disinfected? Yes No X

5 TYPE OF BLANK CASING USED: 1 Steel 3 RMP (SR) 6 Asbestos-Cement 9 Other (specify below) Welded
2 PVC 4 ABS 7 Fiberglass Threaded FLUSH
 Blank casing diameter in. to ft., Dia in. to ft., Dia in. to ft.
 Casing height above land surface FLUSH MTD in., weight lbs./ft. Wall thickness or gauge No. SCN 40
 TYPE OF SCREEN OR PERFORATION MATERIAL: 7 PVC 10 Asbestos-cement
 1 Steel 3 Stainless steel 5 Fiberglass 8 RMP (SR) 11 Other (specify)
 2 Brass 4 Galvanized steel 6 Concrete tile 9 ABS 12 None used (open hole)
 SCREEN OR PERFORATION OPENINGS ARE: 5 Gauzed wrapped 8 Saw cut 11 None (open hole)
 1 Continuous slot 3 Mill slot 0.010 6 Wire wrapped 9 Drilled holes
 2 Louvered shutter 4 Key punched 7 Torch cut 10 Other (specify)
 SCREEN-PERFORATED INTERVALS: From 24.3 ft. to 21.3 ft., From ft. to ft.
 From ft. to ft., From ft. to ft.
 GRAVEL PACK INTERVALS: From ft. to ft., From ft. to ft.
 From ft. to ft., From ft. to ft.

6 GROUT MATERIAL: 1 Neat cement 2 Cement grout 3 Bentonite 4 Other
 Grout Intervals: From 0 ft. to 4 ft., From ft. to ft., From ft. to ft.
 What is the nearest source of possible contamination:
 1 Septic tank 4 Lateral lines 7 Pit privy 10 Livestock pens 14 Abandoned water well
 2 Sewer lines 5 Cess pool 8 Sewage lagoon 11 Fuel storage 15 Oil well/Gas well
 3 Watertight sewer lines 6 Seepage pit 9 Feedyard 12 Fertilizer storage 16 Other (specify below)
FORMER UST SITE
 Direction from well? How many feet?

FROM	TO	LITHOLOGIC LOG	FROM	TO	PLUGGING INTERVALS
0	24.3	DIRECT PUSA INSTALLED NO CUTTINGS			

7 CONTRACTOR'S OR LANDOWNER'S CERTIFICATION: This water well was (1) constructed, (2) reconstructed, or (3) plugged under my jurisdiction and was completed on (mo/day/year) 3-1-98 and this record is true to the best of my knowledge and belief. Kansas Water Well Contractor's License No. 696 This Water Well Record was completed on (mo/day/yr) 4-15-98 under the business name of ESCC dba PSA ENV. by (signature) [Signature]

INSTRUCTIONS: Use typewriter or ball point pen. PLEASE PRESS FIRMLY and PRINT clearly. Please fill in blanks, underline or circle the correct answers. Send top three copies to Kansas Department of Health and Environment, Bureau of Water, Topeka, Kansas 66620-0001. Telephone: 913-296-5545. Send one to WATER WELL OWNER and retain one for your records.

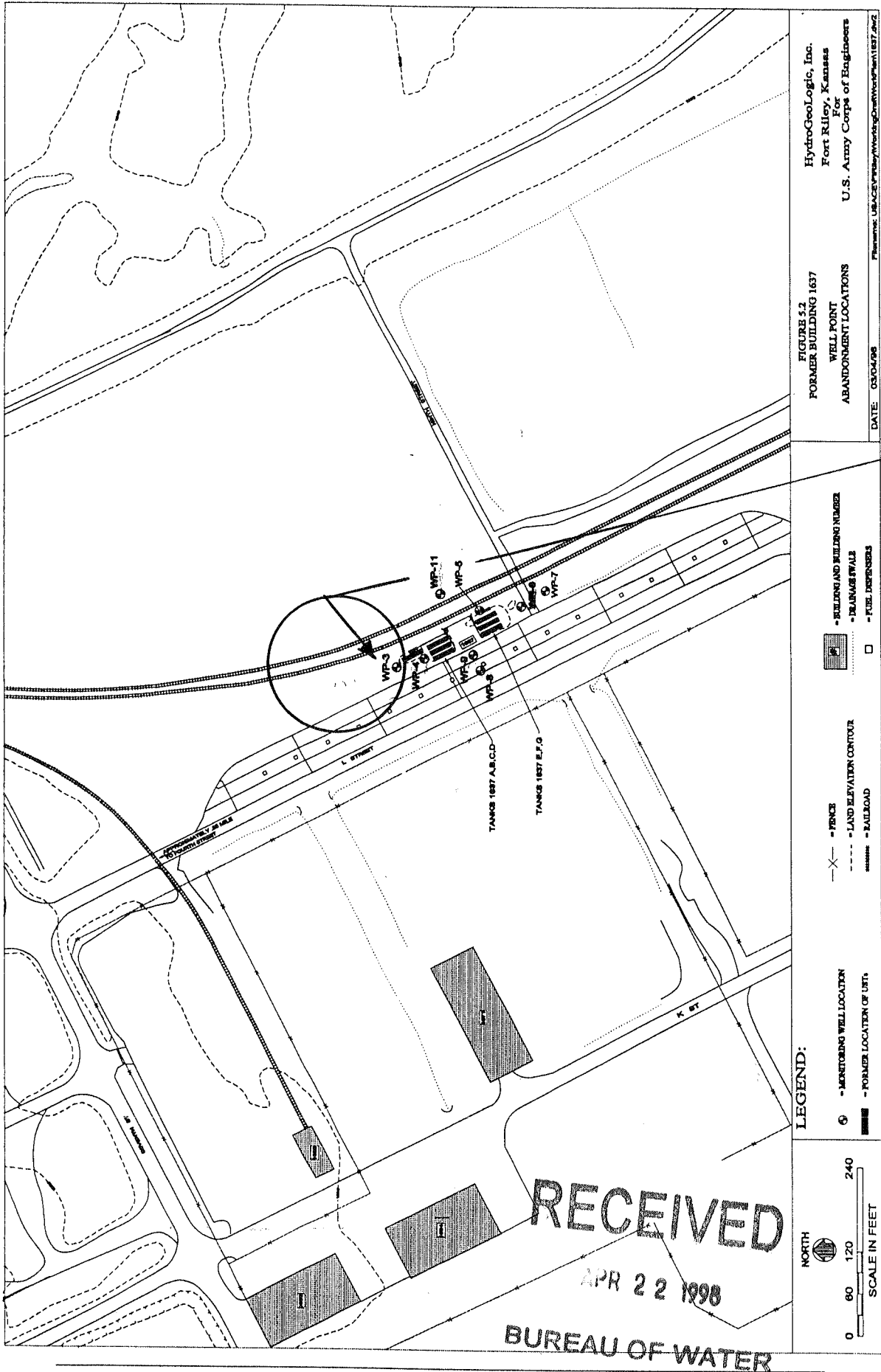

PIEZOMETER WP 3
FORMER BLDG 1637