

WATER WELL PLUGGING RECORD Form WWC-5P KSA 82a-1212 ID NO.

1 LOCATION OF WATER WELL: County: <u>Geary</u>	Fraction <u>¼ SE ¼ SE ¼ NW ¼</u>	Section Number <u>29</u>	Township Number <u>T 11 S</u>	Range Number <u>6</u> <input checked="" type="checkbox"/> E <input type="checkbox"/> W
--	-------------------------------------	-----------------------------	----------------------------------	---

Street/Rural Address of Well Location; if unknown, distance & direction from nearest town or intersection: If at owner's address, check here Main Post Building 388

Fort Riley, Kansas

Global Positioning Systems (GPS) information:
 Latitude: 39.066419 (in decimal degrees)
 Longitude: 96.772469 (in decimal degrees)
 Elevation: 1188
 Datum: WGS84, NAD83, NAD27
 Collection Method:
 GPS unit (Make/Model): _____
 Digital Map/Photo, Topographic Map, Land Survey
 Est. Accuracy: < 3 m, 3-5 m, 5-15 m, > 15 m

2 WATER WELL OWNER: Richard Shields
 Building 407, Main Post, RR#, St. Address, Box #: Fort Riley, Kansas 66442
 City, State ZIP Code:

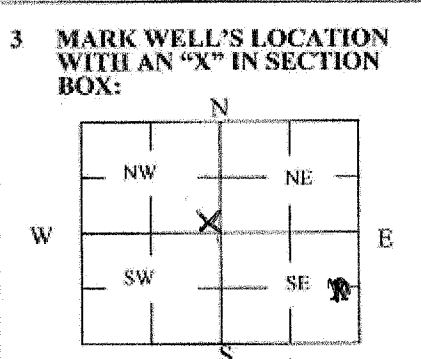

4 DEPTH OF WELL 20 ft.
 WELL'S STATIC WATER LEVEL Dry ft.
 WELL WAS USED AS:
 Domestic Public Water Supply Dewatering
 Irrigation Oil Field Water Supply Monitoring
 Feedlot Domestic (Lawn & Garden) Injection Well
 Industrial Air Conditioning Other 388 MW94-05
 Was a chemical/bacteriological sample submitted to Department? Yes No

5 TYPE OF BLANK CASING USED:

Steel RMP (SR) Wrought Fiberglass Other (Specify below) _____
 PVC ABS Asbestos-Cement Concrete Tile

Blank casing diameter 2 in. Was casing pulled? Yes No If yes, how much All
 Casing height above or below land surface 0 in.

6 GROUT PLUG MATERIAL: Neat cement Cement grout Bentonite Other Topsoil/grass seed

Grout Plug Intervals: From 2 ft. to 20 ft., From N/A ft. to N/A ft., From N/A to N/A ft.

What is the nearest source of possible contamination:
 Septic tank Seepage pit Fuel Storage Other (specify below) _____
 Sewer lines Pit privy Fertilizer storage _____
 Watertight sewer lines Sewage lagoon Insecticide storage _____
 Lateral lines Feedyard Abandoned water well Oil well/Gas well Direction from well? West
 Cess pool Livestock pens How many feet? ~240-feet

FROM	TO	PLUGGING MATERIALS	FROM	TO	PLUGGING MATERIALS
25	2	Bentonite Grout			

7 CONTRACTOR'S OR LANDOWNER'S CERTIFICATION: This water well was plugged under my jurisdiction and was completed on (mo/day/year) 4-15-2013 and this record is true to the best of my knowledge and belief. Kansas Water Well Contractor's License No. 759. This Water Well Record was completed on (mo/day/year) 6-9-2013 under the business name of RAZEK Environmental, LLC by (signature) *[Signature]*

INSTRUCTIONS: Use typewriter or ballpoint pen. Please press firmly and print clearly. Please fill in blanks, underline or circle the correct answers. Send top three copies to Kansas Department of Health and Environment, Bureau of Water, Geology Section, 1000 SW Jackson St., Ste. 420, Topeka, Kansas 66612-1367. Telephone: 785/296-5524. Send one to Water Well Owner and retain one for your records. Visit us at <http://www.kdheks.gov/waterwell/index.html>.

Check one: White Copy Blue Copy Pink Copy