

**WATER WELL RECORD**

**Form WWC-5**

Division of Water Resources App. No.

<b>1 LOCATION OF WATER WELL:</b> County: <b>Shawnee</b>	Fraction $\frac{1}{4}$ NE $\frac{1}{4}$ NE $\frac{1}{4}$ NE $\frac{1}{4}$	Section Number <b>9</b>	Township No. T <b>12</b> S	Range Number R <b>15</b> <input checked="" type="checkbox"/> E <input type="checkbox"/> W
--	--	----------------------------	-------------------------------	--

Street/Rural Address of Well Location; if unknown, distance & direction from nearest town or intersection: If at owner's address, check here .  
Former Amoco Station No. 1929  
2101 SW Fairlawn Road, Topeka, KS 66614

**Global Positioning System (GPS) information:**  
Latitude: **39.029097** (in decimal degrees)  
Longitude: **95.743883** (in decimal degrees)  
Elevation: **1003**  
Datum:  WGS 84,  NAD 83,  NAD 27  
Collection Method:  
 GPS unit (Make/Model: .....)  
 Digital Map/Photo,  Topographic Map,  Land Survey  
Est. Accuracy:  <3 m,  3-5 m,  5-15 m,  >15 m

**2 WATER WELL OWNER:** BP Products North America  
RR#, Street Address, Box #: 28100 Torch Parkwav  
City, State, ZIP Code : Warrenville, IL 60555

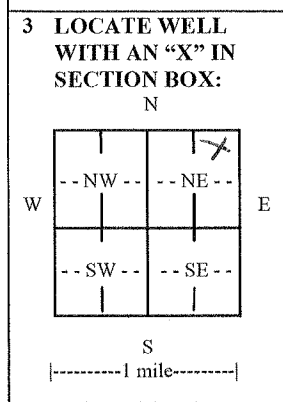

**4 DEPTH OF COMPLETED WELL** 25.5 ft.  
Depth(s) Groundwater Encountered (1) 18 ft. (2) N/A ft. (3) N/A ft.  
WELL'S STATIC WATER LEVEL 18.69 ft. below land surface measured on mo/day/yr. 8-18-2014  
Pump test data: Well water was N/A ft. after N/A hours pumping. N/A gpm  
EST. YIELD N/A gpm. Well water was N/A ft. after N/A hours pumping. N/A gpm  
Bore Hole Diameter 8.25 in. to 25.5 ft., and N/A in. to N/A ft.  
WELL WATER TO BE USED AS:  Public water supply  Geothermal  Injection well  
 Domestic  Feedlot  Oil field water supply  Dewatering  Other (Specify below)  
 Irrigation  Industrial  Domestic-lawn & garden  Monitoring well MW-6R  
Was a chemical/bacteriological sample submitted to Department?  Yes  No  
If yes, mo/day/yr sample was submitted N/A  
Water well disinfected?  Yes  No

**5 TYPE OF CASING USED:**  Steel  PVC  Other  
CASING JOINTS:  Glued  Clamped  Welded  Threaded  
Casing diameter 2 in. to 10.5 ft., Diameter N/A in. to N/A ft., Diameter N/A in. to N/A ft.  
Casing height above land surface 0 in., Weight N/A lbs./ft., Wall thickness or gauge No. Schedule 40  
TYPE OF SCREEN OR PERFORATION MATERIAL:  
 Steel  Stainless Steel  PVC  Other (Specify) .....  
 Brass  Galvanized Steel  None used (open hole)  
SCREEN OR PERFORATION OPENINGS ARE:  
 Continuous slot  Mill slot  Gauze wrapped  Torch cut  Drilled holes  None (open hole)  
 Louvered shutter  Key punched  Wire wrapped  Saw cut  Other (specify) .....  
SCREEN-PERFORATED INTERVALS: From 10.5 ft. to 25.5 ft., From N/A ft. to N/A ft.  
From N/A ft. to N/A ft., From N/A ft. to N/A ft.  
GRAVEL PACK INTERVALS: From 8.5 ft. to 25.5 ft., From N/A ft. to N/A ft.  
From N/A ft. to N/A ft., From N/A ft. to N/A ft.

**6 GROUT MATERIAL:**  Neat cement  Cement grout  Bentonite  Other Concrete 0-2-feet  
Grout Intervals: From 2 ft. to 8.5 ft., From N/A ft. to N/A ft., From N/A ft. to N/A ft.  
What is the nearest source of possible contamination:  
 Septic tank  Lateral lines  Pit privy  Livestock pens  Insecticide storage  Other (specify below)  
 Sewer lines  Cesspool  Sewage lagoon  Fuel storage  Abandoned water well  
 Watertight sewer lines  Seepage pit  Feedyard  Fertilizer storage  Oil well/gas well  
Direction from well South Distance from well <75-feet

FROM	TO	LITHOLOGIC LOG	FROM	TO	LITHO. LOG (cont.) or PLUGGING INTERVALS
0	0.5	Concrete surface / fill			
0.5	6	brn silty clay damp plastic silt			
6	10	clr red-brn sand dry very fine avg quartz			
10	12	weathered clr brn s-stone			
12	25.5	clr red-brn s-stone			

**7 CONTRACTOR'S OR LANDOWNER'S CERTIFICATION:** This water well was  constructed,  reconstructed, or  plugged under my jurisdiction and was completed on (mo/day/year) 8-18-2014 and this record is true to the best of my knowledge and belief. Kansas Water Well Contractor's License No. 759. This Water Well Record was completed on (mo/day/year) 9-29-2014 under the business name of RAZEK Environmental, LLC by (signature)

**INSTRUCTIONS:** Use typewriter or ball point pen. PLEASE PRESS FIRMLY and PRINT clearly. Please fill in blanks and check the correct answers. Send one copy to Kansas Department of Health and Environment, Bureau of Water, Geology Section, 1000 SW Jackson St., Suite 420, Topeka, Kansas 66612-1367. Telephone 785-296-5524. Send one copy to WATER WELL OWNER and retain one for your records. Include fee of \$5.00 for each constructed well. Visit us at <http://www.kdheks.gov/waterwell/index.html>