

MW-1

**WATER WELL PLUGGING RECORD Form WWC-5P KSA 82a-1212 ID NO.**

<b>1 LOCATION OF WATER WELL:</b> County: <u>Shawnee</u>	Fraction NW ¼ SE ¼ SW ¼ SW ¼	Section Number <u>10</u>	Township Number T <u>12</u> S	Range Number <u>15</u> <input checked="" type="checkbox"/> E <input type="checkbox"/> W
--	---------------------------------	-----------------------------	----------------------------------	--

Street/Rural Address of Well Location; if unknown, distance & direction from nearest town or intersection: If at owner's address, check here  2820 Fairlawn; Topeka, KS

**Global Positioning Systems (GPS) information:**  
Latitude: 39.015 631 (in decimal degrees)  
Longitude: -95.743 197 (in decimal degrees)  
Elevation: \_\_\_\_\_  
Datum:  WGS84,  NAD83,  NAD27  
Collection Method:

**2 WATER WELL OWNER:** TPI Petroleum (ELR LLC)  
RR#, St. Address, Box #: 5590 Havana St. Bldg B  
City, State ZIP Code: Denver Co 80239

GPS unit (Make/Model: etrek)  
 Digital Map/Photo,  Topographic Map,  Land Survey  
Est. Accuracy:  < 3 m,  3-5 m,  5-15 m,  > 15 m

**3 MARK WELL'S LOCATION WITH AN "X" IN SECTION BOX:**

N		
NW		NE
SW		SE
S		

W E

**X** (in SW section)

**4 DEPTH OF WELL** 15 ft.

WELL'S STATIC WATER LEVEL \_\_\_\_\_ ft

WELL WAS USED AS:

<input type="checkbox"/> Domestic	<input type="checkbox"/> Public Water Supply	<input type="checkbox"/> Dewatering
<input type="checkbox"/> Irrigation	<input type="checkbox"/> Oil Field Water Supply	<input checked="" type="checkbox"/> Monitoring
<input type="checkbox"/> Feedlot	<input type="checkbox"/> Domestic (Lawn & Garden)	<input type="checkbox"/> Injection Well
<input type="checkbox"/> Industrial	<input type="checkbox"/> Air Conditioning	<input type="checkbox"/> Other _____

Was a chemical/bacteriological sample submitted to Department? Yes  No

**5 TYPE OF BLANK CASING USED:**

<input type="checkbox"/> Steel	<input type="checkbox"/> RMP (SR)	<input type="checkbox"/> Wrought	<input type="checkbox"/> Fiberglass	<input type="checkbox"/> Other (Specify below)
<input checked="" type="checkbox"/> PVC	<input type="checkbox"/> ABS	<input type="checkbox"/> Asbestos-Cement	<input type="checkbox"/> Concrete Tile	

Blank casing diameter 2 in. Was casing pulled? Yes  No  If yes, how much all

Casing height above or below land surface -6 in.

**6 GROUT PLUG MATERIAL:**  Neat cement  Cement grout  Bentonite  Other \_\_\_\_\_

Grout Plug Intervals: From 3 ft. to 15 ft., From — ft. to — ft., From — to — ft.

What is the nearest source of possible contamination:

<input type="checkbox"/> Septic tank	<input type="checkbox"/> Seepage pit	<input checked="" type="checkbox"/> Fuel Storage	<input type="checkbox"/> Other (specify below)
<input type="checkbox"/> Sewer lines	<input type="checkbox"/> Pit privy	<input type="checkbox"/> Fertilizer storage	
<input type="checkbox"/> Watertight sewer lines	<input type="checkbox"/> Sewage lagoon	<input type="checkbox"/> Insecticide storage	
<input type="checkbox"/> Lateral lines	<input type="checkbox"/> Feedyard	<input type="checkbox"/> Abandoned water well	Direction from well? <u>South</u>
<input type="checkbox"/> Cess pool	<input type="checkbox"/> Livestock pens	<input type="checkbox"/> Oil well/Gas well	How many feet? <u>150 Feet</u>

FROM	TO	PLUGGING MATERIALS	FROM	TO	PLUGGING MATERIALS
<u>0</u>	<u>3</u>	<u>Top Soil</u>			
<u>3</u>	<u>15</u>	<u>Bentonite</u>			

**7 CONTRACTOR'S OR LANDOWNER'S CERTIFICATION:** This water well was plugged under my jurisdiction and was completed on (mo/day/year) 04062015 and this record is true to the best of my knowledge and belief. Kansas Water Well Contractor's License No. 710. This Water Well Record was completed on (mo/day/year) 04072015 under the business name of Below Ground Surface, Inc. by (signature) [Signature]

**INSTRUCTIONS:** Use typewriter or ballpoint pen. Please press firmly and print clearly. Please fill in blanks, underline or circle the correct answers. Send one copy to Kansas Department of Health and Environment, Bureau of Water, Geology Section, 1000 SW Jackson St., Ste. 420, Topeka, Kansas 66612-1367. Telephone: 785/296-5524. Send one to Water Well Owner and retain one for your records. Visit us at <http://www.kdheks.gov/waterwell/index.html>.

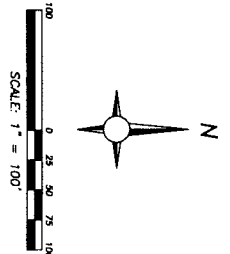
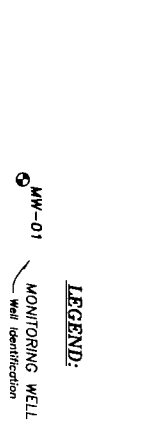
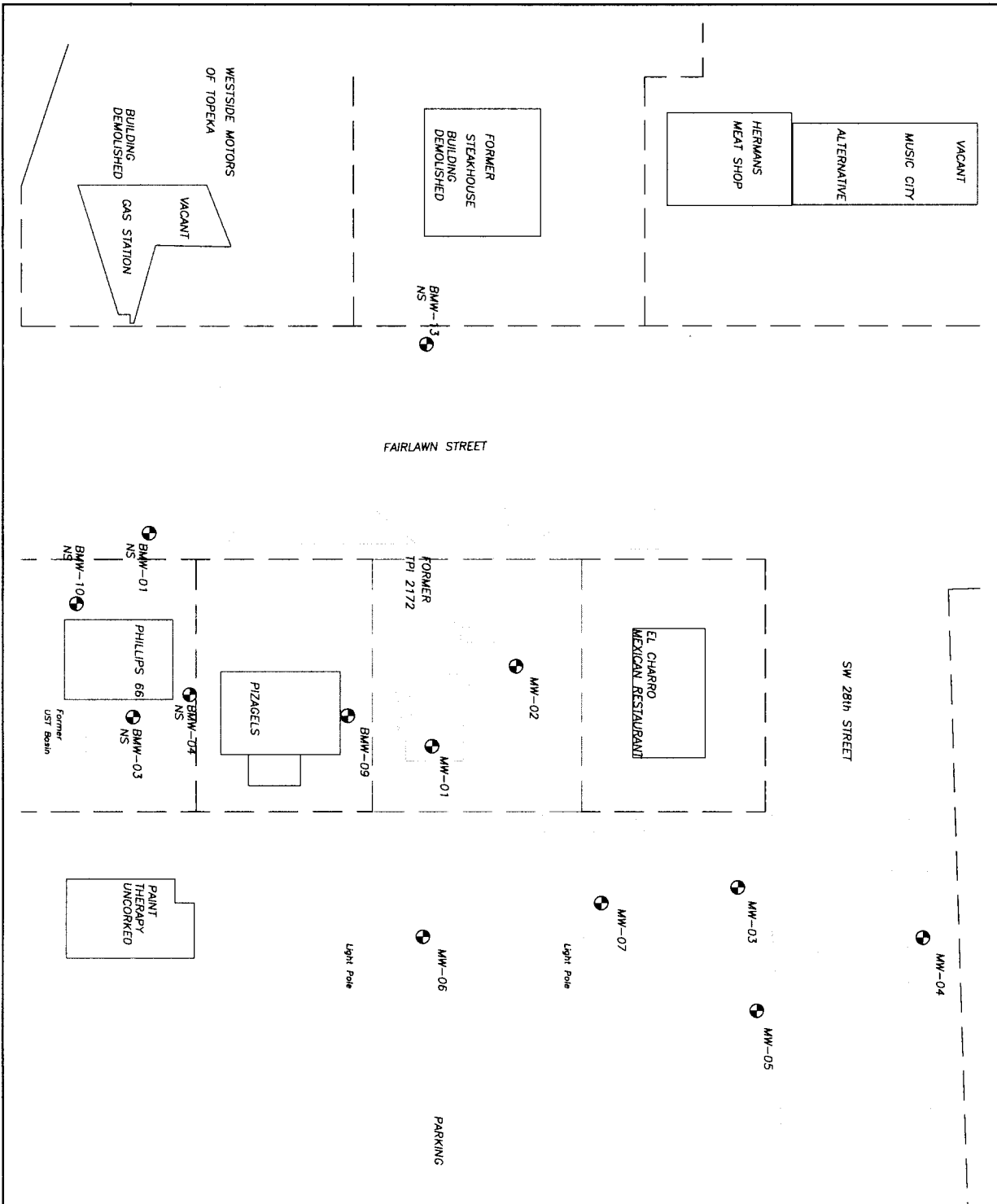

<b>1.0</b>		<b>Cardno</b> ATC Shaping the Future	
<b>SITE MAP</b>			
TOTAL #2172 TOPEKA PARKING TOPEKA, KANSAS			
PROJECT NUMBER: CS12172	DOCUMENT: WELL ABANDONMENT	DATE: 03/31/15	DRAWN BY: GREGORY W.