

**WATER WELL PLUGGING RECORD Form WWC-5P**

KSA 82a-1212 ID NO. MW-6

<b>1 LOCATION OF WATER WELL:</b> County: <u>Shawnee</u>	Fraction <u>NW 1/4 SE 1/4 SW 1/4 SW 1/4</u>	Section Number <u>10</u>	Township Number <u>T 12 S</u>	Range Number <u>15</u> <input checked="" type="checkbox"/> E <input type="checkbox"/> W
--	--	-----------------------------	----------------------------------	--

Street/Rural Address of Well Location; if unknown, distance & direction from nearest town or intersection: If at owner's address, check here  2820 Fairlawn; Topeka, KS

**Global Positioning Systems (GPS) information:**  
 Latitude: 39.015627 (in decimal degrees)  
 Longitude: -95.742832 (in decimal degrees)  
 Elevation: \_\_\_\_\_  
 Datum:  WGS84,  NAD83,  NAD27  
 Collection Method:

**2 WATER WELL OWNER:** TPI Petroleum (EIR LLC)  
 RR#, St. Address, Box #: 5590 Havana St. Bldg B  
 City, State ZIP Code: Denver CO 80239

GPS unit (Make/Model: etrek)  
 Digital Map/Photo,  Topographic Map,  Land Survey  
 Est. Accuracy:  < 3 m,  3-5 m,  5-15 m,  > 15 m

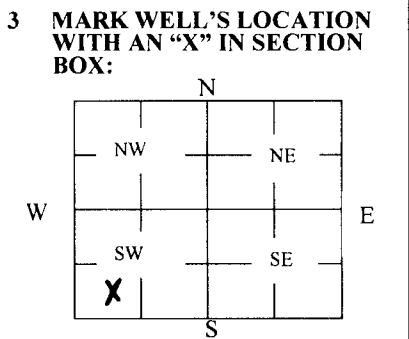

**4 DEPTH OF WELL** 15 ft.  
 WELL'S STATIC WATER LEVEL 9.25 ft.  
 WELL WAS USED AS:  
 Domestic  Public Water Supply  Dewatering  
 Irrigation  Oil Field Water Supply  Monitoring  
 Feedlot  Domestic (Lawn & Garden)  Injection Well  
 Industrial  Air Conditioning  Other \_\_\_\_\_  
 Was a chemical/bacteriological sample submitted to Department? Yes  No

**5 TYPE OF BLANK CASING USED:**

Steel  RMP (SR)  Wrought  Fiberglass  Other (Specify below)  
 PVC  ABS  Asbestos-Cement  Concrete Tile

Blank casing diameter 2 in. Was casing pulled? Yes  No  If yes, how much all  
 Casing height above or below land surface -6 in.

**6 GROUT PLUG MATERIAL:**  Neat cement  Cement grout  Bentonite  Other \_\_\_\_\_

Grout Plug Intervals: From 3 ft. to 15 ft., From — ft. to — ft., From — to — ft.

What is the nearest source of possible contamination:  
 Septic tank  Seepage pit  Fuel Storage  Other (specify below)  
 Sewer lines  Pit privy  Fertilizer storage  
 Watertight sewer lines  Sewage lagoon  Insecticide storage  
 Lateral lines  Feedyard  Abandoned water well  Direction from well? South  
 Cess pool  Livestock pens  Oil well/Gas well  How many feet? 150

FROM	TO	PLUGGING MATERIALS	FROM	TO	PLUGGING MATERIALS
<u>0</u>	<u>3</u>	<u>Concrete</u>			
<u>3</u>	<u>15</u>	<u>Bentonite</u>			

**7 CONTRACTOR'S OR LANDOWNER'S CERTIFICATION:** This water well was plugged under my jurisdiction and was completed on (mo/day/year) 04062015 and this record is true to the best of my knowledge and belief. Kansas Water Well Contractor's License No. 710. This Water Well Record was completed on (mo/day/year) 04072015 under the business name of Below Ground Surface, Inc. by (signature) [Signature]

**INSTRUCTIONS:** Use typewriter or ballpoint pen. Please press firmly and print clearly. Please fill in blanks, underline or circle the correct answers. Send one copy to Kansas Department of Health and Environment, Bureau of Water, Geology Section, 1000 SW Jackson St., Ste. 420, Topeka, Kansas 66612-1367. Telephone: 785/296-5524. Send one to Water Well Owner and retain one for your records. Visit us at <http://www.kdheks.gov/waterwell/index.html>.

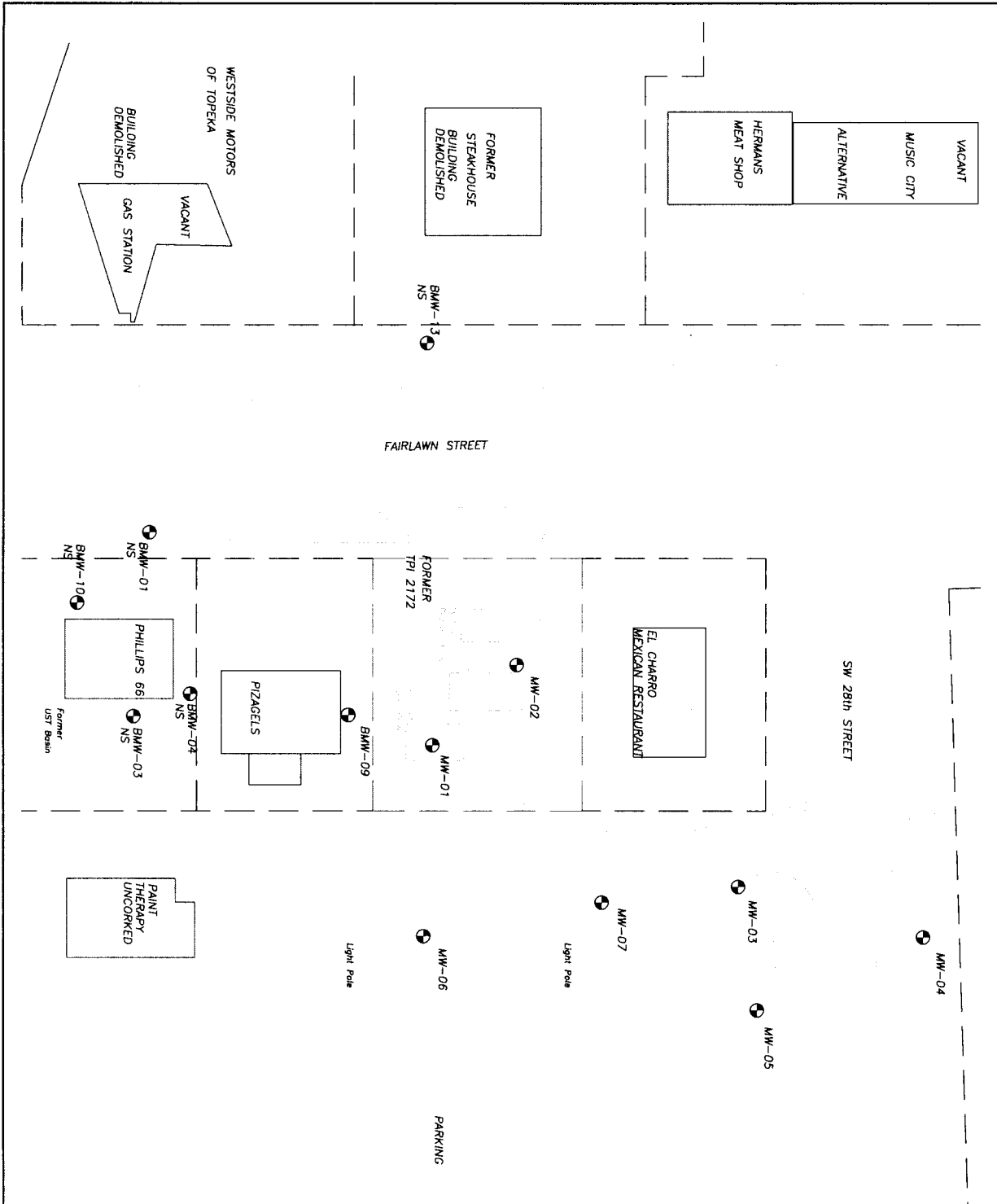

**LEGEND:**  
 MW-01 MONITORING WELL  
 Well Identification

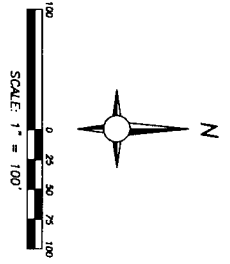

<h1>1.0</h1>		<p><b>Cardno</b> ATC Shaping the Future</p>	
<b>SITE MAP</b>			
TOTAL #2172 TPI 2172 TOPEKA, KANSAS			
PROJECT NUMBER:	DOCUMENT:	DRAWN BY:	CHECKED BY:
CS12172	WELL ABANDONMENT	TMF 03/31/15	03/25/15