

**WATER WELL PLUGGING RECORD Form WWC-5P**

KSA 82a-1212

ID NO.  

1 LOCATION OF WATER WELL: County: Shawnee Fraction: 1/4 SE 1/4 SE 1/4 SE 1/4 Section Number: 5 Township Number: T 12 S Range Number: 16  E  W

Street/Rural Address of Well Location; if unknown, distance & direction from nearest town or intersection: If at owner's address, check here  SE 21<sup>st</sup> St. and SE California Ave. Topeka KS

Global Positioning Systems (GPS) information:  
 Latitude: 39.02997 (in decimal degrees)  
 Longitude: 95.65167 (in decimal degrees)  
 Elevation: \_\_\_\_\_  
 Horizontal Datum:  WGS84,  NAD83,  NAD27  
 Collection Method:  GPS unit (Make/Model: Garmin etrek)  
 Digital Map/Photo,  Topographic Map,  Land Survey  
 Est. Accuracy:  < 3 m,  3-5 m,  5-15 m,  > 15 m

2 WATER WELL OWNER: Chevron Env. Mgt. Co.  
 RR#, St. Address, Box #: 4800 Fournance Road  
 City, State ZIP Code: Bellaire TX 77401

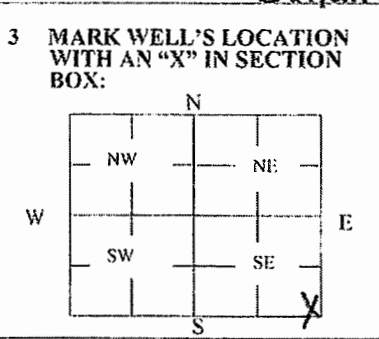

4 DEPTH OF WELL 19.5 ft.

WELL'S STATIC WATER LEVEL \_\_\_\_\_ ft MW-6

WELL WAS USED AS:

Domestic  Public Water Supply  Dewatering  
 Irrigation  Oil Field Water Supply  Monitoring  
 Feedlot  Domestic (Lawn & Garden)  Injection Well  
 Industrial  Air Conditioning  Other \_\_\_\_\_

Was a chemical/bacteriological sample submitted to Department? Yes  No

5 TYPE OF BLANK CASING USED:

Steel  RMP (SR)  Wrought  Fiberglass  Other (Specify below)  
 PVC  ABS  Asbestos-Cement  Concrete Tile

Blank casing diameter 2 in. Was casing pulled? Yes  No  If yes, how much all  
 Casing height above or below land surface -6 in.

6 GROUT PLUG MATERIAL:  Neat cement  Cement grout  Bentonite  Other Top Soil / Concrete

Grout Plug Intervals: From 0 ft. to 3 ft., From 3 ft. to 19.5 ft., From \_\_\_\_\_ ft. to \_\_\_\_\_ ft.

What is the nearest source of possible contamination:

Septic tank  Sepage pit  Fuel storage  Other (specify below) Tire Shop  
 Sewer lines  Pit privy  Fertilizer storage  
 Watertight sewer lines  Sewage lagoon  Insecticide storage  
 Lateral lines  Feedyard  Abandoned water well Direction from well? E  
 Cess pool  Livestock pens  Oil well/Gas well How many feet? ≈ 200 ft.

FROM	TO	PLUGGING MATERIALS	FROM	TO	PLUGGING MATERIALS
0	3	Concrete			
3	19.5	Bentonite			

7 CONTRACTOR'S OR LANDOWNER'S CERTIFICATION: This water well was plugged under my jurisdiction and was completed on (mo/day/year) 5/5/17 and this record is true to the best of my knowledge and belief. Kansas Water Well Contractor's License No. 710. This Water Well Record was completed on (mo/day/year) 5/8/17 under the business name of Below Ground Surface, Inc. by (signature) Craig R. Hewitt

Send one white copy to Kansas Department of Health & Environment, Geology Section, 1000 SW Jackson Street, Ste. 420, Topeka, KS 66612-1367. Send one copy to WATER WELL OWNER and retain one for your records.  
 Visit us at <http://www.kdhcks.gov/waterwell/index.html> Telephone 785-296-5524.