

WATER WELL PLUGGING RECORD Form WWC-5P

KSA 82a-1212

ID NO.

1 LOCATION OF WATER WELL: Fraction $\frac{1}{4}$ SE $\frac{1}{4}$ SE $\frac{1}{4}$ SE $\frac{1}{4}$ Section Number 5 Township Number T 12 S Range Number 16 E W

County: Shawnee
 Street/Rural Address of Well Location; if unknown, distance & direction from nearest town or intersection: If at owner's address, check here SE 21st St. and SE California Ave. Topeka KS

Global Positioning Systems (GPS) information:
 Latitude: 39.03000 (in decimal degrees)
 Longitude: 95.65180 (in decimal degrees)
 Elevation: _____
 Horizontal Datum: WGS84, NAD83, NAD27
 Collection Method:

2 WATER WELL OWNER: Chevron Env. Mgt. Co.
 RR#, St. Address, Box #: 4800 Fournance Road
 City, State ZIP Code: Bellaire TX 77401

GPS unit (Make/Model: Garmin etrek)
 Digital Map/Photo, Topographic Map, Land Survey
 Est. Accuracy: < 3 m, 3-5 m, 5-15 m, > 15 m

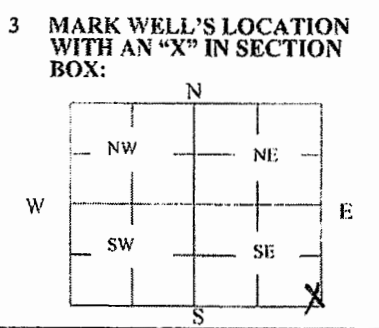

4 DEPTH OF WELL 19 ft.
 WELL'S STATIC WATER LEVEL _____ ft MW-7
 WELL WAS USED AS:
 Domestic Public Water Supply Dewatering
 Irrigation Oil Field Water Supply Monitoring
 Feedlot Domestic (Lawn & Garden) Injection Well
 Industrial Air Conditioning
 Was a chemical/bacteriological sample submitted to Department? Yes No

5 TYPE OF BLANK CASING USED:
 Steel RMP (SR) Wrought Fiberglass Other (Specify below)
 PVC ABS Asbestos-Cement Concrete Tile
 Blank casing diameter 2 in. Was casing pulled? Yes No If yes, how much all
 Casing height above or below land surface -6 in.

6 GROUT PLUG MATERIAL: Neat cement Cement grout Bentonite Other Top Soil / ~~Cement~~
 Grout Plug Intervals: From 0 ft. to 3 ft., From 3 ft. to 19 ft., From _____ ft. to _____ ft.

What is the nearest source of possible contamination:
 Septic tank Seepage pit Fuel storage Other (specify below) Tire Shop
 Sewer lines Pit privy Fertilizer storage
 Watertight sewer lines Sewage lagoon Insecticide storage
 Lateral lines Feedyard Abandoned water well
 Cess pool Livestock pens Oil well/Gas well
 Direction from well? E
 How many feet? ≈ 200 ft.

FROM	TO	PLUGGING MATERIALS	FROM	TO	PLUGGING MATERIALS
0	3	Top Soil			
3	19	Bentonite			

7 CONTRACTOR'S OR LANDOWNER'S CERTIFICATION: This water well was plugged under my jurisdiction and was completed on (mo/day/year) 5/5/17 and this record is true to the best of my knowledge and belief. Kansas Water Well Contractor's License No. 710. This Water Well Record was completed on (mo/day/year) 5/8/17 under the business name of Below Ground Surface, Inc. by (signature) Craig R. Hewitt

Send one white copy to Kansas Department of Health & Environment, Geology Section, 1000 SW Jackson Street, Ste. 420, Topeka, KS 66612-1367. Send one copy to WATER WELL OWNER and retain one for your records.
 Visit us at <http://www.kdheks.gov/waterwell/index.html> Telephone 785-296-5524.