

# WATER WELL PLUGGING RECORD Form WWC-5P

KSA 82a-1212

ID NO.

MW9

<b>1 LOCATION OF WATER WELL:</b> County: <b>SHAWNEE</b>	Fraction <b>NW 1/4 NW 1/4 NE 1/4 NE 1/4</b>	Section Number <b>17</b>	Township Number <b>T 12 S</b>	Range Number <b>16</b> <input checked="" type="checkbox"/> E <input type="checkbox"/> W
Street/Rural Address of Well Location; if unknown, distance & direction from nearest town or intersection: If at owner's address, check here <input checked="" type="checkbox"/>		<b>Global Positioning Systems (GPS) information:</b> Latitude: <b>39.01475</b> (in decimal degrees) Longitude: <b>95.65622</b> (in decimal degrees) Elevation: <b>1029.51</b> Horizontal Datum: <input checked="" type="checkbox"/> WGS84, <input type="checkbox"/> NAD83, <input type="checkbox"/> NAD27 Collection Method:		

<b>2 WATER WELL OWNER:</b> <b>ARSHED QURESHI</b> RR#, St. Address, Box #: <b>1611 SE 29TH ST.</b> City, State ZIP Code: <b>TOPEKA, KS 66602</b>	<input type="checkbox"/> GPS unit (Make/Model: _____) <input type="checkbox"/> Digital Map/Photo, <input type="checkbox"/> Topographic Map, <input checked="" type="checkbox"/> Land Survey Est. Accuracy: <input type="checkbox"/> < 3 m, <input type="checkbox"/> 3-5 m, <input type="checkbox"/> 5-15 m, <input type="checkbox"/> > 15 m
---	---

<b>3 MARK WELL'S LOCATION WITH AN "X" IN SECTION BOX:</b> 	<b>4 DEPTH OF WELL</b> <u>22.42</u> <b>ft.</b> WELL'S STATIC WATER LEVEL <u>16.60</u> <b>ft</b> WELL WAS USED AS: <table border="0"> <tr> <td><input type="checkbox"/> Domestic</td> <td><input type="checkbox"/> Public Water Supply</td> <td><input type="checkbox"/> Dewatering</td> </tr> <tr> <td><input type="checkbox"/> Irrigation</td> <td><input type="checkbox"/> Oil Field Water Supply</td> <td><input checked="" type="checkbox"/> Monitoring</td> </tr> <tr> <td><input type="checkbox"/> Feedlot</td> <td><input type="checkbox"/> Domestic (Lawn &amp; Garden)</td> <td><input type="checkbox"/> Injection Well</td> </tr> <tr> <td><input type="checkbox"/> Industrial</td> <td><input type="checkbox"/> Air Conditioning</td> <td><input type="checkbox"/> Other _____</td> </tr> </table> Was a chemical/bacteriological sample submitted to Department? Yes <input type="checkbox"/> No <input checked="" type="checkbox"/>	<input type="checkbox"/> Domestic	<input type="checkbox"/> Public Water Supply	<input type="checkbox"/> Dewatering	<input type="checkbox"/> Irrigation	<input type="checkbox"/> Oil Field Water Supply	<input checked="" type="checkbox"/> Monitoring	<input type="checkbox"/> Feedlot	<input type="checkbox"/> Domestic (Lawn & Garden)	<input type="checkbox"/> Injection Well	<input type="checkbox"/> Industrial	<input type="checkbox"/> Air Conditioning	<input type="checkbox"/> Other _____
<input type="checkbox"/> Domestic	<input type="checkbox"/> Public Water Supply	<input type="checkbox"/> Dewatering											
<input type="checkbox"/> Irrigation	<input type="checkbox"/> Oil Field Water Supply	<input checked="" type="checkbox"/> Monitoring											
<input type="checkbox"/> Feedlot	<input type="checkbox"/> Domestic (Lawn & Garden)	<input type="checkbox"/> Injection Well											
<input type="checkbox"/> Industrial	<input type="checkbox"/> Air Conditioning	<input type="checkbox"/> Other _____											

**5 TYPE OF BLANK CASING USED:**

<input type="checkbox"/> Steel	<input type="checkbox"/> RMP (SR)	<input type="checkbox"/> Wrought	<input type="checkbox"/> Fiberglass	<input type="checkbox"/> Other (Specify below) _____
<input checked="" type="checkbox"/> PVC	<input type="checkbox"/> ABS	<input type="checkbox"/> Asbestos-Cement	<input type="checkbox"/> Concrete Tile	

Blank casing diameter 2 in. Was casing pulled? Yes ☒ No ☐ If yes, how much 3'  
 Casing height above or below land surface \_\_\_\_\_ in.

**6 GROUT PLUG MATERIAL:** ☐ Neat cement ☐ Cement grout ☒ Bentonite ☐ Other \_\_\_\_\_

Grout Plug Intervals: From 1.5 ft. to 22.42 ft., From \_\_\_\_\_ ft. to \_\_\_\_\_ ft., From \_\_\_\_\_ ft. to \_\_\_\_\_ ft.

What is the nearest source of possible contamination:

<input type="checkbox"/> Septic tank	<input type="checkbox"/> Seepage pit	<input checked="" type="checkbox"/> Fuel storage	<input type="checkbox"/> Other (specify below) _____
<input type="checkbox"/> Sewer lines	<input type="checkbox"/> Pit privy	<input type="checkbox"/> Fertilizer storage	
<input type="checkbox"/> Watertight sewer lines	<input type="checkbox"/> Sewage lagoon	<input type="checkbox"/> Insecticide storage	
<input type="checkbox"/> Lateral lines	<input type="checkbox"/> Feedyard	<input type="checkbox"/> Abandoned water well	Direction from well? _____
<input type="checkbox"/> Cess pool	<input type="checkbox"/> Livestock pens	<input type="checkbox"/> Oil well/Gas well	How many feet? _____

FROM	TO	PLUGGING MATERIALS	FROM	TO	PLUGGING MATERIALS
0	1.5	ASPHALT			
1.5	22.42	BENTONITE			

**7 CONTRACTOR'S OR LANDOWNER'S CERTIFICATION:** This water well was plugged under my jurisdiction and was completed on (mo/day/year) 1/7/20 and this record is true to the best of my knowledge and belief. Kansas Water Well Contractor's License No. 585. This Water Well Record was completed on (mo/day/year) 1/24/20 under the business name of ASSOCIATED ENVIRONMENTAL INC by (signature) [Signature]

Send one white copy to Kansas Department of Health & Environment, Geology Section, 1000 SW Jackson Street, Ste. 420, Topeka, KS 66612-1367. Send one copy to WATER WELL OWNER and retain one for your records.

Visit us at <http://www.kdheks.gov/waterwell/index.html> Telephone 785-296-5524.



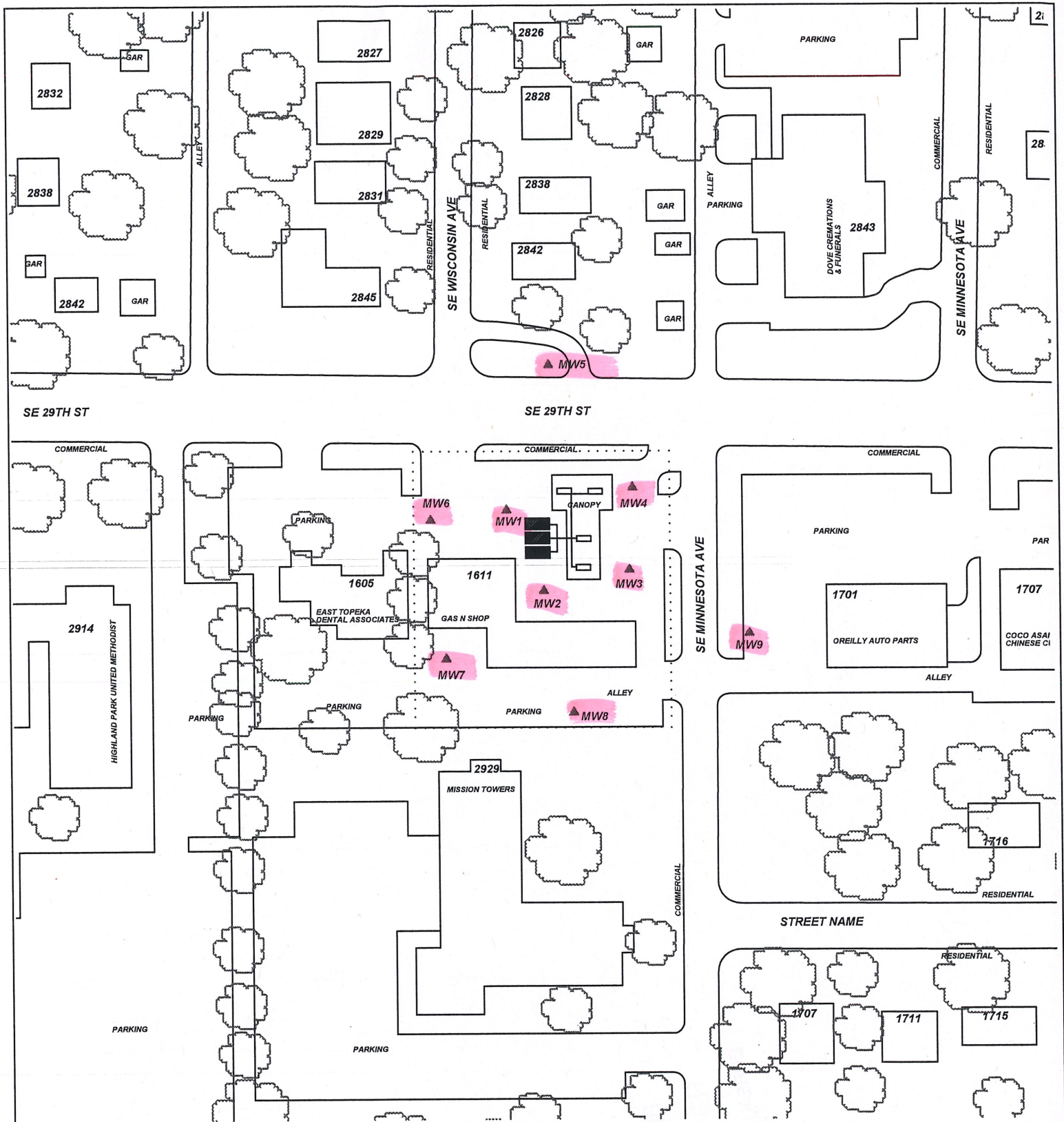

KSA82a-1212

Revised 1/20/2015



PROJECT: <b>AJJC LLC</b>	
ADDRESS: <b>1611 SE 29TH ST.</b>	
LOCATION: <b>TOPEKA, KS</b>	
DRAWN BY: <b>B. STALNAKER</b>	DATE: <b>3/23/18</b>
REVISED BY: <b>B. STALNAKER</b>	DATE: <b>1/24/20</b>
AEI JOB #: <b>TF509</b>	KDHE JOB #: <b>U4-089-15030</b>

TITLE:
 <b>ASSOCIATED ENVIRONMENTAL INC.</b>

<b>LEGEND:</b>  = SUBJECT PROPERTY  = MONITORING WELL   = SUBJECT PROPERTY	
---	---

SCALE: 1" = 100'  0 50 100
---

NOTES:  
No basements observed within 500'.