

WATER WELL PLUGGING RECORD Form WWC-5P

KSA 82a-1212

ID NO.

MW6

1 LOCATION OF WATER WELL: County: SHAWNEE	Fraction NE ¼ NE ¼ NW ¼ NE ¼	Section Number 17	Township Number T 12 S	Range Number 16 <input checked="" type="checkbox"/> E <input type="checkbox"/> W
Street/Rural Address of Well Location; if unknown, distance & direction from nearest town or intersection: If at owner's address, check here <input checked="" type="checkbox"/>		Global Positioning Systems (GPS) information: Latitude: 39.01496 (in decimal degrees) Longitude: 95.65704 (in decimal degrees) Elevation: 1031.51 Horizontal Datum: <input checked="" type="checkbox"/> WGS84, <input type="checkbox"/> NAD83, <input type="checkbox"/> NAD27 Collection Method:		

2 WATER WELL OWNER: ARSHED QURESHI
 RR#, St. Address, Box #: 1611 SE 29TH ST.
 City, State ZIP Code: TOPEKA, KS 66602

☐ GPS unit (Make/Model: _____)
☐ Digital Map/Photo, ☐ Topographic Map, ☒ Land Survey
 Est. Accuracy: ☐ < 3 m, ☐ 3-5 m, ☐ 5-15 m, ☐ > 15 m

3 MARK WELL'S LOCATION WITH AN "X" IN SECTION BOX:

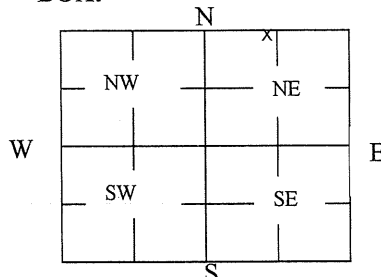

4 DEPTH OF WELL 23.83 ft.

WELL'S STATIC WATER LEVEL 17.52 ft

WELL WAS USED AS:

☐ Domestic
☐ Irrigation
☐ Feedlot
☐ Industrial

☐ Public Water Supply
☐ Oil Field Water Supply
☐ Domestic (Lawn & Garden)
☐ Air Conditioning

☐ Dewatering
☒ Monitoring
☐ Injection Well
☐ Other _____

Was a chemical/bacteriological sample submitted to Department? Yes ☐ No ☒

5 TYPE OF BLANK CASING USED:

☐ Steel ☐ RMP (SR) ☐ Wrought ☐ Fiberglass ☐ Other (Specify below)
☒ PVC ☐ ABS ☐ Asbestos-Cement ☐ Concrete Tile

Blank casing diameter 2 in. Was casing pulled? Yes ☒ No ☐ If yes, how much 3'
 Casing height above or below land surface in.

6 GROUT PLUG MATERIAL: ☐ Neat cement ☐ Cement grout ☒ Bentonite ☐ Other _____

Grout Plug Intervals: From 1.5 ft. to 23.83 ft., From _____ ft. to _____ ft., From _____ ft. to _____ ft.

What is the nearest source of possible contamination:

☐ Septic tank ☐ Seepage pit ☒ Fuel storage ☐ Other (specify below)
☐ Sewer lines ☐ Pit privy ☐ Fertilizer storage
☐ Watertight sewer lines ☐ Sewage lagoon ☐ Insecticide storage
☐ Lateral lines ☐ Feedyard ☐ Abandoned water well Direction from well? _____
☐ Cess pool ☐ Livestock pens ☐ Oil well/Gas well How many feet? _____

FROM	TO	PLUGGING MATERIALS	FROM	TO	PLUGGING MATERIALS
0	1.5	CONCRETE			
1.5	23.83	BENTONITE			

7 CONTRACTOR'S OR LANDOWNER'S CERTIFICATION: This water well was plugged under my jurisdiction and was completed on (mo/day/year) 1/7/20 and this record is true to the best of my knowledge and belief. Kansas Water Well Contractor's License No. 585. This Water Well Record was completed on (mo/day/year) 1/24/20 under the business name of ASSOCIATED ENVIRONMENTAL INC by (signature) _____

Send one white copy to Kansas Department of Health & Environment, Geology Section, 1000 SW Jackson Street, Ste. 420, Topeka, KS 66612-1367. Send one copy to WATER WELL OWNER and retain one for your records.
 Visit us at <http://www.kdheks.gov/waterwell/index.html> Telephone 785-296-5524.

KSA82a-1212

Revised 1/20/2015

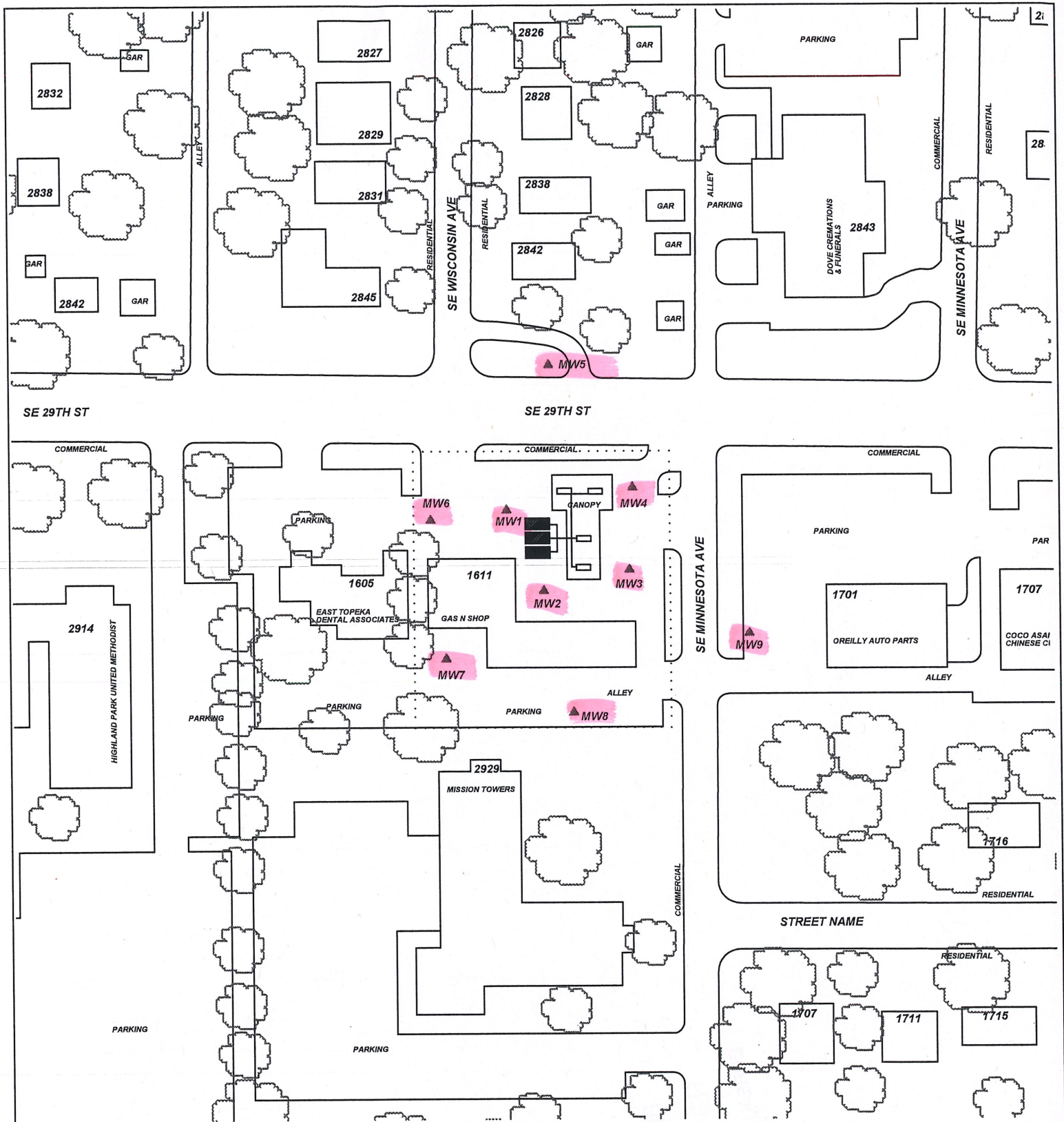

PROJECT: **AJJC LLC**

ADDRESS: **1611 SE 29TH ST.**

LOCATION: **TOPEKA, KS**

DRAWN BY: **B. STALNAKER** DATE: **3/23/18**

REVISED BY: **B. STALNAKER** DATE: **1/24/20**

AEI JOB #: **TF509** KDHE JOB #: **U4-089-15030**

TITLE:

ASSOCIATED ENVIRONMENTAL INC.

SCALE: 1" = 100'

0 50 100

NOTES:
No basements observed within 500'.

LEGEND:

= SUBJECT PROPERTY

= MONITORING WELL

= SUBJECT PROPERTY