

WATER WELL RECORD

Form WWC-5

Division of Water Resources App. No.

Well ID

MW15

Original Record Correction Change in Well Use

1 LOCATION OF WATER WELL: County Shawnee Fraction SE 1/4 SW 1/4 SW 1/4 SE 1/4 Section Number 7 Township Number T 12 S Range Number R 16 E

2 WELL OWNER: Last Name: First: Street or Rural Address where well is located (if unknown, distance and direction from nearest town or intersection): If at owner's address, check here: 400 SE 29th St, Topeka, KS 66605

3 LOCATE WELL WITH "X" IN SECTION BOX: 4 DEPTH OF COMPLETED WELL: 15 ft Depth(s) Groundwater Encountered: 1) ft 2) ft 3) ft, or 4) Dry Well WELL'S STATIC WATER LEVEL: 6.95 ft. X below land surface, measured on (mo-day-yr) 1/30/20

7 WELL WATER TO BE USED AS: 1 Domestic: 5 Public Water Supply: well ID 10 Oil Field Water Supply: lease 6 Household 6 Dewatering: how many wells? 11 Test Hole: well ID 7 Lawn & Garden 7 Aquifer Recharge: well ID 8 X Monitoring: well ID MW15 9 Environmental Remediation: well ID 12 Geothermal: How many bores? 9 Feedlot 9 Air Sparge 9 Soil Vapor Extractor 9 Industrial 9 Recovery 9 Injection

Was a chemical/bacteriological sample submitted to KDHE? Yes No X No If yes, date sample was submitted:

8 TYPE OF CASING USED: Steel X PVC Other CASING JOINTS: Glued Clamped Welded X Threaded Casing diameter 2 in. to 5 ft, Diameter in. to ft, Diameter in. to ft, Casing height above land surface -0.36 in. Weight lbs./ft. Well thickness or gauge No TYPE OF SCREEN OR PERFORATION MATERIAL: Steel Stainless Steel Fiberglass X PVC Other (Specify) Brass Galvanized Steel Concrete tile None used (open hole) SCREEN OR PERFORATION OPENINGS ARE: Continuous Slot X Mill Slot Gauze Wrapped Torch Cut Drilled Holes Other (Specify) Louvered Shutter Key Punched Wire Wrapped Saw Cut None (Open Hole) SCREEN-PERFORATED INTERVALS: From 5 ft. to 15 ft, From ft. to ft, From ft. to ft, From ft. to ft, GRAVEL PACK INTERVALS: From 3 ft. to 15 ft, From ft. to ft, From ft. to ft, From ft. to ft,

9 GROUT MATERIAL: Neat cement Cement grout X Bentonite X Other Concrete: 0-0.5' Grout intervals: From 0.5 ft. to 3 ft, From ft. to ft, From ft. to ft,

Nearest source of possible contamination: Septic Tank Lateral Lines Pit Privy Livestock Pens Insecticide Storage Sewer Lines Cess Pool Sewage Lagoon X Fuel Storage Abandoned Water Well Watertight Sewer Lines Seepage Pit Feedyard Fertilizer Storage Oil Well / Gas Well Other (Specify) Direction from well? SW Distance from well? ~370 ft

Table with 6 columns: FROM, TO, LITHOLOGIC LOG, FROM, TO, LITHO. LOG (cont.) or PLUGGING INTERVALS. Rows include lithology from 0 to 15 ft depth.

11 CONTRACTOR'S OR LANDOWNER'S CERTIFICATION: This water well was X constructed, reconstructed, or plugged under my jurisdiction and was completed on (mo-day-year) 1/28/20 and this record is true to the best of my knowledge and belief. Kansas Water Well Contractor's License No 757 This Water Well Record was completed on (mo-day-year) 2/11/20 under the business name of Larsen & Associates, Inc. Signature

*Drawings*

*7-12-16E*

# DENNIS L HANDKE

1820 NW 59th Terrace  
TOPEKA, KANSAS 66618  
785-286-4047 Home  
785-286-1990 Fax

Jessica Chapman  
Larsen & Associates  
1311 E. 25<sup>th</sup> Street, Suite B  
Lawrence, Kansas, 66046

February 8, 2020

RE: Monitor Well Elevation Survey  
311 SE 29<sup>th</sup> St., Topeka, Kansas

Proj. 20-00G  
Former Sinclair  
U4-089-15033

Bench Mark: Chisled Sq. on SE corner of concrete signal light base at Northwest corner of property.  
Elev: 941.80      North 5214      West 1263      (from SE Cor. Sec. 18-12-16E)

MW-14	rim	957.72	North	5530	SE1/4,SW1/4,SW1/4,SE1/4 (Sec. 7-12-16E)
	top pipe	957.42	West	971	Lat= 39.01592 Long = 95.67364
MW-15	rim	954.99	North	5385	SE1/4,SW1/4,SW1/4,SE1/4 (Sec. 7-12-16E)
	top pipe	954.63	West	964	Lat= 39.01552 Long = 95.67363

Lat & Long derived from Topeka 7.5' quad map. WGS 84.

Elevation established from existing project.

If you have any questions, please feel free to call me. Thank you for the opportunity to be of service to you.

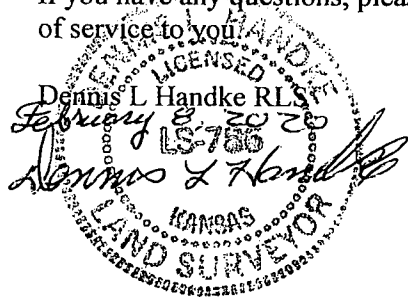

NOTE: Figures exhibited within this report are only to be used within the context of this report. Placement of property lines, wells, structures, and roads is based on the available information from county appraiser maps, surveys, site visits, and/or previous vendor reports and should be considered approximate.

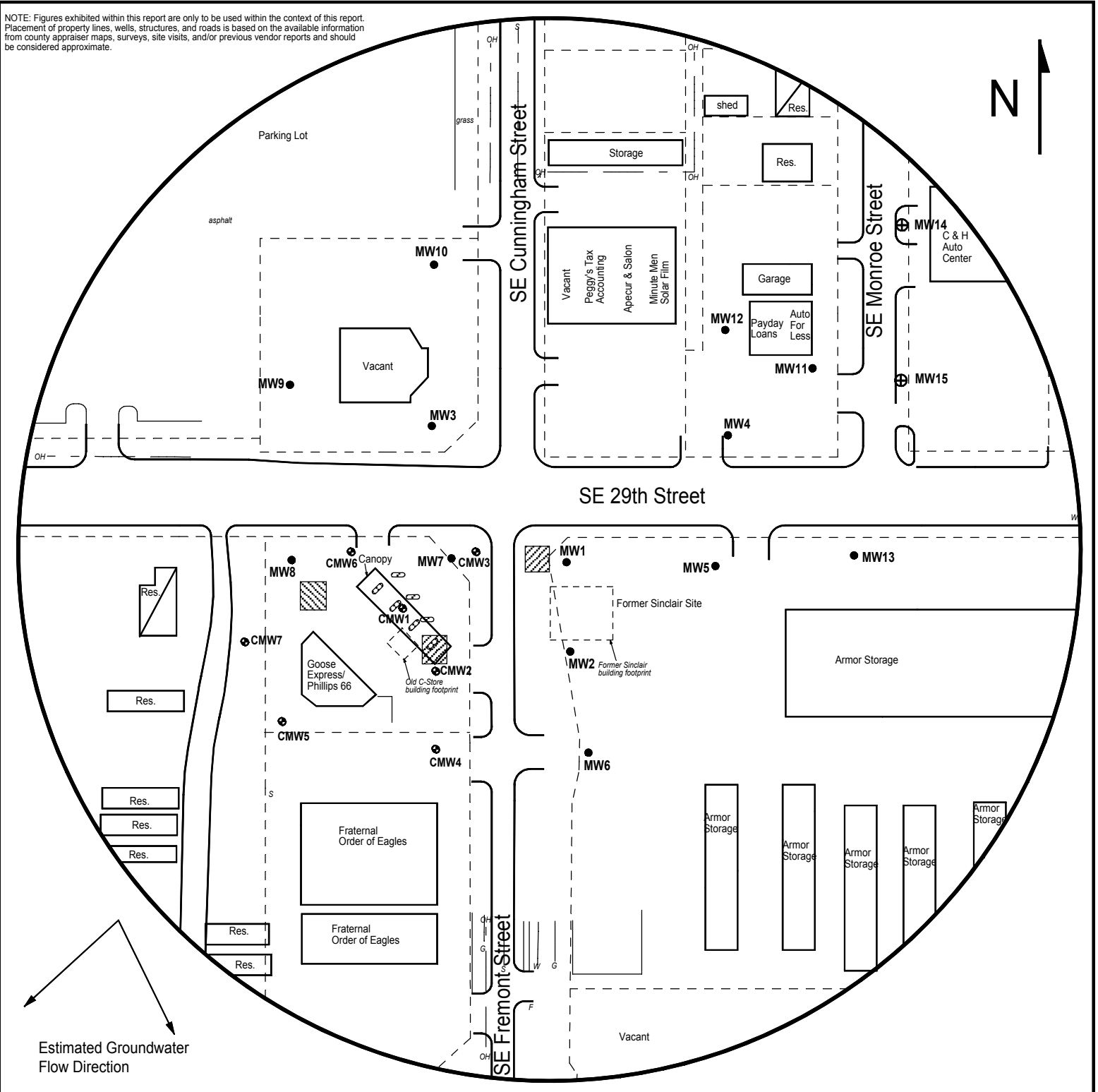

FIGURE 2.2 - 500 FT RADIUS AREA BASE MAP

**LEGEND:**

- Approximate Location of Former UST Basin and Pump Islands
- Approximate Location of Active UST Basin and Pump Islands
- Approximate Location of Property Line
- Building with Basement
- Existing Monitoring Well
- Plugged Monitoring Well Nearby Site Clark #1345 (U4-089-1605)
- Proposed Monitoring Well
- Fire Hydrant
- Electric Lines (2 - 6 ft BGS)
- Gas Lines (2 - 6 ft BGS)
- Overhead Lines (25-40 ft high)
- Sewer Lines (2 - 6 ft BGS)

NOTE: Utility depths, heights and locations are approximate.



**PROJECT:**

Former Sinclair  
 311 SE 29th Street  
 Topeka, KS  
 KDHE ID: U4-089-15033  
 Date: 10/26/18



1311 E 25th St., Suite B (785) 841-8707 office  
 Lawrence, KS 66046 (785) 865-4282 fax