

Shawnee

31-11-16E



	FIGURE: 3.0	FIGURE NAME: Aerial Photo	Montgomery Ward & Co., Inc. 320 Kansas Avenue Topeka, Kansas KDEE #U4-089-00772	 SCALE: 1" = 110'
	DATE: 01/07/2022	PROJECT NUMBER: 2174145		
	DRAWN BY: HS	PROJECT MANAGER: RE		

Legend

	= Proposed Well		= Former Pump Island
	= Proposed Soil Boring		= Electric Line
	= Monitoring Well		= Gas Line
	= Destroyed Well		= Sewer Line
	= Easement		= Water Line
	= Parcel		= Fiber Optic Line
	= Building Footprint		= Power Pole
	= Grassy Area		= Trees
	= Former UST		

*Estimated buried utilities depth >= 4 ft bgs

ALL LOCATIONS AND BOUNDARIES ARE APPROXIMATE

31-11-166

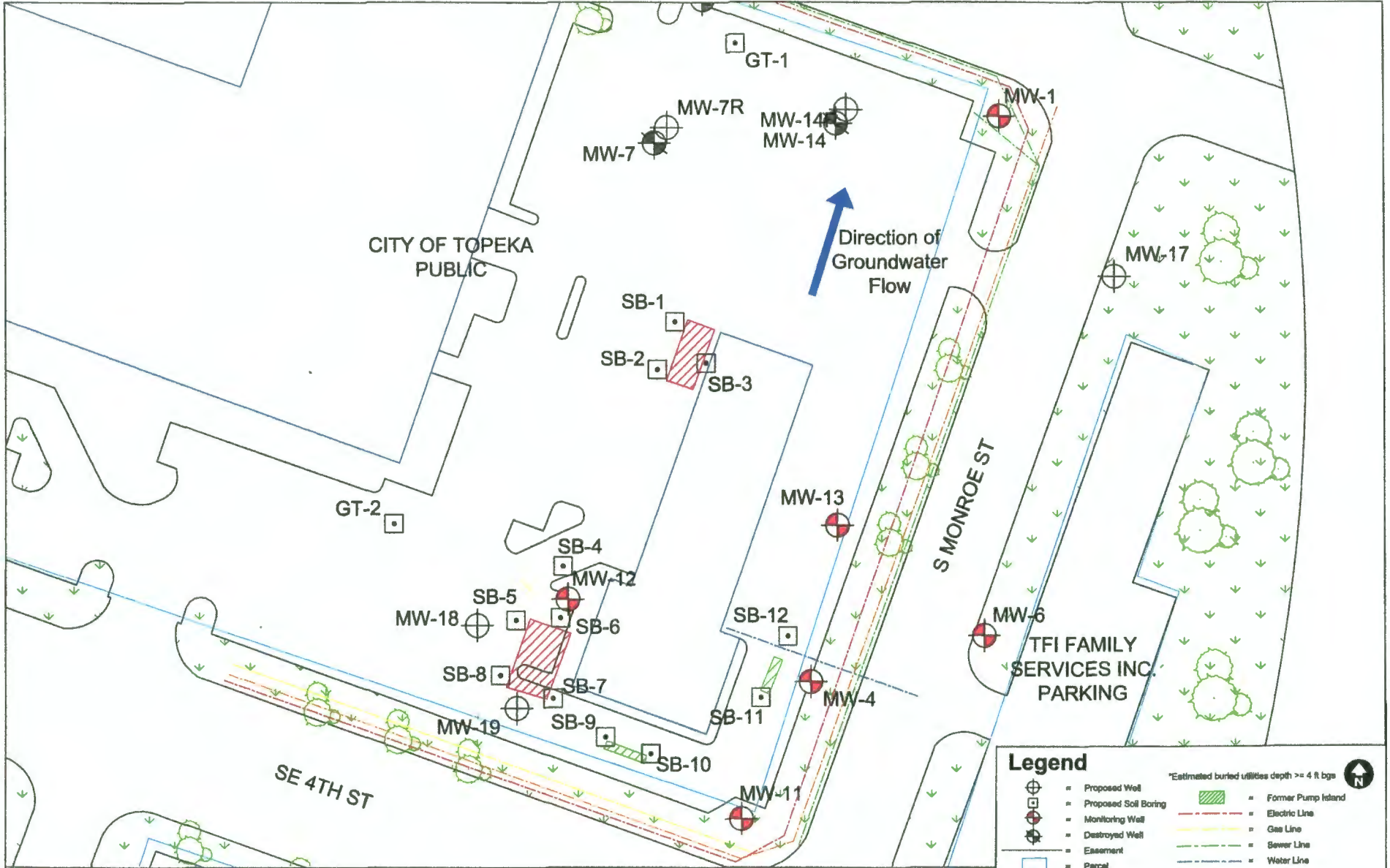

Legend

	= Proposed Well		= Former Pump Island
	= Proposed Soil Boring		= Electric Line
	= Monitoring Well		= Gas Line
	= Destroyed Well		= Sewer Line
	= Easement		= Water Line
	= Parcel		= Fiber Optic Line
	= Building Footprint		= Power Pole
	= Grassy Area		= Trees
	= Former UST		

*Estimated buried utilities depth >= 4 ft bgs

ALL LOCATIONS AND BOUNDARIES ARE APPROXIMATE



FIGURE: 2.0
 DATE: 01/07/2022
 DRAWN BY: HS

FIGURE NAME: Site Map - Scale 1"=50'
 PROJECT NUMBER: 2174145
 PROJECT MANAGER: RE

Montgomery ward & Co., Inc.
 320 Kansas Avenue
 Topeka, Kansas
 KDHE #U4-089-00772

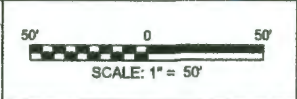

31-11-16E

DENNIS L HANDKE

1820 NW 59th Terrace
TOPEKA, KANSAS 66618
785-286-4047 Home

Kelse Wheeler
GSI
4503 E. 47th Street
Wichita, Kansas, 67210

February 17, 2022

RE: Monitor Well Elevation Survey
320 SE Kansas, Topeka, Kansas

Proj. 22-00L
Montgomery Ward Co. Inc.
KDHE ID U4-089-00772

Bench Mark: Chisled Square on North center of concrete storm inlet on South side of 3rd St. & West of Monroe Street.

Elev: 888.04 North 3991.28 East 99.21 (from SE Cor. Sec. 31-11-16E)

✓ MW-7R	rim	892.38	North	3952.46	NE1/4,NE1/4,SE1/4,NE1/4
	top pipe	891.89	West	86.91	Lat= 37.05506 Long = 95.66954
✓ MW-14R	rim	890.81	North	3952.48	NW1/4,NW1/4,SW1/4,NW1/4 (Sec. 6-12-16E)
	top pipe	890.26	East	17.39	Lat= 37.05506 Long = 95.66917
✓ MW-17	rim	890.27	North	3881.50	NW1/4,NW1/4,SW1/4,NW1/4 (Sec. 6-12-16E)
	top pipe	889.51	East	167.38	Lat= 37.05487 Long = 95.66864
✓ MW-18	rim	899.24	North	3706.02	NE1/4,NE1/4,SE1/4,NE1/4
	top pipe	898.77	West	187.82	Lat= 37.05439 Long = 95.66990
✓ MW-19	rim	899.55	North	3627.60	SE1/4,NE1/4,SE1/4,NE1/4
	top pipe	898.73	West	171.75	Lat= 37.05417 Long = 95.66984

Lat & Long derived from Topeka 7.5' quad map. WGS 84.

Elevation established from existing proj. NAVD 88

If you have any questions, please feel free to call me. Thank you for the opportunity to be of service.

Dennis L Handke RLS

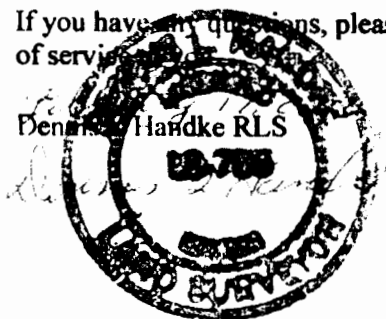

WATER WELL RECORD Form WWC-5

Division of Water Resources App. No.

Well ID **MW-14R**

Original Record Correction Change in Well Use

1 LOCATION OF WATER WELL: County: Shawnee	Fraction NW 1/4 NW 1/4 SW 1/4 NW 1/4	Section Number 6	Township Number T 12 S	Range Number R 16 E W
--	--	----------------------------	----------------------------------	---------------------------------

2 WELL OWNER: Last Name: Business: KDHE Address: 1000 SW Jackson St Address: City: Topeka State: KS ZIP:	Street or Rural Address where well is located (if unknown, distance and direction from nearest town or intersection): If at owner's address, check here: <input type="checkbox"/> Approx. 100' W. + 50' S. of intersection of SE 3rd St. + S. Monroe St., Topeka, KS.
--	---

3 LOCATE WELL WITH "X" IN SECTION BOX:

N

X	NW	NE	
W			E
	SW	SE	
		S	

-----1 mile-----

4 DEPTH OF COMPLETED WELL: **25.0** ft.
Depth(s) Groundwater Encountered: 1) **15.62** ft.
2) ft. 3) ft., or 4) Dry Well
WELL'S STATIC WATER LEVEL: ft.
 below land surface, measured on (mo-day-yr).....
 above land surface, measured on (mo-day-yr).....
Pump test data: Well water was ft.
after..... hours pumping gpm
Well water was ft.
after..... hours pumping gpm
Estimated Yield: gpm
Bore Hole Diameter: **8.75** in. to **25.0** ft. and
..... in. to ft.

5 Latitude: **37.05506** (decimal degrees)
Longitude: **-95.66917** (decimal degrees)
Horizontal Datum: WGS 84 NAD 83 NAD 27
Source for Latitude/Longitude:
 GPS (unit make/model:)
(WAAS enabled? Yes No)
 Land Survey Topographic Map
 Online Mapper:

6 Elevation: **890.26** ft. Ground Level TOC
Source: Land Survey GPS Topographic Map
 Other

7 WELL WATER TO BE USED AS:

1. Domestic: <input type="checkbox"/> Household <input type="checkbox"/> Lawn & Garden <input type="checkbox"/> Livestock	5. <input type="checkbox"/> Public Water Supply: well ID	10. <input type="checkbox"/> Oil Field Water Supply: lease
2. <input type="checkbox"/> Irrigation	6. <input type="checkbox"/> Dewatering: how many wells?	11. Test Hole: well ID
3. <input type="checkbox"/> Feedlot	7. <input type="checkbox"/> Aquifer Recharge: well ID	<input type="checkbox"/> Cased <input type="checkbox"/> Uncased <input type="checkbox"/> Geotechnical
4. <input type="checkbox"/> Industrial	8. <input checked="" type="checkbox"/> Monitoring: well ID MW-14R	12. Geothermal: how many bores?
	9. Environmental Remediation: well ID	a) Closed Loop <input type="checkbox"/> Horizontal <input type="checkbox"/> Vertical
	<input type="checkbox"/> Air Sparge <input type="checkbox"/> Soil Vapor Extraction	b) Open Loop <input type="checkbox"/> Surface Discharge <input type="checkbox"/> Inj. of Water
	<input type="checkbox"/> Recovery <input type="checkbox"/> Injection	13. <input type="checkbox"/> Other (specify):

Was a chemical/bacteriological sample submitted to KDHE? Yes No If yes, date sample was submitted:

Water well disinfected? Yes No

8 TYPE OF CASING USED: Steel PVC Other CASING JOINTS: Glued Clamped Welded Threaded
Casing diameter **2** in. to **25.0** ft., Diameter in. to ft., Diameter in. to ft.
Casing height above land surface **0** in. Weight lbs./ft. Wall thickness or gauge No. **sch 40**

TYPE OF SCREEN OR PERFORATION MATERIAL:
 Steel Stainless Steel Fiberglass PVC Other (Specify)
 Brass Galvanized Steel Concrete tile None used (open hole)

SCREEN OR PERFORATION OPENINGS ARE:
 Continuous Slot Mill Slot Gauze Wrapped Torch Cut Drilled Holes Other (Specify)
 Louvered Shutter Key Punched Wire Wrapped Saw Cut None (Open Hole)

SCREEN-PERFORATED INTERVALS: From **15.0** ft. to **25.0** ft., From ft. to ft., From ft. to ft.
GRAVEL PACK INTERVALS: From **13.0** ft. to **25.0** ft., From ft. to ft., From ft. to ft.

9 GROUT MATERIAL: Neat cement Cement grout Bentonite Other

Grout Intervals: From **1** ft. to **13.0** ft., From **0** ft. to **1** ft., From ft. to ft.

Nearest source of possible contamination:
 Septic Tank Lateral Lines Pit Privy Livestock Pens Insecticide Storage
 Sewer Lines Cess Pool Sewage Lagoon Fuel Storage Abandoned Water Well
 Watertight Sewer Lines Seepage Pit Feedyard Fertilizer Storage Oil Well/Gas Well
 Other (Specify) **Contaminated Site**

Direction from well? Distance from well? ft.

10 FROM	TO	LITHOLOGIC LOG	FROM	TO	LITHO. LOG (cont.) or PLUGGING INTERVALS
0	0.5	Asphalt			
0.5	5	Silt, black moist			
5	10	Clay, black, moist, silty, petroleum odor			
10	15	Silty Clay, dark gray, damp, petroleum odor			
15	20	Silty Clay, dark gray, moist, petroleum odor			
20	25	Silty Clay, gray-brown, moist, plastic, slight petroleum odor			

Notes:

11 CONTRACTOR'S OR LANDOWNER'S CERTIFICATION: This water well was constructed, reconstructed, or plugged under my jurisdiction and was completed on (mo-day-year) **2-1-2022** and this record is true to the best of my knowledge and belief. Kansas Water Well Contractor's License No. **604** This Water Well Record was completed on (mo-day-year) **3/21/22** under the business name of **Environmental Priority Service, Inc.** Signature **[Signature]**