

**1 LOCATION OF WATER WELL:** County: Douglas Fraction: 1/4 SW 1/4 SW 1/4 SW 1/4 Section Number: 28 Township Number: T 12 S Range Number: 19  E  W

Street/Rural Address of Well Location; if unknown, distance & direction from nearest town or intersection: If at owner's address, check here   
5240 West 6th Lawrence KS 66049

**2 WATER WELL OWNER:** Edward Wang  
RR#, St. Address, Box #: 919 E 29th St  
City, State ZIP Code: Lawrence KS 66076

**Global Positioning Systems (GPS) information:**  
Latitude: \_\_\_\_\_ (in decimal degrees)  
Longitude: \_\_\_\_\_ (in decimal degrees)  
Elevation: \_\_\_\_\_  
Datum:  WGS84,  NAD83,  NAD27  
Collection Method:  
 GPS unit (Make/Model: \_\_\_\_\_)  
 Digital Map/Photo,  Topographic Map,  Land Survey  
Est. Accuracy:  < 3 m,  3-5 m,  5-15 m,  > 15 m

**3 MARK WELL'S LOCATION WITH AN "X" IN SECTION BOX:**

N	
NW	NE
SW	SE
S	

**4 DEPTH OF WELL** 28 ft.  
**WELL'S STATIC WATER LEVEL** 14 ft.  
**WELL WAS USED AS:**  
 Domestic  Public Water Supply  Dewatering  
 Irrigation  Oil Field Water Supply  Monitoring  
 Feedlot  Domestic (Lawn & Garden)  Injection Well  
 Industrial  Air Conditioning  Other \_\_\_\_\_  
Was a chemical/bacteriological sample submitted to Department? Yes  No

**5 TYPE OF BLANK CASING USED:**  
 Steel  RMP (SR)  Wrought  Fiberglass  Other (Specify below) None  
 PVC  ABS  Asbestos-Cement  Concrete Tile

Blank casing diameter \_\_\_\_\_ in. Was casing pulled? Yes  No  If yes, how much \_\_\_\_\_  
Casing height above or below land surface \_\_\_\_\_ in.

**6 GROUT PLUG MATERIAL:**  Neat cement  Cement grout  Bentonite  Other \_\_\_\_\_  
Grout Plug Intervals: From 4 ft. to 4.5 ft., From \_\_\_\_\_ ft. to \_\_\_\_\_ ft., From \_\_\_\_\_ to \_\_\_\_\_ ft.

What is the nearest source of possible contamination:  
 Septic tank  Seepage pit  Fuel Storage  Other (specify below) \_\_\_\_\_  
 Sewer lines  Pit privy  Fertilizer storage \_\_\_\_\_  
 Watertight sewer lines  Sewage lagoon  Insecticide storage \_\_\_\_\_  
 Lateral lines  Feedyard  Abandoned water well Direction from well? \_\_\_\_\_  
 Cess pool  Livestock pens  Oil well/Gas well How many feet? \_\_\_\_\_

FROM	TO	PLUGGING MATERIALS	FROM	TO	PLUGGING MATERIALS
<u>28</u>	<u>14</u>	<u>Washed Rock</u>			
<u>14</u>	<u>4.5</u>	<u>Sub Soil</u>			
<u>4.5</u>	<u>4</u>	<u>Bentonite</u>			
<u>4</u>	<u>0</u>	<u>Top Soil</u>			

**7 CONTRACTOR'S OR LANDOWNER'S CERTIFICATION:** This water well was plugged under my jurisdiction and was completed on (mo/day/year) 2-3-10 and this record is true to the best of my knowledge and belief. Kansas Water Well Contractor's License No. \_\_\_\_\_ This Water Well Record was completed on (mo/day/year) \_\_\_\_\_ under the business name of Denning-Santee Const Co by (signature) [Signature]

**INSTRUCTIONS:** Use typewriter or ballpoint pen. Please press firmly and print clearly. Please fill in blanks, underline or circle the correct answers. Send top three copies to Kansas Department of Health and Environment, Bureau of Water, Geology Section, 1000 SW Jackson St., Ste. 420, Topeka, Kansas 66612-1367. Telephone: 785/296-5524. Send one to Water Well Owner and retain one for your records. Visit us at <http://www.kdheks.gov/waterwell/index.html>.

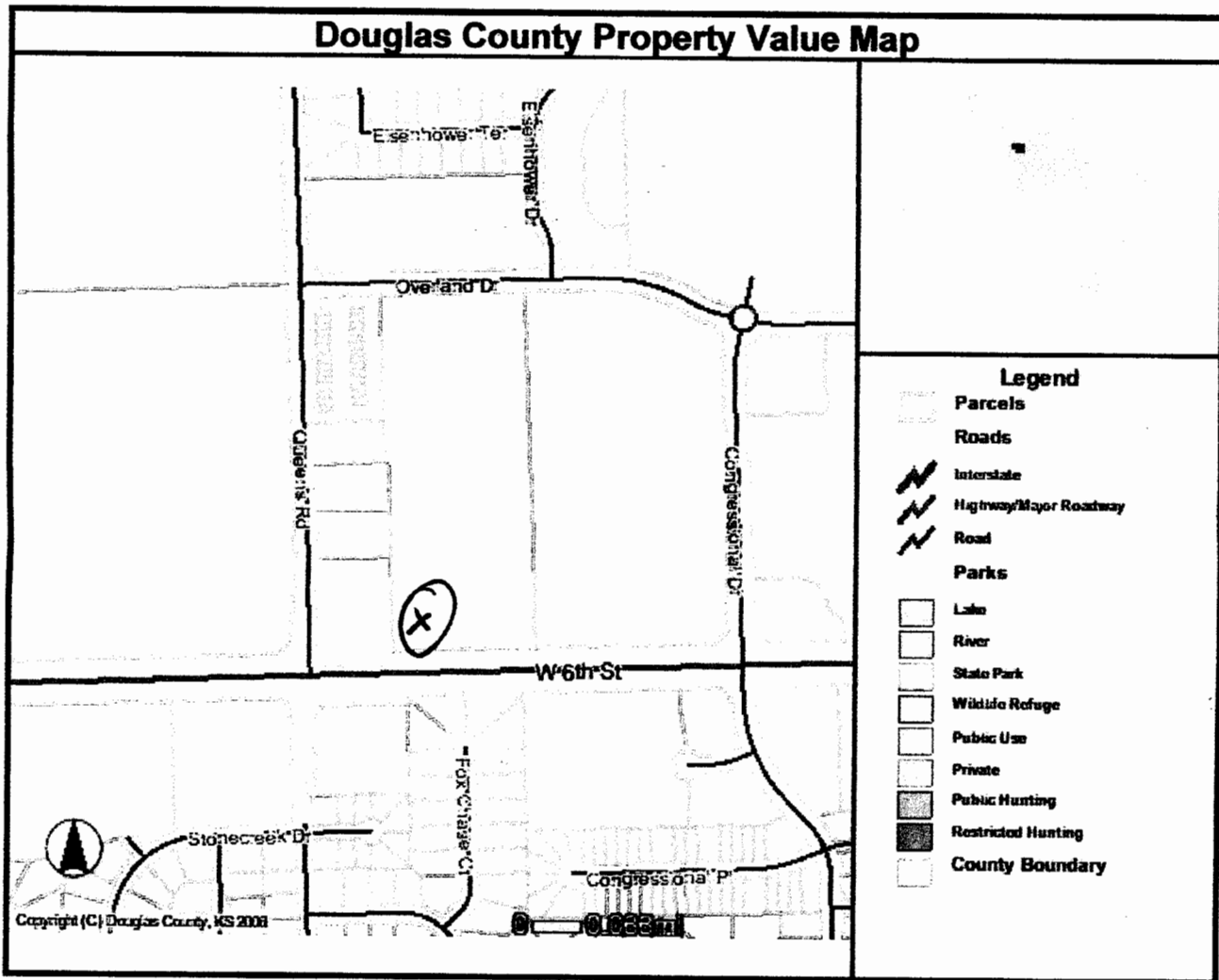

5240 West 6th  
U13960H

**LEGAL DESCRIPTION**

28-12-19 BEG AT PT 277.9 FT E OF SW COR SW 1/4 SW 1/4 TH N 1327.5 FT PARA W LINE SD SEC TON LINE SD SW 1/4 SW 1/4 TH E 495.52 FT ALONG SD N LINE TH S 1327.7 FT PARA W LINE SD SEC TO S LINE SD SEC TH W ALONG SD S LINE 495.52 FT TO PT BEG 15.1A (ANNEXED TO CITY OF LAWRENCE ORD NO 7400 ADOPTED 09/04/2001 BK 735/1109 REPLACES 800196-03), LESS 0.85A PORTION TR 11 IN PERM EASEMENT FOR KDOT CONDEMNATION CASE NO 03-C-311 FILED 06/09/2003 14.25A (DIV 2004 U13960H)