

CORRECTED

WATER WELL RECORD

Form WWC-5

Division of Water Resources App. No.

Well ID

TMW3RR

Original Record Correction Change in Well Use

1 LOCATION OF WATER WELL: County Douglas Fraction SE 1/4 SE 1/4 NE 1/4 NE 1/4 Section Number 35-12 Township Number T 12-13 Range Number R 19 E W

2 WELL OWNER: Last Name: Sinclair Marketing, Inc. Business: Sinclair Marketing, Inc. Address: PO Box 30825 City Salt Lake City State: UT ZIP: 84130 Street or Rural Address where well is located (if unknown, distance and direction from nearest town or intersection): 845 Iowa, Lawrence KS

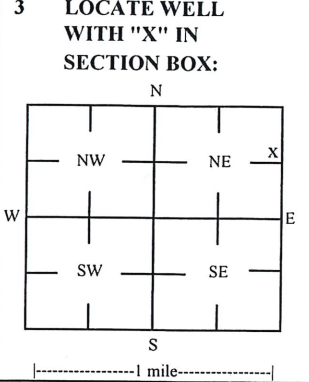

3 LOCATE WELL WITH 'X' IN SECTION BOX: 4 DEPTH OF COMPLETED WELL: 15 ft Depth(s) Groundwater Encountered: 1) ft 2) ft 3) ft or 4) Dry Well WELL'S STATIC WATER LEVEL: ft below land surface, measured on (mo-day-yr) above land surface, measured on (mo-day-yr) Pump test data: Well water was ft after hours pumping gpm Water well was ft after hours pumping gpm Estimated Yield: gpm Bore Hole Diameter: 7.25 in to ft, and in to ft

5 Latitude: 38.96836 (decimal degrees) Longitude: 95.26067 (decimal degrees) Horizontal Datum: X WGS 84 NAD 83 NAD 27 Source for Latitude/Longitude: GPS (unit make/model) (WAAS enabled? Yes No) Land Survey Topographic Map Online Mapper

6 Elevation: 1013.02 ft Ground Level TOC Source: X Land Survey GPS Topographic Map Other

7 WELL WATER TO BE USED AS: 1 Domestic: Household Lawn & Garden Livestock Irrigation Feedlot Industrial 2 3 4 5 Public Water Supply: well ID 6 Dewatering: how many wells? 7 Aquifer Recharge: well ID 8 X Monitoring: well ID TMW3RR 9 Environmental Remediation: well ID Air Sparge Soil Vapor Extractor Recovery Injection 10 Oil Field Water Supply: lease 11 Test Hole: well ID Cased Uncased Geotechnical 12 Geothermal: How many bores? a) Closed Loop Horizontal Vertical b) Open Loop Surface Discharge Inj. of Water Other (specify):

Was a chemical/bacteriological sample submitted to KDHE? Yes No X No If yes, date sample was submitted:

8 TYPE OF CASING USED: Steel PVC Other CASING JOINTS: Glued Clamped Welded X Threaded Casing diameter 2 in. to 5 ft, Diameter in. to ft, Diameter in. to ft, Casing height above land surface -0.34 in. Weight lbs./ft. Well thickness or gauge No

TYPE OF SCREEN OR PERFORATION MATERIAL: Steel Stainless Steel Fiberglass X PVC Other (Specify) Brass Galvanized Steel Concrete tile None used (open hole)

SCREEN OR PERFORATION OPENINGS ARE: Continuous Slot X Mill Slot Gauze Wrapped Torch Cut Drilled Holes Other (Specify) Louvered Shutter Key Punched Wire Wrapped Saw Cut None (Open Hole)

SCREEN-PERFORATED INTERVALS: From 5 ft. to 15 ft, From ft. to ft, From ft. to ft, GRAVEL PACK INTERVALS: From 3 ft. to 15 ft, From ft. to ft, From ft. to ft,

9 GROUT MATERIAL: Neat cement Cement grout X Bentonite X Other Concrete: 0-1' Grout intervals: From 1 ft. to 3 ft, From ft. to ft, From ft. to ft,

Nearest source of possible contamination: Septic Tank Lateral Lines Pit Privy Livestock Pens Insecticide Storage Sewer Lines Cess Pool Sewage Lagoon X Fuel Storage Abandoned Water Well Watertight Sewer Lines Seepage Pit Feedyard Fertilizer Storage Oil Well / Gas Well Other (Specify)

Direction from well? S Distance from well? ~50 ft

Table with 5 columns: FROM, TO, LITHOLOGIC LOG, FROM, TO, LITHO. LOG (cont.) or PLUGGING INTERVALS. Rows show 0-1 Concrete, 1-4 Bentonite, 4-15 Filter Sand and Clay.

Notes: KDHE ID: Sinclair #15005; U4-023-10255 Target of monitoring well is shallow groundwater, <20' of grout was installed at the direction of KDHE.

11 CONTRACTOR'S OR LANDOWNER'S CERTIFICATION: This water well was X constructed, reconstructed or plugged under my jurisdiction and was completed on (mo-day-year) 10/12/22 and this record is true to the best of my knowledge and belief. Kansas Water Well Contractor's License No 757 This Water Well Record was completed on (mo-day-year) 11/28/22 under the business name of Larsen & Associates, Inc. Signature

NOTE: Figures exhibited within this report are only to be used within the context of this report. Placement of property lines, wells, structures, and roads is based on the available information from county appraiser maps, surveys, site visits, and/or previous vendor reports and should be considered approximate.

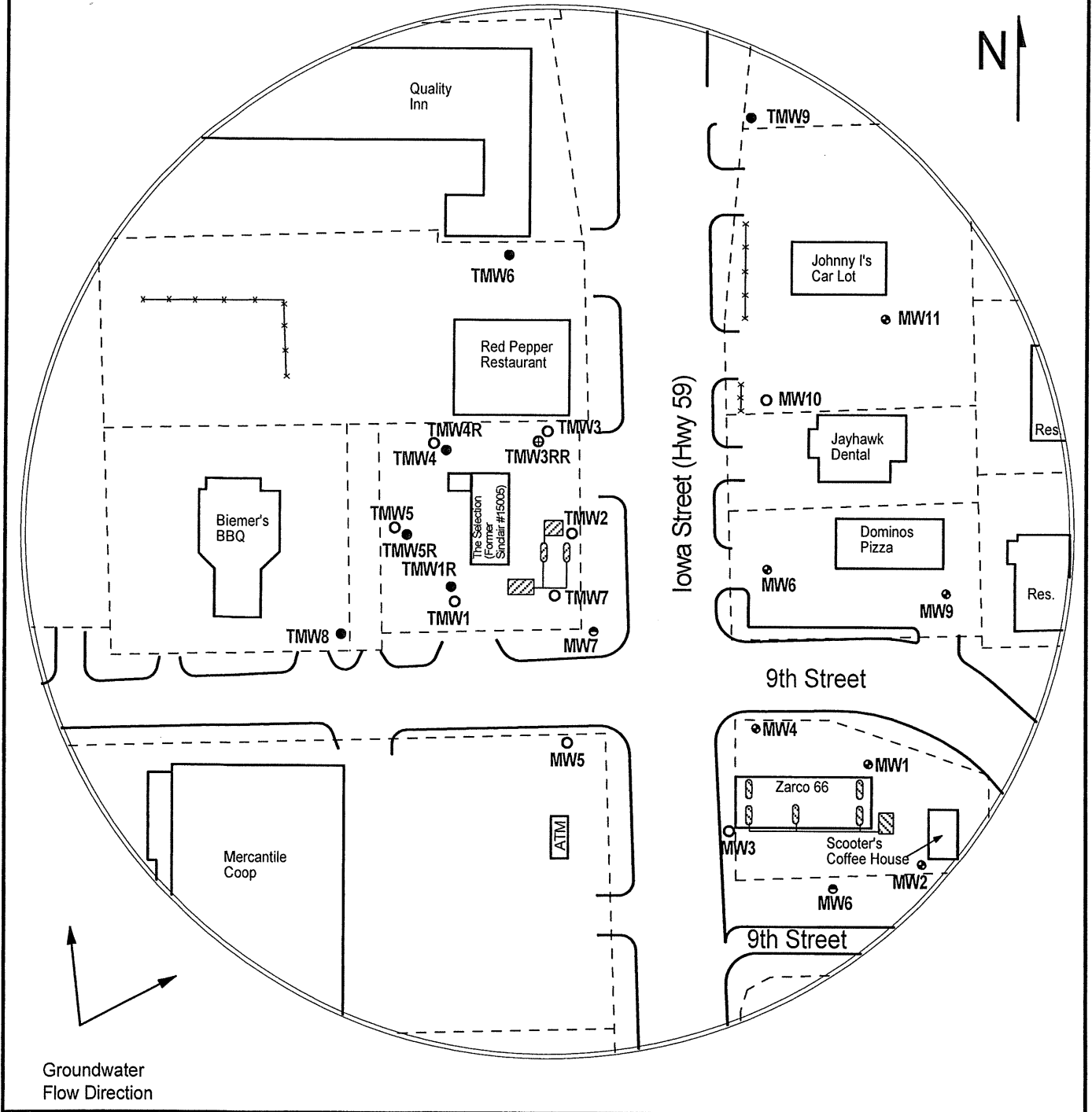

FIGURE 1 - BASE AREA MAP



PROJECT:

Sinclair #15005
845 Iowa
Lawrence, KS
KDHE ID: U4-023-10255
Date: 10/12/22



1311 E 25th St., Suite B (785) 841-8707 office
Lawrence, KS 66046 (785) 865-4282 fax

LEGEND:

- Approximate Location of Former UST Basin, Pump Island and Product Line
- Approximate Location of Active UST Basin, Pump Island and Product Line
- - - - - Approximate Location of Property Line
- Monitoring Well
- Plugged Monitoring Well
- ⊕ Monitoring Well Nearby Site Total Retail #2181 (U4-023-01573)
- Destroyed Well
- ⊕ New Monitoring Well

Note: Well MW3RR was drilled in the same location as MW3R.